

JVC

SERVICE MANUAL

20" COLOR TV

C-2030 (US)

BASIC CHASSIS
FY III'

C-1429

C-1489

Registers

JVC SERVICE & ENGINEERING COMPANY OF AMERICA  
DIVISION OF US JVC CORP.

East Coast Region	: 107 Little Falls Road, Fairfield, New Jersey 07006	(201)808-9279
Mid West Region	: 2250 Lively Blvd., Elk Grove, Illinois 60007	(708)364-0880
South West Region	: 407 Garden Oaks Blvd., Houston, Texas 77018	(713)694-3331
West Coast Region	: 5665 Corporate Avenue, Cypress, California 90630	(714)229-8011
South East Region	: 1500 Lakes Parkway, Lawrenceville, Georgia 30243	(404)339-2522
Hawaii	: 2969 Mapunapuna Place, Honolulu, Hawaii 96819	(808)833-5828

JVC

Service & Engineering Company of America  
Corporate Office  
107 Little Falls Road  
Fairfield, New Jersey 07006  
201-808-2100

INFORMATION

In accordance with the production form change of the PARTS No. have been changed.  
Therefore, we issued an amended PARTS LIST and STANDARD CIRCUIT DIAGRAM.  
Please use the new PARTS LIST and STANDARD CIRCUIT DIAGRAM together with the existing  
original manual(No.50380 Mar. 1990)

sign & specification subject to change without notice.



PARTS LIST

CAUTION

- The parts marked  $\Delta$  are very important for the safety. When replacing these parts, be sure to use specified ones to secure the safety and performance.
  - The module circuit board is supplied together with the assembly, but the parts which do not have the drawing in this Parts List, P. C. Board Assy and the Parts No. columns of which are filled with lines —, will not be supplied.
  - As a rule, the resistors and capacitors which are indicated as shown in (NOTE 2) "HOW TO EXPRESS PARTS NUMBERS OF STANDARD PARTS" are not shown in the list of the parts on the board.
- When ordering the service parts, confirm the resistance/rated power, capacitance/rated voltage, and type of the parts, then order by the part No. indicated according to (NOTE 2).

( NOTE 1 ) ABBREVIATIONS OF RESISTORS, CAPACITORS AND TOLERANCES

RESISTORS		CAPACITORS	
C R	Carbon Resistor	C CAP.	Ceramic Capacitor
F R	Fusible Resistor	E CAP.	Electrolytic Capacitor
P R	Plate Resistor	M CAP.	Mylar Capacitor
V R	Variable Resistor	HV CAP.	High Voltage Capacitor
HV R	High Voltage Resistor	MF CAP.	Metalized Film Capacitor
MF R	Metal Film Resistor	MM CAP.	Metalized Mylar Capacitor
MG R	Metal Glazed Resistor	MP CAP.	Metalized Polystryrol Capacitor
MP R	Metal Plate Resistor	PP CAP.	Polypropylene Capacitor
OM R	Metal Oxide Film Resistor	PS CAP.	Polystyrol Capacitor
CMF R	Coating Metal Film Resistor	TF CAP.	Thin Film Capacitor
UNF R	Non-Flammable Resistor	MPP CAP.	Metalized Polypropylene Capacitor
CH V R	Chip Variable Resistor	TAN. CAP.	Tantalum Capacitor
CH MG R	Chip Metal Glazed Resistor	CH C CAP.	Chip Ceramic Capacitor
COMP. R	Composition Resistor	BP E CAP.	Bi-Polar Electrolytic Capacitor
LPTC R	Linear Positive Temperature Coefficient Resistor	CH AL E CAP.	Chip Aluminum Electrolytic Capacitor
		CH AL BP CAP.	Chip Aluminum Bi-Polar Capacitor
		CH TAN. E CAP.	Chip Tantalum Electrolytic Capacitor
		CH AL BP E CAP.	Chip Tantalum Bi-Polar Electrolytic Capacitor

TOLERANCES									
F	G	J	K	M	N	R	H	Z	P
± 1%	± 2%	± 5%	± 10%	± 20%	± 30%	+ 30% - 10%	+ 50% - 10%	+ 80% - 20%	+ 100% - 0%

( NOTE 2 ) HOW TO EXPRESS PARTS NUMBERS OF STANDARD PARTS

■ RESISTOR

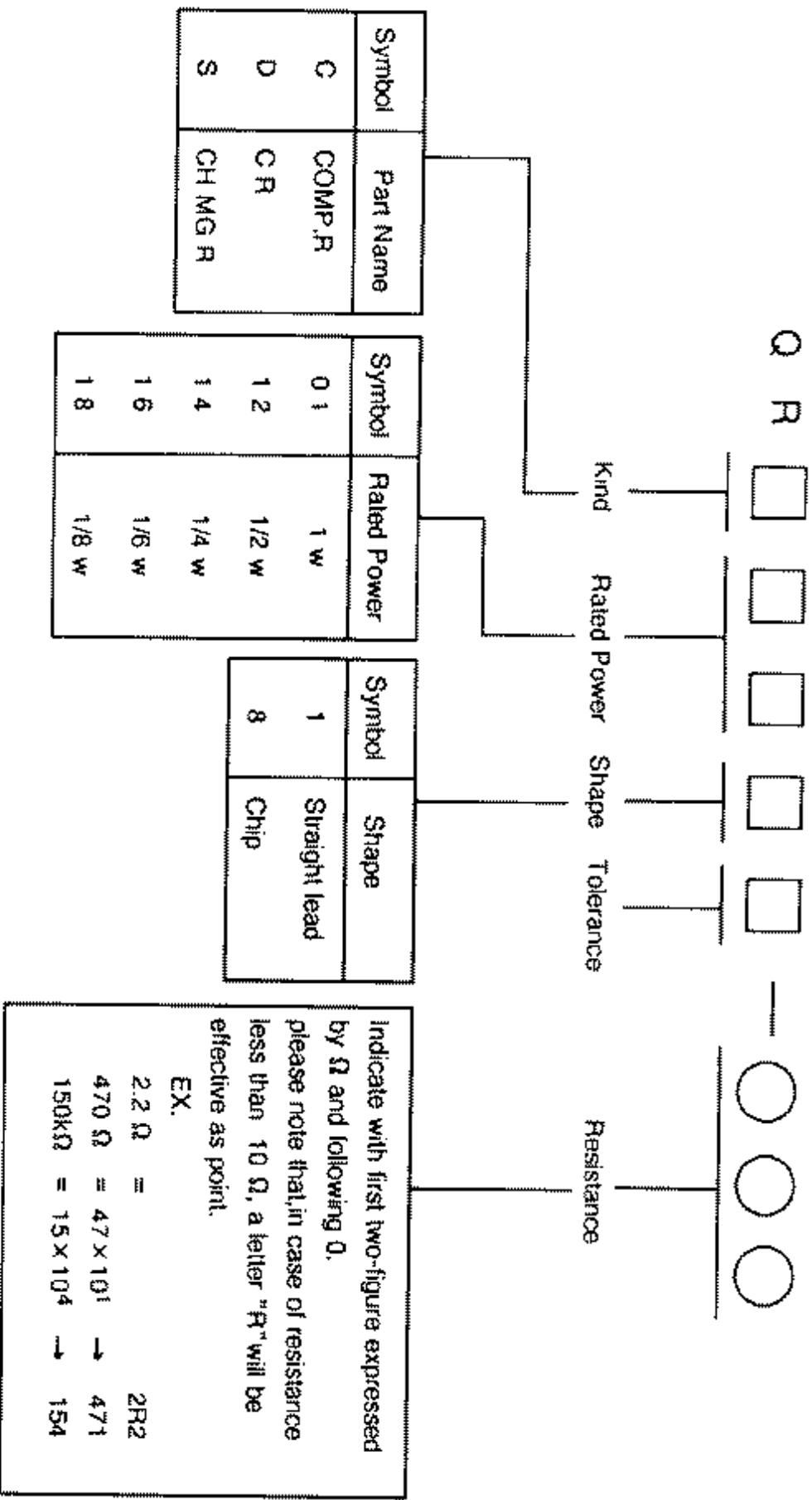

■ CAPACITOR

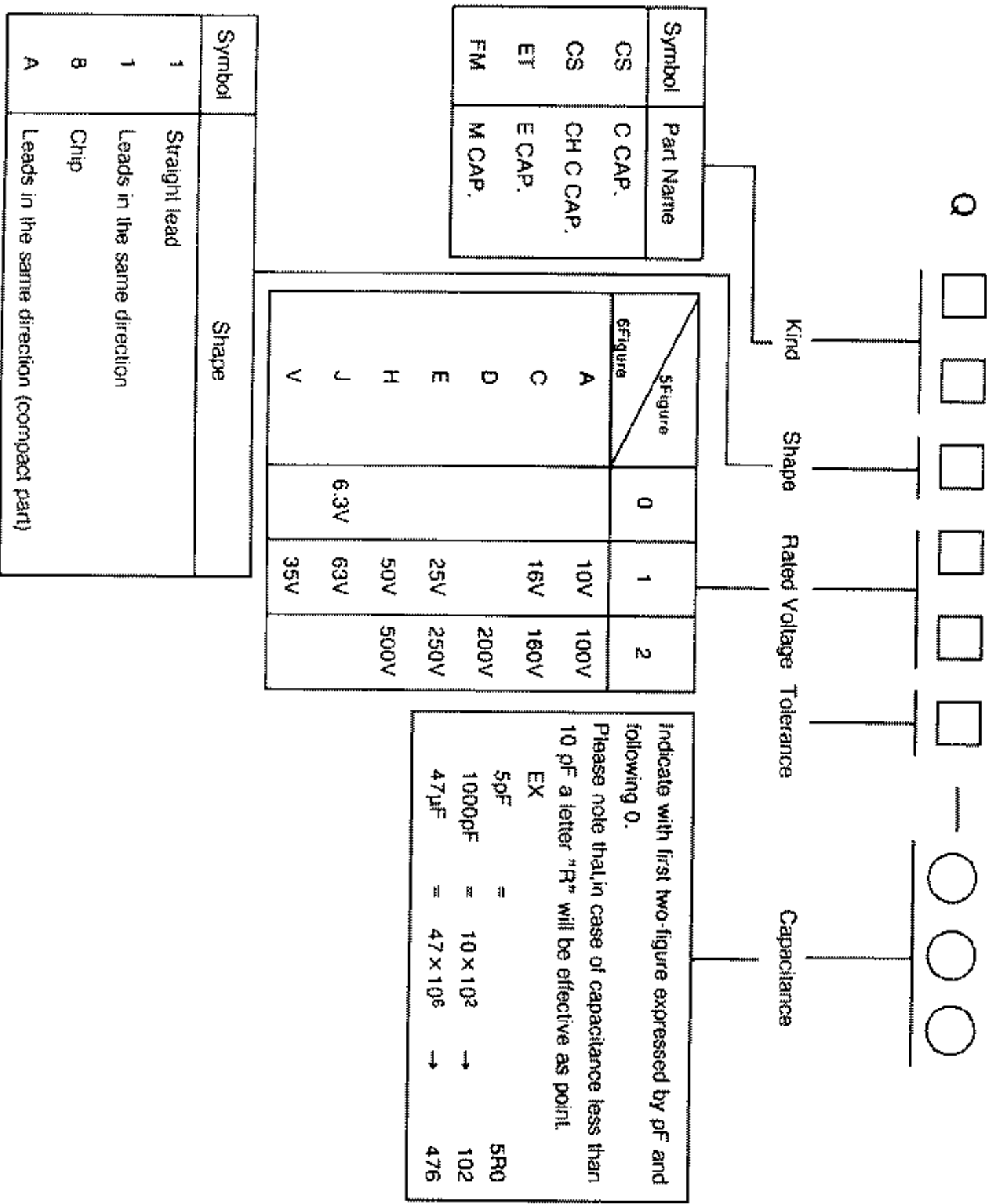

Symbol	Shape
1	Straight lead
1	Leads in the same direction
8	Chip
A	Leads in the same direction (compact part)

EXPLODED VIEW PARTS LIST

SYMBOL NO.	PART NO.	PART NAME	REMARKS
1	CM11715-00C-MH	FRONT CABINET AS	
2	A51JFC80X(Y)	PICTURE TUBE	V01
3	CM11717-001-MH	REAR COVER	
4	CE41803-00A-KD	FLYBACK TRANSF.	T1522
5	CE20174-A0AK11	DEF. YOKE ASSY	DY01
6	CE41259-00DJ2	DEGAUSSING COIL	L01
7	CEBSN12D-02K13	CONE SPEAKER	SP01
8	CE40764-00A	WEDGE ASSY	x3
9	CM21983-001-H	RATING LABEL	
10	A75034-B	P&C MAGNET	
11	CM21978-A01-V0	ORNAMENT PLATE	
12	CM46093-A01	LED MIRROR	
13	CM43094-002	JVC MARK	
14	CE41849-150A	ANT SHIELD BOX	
15	QMP14B0-220J3	POWER CORD	
16	A48457	SPRING	
17	G8SB40162-H	W TAP SCREW	
18	CH43338-00A	BRAIDED ASSY	
19	CM34127-001-VH	ANT TER BASE	x9

EXPLODED VIEW

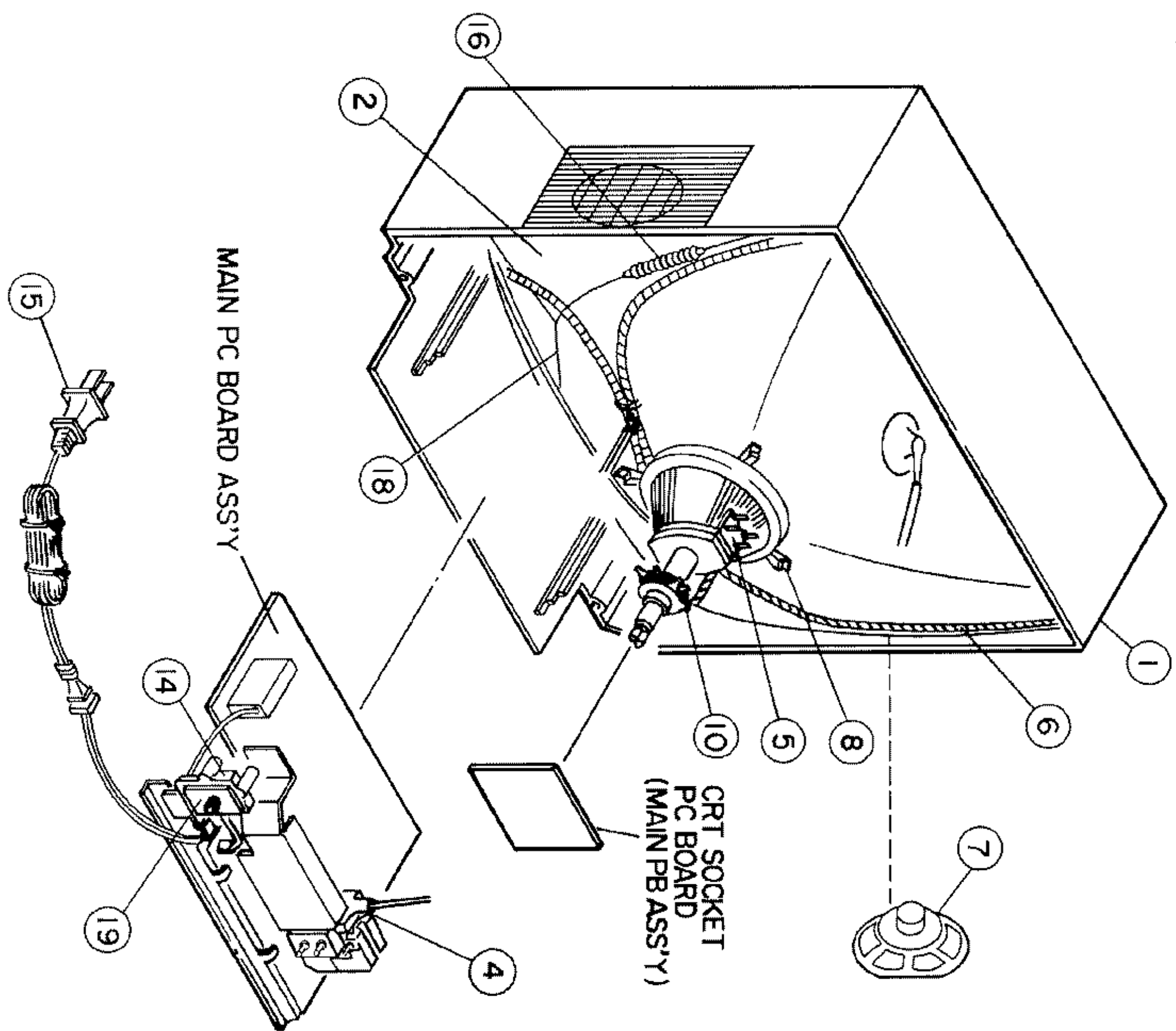

# PRINTED CIRCUIT BOARD PARTS LIST MAIN PC BOARD ASS'Y ( SX-1223A(H3) )

SYMBOL NO.	PART NO.	PART NAME	REMARKS
VARIABLE R			
R1112	QVPE610-202H	VR (NOISE)	2KΩ B
R1246	QVPE610-202H	VR (SUB BRIGHT)	2KΩ B
R1249	QVPE610-103H	VR (SUB PICTURE)	10KΩ B
R1354	QVPE805-502H	VR (B CUT OFF)	5KΩ B
R1355	QVPE805-502H	VR (G CUT OFF)	5KΩ B
R1356	QVPE805-502H	VR (R CUT OFF)	5KΩ B
R1361	QVPE805-201H	VR (G DRIVE)	200 Ω B
R1362	QVPE805-201H	VR (R DRIVE)	200 Ω B
R1428	QVPE610-102H	VR (V. HEIGHT)	1KΩ B
RESISTOR			
RB1507	CJ39520-00Q	RESISTOR ARRAY	
R1108	QR20075-560YJ2	C R	56 Ω 1/2W J
R1201	QR20075-330YJ2	C R	33 Ω 1/2W J
R1217	QR20075-391YJ2	C R	390 Ω 1/2W J
R1218	QR20075-472YJ2	C R	4.7kΩ 1/2W J
R1363	QRC029J-153A	OM R	15kΩ 2W J
R1364	QRC029J-153A	OM R	15kΩ 2W J
R1365	QRC029J-153A	OM R	15kΩ 2W J
R1366	QRC121K-3322	COMP. R	3.3kΩ 1/2W K
R1367	QRC121K-3322	COMP. R	3.3kΩ 1/2W K
R1368	QRC121K-3322	COMP. R	3.3kΩ 1/2W K
R1422	QR20075-561YJ2	C R	560 Ω 1/2W J
R1423	QR20075-122YJ2	C R	1.2kΩ 1/2W J
R1426	QRX019J-3R3S	MF R	3.3 Ω 1W J
R1505	QRD161J-103YJ2	C R	10kΩ 1/6W J
R1508	QR20075-100YJ2	C R	10 Ω 1/2W J
R1521	QRC029J-273A	OM R	27kΩ 1/2W J
R1524	QR20075-562YJ2	C R	5.6kΩ 1/2W J
R1525	QR20082-682	OM R	6.8kΩ 3W J
R1526	QR20081-153	OM R	15kΩ 2W J
R1527	QR20081-153	OM R	15kΩ 2W J
R1528	QRC029J-391A	OM R	390 Ω 2W J
R1532	QRD129J-3R9SJ2	C R	3.9 Ω 1/2W J
R1533	QRX039J-3R3A	MF R	3.3 Ω 3W J
R1534	QRX039J-3R9A	MF R	3.9 Ω 3W J
R1536	QRD149J-1R0SJ2	C R	1.0 Ω 1/4W J
R1537	QR20075-121YJ2	C R	120 Ω 1/2W J
R1539	QRC039J-561A	OM R	560 Ω 3W J
R1541	QR20075-274YJ2	C R	270kΩ 1/2W J
R1542	QR20075-224YJ2	C R	220kΩ 1/2W J
R1628	QR20075-4R7YJ2	C R	4.7 Ω 1/2W J
R1791	QRC019J-471S	OM R	470 Ω 1W J
R1792	QRC029J-561A	OM R	560 Ω 2W J
R1793	QR20080-152	UNF. R	1.5kΩ 5W J
R1794	QRC029J-182A	OM R	1.8kΩ 2W J
R1795	QRC029J-562A	OM R	5.6kΩ 2W J
R1796	QR20075-474YJ2	C R	470kΩ 1/2W J
R1824	QRC029J-183A	OM R	18kΩ 2W J
R1901	QRF074K-1R8J5	UNF. R	1.8 Ω 7W K
R1902	QRD161J-221YJ2	C R	220 Ω 1/6W J
R1903	QRX039J-2R7A	MF R	2.7 Ω 3W J
R1904	QR20075-103YJ2	C R	10kΩ 1/2W J
R1905	QRD161J-224YJ2	C R	220kΩ 1/6W J
R1906	QRF204J-161J5	UNF. R	160 Ω 20W J
CAPACITOR			
C1108	QEC01HM-224M2	E CAP.	0.22μF 50V M
C1110	QCT25CH-101ZJ5	CAP.	100pF 50V J
C1111	QCT25CH-820ZJ5	C CAP.	82pF 50V J

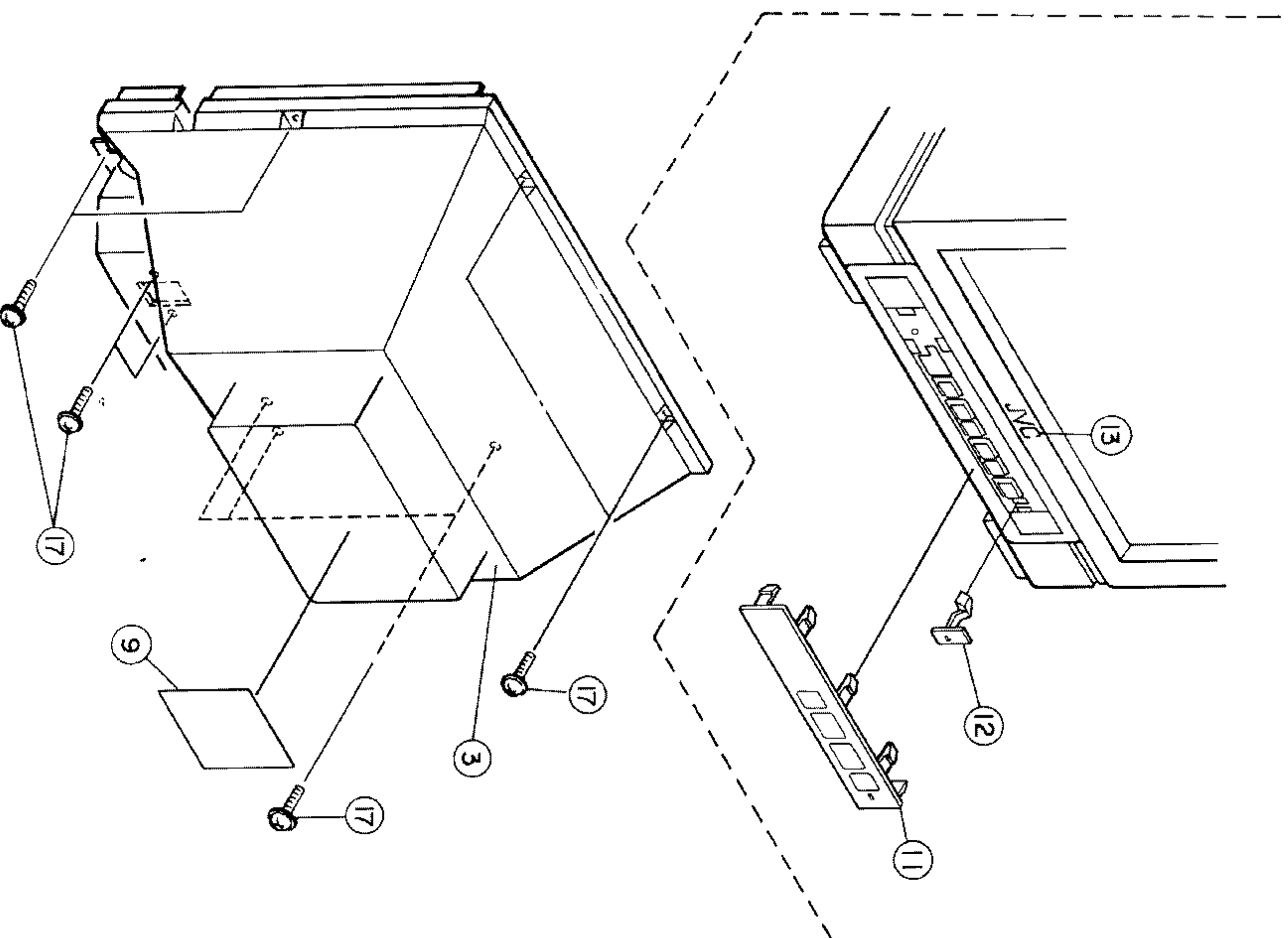



SYMBOL NO.	PART NO.	PART NAME	REMARKS
Δ CAPACITOR			
C1205	QEM61EK-106M2	E CAP.	10μF 25V K
C1214	QFZ0083-683M2	M CAP.	0.068μF 50V K
C1303	QEN61HM-2252J3	BP E CAP.	2.2μF 50V M
C1306	QFM71HK-103M2	M CAP.	0.01μF 50V K
C1307	QFZ0083-563M2	M CAP.	0.056μF 50V K
Δ C1357	QCZ0121-102A	C CAP.	1000pF 3KV P
C1401	QEM61HK-225M2	E CAP.	2.2μF 50V K
C1421	QFN31HK-6822J1	M CAP.	6800pF 50V K
C1423	QETC1VM-1072J5	E CAP.	100μF 35V M
Δ C1426	QFV71HJ-564M2	TF CAP.	0.56μF 50V J
Δ C1504	QFN31HK-3322J1	M CAP.	3300pF 50V K
Δ C1508	QETC1VM-1072J5	E CAP.	100μF 35V M
Δ C1510	QFK52AK-224M	MM CAP.	0.22μF 100V K
Δ C1523	QFN32DK-103J1	M CAP.	0.01μF 200V K
Δ C1524	QFZ0081-6801S	MPP CAP.	6800pF 1600V ±3%
Δ C1526	QFZ0089-354M	MPP CAP.	0.35μF 200V J
Δ C1527	QCZ0115-331A	C CAP.	330pF 2KV K
Δ C1528	QCY32HK-561A2	C CAP.	560pF 500V K
Δ C1529	QCY32HK-102A2	C CAP.	1000pF 500V K
Δ C1530	QCY32HK-102A2	C CAP.	1000pF 500V K
Δ C1533	QETB1VM-228J3	E CAP.	2200μF 35V M
Δ C1534	QETB1EM-108J3	E CAP.	1000μF 25V M
Δ C1536	QET52ER-106	E CAP.	10μF 250V R
Δ C1542	QFN32DK-473J1	M CAP.	0.047μF 200V K
Δ C1544	QCY32HK-561A2	C CAP.	560pF 500V K
Δ C1606	QFN31HK-3922J1	M CAP.	3900pF 50V K
Δ C1622	QEN61HM-1052J3	BP E CAP.	1μF 50V M
Δ C1700	QEB61HM-104M2	E CAP.	0.1μF 50V M
Δ C1707	QFN31HK-2222J1	M CAP.	2200pF 50V K
Δ C1718	QCNB42M-101M	CAP. BLOCK	
Δ C1732	QFV81HJ-224M	TF CAP.	0.22μF 50V J
Δ C1791	QET52ER-475	E CAP.	4.7μF 250V R
Δ C1792	QETB2CM-336	E CAP.	33μF 160V M
Δ C1901	QCZ9025-472A	C CAP.	4700pFACI25V Z
Δ C1902	QCZ9025-472A	C CAP.	4700pFACI25V Z
Δ C1903	QCZ9025-472A	C CAP.	4700pFACI25V Z
Δ C1904	QEZ0110-567R	E CAP.	560μF 200V M
Δ C1905	QET52ER-106	E CAP.	10μF 250V R
Δ C1906	QFZ9025-104M	MF CAP.	0.1μFACI25V M
Δ C1907	QFZ9025-473M	MF CAP.	0.047μFACI25V M
Δ C1908	QET52CR-107	E CAP.	100μF 160V R
Δ TRANSFORMER			
T1103	A75588-B-T	AFC TRANSF.	
T1104	CELT004-201J1	C.W. TRANSF.	
T1301	CELT030-001J1	3.58 BP TRANSF.	
T1521	CEX40133-001J1	HOR DRIVE TRANSF.	
T1601	CELT013-101J1	TAKE-OFF TRANSF.	
T1602	CELT005-101J1	S. I. F. TRANSF.	
Δ COIL			
L1101	CE40143-R47J1	PEAKING COIL	0.47μH
L1102	A76186-1.02-T	PEAKING COIL	1.0μH
L1103	A76186-152-T	PEAKING COIL	15μH
L1201	CE40547-470J1	PEAKING COIL	47μH
L1301	A76186-2.22-T	PEAKING COIL	2.2μH
Δ L1351	A04725-180-T	PEAKING COIL	
Δ L1352	CJ30030-028	CHOKE COIL	180μH
Δ L1521	A76186-562-T	PEAKING COIL	56μH

SYMBOL NO.	PART NO.	PART NAME	REMARKS
Δ COIL			
L1523	CE41807-00B	H. LIN. COIL	
L1524	CE41169-002	PEAKING COIL	
L1525	CE41169-002	PEAKING COIL	
L1702	CE40041-2202J1	PEAKING COIL	22μH
L1703	CELP017-4R7Y	PEAKING COIL	4.7μH
L1704	CELP017-4R7Y	PEAKING COIL	4.7μH
L1705	CELP017-4R7Y	PEAKING COIL	4.7μH
L1706	CELP017-4R7Y	PEAKING COIL	4.7μH
L1707	CELP017-4R7Y	PEAKING COIL	4.7μH
L1708	A76186-2.22-T	PEAKING COIL	2.2μH
L1831	A76186-1.02-T	PEAKING COIL	1.0μH
Δ DIODE			
D1102	RD8.2ES(B1)-T2	ZENER DIODE	
D1103	ISS133-T2	SI. DIODE	
D1104	ISS133-T2	SI. DIODE	
D1201	RD7.5E(B3)	ZENER DIODE	
D1202	ISS133-T2	SI. DIODE	
D1203	MA4150(L)-T2	ZENER DIODE	
D1204	ISS133-T2	SI. DIODE	
D1205	ISS133-T2	SI. DIODE	
D1207	ISS133-T2	SI. DIODE	
D1208	ISS133-T2	SI. DIODE	
D1209	ISS133-T2	SI. DIODE	
D1210	ISS133-T2	SI. DIODE	
D1301	ISS133-T2	SI. DIODE	
D1302	ISS133-T2	SI. DIODE	
D1303	ISS133-T2	SI. DIODE	
D1304	ISS133-T2	SI. DIODE	
D1305	ISS133-T2	SI. DIODE	
D1306	ISS133-T2	SI. DIODE	
D1401	ISS133-T2	SI. DIODE	
D1421	ISSR35-100-T3	SI. DIODE	
D1422	05A275-T5	ZENER DIODE	
D1501	MA4068(L)-T2	ZENER DIODE	
D1502	MA4091(M)-T2	ZENER DIODE	
D1503	MA4068(N) C1-T2	ZENER DIODE	
D1504	ISS81-T2	SI. DIODE	
D1532	RCPI0J-T3	SI. DIODE	
D1533	RCPI0J-T3	SI. DIODE	
D1534	RCPI0J-T3	SI. DIODE	
D1536	RH1S-T3	SI. DIODE	
D1537	ISS81-T2	SI. DIODE	
D1702	ISS133-T2	SI. DIODE	
D1703	ISS133-T2	SI. DIODE	
D1704	ISS133-T2	SI. DIODE	
D1705	ISS133-T2	SI. DIODE	
D1706	ISS133-T2	SI. DIODE	
D1710	ISS133-T2	SI. DIODE	
D1711	ISS133-T2	SI. DIODE	
D1712	ISS133-T2	SI. DIODE	
D1713	ISS133-T2	SI. DIODE	
D1714	GL-5HD23	L.E.D.	
D1716	MA4056(M)-T2	ZENER DIODE	
D1718	ISS133-T2	SI. DIODE	
D1719	ISS133-T2	SI. DIODE	
D1721	ISS133-T2	SI. DIODE	
D1722	ISS133-T2	SI. DIODE	
D1723	ISS133-T2	SI. DIODE	

Power Indicator

SYMBOL NO.	PART NO.	PART NAME	REMARKS
DIODE			
D1724	1SS133-T2	S.I. DIODE	
D1725	1SS133-T2	S.I. DIODE	
D1726	MA4068 (L)	ZENER DIODE	
D1791	1SS146-T2	S.I. DIODE	
D1792	1SS146-T2	S.I. DIODE	
D1793	1S1887A-T3	S.I. DIODE	
D1794	MA4062 (M)-T2	ZENER DIODE	
D1795	1SS133-T2	S.I. DIODE	
D1796	1SS133-T2	S.I. DIODE	
D1797	1SS133-T2	S.I. DIODE	
D1831	1SS133-T2	S.I. DIODE	
D1841	MA4330 (M)-T2	ZENER DIODE	
D1901	1S1887A-T3	S.I. DIODE	
D1902	1S1887A-T3	S.I. DIODE	
D1903	1S1887A-T3	S.I. DIODE	
D1904	1S1887A-T3	S.I. DIODE	
D1905	1S1887A-T3	S.I. DIODE	
TRANSISTOR			
Q1101	2SC1906-T	S.I. TRANSISTOR	
Q1102	2SA933S (QR)-T	S.I. TRANSISTOR	
Q1103	2SC1740S (QR)-T	S.I. TRANSISTOR	
Q1201	2SC1740S (QR)-T	S.I. TRANSISTOR	
Q1202	2SA933S (QR)-T	S.I. TRANSISTOR	
Q1204	2SC1740S (QR)-T	S.I. TRANSISTOR	
Q1351	2SC3271 (NP)-CI	S.I. TRANSISTOR	B. Out
Q1352	2SC3271 (NP)-CI	S.I. TRANSISTOR	G. Out
Q1353	2SC3271 (NP)-CI	S.I. TRANSISTOR	R. Out
Q1521	2SC2482 (CI)-T	S.I. TRANSISTOR	
Q1522	2SD1554-LB	S.I. TRANSISTOR	H. Out
Q1701	2SC1740S (QR)-T	S.I. TRANSISTOR	
Q1702	2SC1740S (QR)-T	S.I. TRANSISTOR	
Q1704	2SC1740S (QR)-T	S.I. TRANSISTOR	
Q1705	2SC1740S (QR)-T	S.I. TRANSISTOR	
Q1706	2SC1740S (QR)-T	S.I. TRANSISTOR	
Q1707	2SC1740S (QR)-T	S.I. TRANSISTOR	
Q1708	2SC1740S (QR)-T	S.I. TRANSISTOR	
Q1709	2SC1740S (QR)-T	S.I. TRANSISTOR	
Q1710	2SC1740S (QR)-T	S.I. TRANSISTOR	
Q1791	2SC2073	S.I. TRANSISTOR	
Q1792	2SC3271 (NP)	S.I. TRANSISTOR	
IC			
IC1101	M51496P	I. C. (M)	
IC1201	TA8601BNV	I. C.	
IC1301	AN5352N	I. C. (M)	
IC1421	UPC1488H	I. C.	
IC1621	AN5265	I. C. (M)	
IC1701	MN152121JMT3	I. C. (M)	
IC1702	MN1280-K	I. C. (M)	
IC1801	TA78L005AP-Y	I. C. (H)	
IC1831	MN12C201D	I. C. (M)	
IC1841	CP10721Q	IFR DETECT UNIT	
IC1901	STR30130-A	I. C.	
OTHERS			
CF1101	CE41602-001	CRT SOCKET	
CF1501	CE41505-001	CERAMIC TRAP	
CF1601	CSB503F17	C. RESONATOR	
	A74603-C	CERAMIC FILTER	

SYMBOL NO.	PART NO.	PART NAME	REMARKS
OTHERS			
CF1701	CSA4.00MS3	CERAMIC FILTER	
DL1201	CE41108-001J1	DELAY LINE	
F1901	QMF66U1-5R0S	FUSE	5.0A
F1902	QMF53U1-1R25S	FUSE	1.25A
LF1901	CE41506-008J1	LINE FILTER	
RY1901	CESK017-001J1	RELAY	
SF1101	CE41706-201	SAW FILTER	
S1201	QSL4A13-C02	LEVER SWITCH	
S1701	QSP4H11-C02	PUSH SWITCH	
S1702	QSP4H11-C02	PUSH SWITCH	
S1703	QSP4H11-C02	PUSH SWITCH	
S1704	QSP4H11-C02	PUSH SWITCH	
S1705	QSP4H11-C02	PUSH SWITCH	
S1706	QSP4H11-C02	PUSH SWITCH	
TH1901	CE40595-001T	POST. THERMISTOR	
TU1701	AN3181EL-B01	TUNER	
X1301	CE40668-001J1	CRYSTAL	

PACKING

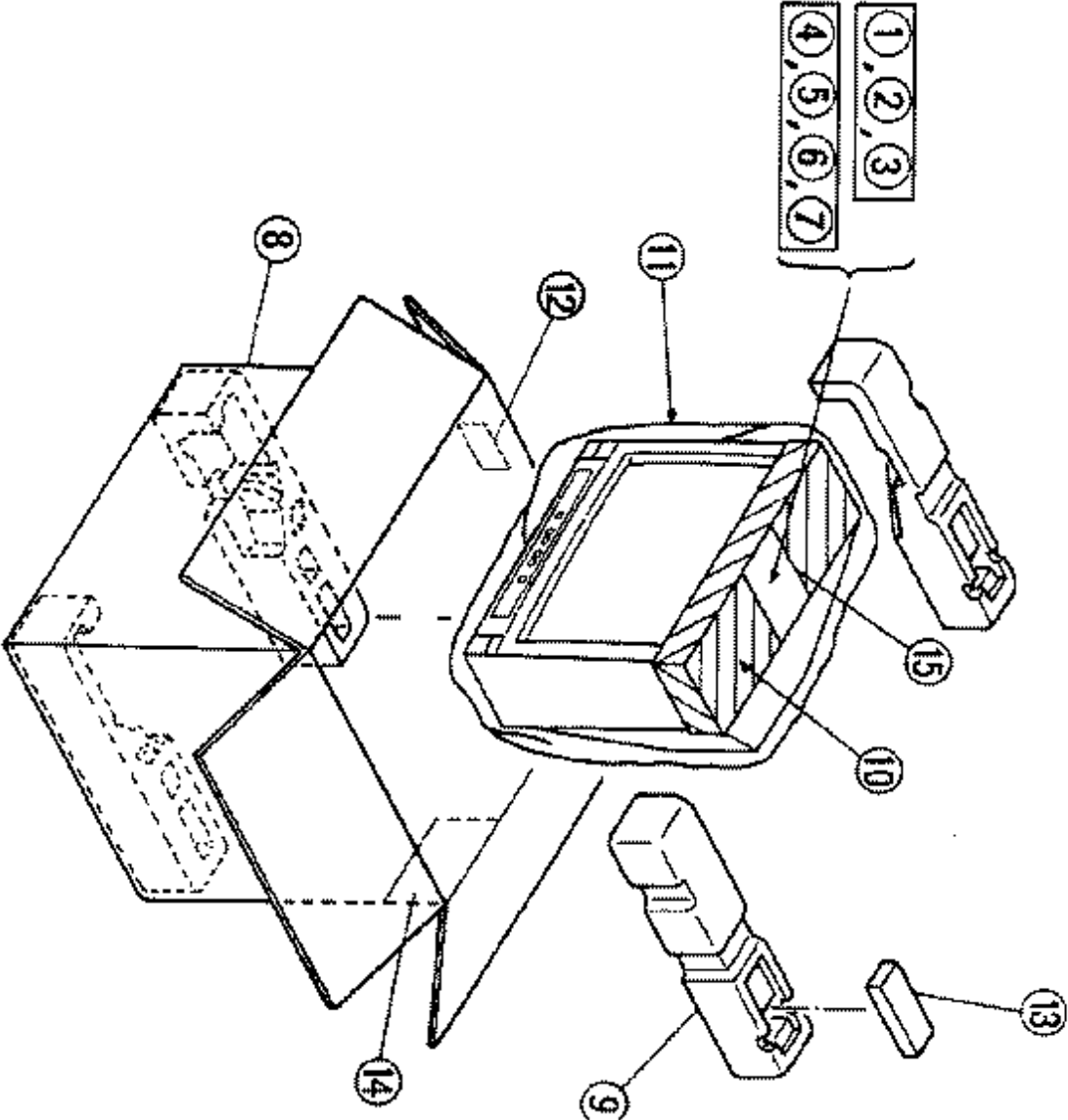





PACKING PARTS LIST

SYMBOL NO.	PART NO.	PART NAME	REMARKS
1	CM31850-00A-T	ROD ANTENNA	
2	20102030US1BAH	INST. BOOK	
3	CE41447-001	UV MIXER	
4	BT-20108A-H	SERVICE INF CARD	
5	BT-20113-H	WARRANTY CARD	
6	CM21229-004-H	SAFETY TIPS	
7	CM34549-A0A-T	UHF LOOP ANT.	
8	CP10974-003-H	PACKING CASE	
9	CP10924-00A-H	CUSHION ASSY	
10	CP30544-001-H	TOP COVER	
11	CP30545-001-H	SET COVER	
12	CP30664-004 (R)	POS LABEL	
13	RM-C423-KD-T	REMOCON	
14	CM22029-00A-H	REC KEEPING CARD	
15	QPCA025-04005H	POLY BAG	



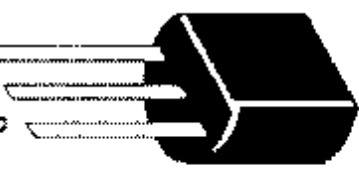

4pcs in 1set

SEMICONDUCTOR SHAPES

TRANSISTORS

 2SA933S(OR)-T 2SC1740S(OR)-T 2SC1906-T	 2SC3271(NP)-C	 2SD1554-C1
 2SC2073		

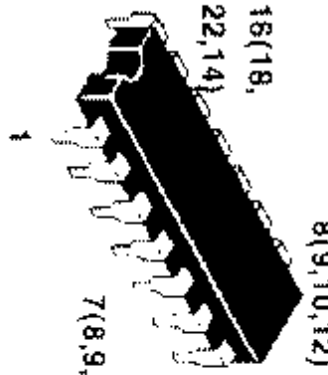
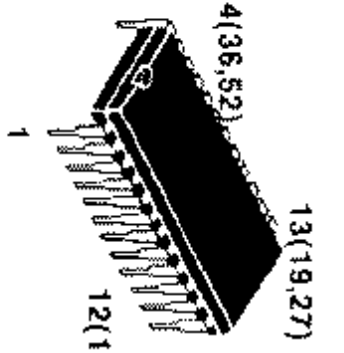
ICs

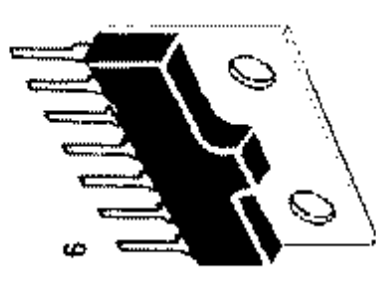
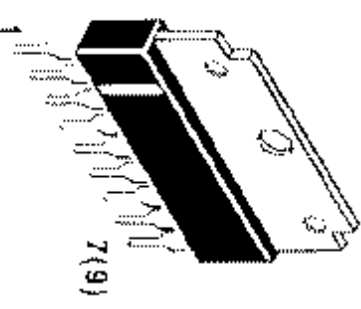
 TA78L005AP-Y	 MK1280-K	 AN5352N MS1496P MN12C201D
 MN15212JMTS TA8601BNV	 STR30130	 μPC1488H
 AN5265		

C-2030(us) STANDARD CIRCUIT DIAGRAM

■ NOTE ON USING CIRCUIT DIAGRAMS

1.SAFETY

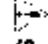
The components identified by the  symbol and shading are critical for safety. For continued safety replace safety critical components only with manufactures recommended parts.

2.SPECIFIED VOLTAGE AND WAVEFORM VALUES

The voltage and waveform values have been measured under the following conditions.

- (1)Input signal :Color bar signal
- (2)Setting positions of each knob/button and variable resistor :Original setting position when shipped

(3)Internal resistance of tester :DC 20kΩ/V

- (4)Oscilloscope sweeping time :H ⇒20pS/div :V ⇒5mS/div
- :Others ⇒ Sweeping time is specified

(5)Voltage values :All DC voltage values

\* Since the voltage values of signal circuit vary to some extent according to adjustments, use them as reference values.

3.INDICATION OF PARTS SYMBOL[EXAMPLE]

- In the P.W board :R1209→R209

4.INDICATIONS ON THE CIRCUIT DIAGRAM

(1)Resistors

- Resistance value  
No unit :[Ω]  
K :[KΩ]  
M :[MΩ]  
•Rated allowable power  
No indication :1/6[W]  
Others :As specified

•Type

- No indication :Carbon resistor
- OMR :Oxide metal film resistor
- MFR :Metal film resistor
- MPR :Metal plate resistor
- UNFR :Unflammable resistor
- FR :Fusible resistor

- Composition resistor 1/2 [W] is specified as 1/2S or Comp.

(2)Capacitors

- Capacitance value  
For higher :[pF]  
less than 1 :[μF]

•Withstand voltage

- No indication :DC50[V]  
Others :DC withstand voltage[V]  
AC indicated :AC withstand voltage[V]

• Electrolytic Capacitors

47/50[Example]Capacitance value[μF]withstand voltage[V]

•Type

- No indication :Ceramic capacitor
- MY :Mylar capacitor
- MM :Metalized mylar capacitor
- PP :Polypropylene capacitor
- MPP :Metalized polypropylene capacitor
- MF :Metalized film capacitor
- TF :Thin film capacitor
- BP :Bipolar electrolytic capacitor
- TAN :Tantalum capacitor

(3)Coils

- No unit :[μH]  
Others :As specified

(4)Power Supply

- :B1(129.3V)
- :B2(12V)
- :9V
- :5V

\* Respective voltage values are indicated.

(5)Test Point

- : Test point

- : Only test point display

(6)Connecting method

- : Connector
- : Wrapping or soldering
- : Replaceable

(7)Ground symbol

- ⊥ : LIVE (Primary) side ground

5.NOTE FOR REPAIRING SERVICE

USE ISOLATION TRANSFORMER BECAUSE THIS PRODUCT IS A HOT CHASSIS!

Whenever any service on this product is performed, AC power of the product should be supplied through an adequate capacity isolation transformer whose power supply cord is connected to the wall outlet.

If the above precaution is not respected, an electric shock may be caused when you touched the chassis with the hand.

<> Since the circuit diagram is a standard one, the circuit and circuit constants may be subject to change for improvement without any notice.



**C-2030**

**C-2030**



2-4 (No. 50380B)

— \* USE ISOLATION  
TRANSFORMER  
WHEN REPAIRING





FRONT

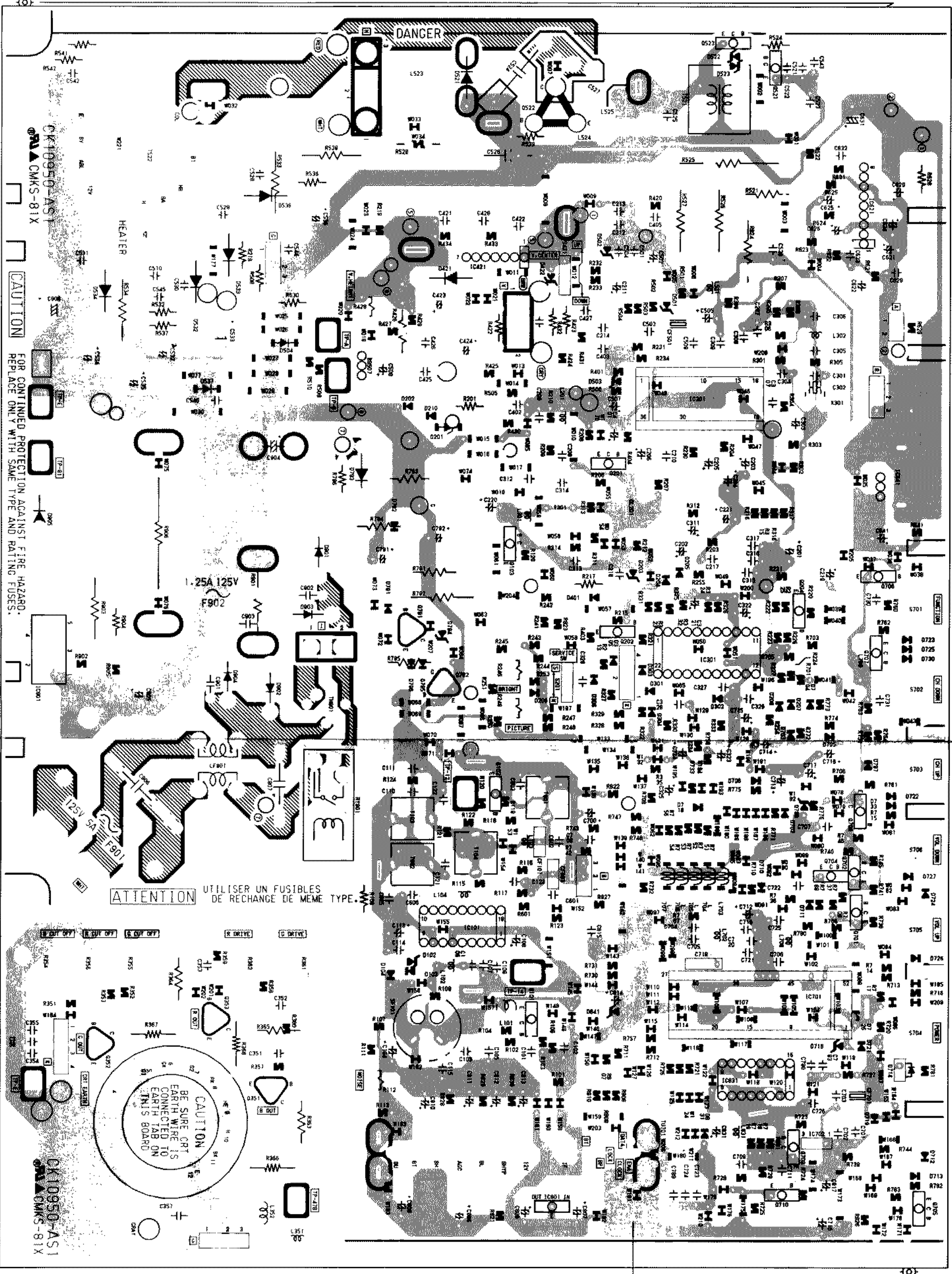



# ATU701 CEEK241-A04-T CATV. TUNER

ANTENNA  
TERMINAL  
CM33702-001-VT  
CE41849-150A

