

5. Exploded View & Part List

5-1. LN32A450C1D Exploded View

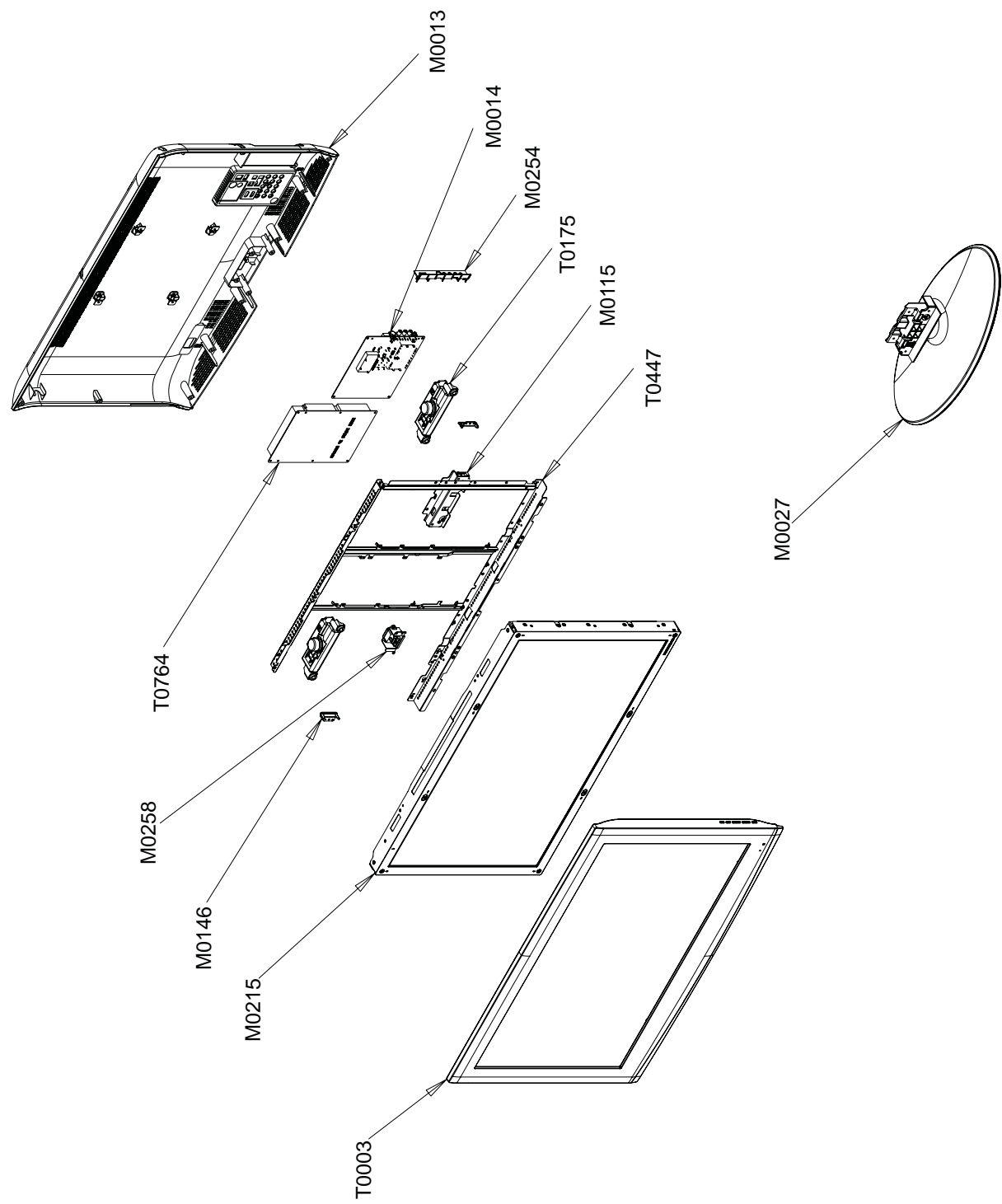

5-1-2. LN32A450C1D Parts List

Location No.	Code No.	Description & Specification	Q'ty	S.A/S.N.A	Remark
T0003	BN96-06784P	ASSY COVER P-FRONT;32L450,UO,PC+ABS,V0,B	1	S.A	
M0215	BN07-00538A	LCD-PANEL;LTF320AB01	1	S.A	
M0146	BN61-03678A	BRACKET-PANEL TOP;32L450,GPSP,T1.0	1	S.N.A	
T0447	BN96-06958A	ASSY BRACKET P-PANEL;32L450,AM,CMO,AUO,G	1	S.N.A	
M0115	BN61-02947A	BRACKET-STAND LINK;JASMINE 32",SECC,T1.6	1	S.A	
T0175	BN96-06818A	ASSY SPEAKER P;8ohm,CORAL,LCD,PDP,10W,4p	1	S.A	
M0254	BN61-03699F	HOLDER-SIDE AV;32L450,UO,HIPS,V0,-,-,-,B	1	S.N.A	
M0014	BN94-01638Q	ASSY PCB MAIN-AMLCD;LN32A450C1DXZA,SSD	1	S.A	
M0013	BN96-06462A	ASSY COVER P-REAR;32L450,UO,HIPS,V0,BK50	1	S.A	
M0027	BN96-06464A	ASSY STAND P-BASE;32L450,,ABS+PMMA,HB,BK	1	S.A	

5-2. LN37A450C1D Exploded View

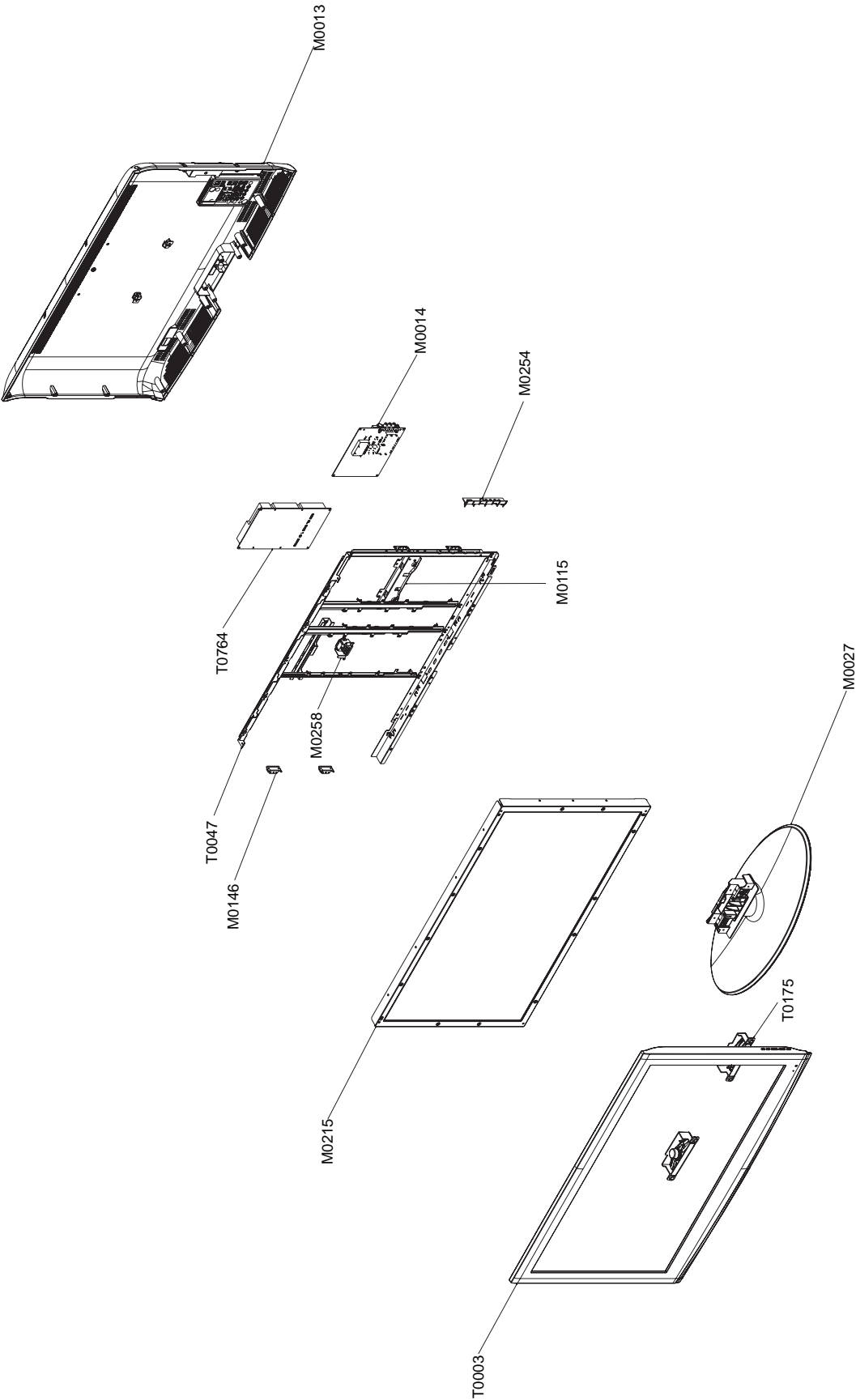

5-2-1. LN37A450C1D Parts List

Location No.	Code No.	Description & Specification	Q'ty	S.A/S.N.A	Remark
T0003	BN96-06785J	ASSY COVER P-FRONT;37L450,UO,PC+ABS,V0,B	1	S.A	
T0175	BN96-06818A	ASSY SPEAKER P;8ohm,CORAL,LCD,PDP,10W,4p	1	S.A	
M0215	BN07-00507A	LCD-PANEL;CLAA370WF02S	1	S.A	
M0146	BN61-02419A	BRACKET-PANEL SIDE;SONOMA 32,SECC,T1.2,A	4	S.N.A	
T0447	BN96-06959C	ASSY BRACKET P-PANEL;37L450,UO,CPT,,SECC	1	S.N.A	
M0258	BN39-00615Q	CBF HARNESS-INLET SOCKET;LN40A450C1D,UL1	1	S.A	
M0115	BN61-02882A	BRACKET-STAND LINK;TULIP,40,SECC,T1.6,-,	1	S.A	
M0254	BN61-03699B	HOLDER-SIDE AV;32L450,UO,HIPS,HB,BK500	1	S.N.A	
T0764	BN44-00217A	SMPS-LCDTV;MK37P5B,SEM,AC/DC,171W,AC100	1	S.A	
M0014	BN94-01638R	ASSY PCB MAIN-CPT;LN37A450C1DXZA	1	S.A	
M0013	BN96-06789A	ASSY COVER P-REAR;37L450,UO,HIPS,V0,BK50	1	S.A	
M0027	BN96-07182A	ASSY STAND P-BASE;37,40L450,UO,ABS+PMMA,	1	S.A	

5-3. LN32A450C1D Parts List

Level	Location No.	Code No.	Description & Specification	Q'ty	SA/SNA	Remark
		LN32A450C1DXZA	LN32A450C1D,N45B/32AC1-GCR,32,LCD-TV,UNI			
0.1	M0001	BN90-01501A	ASSY COVER FRONT;32L450,UO,,,	1	S.N.A	
..2	T0175	BN96-06818A	ASSY SPEAKER P;8ohm,CORAL,LCD,PDP,10W,4p	1	S.A	
..2	T0003	BN96-06784P	ASSY COVER P-FRONT;32L450,UO,PC+ABS,V0,B	1	S.A	
...3	M0081	6003-001188	SCREW-TAPTITE;BH,+,-,B,M4,L10,ZPC(WHT),S	1	S.A	
...3	M0081	6003-001188	SCREW-TAPTITE;BH,+,-,B,M4,L10,ZPC(WHT),S	2	S.A	
...3	M0279	AA63-01637A	FELT;50P9,FELT,0.5,10,80	1	S.N.A	
...3	CCM1	BN63-02183F	COVER-SHEET;Rhcm,PE Vinyl,T0.05,900mm,20	0.74	S.N.A	
...3	M0112	BN63-04166A	COVER-FRONT;32L450,UO,PC+ABS,-,-,-,V0,-,	1	S.N.A	
...3	T0059	BN64-00379A	INDICATOR LED;ROME-II,23,PC,CLEAR	1	S.N.A	
...3	T0061	BN64-00453A	WINDOW-REMOCON;32R71,PC,VIOLET,DIFFUSER(1	S.N.A	
...3	T0022	BN64-00755A	KNOB-CONTROL;32L450,ABS,V0,BK07	1	S.N.A	
...3	DECO/BOT	BN64-00756A	DECORATION-BOTTOM;L450 32INCH,PC,-,-,-,-	1	S.N.A	
...3	A/HBOSS	BN96-06794A	ASSY HOLDER P-BOSS;32L450,UO,HIPS,V0,,BK	1	S.N.A	
....4	H/BOSS	BN61-03675A	HOLDER-BOSS BOTTOM;32L450,UO,HIPS,V0,-,-	1	S.N.A	
....4		BN61-03261B	BOSS-TAPE;Tulip,ACRYL,T1.1,W20mm,GRAY,TA	0.57	S.N.A	
...3	T0069	BP60-00015R	SPACER-FELT;L450,FELT,L710,BLK,T0.35,W10	2	S.N.A	
...3	T0069	BP60-00015S	SPACER-FELT;L450 32",FELT,L410,BLK,T0.35	2	S.N.A	
...3	M0145	BN96-07269A	ASSY BOARD P-FUNCTION;LN40A450C1D,CT5000	1	S.A	
...3	M0146	BN96-07270D	ASSY BOARD P-POWER & IR;LN32A450C1D,CT50	1	S.A	
0.1	M0002	BN90-01506A	ASSY COVER REAR;32L450,UO,,,	1	S.N.A	
..2	T0081	6002-001294	SCREW-TAPPING;BH,+,,M4,L16,ZPC(BLK)	1	S.A	
..2	T0081	6002-001294	SCREW-TAPPING;BH,+,,M4,L16,ZPC(BLK)	1	S.A	
..2	T0081	6002-001294	SCREW-TAPPING;BH,+,,M4,L16,ZPC(BLK)	11	S.A	
..2	M0013	BN96-06462A	ASSY COVER P-REAR;32L450,UO,HIPS,V0,BK50	1	S.A	
...3	M0081	6003-001188	SCREW-TAPTITE;BH,+,-,B,M4,L10,ZPC(WHT),S	4	S.A	
...3	T0101	BN61-03348A	BRACKET-WALL;LCD TV 32,SECC T1.2,-,-,-,-	4	S.N.A	
...3	M0006	BN63-04172A	COVER-REAR;32L450,UO,HIPS,-,-,-,V0,-,BK5	1	S.N.A	
...3	T0071	BN64-00759A	INLAY-TERMINAL;L450,UO,PS SHEET,T0.3,104	1	S.N.A	
...3	T0064	BN65-00002A	CLAMPER CORE;BORDEAUX,LDPE,-,-,BLK,-	1	S.N.A	
...3	T0069	AA60-00091J	SPACER-FELT;-,-,FELT,330X10,-,-,BLK,T0.5,-	2	S.N.A	
...3	M0279	BN63-00867A	FELT;AS17UO,FELT,0.5,10,68	2	S.N.A	
0.1	M0216	BN90-01512A	ASSY STAND;32L450,UO,,,	1	S.N.A	
..2	C/STAND	BN63-04356A	COVER-STAND NECK;L450 32INCH,ABS+PMMA,HB	1	S.N.A	
..2	M0027	BN96-06464A	ASSY STAND P-BASE;32L450,,ABS+PMMA,HB,BK	1	S.A	
...3	T0081	6002-001294	SCREW-TAPPING;BH,+,,M4,L16,ZPC(BLK)	4	S.A	
...3	M0081	6003-001239	SCREW-TAPTITE;FH,+,-,B,M4,L10,ZPC(WHT),S	4	S.A	
...3	H/WRTOP	BN61-02232A	HOLDER-SWIVEL RING;32R71,ACETAL NATUAL,N	1	S.N.A	
...3	H/WRBOTTOM	BN61-02233A	HOLDER-SWIVEL RING;32R71,ACETAL NATUAL,N	1	S.N.A	
...3	B/HSWIVEL	BN61-02236A	BRACKET-HINGE SWIVEL;BORDEAUX 32,SECC,T1	1	S.N.A	
...3	B/SBOTTOM	BN61-02942A	BRACKET-STAND BOTTOM;32,BORDEAUX PLUS,SE	1	S.N.A	
...3	CCM1	BN63-02183D	COVER-SHEET;Rhcm,PE Vinyl,T0.05,680mm,20	0.4	S.N.A	
...3	T0004	BN63-04355A	COVER-STAND BASE;L450 32INCH,ABS+PMMA,HB	1	S.N.A	
...3	ASTGUIDE	BN96-07934A	ASSY STAND P-GUIDE;BOTTOM;L450,V0,BLK,40	1	S.A	
....4		BN61-02932B	BRACKET-STOPPER NUT;L450,M4,OD8,-,-,L24,	3	S.N.A	

5. Exploded View & Part List

Level	Location No.	Code No.	Description & Specification	Q'ty	SA/SNA	Remark
....4		BN61-03872A	GUIDE-STAND BOTTOM;L450 32INCH,PC+GF(20%	1	S.N.A	
...3	M0126	BN73-00052C	RUBBER-FOOT;LCD TV,CR RUBBER,T2.0 DIA19,	4	S.N.A	
..2	ASTGD	BN96-08422A	ASSY STAND P-GUIDE;L450,32 INCH,BLK,PC+G	1	S.A	
...3	T0920	BN61-03868A	GUIDE-STAND;L450 32INCH,PC+GF(20%) V0,BL	1	S.N.A	
0.1	A/CHASSIS	BN91-01973H	ASSY CHASSIS-SSD;LN32A450C1DXZA	1	S.N.A	
..2	M0014	BN94-01638Q	ASSY PCB MAIN-AMLCD;LN32A450C1DXZA,SSD	1	S.A	
...3	T0245	0202-001608	SOLDER-WIRE FLUX;LFC7-107,D0.8,99.3Sn/0.	0.25	S.N.A	
...3	JA801S	3701-001388	CONNECTOR-HDMI;20P,Phosphor Bronze,ANGLE	1	S.A	
...3	JA7003	3701-001400	CONNECTOR-DSUB;15P,3R,FEMALE,STRAIGHT,Ni	1	S.A	
...3	CN906	3707-001081	CONNECTOR-OPTICAL;STRAIGHT,SPDIF	1	S.A	
...3	CN330	3711-000058	HEADER-BOARD TO CABLE;BOX,4P,1R,2.5MM,AN	1	S.A	
...3	CN330	3711-003846	HEADER-BOARD TO CABLE;BOX,8P,1R,2mm,ANGL	1	S.A	
...3	CN330	3711-004484	HEADER-BOARD TO CABLE;BOX,5P,1R,2mm,STRA	1	S.A	
...3	CN330	3711-005606	HEADER-BOARD TO CABLE;BOX,30P,2R,2mm,STR	1	S.A	
...3	CN330	3711-005842	HEADER-BOARD TO CABLE;BOX,24P,2R,2MM,STR	1	S.A	
...3	JA330	3722-000143	JACK-PHONE;1P(VER),AG,BLK,ANGLE	1	S.A	
...3	JA330	3722-001061	JACK-PHONE;1P,3.6PI,AG,BLK,N	1	S.A	
...3	JA806S	3722-002275	JACK-DIN;4P,-,SN,BLK,-	1	S.A	
...3	JA7004	3722-002516	JACK-USB;4P/1C,AU30U,BLK,STRAIGHT,A TYPE	1	S.A	
...3	JA333	3722-002635	JACK-PIN;3P,Sn,YEL/WHT/RED,ANGLE	1	S.A	
...3	JA333	3722-002697	JACK-PIN;14P+1P(Shield+Gnd),NI,BLACK,STR	1	S.A	
...3	M0107	BN63-01847A	SHIELD-COVER;ROME,SPTT,T0.3,49.5,79.5,HE	1	S.N.A	
...3	CCMM1	BN73-00024D	SILICON/RUBBER;BORDEAUX,SILICON,28x28XT6	1	S.A	
...3		BN97-00707A	ASSY HDCP;BN46-00018A,BR20/21BS_CS,MSTAR	1	S.N.A	
....4		BN46-00018A	KEY CODE-CERTIFICATE;(HDCP KEY)PPM42M5S,	1	S.N.A	
...3		BN97-01995H	ASSY SMD-SSD;LN32A450C1DXZA	1	S.N.A	
....4	SUB05	0202-001477	SOLDER-CREAM;LST309-M,-,D20~45um,96.5Sn/	2.094	S.N.A	
....4	D1011	0401-000133	DIODE-SWITCHING;RLS4148,75V,150mA,LL-34,	1	S.A	
....4	D9005	0401-000133	DIODE-SWITCHING;RLS4148,75V,150mA,LL-34,	1	S.A	
....4	D2002	0401-001056	DIODE-SWITCHING;MMBD4148SE,100V,200mA,SO	1	S.A	
....4	D2003	0401-001056	DIODE-SWITCHING;MMBD4148SE,100V,200mA,SO	1	S.A	
....4	D2004	0401-001056	DIODE-SWITCHING;MMBD4148SE,100V,200mA,SO	1	S.A	
....4	D2006	0401-001056	DIODE-SWITCHING;MMBD4148SE,100V,200mA,SO	1	S.A	
....4	D2008	0401-001056	DIODE-SWITCHING;MMBD4148SE,100V,200mA,SO	1	S.A	
....4	D5001	0401-001056	DIODE-SWITCHING;MMBD4148SE,100V,200mA,SO	1	S.A	
....4	D7002	0401-001056	DIODE-SWITCHING;MMBD4148SE,100V,200mA,SO	1	S.A	
....4	D7005	0401-001056	DIODE-SWITCHING;MMBD4148SE,100V,200mA,SO	1	S.A	
....4	D7011	0401-001056	DIODE-SWITCHING;MMBD4148SE,100V,200mA,SO	1	S.A	
....4	D7012	0401-001056	DIODE-SWITCHING;MMBD4148SE,100V,200mA,SO	1	S.A	
....4	D7013	0401-001056	DIODE-SWITCHING;MMBD4148SE,100V,200mA,SO	1	S.A	
....4	D7023	0401-001056	DIODE-SWITCHING;MMBD4148SE,100V,200mA,SO	1	S.A	
....4	D7025	0401-001056	DIODE-SWITCHING;MMBD4148SE,100V,200mA,SO	1	S.A	
....4	D8012S	0401-001056	DIODE-SWITCHING;MMBD4148SE,100V,200mA,SO	1	S.A	
....4	D8014S	0401-001056	DIODE-SWITCHING;MMBD4148SE,100V,200mA,SO	1	S.A	
....4	D1004	0401-001099	DIODE-SWITCHING;1N4148WS,75V,150mA,SOD-3	1	S.A	
....4	D1005	0401-001099	DIODE-SWITCHING;1N4148WS,75V,150mA,SOD-3	1	S.A	
....4	D1007	0401-001099	DIODE-SWITCHING;1N4148WS,75V,150mA,SOD-3	1	S.A	
....4	D1008	0401-001099	DIODE-SWITCHING;1N4148WS,75V,150mA,SOD-3	1	S.A	
....4	D1009	0401-001099	DIODE-SWITCHING;1N4148WS,75V,150mA,SOD-3	1	S.A	
....4	D1010	0401-001099	DIODE-SWITCHING;1N4148WS,75V,150mA,SOD-3	1	S.A	

Level	Location No.	Code No.	Description & Specification	Q'ty	SA/SNA	Remark
....4	D9004	0401-001099	DIODE-SWITCHING;1N4148WS,75V,150mA,SOD-3	1	S.A	
....4	D0254	0402-000553	DIODE-SCHOTTKY;SS24/B240,40V,2000mA,DO-2	1	S.A	
....4	D0254	0402-000553	DIODE-SCHOTTKY;SS24/B240,40V,2000mA,DO-2	1	S.A	
....4	D0254	0402-001207	DIODE-SCHOTTKY;UPS5819,40V,1000MA,DO-216	1	S.A	
....4	D1006	0403-000002	DIODE-ZENER;VLZ5V6B,5.45/5.73V,500mW,SOD	1	S.A	
....4	D7017	0403-000771	DIODE-ZENER;VLZ6V2B,5.96-6.27V,500mW,SOD	1	S.A	
....4	D7018	0403-000771	DIODE-ZENER;VLZ6V2B,5.96-6.27V,500mW,SOD	1	S.A	
....4	D7050	0403-000771	DIODE-ZENER;VLZ6V2B,5.96-6.27V,500mW,SOD	1	S.A	
....4	D8007S	0403-000771	DIODE-ZENER;VLZ6V2B,5.96-6.27V,500mW,SOD	1	S.A	
....4	D6002	0403-001052	DIODE-ZENER;RD8.2MB,7.7-8.7V,200mW,SOT-2	1	S.A	
....4	D6003	0403-001052	DIODE-ZENER;RD8.2MB,7.7-8.7V,200mW,SOT-2	1	S.A	
....4	D6004	0403-001052	DIODE-ZENER;RD8.2MB,7.7-8.7V,200mW,SOT-2	1	S.A	
....4	D6005	0403-001052	DIODE-ZENER;RD8.2MB,7.7-8.7V,200mW,SOT-2	1	S.A	
....4	D6007	0403-001052	DIODE-ZENER;RD8.2MB,7.7-8.7V,200mW,SOT-2	1	S.A	
....4	D6008	0403-001052	DIODE-ZENER;RD8.2MB,7.7-8.7V,200mW,SOT-2	1	S.A	
....4	D6013	0403-001052	DIODE-ZENER;RD8.2MB,7.7-8.7V,200mW,SOT-2	1	S.A	
....4	D6014	0403-001052	DIODE-ZENER;RD8.2MB,7.7-8.7V,200mW,SOT-2	1	S.A	
....4	D6016	0403-001052	DIODE-ZENER;RD8.2MB,7.7-8.7V,200mW,SOT-2	1	S.A	
....4	D6017	0403-001052	DIODE-ZENER;RD8.2MB,7.7-8.7V,200mW,SOT-2	1	S.A	
....4	D6019	0403-001052	DIODE-ZENER;RD8.2MB,7.7-8.7V,200mW,SOT-2	1	S.A	
....4	D6020	0403-001052	DIODE-ZENER;RD8.2MB,7.7-8.7V,200mW,SOT-2	1	S.A	
....4	D7019	0403-001052	DIODE-ZENER;RD8.2MB,7.7-8.7V,200mW,SOT-2	1	S.A	
....4	D7021	0403-001052	DIODE-ZENER;RD8.2MB,7.7-8.7V,200mW,SOT-2	1	S.A	
....4	D7027	0403-001052	DIODE-ZENER;RD8.2MB,7.7-8.7V,200mW,SOT-2	1	S.A	
....4	D7028	0403-001052	DIODE-ZENER;RD8.2MB,7.7-8.7V,200mW,SOT-2	1	S.A	
....4	D7030	0403-001052	DIODE-ZENER;RD8.2MB,7.7-8.7V,200mW,SOT-2	1	S.A	
....4	D7032	0403-001052	DIODE-ZENER;RD8.2MB,7.7-8.7V,200mW,SOT-2	1	S.A	
....4	D7034	0403-001052	DIODE-ZENER;RD8.2MB,7.7-8.7V,200mW,SOT-2	1	S.A	
....4	D8002S	0403-001052	DIODE-ZENER;RD8.2MB,7.7-8.7V,200mW,SOT-2	1	S.A	
....4	D8003S	0403-001052	DIODE-ZENER;RD8.2MB,7.7-8.7V,200mW,SOT-2	1	S.A	
....4	D8010S	0403-001052	DIODE-ZENER;RD8.2MB,7.7-8.7V,200mW,SOT-2	1	S.A	
....4	D8025S	0403-001052	DIODE-ZENER;RD8.2MB,7.7-8.7V,200mW,SOT-2	1	S.A	
....4	D8026S	0403-001052	DIODE-ZENER;RD8.2MB,7.7-8.7V,200mW,SOT-2	1	S.A	
....4	D8027S	0403-001052	DIODE-ZENER;RD8.2MB,7.7-8.7V,200mW,SOT-2	1	S.A	
....4	D8028S	0403-001052	DIODE-ZENER;RD8.2MB,7.7-8.7V,200mW,SOT-2	1	S.A	
....4	D5002	0403-001425	DIODE-ZENER;BZX84C33,31-35V,350mW,SOT-23	1	S.A	
....4	D6001	0406-001172	DIODE-TVS;CDS3C30GTH,48/-/50V,SMD	1	S.A	
....4	D6006	0406-001172	DIODE-TVS;CDS3C30GTH,48/-/50V,SMD	1	S.A	
....4	D6009	0406-001172	DIODE-TVS;CDS3C30GTH,48/-/50V,SMD	1	S.A	
....4	D6010	0406-001172	DIODE-TVS;CDS3C30GTH,48/-/50V,SMD	1	S.A	
....4	D6011	0406-001172	DIODE-TVS;CDS3C30GTH,48/-/50V,SMD	1	S.A	
....4	D6012	0406-001172	DIODE-TVS;CDS3C30GTH,48/-/50V,SMD	1	S.A	
....4	D6015	0406-001172	DIODE-TVS;CDS3C30GTH,48/-/50V,SMD	1	S.A	
....4	D6018	0406-001172	DIODE-TVS;CDS3C30GTH,48/-/50V,SMD	1	S.A	
....4	D6021	0406-001172	DIODE-TVS;CDS3C30GTH,48/-/50V,SMD	1	S.A	
....4	D6022	0406-001172	DIODE-TVS;CDS3C30GTH,48/-/50V,SMD	1	S.A	
....4	D6023	0406-001172	DIODE-TVS;CDS3C30GTH,48/-/50V,SMD	1	S.A	
....4	D6024	0406-001172	DIODE-TVS;CDS3C30GTH,48/-/50V,SMD	1	S.A	
....4	D6025	0406-001172	DIODE-TVS;CDS3C30GTH,48/-/50V,SMD	1	S.A	
....4	D7001	0406-001172	DIODE-TVS;CDS3C30GTH,48/-/50V,SMD	1	S.A	
....4	D7003	0406-001172	DIODE-TVS;CDS3C30GTH,48/-/50V,SMD	1	S.A	

5. Exploded View & Part List

Level	Location No.	Code No.	Description & Specification	Q'ty	SA/SNA	Remark
....4	D7010	0406-001172	DIODE-TVS;CDS3C30GTH,48/-/50V,SMD	1	S.A	
....4	D7024	0406-001172	DIODE-TVS;CDS3C30GTH,48/-/50V,SMD	1	S.A	
....4	D7041	0406-001172	DIODE-TVS;CDS3C30GTH,48/-/50V,SMD	1	S.A	
....4	D7042	0406-001172	DIODE-TVS;CDS3C30GTH,48/-/50V,SMD	1	S.A	
....4	D8004S	0406-001172	DIODE-TVS;CDS3C30GTH,48/-/50V,SMD	1	S.A	
....4	D8005S	0406-001172	DIODE-TVS;CDS3C30GTH,48/-/50V,SMD	1	S.A	
....4	D8008S	0406-001172	DIODE-TVS;CDS3C30GTH,48/-/50V,SMD	1	S.A	
....4	D8009S	0406-001172	DIODE-TVS;CDS3C30GTH,48/-/50V,SMD	1	S.A	
....4	D8015S	0406-001172	DIODE-TVS;CDS3C30GTH,48/-/50V,SMD	1	S.A	
....4	D8021S	0406-001172	DIODE-TVS;CDS3C30GTH,48/-/50V,SMD	1	S.A	
....4	D8022S	0406-001172	DIODE-TVS;CDS3C30GTH,48/-/50V,SMD	1	S.A	
....4	D8023S	0406-001172	DIODE-TVS;CDS3C30GTH,48/-/50V,SMD	1	S.A	
....4	D8024S	0406-001172	DIODE-TVS;CDS3C30GTH,48/-/50V,SMD	1	S.A	
....4	D7014	0406-001200	DIODE-TVS;RCLAMP0504F,6/-/-V,150W,SC-70	1	S.A	
....4	D7051	0406-001271	DIODE-TVS;RCLAMP0524P,6/-/-V,150W,SLP251	1	S.A	
....4	D7052	0406-001271	DIODE-TVS;RCLAMP0524P,6/-/-V,150W,SLP251	1	S.A	
....4	D7053	0406-001271	DIODE-TVS;RCLAMP0524P,6/-/-V,150W,SLP251	1	S.A	
....4	D7054	0406-001271	DIODE-TVS;RCLAMP0524P,6/-/-V,150W,SLP251	1	S.A	
....4	D8100S	0406-001271	DIODE-TVS;RCLAMP0524P,6/-/-V,150W,SLP251	1	S.A	
....4	D8101S	0406-001271	DIODE-TVS;RCLAMP0524P,6/-/-V,150W,SLP251	1	S.A	
....4	D7038	0407-000123	DIODE-ARRAY;DAN202K,80V,100mA,CA2-3,SOT-	1	S.A	
....4	D7039	0407-000123	DIODE-ARRAY;DAN202K,80V,100mA,CA2-3,SOT-	1	S.A	
....4	Q1000	0501-000434	TR-SMALL SIGNAL;KTC3875S-GR,NPN,150mW,SO	1	S.A	
....4	Q9004	0501-000434	TR-SMALL SIGNAL;KTC3875S-GR,NPN,150mW,SO	1	S.A	
....4	Q9005	0501-000434	TR-SMALL SIGNAL;KTC3875S-GR,NPN,150mW,SO	1	S.A	
....4	Q2003	0501-000445	TR-SMALL SIGNAL;KTC3875S-Y,NPN,150mW,SOT	1	S.A	
....4	Q3001L	0501-000445	TR-SMALL SIGNAL;KTC3875S-Y,NPN,150mW,SOT	1	S.A	
....4	Q5001	0501-000445	TR-SMALL SIGNAL;KTC3875S-Y,NPN,150mW,SOT	1	S.A	
....4	Q7003	0501-000445	TR-SMALL SIGNAL;KTC3875S-Y,NPN,150mW,SOT	1	S.A	
....4	Q7004	0501-000445	TR-SMALL SIGNAL;KTC3875S-Y,NPN,150mW,SOT	1	S.A	
....4	Q9002	0501-000669	TR-SMALL SIGNAL;KTA1505Y,PNP,150mW,SOT-2	1	S.A	
....4	Q1002L	0501-002080	TR-SMALL SIGNAL;2SC2412K,NPN,200mW,SC-59	1	S.A	
....4	Q1003L	0501-002080	TR-SMALL SIGNAL;2SC2412K,NPN,200mW,SC-59	1	S.A	
....4	Q409	0505-000110	FET-SILICON;2N7002,N,60V,115mA,7.5ohm,0.	1	S.A	
....4	Q409	0505-000110	FET-SILICON;2N7002,N,60V,115mA,7.5ohm,0.	1	S.A	
....4	Q409	0505-000110	FET-SILICON;2N7002,N,60V,115mA,7.5ohm,0.	1	S.A	
....4	Q409	0505-000110	FET-SILICON;2N7002,N,60V,115mA,7.5ohm,0.	1	S.A	
....4	Q409	0505-001165	FET-SILICON;SI3443BDV,P,-20V,+/-4.4A,65mo	1	S.A	
....4	IC104	0801-002633	IC-CMOS LOGIC;7WBD3125,2bit BUS SWITCH,S	1	S.A	
....4	IC104	0801-002633	IC-CMOS LOGIC;7WBD3125,2bit BUS SWITCH,S	1	S.A	
....4	IC2003	0904-001862	IC-I/O SUPPORT CHIP;PCF8574ATS,8Bit,SSOP	1	S.A	
....4	IC6003	1001-000164	IC-ANALOG MULTIPLEX;74HC4052,CMOS,SOP,16	1	S.A	
....4	IC106	1001-001082	IC-VIDEO SWITCH;BA7657F,-,SOP,24P,300MIL	1	S.A	
....4	IC106	1001-001513	IC-VIDEO SWITCH;TMDS351PAG,TQFP,64P,9x9m	1	S.A	
....4	IC6001	1006-001266	IC-LINE TRANSCEIVER;SP3232EEY,TSSOP,16P,	1	S.A	
....4	IC112	1103-000129	IC-EEPROM;24C02,2Kbit,256x8Bit,SOP,8P,5x	1	S.A	
....4	IC112	1103-000129	IC-EEPROM;24C02,2Kbit,256x8Bit,SOP,8P,5x	1	S.A	
....4	IC112	1103-000129	IC-EEPROM;24C02,2Kbit,256x8Bit,SOP,8P,5x	1	S.A	
....4	IC112	1103-000129	IC-EEPROM;24C02,2Kbit,256x8Bit,SOP,8P,5x	1	S.A	
....4	IC112	1103-001406	IC-EEPROM;AT24C512BN-SH25-T,512Kbit,64Kx	1	S.A	
....4	IC201C	1105-001838	IC-DDR SDRAM;EM6A9160TS0A-5G,DDR SDRAM,1	1	S.A	

5. Exploded View & Part List

[illegible]

5. Exploded View & Part List

[illegible]

5. Exploded View & Part List

[illegible]

5. Exploded View & Part List

[illegible]

5. Exploded View & Part List

[illegible]

5. Exploded View & Part List

[illegible]

5. Exploded View & Part List

[illegible]

5. Exploded View & Part List

[illegible]

5. Exploded View & Part List

[illegible]

5. Exploded View & Part List

Level	Location No.	Code No.	Description & Specification	Q'ty	SA/SNA	Remark
....4	R110	2007-001325	R-CHIP;3.3Kohm,5%,1/16W,TP,1005	1	S.N.A	
....4	R110	2007-001433	R-CHIP;12Kohm,1%,1/10W,TP,1608	1	S.A	
....4	R110	2007-007008	R-CHIP;300ohm,5%,1/16W,TP,1005	1	S.N.A	
....4	R110	2007-007008	R-CHIP;300ohm,5%,1/16W,TP,1005	1	S.N.A	
....4	R110	2007-007095	R-CHIP;390ohm,5%,1/16W,TP,1005	1	S.N.A	
....4	R110	2007-007107	R-CHIP;100Kohm,1%,1/16W,TP,1005	1	S.N.A	
....4	R110	2007-007107	R-CHIP;100Kohm,1%,1/16W,TP,1005	1	S.N.A	
....4	R110	2007-007142	R-CHIP;10Kohm,1%,1/16W,TP,1005	1	S.N.A	
....4	R110	2007-007142	R-CHIP;10Kohm,1%,1/16W,TP,1005	1	S.N.A	
....4	R110	2007-007142	R-CHIP;10Kohm,1%,1/16W,TP,1005	1	S.N.A	
....4	R110	2007-007142	R-CHIP;10Kohm,1%,1/16W,TP,1005	1	S.N.A	
....4	R110	2007-007142	R-CHIP;10Kohm,1%,1/16W,TP,1005	1	S.N.A	
....4	R110	2007-007142	R-CHIP;10Kohm,1%,1/16W,TP,1005	1	S.N.A	
....4	R110	2007-007316	R-CHIP;3.3Kohm,1%,1/16W,TP,1005	1	S.N.A	
....4	R110	2007-007318	R-CHIP;1Kohm,1%,1/16W,TP,1005	1	S.N.A	
....4	R110	2007-007318	R-CHIP;1Kohm,1%,1/16W,TP,1005	1	S.N.A	
....4	R110	2007-007318	R-CHIP;1Kohm,1%,1/16W,TP,1005	1	S.N.A	
....4	R110	2007-007318	R-CHIP;1Kohm,1%,1/16W,TP,1005	1	S.N.A	
....4	R110	2007-007334	R-CHIP;200Kohm,1%,1/16W,TP,1005	1	S.N.A	
....4	R110	2007-008015	R-CHIP;75ohm,1%,1/16W,TP,1005	1	S.N.A	
....4	R110	2007-008015	R-CHIP;75ohm,1%,1/16W,TP,1005	1	S.N.A	
....4	R110	2007-008015	R-CHIP;75ohm,1%,1/16W,TP,1005	1	S.N.A	
....4	R110	2007-008015	R-CHIP;75ohm,1%,1/16W,TP,1005	1	S.N.A	
....4	R110	2007-008015	R-CHIP;75ohm,1%,1/16W,TP,1005	1	S.N.A	
....4	R110	2007-008015	R-CHIP;75ohm,1%,1/16W,TP,1005	1	S.N.A	
....4	R110	2007-008015	R-CHIP;75ohm,1%,1/16W,TP,1005	1	S.N.A	
....4	R110	2007-008015	R-CHIP;75ohm,1%,1/16W,TP,1005	1	S.N.A	
....4	R110	2007-008015	R-CHIP;75ohm,1%,1/16W,TP,1005	1	S.N.A	
....4	R110	2007-008015	R-CHIP;75ohm,1%,1/16W,TP,1005	1	S.N.A	
....4	R110	2007-008015	R-CHIP;75ohm,1%,1/16W,TP,1005	1	S.N.A	
....4	R110	2007-008015	R-CHIP;75ohm,1%,1/16W,TP,1005	1	S.N.A	
....4	R110	2007-008015	R-CHIP;75ohm,1%,1/16W,TP,1005	1	S.N.A	
....4	R110	2007-008015	R-CHIP;75ohm,1%,1/16W,TP,1005	1	S.N.A	
....4	R110	2007-008015	R-CHIP;75ohm,1%,1/16W,TP,1005	1	S.N.A	
....4	R110	2007-008015	R-CHIP;75ohm,1%,1/16W,TP,1005	1	S.N.A	
....4	R110	2007-008015	R-CHIP;75ohm,1%,1/16W,TP,1005	1	S.N.A	
....4	R110	2007-008015	R-CHIP;75ohm,1%,1/16W,TP,1005	1	S.N.A	
....4	R110	2007-008015	R-CHIP;75ohm,1%,1/16W,TP,1005	1	S.N.A	
....4	R110	2007-008015	R-CHIP;75ohm,1%,1/16W,TP,1005	1	S.N.A	
....4	R110	2007-008015	R-CHIP;75ohm,1%,1/16W,TP,1005	1	S.N.A	
....4	R110	2007-008015	R-CHIP;75ohm,1%,1/16W,TP,1005	1	S.N.A	
....4	R110	2007-008015	R-CHIP;75ohm,1%,1/16W,TP,1005	1	S.N.A	
....4	R110	2007-008015	R-CHIP;75ohm,1%,1/16W,TP,1005	1	S.N.A	
....4	R110	2007-008015	R-CHIP;75ohm,1%,1/16W,TP,1005	1	S.N.A	
....4	R110	2007-008813	R-CHIP;909ohm,1%,1/16W,TP,1005	1	S.N.A	
....4	R110	2007-009853	R-CHIP;1.6Kohm,1%,1/16W,TP,1005	1	S.A	
....4	R2001	2011-001261	R-NETWORK;33ohm,5%,1/16W,L,CHIP,8P,TP,2.	1	S.A	
....4	R2002	2011-001261	R-NETWORK;33ohm,5%,1/16W,L,CHIP,8P,TP,2.	1	S.A	
....4	R2003	2011-001261	R-NETWORK;33ohm,5%,1/16W,L,CHIP,8P,TP,2.	1	S.A	
....4	R2004	2011-001261	R-NETWORK;33ohm,5%,1/16W,L,CHIP,8P,TP,2.	1	S.A	
....4	R2005	2011-001261	R-NETWORK;33ohm,5%,1/16W,L,CHIP,8P,TP,2.	1	S.A	
....4	R2006	2011-001261	R-NETWORK;33ohm,5%,1/16W,L,CHIP,8P,TP,2.	1	S.A	
....4	R2007	2011-001261	R-NETWORK;33ohm,5%,1/16W,L,CHIP,8P,TP,2.	1	S.A	
....4	R2008	2011-001261	R-NETWORK;33ohm,5%,1/16W,L,CHIP,8P,TP,2.	1	S.A	
....4	C120	2203-000125	C-CER,CHIP;1.2nF,10%,50V,X7R,TP,1608,-	1	S.A	

5. Exploded View & Part List

[illegible]

5. Exploded View & Part List

Level	Location No.	Code No.	Description & Specification	Q'ty	SA/SNA	Remark
....4	C120	2203-000438	C-CER,CHIP;1nF,10%,50V,X7R,1005	1	S.A	
....4	C120	2203-000489	C-CER,CHIP;2.2nF,10%,50V,X7R,1005	1	S.A	
....4	C120	2203-000489	C-CER,CHIP;2.2nF,10%,50V,X7R,1005	1	S.A	
....4	C120	2203-000489	C-CER,CHIP;2.2nF,10%,50V,X7R,1005	1	S.A	
....4	C120	2203-000575	C-CER,CHIP;220nF,10%,25V,X7R,2012	1	S.A	
....4	C120	2203-000575	C-CER,CHIP;220nF,10%,25V,X7R,2012	1	S.A	
....4	C120	2203-000575	C-CER,CHIP;220nF,10%,25V,X7R,2012	1	S.A	
....4	C120	2203-000575	C-CER,CHIP;220nF,10%,25V,X7R,2012	1	S.A	
....4	C120	2203-000575	C-CER,CHIP;220nF,10%,25V,X7R,2012	1	S.A	
....4	C120	2203-000575	C-CER,CHIP;220nF,10%,25V,X7R,2012	1	S.A	
....4	C120	2203-000575	C-CER,CHIP;220nF,10%,25V,X7R,2012	1	S.A	
....4	C120	2203-000627	C-CER,CHIP;0.022nF,5%,50V,C0G,1005	1	S.N.A	
....4	C120	2203-000783	C-CER,CHIP;0.33nF,5%,50V,C0G,1608	1	S.A	
....4	C120	2203-000783	C-CER,CHIP;0.33nF,5%,50V,C0G,1608	1	S.A	
....4	C120	2203-000783	C-CER,CHIP;0.33nF,5%,50V,C0G,1608	1	S.A	
....4	C120	2203-000783	C-CER,CHIP;0.33nF,5%,50V,C0G,1608	1	S.A	
....4	C120	2203-000783	C-CER,CHIP;0.33nF,5%,50V,C0G,1608	1	S.A	
....4	C120	2203-000783	C-CER,CHIP;0.33nF,5%,50V,C0G,1608	1	S.A	
....4	C120	2203-000783	C-CER,CHIP;0.33nF,5%,50V,C0G,1608	1	S.A	
....4	C120	2203-000783	C-CER,CHIP;0.33nF,5%,50V,C0G,1608	1	S.A	
....4	C120	2203-000783	C-CER,CHIP;0.33nF,5%,50V,C0G,1608	1	S.A	
....4	C120	2203-000783	C-CER,CHIP;0.33nF,5%,50V,C0G,1608	1	S.A	
....4	C120	2203-000783	C-CER,CHIP;0.33nF,5%,50V,C0G,1608	1	S.A	
....4	C120	2203-000783	C-CER,CHIP;0.33nF,5%,50V,C0G,1608	1	S.A	
....4	C120	2203-000783	C-CER,CHIP;0.33nF,5%,50V,C0G,1608	1	S.A	
....4	C120	2203-000783	C-CER,CHIP;0.33nF,5%,50V,C0G,1608	1	S.A	
....4	C120	2203-000783	C-CER,CHIP;0.33nF,5%,50V,C0G,1608	1	S.A	
....4	C120	2203-000783	C-CER,CHIP;0.33nF,5%,50V,C0G,1608	1	S.A	
....4	C120	2203-000783	C-CER,CHIP;0.33nF,5%,50V,C0G,1608	1	S.A	
....4	C120	2203-000783	C-CER,CHIP;0.33nF,5%,50V,C0G,1608	1	S.A	
....4	C120	2203-000783	C-CER,CHIP;0.33nF,5%,50V,C0G,1608	1	S.A	
....4	C120	2203-000851	C-CER,CHIP;0.039nF,5%,50V,C0G,1608	1	S.A	
....4	C120	2203-000851	C-CER,CHIP;0.039nF,5%,50V,C0G,1608	1	S.A	
....4	C120	2203-000888	C-CER,CHIP;4.7nF,10%,50V,X7R,1608	1	S.A	
....4	C120	2203-000888	C-CER,CHIP;4.7nF,10%,50V,X7R,1608	1	S.A	
....4	C120	2203-000975	C-CER,CHIP;47nF,10%,25V,X7R,TP,1608,-	1	S.A	
....4	C120	2203-000995	C-CER,CHIP;0.047nF,5%,50V,C0G,1005	1	S.A	
....4	C120	2203-001072	C-CER,CHIP;0.056nF,5%,50V,NP0,1005	1	S.A	
....4	C120	2203-001153	C-CER,CHIP;0.068nF,5%,50V,NP0,1005	1	S.A	
....4	C120	2203-001153	C-CER,CHIP;0.068nF,5%,50V,NP0,1005	1	S.A	
....4	C120	2203-001412	C-CER,CHIP;0.03nF,5%,50V,NP0,TP,1005	1	S.N.A	
....4	C120	2203-001412	C-CER,CHIP;0.03nF,5%,50V,NP0,TP,1005	1	S.N.A	
....4	C120	2203-001598	C-CER,CHIP;2200nF,+80-20%,16V,Y5V,2012	1	S.A	
....4	C120	2203-001598	C-CER,CHIP;2200nF,+80-20%,16V,Y5V,2012	1	S.A	
....4	C120	2203-001598	C-CER,CHIP;2200nF,+80-20%,16V,Y5V,2012	1	S.A	
....4	C120	2203-001598	C-CER,CHIP;2200nF,+80-20%,16V,Y5V,2012	1	S.A	
....4	C120	2203-001598	C-CER,CHIP;2200nF,+80-20%,16V,Y5V,2012	1	S.A	
....4	C120	2203-001598	C-CER,CHIP;2200nF,+80-20%,16V,Y5V,2012	1	S.A	
....4	C120	2203-001598	C-CER,CHIP;2200nF,+80-20%,16V,Y5V,2012	1	S.A	
....4	C120	2203-001598	C-CER,CHIP;2200nF,+80-20%,16V,Y5V,2012	1	S.A	
....4	C120	2203-001598	C-CER,CHIP;2200nF,+80-20%,16V,Y5V,2012	1	S.A	
....4	C120	2203-002525	C-CER,CHIP;0.56nF,10%,50V,X7R,TP,1005	1	S.N.A	
....4	C120	2203-002525	C-CER,CHIP;0.56nF,10%,50V,X7R,TP,1005	1	S.N.A	
....4	C120	2203-002525	C-CER,CHIP;0.56nF,10%,50V,X7R,TP,1005	1	S.N.A	
....4	C120	2203-002525	C-CER,CHIP;0.56nF,10%,50V,X7R,TP,1005	1	S.N.A	
....4	C120	2203-005221	C-CER,CHIP;15nF,10%,50V,X7R,1608	1	S.A	

5. Exploded View & Part List

[illegible]

5. Exploded View & Part List

[illegible]

5. Exploded View & Part List

[illegible]

5. Exploded View & Part List

[illegible]

5. Exploded View & Part List

Level	Location No.	Code No.	Description & Specification	Q'ty	SA/SNA	Remark
....4	C120	2203-006361	C-CER,CHIP;10000nF,10%,10V,X5R,2012	1	S.A	
....4	C120	2203-006361	C-CER,CHIP;10000nF,10%,10V,X5R,2012	1	S.A	
....4	C120	2203-006361	C-CER,CHIP;10000nF,10%,10V,X5R,2012	1	S.A	
....4	C120	2203-006361	C-CER,CHIP;10000nF,10%,10V,X5R,2012	1	S.A	
....4	C120	2203-006361	C-CER,CHIP;10000nF,10%,10V,X5R,2012	1	S.A	
....4	C120	2203-006361	C-CER,CHIP;10000nF,10%,10V,X5R,2012	1	S.A	
....4	C120	2203-006361	C-CER,CHIP;10000nF,10%,10V,X5R,2012	1	S.A	
....4	C120	2203-006361	C-CER,CHIP;10000nF,10%,10V,X5R,2012	1	S.A	
....4	C120	2203-006361	C-CER,CHIP;10000nF,10%,10V,X5R,2012	1	S.A	
....4	C120	2203-006361	C-CER,CHIP;10000nF,10%,10V,X5R,2012	1	S.A	
....4	C120	2203-006361	C-CER,CHIP;10000nF,10%,10V,X5R,2012	1	S.A	
....4	C120	2203-006361	C-CER,CHIP;10000nF,10%,10V,X5R,2012	1	S.A	
....4	C120	2203-006361	C-CER,CHIP;10000nF,10%,10V,X5R,2012	1	S.A	
....4	C120	2203-006361	C-CER,CHIP;10000nF,10%,10V,X5R,2012	1	S.A	
....4	C120	2203-006361	C-CER,CHIP;10000nF,10%,10V,X5R,2012	1	S.A	
....4	C120	2203-006361	C-CER,CHIP;10000nF,10%,10V,X5R,2012	1	S.A	
....4	C120	2203-006361	C-CER,CHIP;10000nF,10%,10V,X5R,2012	1	S.A	
....4	C120	2203-006361	C-CER,CHIP;10000nF,10%,10V,X5R,2012	1	S.A	
....4	C120	2203-006361	C-CER,CHIP;10000nF,10%,10V,X5R,2012	1	S.A	
....4	C120	2203-006361	C-CER,CHIP;10000nF,10%,10V,X5R,2012	1	S.A	
....4	C120	2203-006361	C-CER,CHIP;10000nF,10%,10V,X5R,2012	1	S.A	
....4	C120	2203-006361	C-CER,CHIP;10000nF,10%,10V,X5R,2012	1	S.A	
....4	C120	2203-006361	C-CER,CHIP;10000nF,10%,10V,X5R,2012	1	S.A	
....4	C120	2203-006361	C-CER,CHIP;10000nF,10%,10V,X5R,2012	1	S.A	
....4	C120	2203-006361	C-CER,CHIP;10000nF,10%,10V,X5R,2012	1	S.A	
....4	C120	2203-006361	C-CER,CHIP;10000nF,10%,10V,X5R,2012	1	S.A	
....4	C120	2203-006399	C-CER,CHIP;1000nF,10%,6.3V,X5R,1005	1	S.A	
....4	C120	2203-006399	C-CER,CHIP;1000nF,10%,6.3V,X5R,1005	1	S.A	
....4	C120	2203-006399	C-CER,CHIP;1000nF,10%,6.3V,X5R,1005	1	S.A	
....4	C120	2203-006399	C-CER,CHIP;1000nF,10%,6.3V,X5R,1005	1	S.A	
....4	C120	2203-006399	C-CER,CHIP;1000nF,10%,6.3V,X5R,1005	1	S.A	
....4	C120	2203-006399	C-CER,CHIP;1000nF,10%,6.3V,X5R,1005	1	S.A	
....4	C120	2203-006399	C-CER,CHIP;1000nF,10%,6.3V,X5R,1005	1	S.A	
....4	C120	2203-006399	C-CER,CHIP;1000nF,10%,6.3V,X5R,1005	1	S.A	
....4	C120	2203-007176	C-CER,CHIP;10000nF,10%,16V,X5R,TP,2012 (1	S.N.A	
....4	C120	2203-007176	C-CER,CHIP;10000nF,10%,16V,X5R,TP,2012 (1	S.N.A	
....4	C9014	2402-001323	C-AL,SMD;100uF,20%,25V,LZ,TP,6.3x8mm	1	S.A	
....4	C9017	2402-001323	C-AL,SMD;100uF,20%,25V,LZ,TP,6.3x8mm	1	S.A	
....4	C1086	2409-001129	C-POLYMER ,CHIP;100uF,20%,6.3V,WT,TP,3.5	1	S.A	
....4	T0052	2703-000158	INDUCTOR-SMD;1uH,10%,2012	1	S.A	

5. Exploded View & Part List

Level	Location No.	Code No.	Description & Specification	Q'ty	SA/SNA	Remark
....4	T0052	2703-000158	INDUCTOR-SMD;1uH,10%,2012	1	S.A	
....4	T0052	2703-000158	INDUCTOR-SMD;1uH,10%,2012	1	S.A	
....4	T0052	2703-000158	INDUCTOR-SMD;1uH,10%,2012	1	S.A	
....4	T0052	2703-000398	INDUCTOR-SMD;10uH,10%,3225	1	S.A	
....4	T0052	2703-000398	INDUCTOR-SMD;10uH,10%,3225	1	S.A	
....4	T0052	2703-000398	INDUCTOR-SMD;10uH,10%,3225	1	S.A	
....4	T0052	2703-000398	INDUCTOR-SMD;10uH,10%,3225	1	S.A	
....4	T0052	2703-000398	INDUCTOR-SMD;10uH,10%,3225	1	S.A	
....4	T0052	2703-000398	INDUCTOR-SMD;10uH,10%,3225	1	S.A	
....4	T0052	2703-000398	INDUCTOR-SMD;10uH,10%,3225	1	S.A	
....4	T0052	2703-000398	INDUCTOR-SMD;10uH,10%,3225	1	S.A	
....4	T0052	2703-000398	INDUCTOR-SMD;10uH,10%,3225	1	S.A	
....4	T0052	2703-000398	INDUCTOR-SMD;10uH,10%,3225	1	S.A	
....4	T0052	2703-000398	INDUCTOR-SMD;10uH,10%,3225	1	S.A	
....4	T0052	2703-000398	INDUCTOR-SMD;10uH,10%,3225	1	S.A	
....4	T0052	2703-000398	INDUCTOR-SMD;10uH,10%,3225	1	S.A	
....4	T0052	2703-000398	INDUCTOR-SMD;10uH,10%,3225	1	S.A	
....4	T0052	2703-000398	INDUCTOR-SMD;10uH,10%,3225	1	S.A	
....4	T0052	2703-000398	INDUCTOR-SMD;10uH,10%,3225	1	S.A	
....4	T0052	2703-000398	INDUCTOR-SMD;10uH,10%,3225	1	S.A	
....4	T0052	2703-000417	INDUCTOR-SMD;220uH,5%,3225	1	S.A	
....4	T0052	2703-001426	INDUCTOR-SMD;680uH,20%,7070	1	S.A	
....4	T0052	2703-001778	INDUCTOR-SMD;3.3uH,20%,3225	1	S.A	
....4	T0052	2703-001778	INDUCTOR-SMD;3.3uH,20%,3225	1	S.A	
....4	L9001	2704-000018	INDUCTOR-SMD-ARRAY;15uH,2000mA,2,0.124oh	1	S.N.A	
....4	L9002	2704-000018	INDUCTOR-SMD-ARRAY;15uH,2000mA,2,0.124oh	1	S.N.A	
....4	X202	2801-003773	CRYSTAL-SMD;12MHz,30ppm,28-AAN,20pF,50oh	1	S.A	
....4	X202	2801-004604	CRYSTAL-SMD;24.69MHz,30ppm,27pF,40ohm,TP	1	S.A	
....4	T0568	3301-000314	BEAD-SMD;120ohm,1.6x0.8x0.8mm,-,-,-	1	S.N.A	
....4	T0568	3301-000314	BEAD-SMD;120ohm,1.6x0.8x0.8mm,-,-,-	1	S.N.A	
....4	T0568	3301-001145	BEAD-SMD;60ohm,4516,TP,70ohm/45MHz,82ohm	1	S.N.A	
....4	T0568	3301-001145	BEAD-SMD;60ohm,4516,TP,70ohm/45MHz,82ohm	1	S.N.A	
....4	T0568	3301-001145	BEAD-SMD;60ohm,4516,TP,70ohm/45MHz,82ohm	1	S.N.A	
....4	T0568	3301-001145	BEAD-SMD;60ohm,4516,TP,70ohm/45MHz,82ohm	1	S.N.A	
....4	T0568	3301-001145	BEAD-SMD;60ohm,4516,TP,70ohm/45MHz,82ohm	1	S.N.A	
....4	T0568	3301-001145	BEAD-SMD;60ohm,4516,TP,70ohm/45MHz,82ohm	1	S.N.A	
....4	T0568	3301-001145	BEAD-SMD;60ohm,4516,TP,70ohm/45MHz,82ohm	1	S.N.A	
....4	T0568	3301-001145	BEAD-SMD;60ohm,4516,TP,70ohm/45MHz,82ohm	1	S.N.A	
....4	T0568	3301-001145	BEAD-SMD;60ohm,4516,TP,70ohm/45MHz,82ohm	1	S.N.A	
....4	T0568	3301-001145	BEAD-SMD;60ohm,4516,TP,70ohm/45MHz,82ohm	1	S.N.A	
....4	T0568	3301-001145	BEAD-SMD;60ohm,4516,TP,70ohm/45MHz,82ohm	1	S.N.A	
....4	T0568	3301-001145	BEAD-SMD;60ohm,4516,TP,70ohm/45MHz,82ohm	1	S.N.A	
....4	T0568	3301-001145	BEAD-SMD;60ohm,4516,TP,70ohm/45MHz,82ohm	1	S.N.A	
....4	T0568	3301-001145	BEAD-SMD;60ohm,4516,TP,70ohm/45MHz,82ohm	1	S.N.A	
....4	T0568	3301-001145	BEAD-SMD;60ohm,4516,TP,70ohm/45MHz,82ohm	1	S.N.A	
....4	T0568	3301-001145	BEAD-SMD;60ohm,4516,TP,70ohm/45MHz,82ohm	1	S.N.A	
....4	T0568	3301-001145	BEAD-SMD;60ohm,4516,TP,70ohm/45MHz,82ohm	1	S.N.A	
....4	T0568	3301-001236	BEAD-SMD;60ohm,1608,-,-,-	1	S.N.A	
....4	T0568	3301-001236	BEAD-SMD;60ohm,1608,-,-,-	1	S.N.A	
....4	T0568	3301-001236	BEAD-SMD;60ohm,1608,-,-,-	1	S.N.A	
....4	T0568	3301-001236	BEAD-SMD;60ohm,1608,-,-,-	1	S.N.A	
....4	T0568	3301-001236	BEAD-SMD;60ohm,1608,-,-,-	1	S.N.A	
....4	T0568	3301-001236	BEAD-SMD;60ohm,1608,-,-,-	1	S.N.A	
....4	T0568	3301-001236	BEAD-SMD;60ohm,1608,-,-,-	1	S.N.A	
....4	T0568	3301-001236	BEAD-SMD;60ohm,1608,-,-,-	1	S.N.A	
....4	T0568	3301-001324	BEAD-SMD;15ohm,2012,600mA,TP,,,0.1ohm	1	S.A	

Level	Location No.	Code No.	Description & Specification	Q'ty	SA/SNA	Remark
....4	T0568	3301-001324	BEAD-SMD;15ohm,2012,600mA,TP,,,0.1ohm	1	S.A	
....4	T0568	3301-001324	BEAD-SMD;15ohm,2012,600mA,TP,,,0.1ohm	1	S.A	
....4	T0568	3301-001324	BEAD-SMD;15ohm,2012,600mA,TP,,,0.1ohm	1	S.A	
....4	T0568	3301-001404	BEAD-SMD;30ohm,2012,TP,15.9OHM/30MHz	1	S.A	
....4	T0568	3301-001404	BEAD-SMD;30ohm,2012,TP,15.9OHM/30MHz	1	S.A	
....4	T0568	3301-001404	BEAD-SMD;30ohm,2012,TP,15.9OHM/30MHz	1	S.A	
....4	T0568	3301-001404	BEAD-SMD;30ohm,2012,TP,15.9OHM/30MHz	1	S.A	
....4	T0568	3301-001404	BEAD-SMD;30ohm,2012,TP,15.9OHM/30MHz	1	S.A	
....4	T0568	3301-001404	BEAD-SMD;30ohm,2012,TP,15.9OHM/30MHz	1	S.A	
....4	T0568	3301-001526	BEAD-SMD;10ohm,1.6x0.8x0.8mm,1000mA,TP,,	1	S.N.A	
....4	T0568	3301-001526	BEAD-SMD;10ohm,1.6x0.8x0.8mm,1000mA,TP,,	1	S.N.A	
....4	T0568	3301-001526	BEAD-SMD;10ohm,1.6x0.8x0.8mm,1000mA,TP,,	1	S.N.A	
....4	T0568	3301-001526	BEAD-SMD;10ohm,1.6x0.8x0.8mm,1000mA,TP,,	1	S.N.A	
....4	T0568	3301-001526	BEAD-SMD;10ohm,1.6x0.8x0.8mm,1000mA,TP,,	1	S.N.A	
....4	T0568	3301-001526	BEAD-SMD;10ohm,1.6x0.8x0.8mm,1000mA,TP,,	1	S.N.A	
....4	T0568	3301-001560	BEAD-SMD;80ohm,1.6X0.8X0.8mm,200mA,TP,,,	1	S.N.A	
....4	T0568	3301-001560	BEAD-SMD;80ohm,1.6X0.8X0.8mm,200mA,TP,,,	1	S.N.A	
....4	T0568	3301-001560	BEAD-SMD;80ohm,1.6X0.8X0.8mm,200mA,TP,,,	1	S.N.A	
....4	T0568	3301-001560	BEAD-SMD;80ohm,1.6X0.8X0.8mm,200mA,TP,,,	1	S.N.A	
....4	T0568	3301-001560	BEAD-SMD;80ohm,1.6X0.8X0.8mm,200mA,TP,,,	1	S.N.A	
....4	T0568	3301-001560	BEAD-SMD;80ohm,1.6X0.8X0.8mm,200mA,TP,,,	1	S.N.A	
....4	T0568	3301-001560	BEAD-SMD;80ohm,1.6X0.8X0.8mm,200mA,TP,,,	1	S.N.A	
....4	T0568	3301-001560	BEAD-SMD;80ohm,1.6X0.8X0.8mm,200mA,TP,,,	1	S.N.A	
....4	T0568	3301-001560	BEAD-SMD;80ohm,1.6X0.8X0.8mm,200mA,TP,,,	1	S.N.A	
....4	T0313	3404-001207	SWITCH-TACT;12V,50mA,160gf,6.2X6.2,SPST	1	S.A	
....4	JA7001	3701-001367	CONNECTOR-HDMI;19P,2R,FEMALE,SMD,AU	1	S.A	
....4	JA7002	3701-001367	CONNECTOR-HDMI;19P,2R,FEMALE,SMD,AU	1	S.A	
....4	T0077	BN41-00963A	PCB MAIN;FR-4,4,1.2T,192*158	1	S.N.A	
....4	M0107	BN61-03858A	BRACKET-PCB;L450,BRASS(H62Y),T0.4,5mm,7m	1	S.N.A	
....4	M0107	BN61-03858A	BRACKET-PCB;L450,BRASS(H62Y),T0.4,5mm,7m	1	S.N.A	
....4	M0107	BN61-03858A	BRACKET-PCB;L450,BRASS(H62Y),T0.4,5mm,7m	1	S.N.A	
....4	M0107	BN61-03858A	BRACKET-PCB;L450,BRASS(H62Y),T0.4,5mm,7m	1	S.N.A	
....4	M0018	BN97-02014A	ASSY MICOM;T-CRLAUSC-XXXX,N45A,2007.11.0	1	S.N.A	
....5	IC2005	1107-001735	IC-NOR FLASH;MX25L3205DM2I-12G,32Mbit,16	1	S.A	
....4	R110	2007-007587	R-CHIP;3.6Kohm,1%,1/16W,TP,1005	1	S.N.A	
....4	Q2005	0504-001129	TR-DIGITAL;KRC104S-I,NPN,200MW,47K/47K,S	1	S.A	
...3	CIS3	BN40-00125A	TUNER;DTSV20FTL111A,DTSV20FTL111A,NTSC/V	1	S.A	
...3		BN61-02470D	HOLDER-CLAMP DMD;NYLON 6/6,NATURAL,DACN-	1	S.N.A	
0.1	A/SHIELD	BN91-01978A	ASSY SHIELD-SQT;LN32A450C1DXZA	1	S.N.A	
..2	M0081	6003-000115	SCREW-TAPTITE;BH,+,B,M3,L6,ZPC(BLK),SWRC	4	S.A	
..2	M0081	6003-000115	SCREW-TAPTITE;BH,+,B,M3,L6,ZPC(BLK),SWRC	6	S.A	
..2	M0081	6003-000337	SCREW-TAPTITE;BH,+,S,M4,L10,ZPC(BLK),SWR	4	S.A	
..2	M0081	6003-001188	SCREW-TAPTITE;BH,+,B,M4,L10,ZPC(WHT),S	2	S.A	
..2	M0081	6003-001188	SCREW-TAPTITE;BH,+,B,M4,L10,ZPC(WHT),S	2	S.A	
..2	M0081	6003-001188	SCREW-TAPTITE;BH,+,B,M4,L10,ZPC(WHT),S	8	S.A	
..2	M0081	6003-001439	SCREW-TAPTITE;BH,+,S,M4,L8,ZPC(WHT),SW	1	S.N.A	
..2	M0081	6003-001439	SCREW-TAPTITE;BH,+,S,M4,L8,ZPC(WHT),SW	1	S.N.A	
..2	M2893	BH39-00362C	LEAD CONNECTOR;Beethoven,UL1007#26,5P,30	1	S.A	
..2	M0258	BN39-00615Q	CBF HARNESS-INLET SOCKET;LN40A450C1D,UL1	1	S.A	
..2	M2893	BN39-00802C	LEAD CONNECTOR;HPT4264H,UL1617#22,24P/24	1	S.A	

5. Exploded View & Part List

Level	Location No.	Code No.	Description & Specification	Q'ty	SA/SNA	Remark
..2	M2893	BN39-00849G	LEAD CONNECTOR;LE26A450,UL1007 #26,14P,2	1	S.A	
..2	T0764	BN44-00214A	SMPS-LCDTV;MK32P5B,DYREL,AC/DC,137W,AC10	1	S.A	
..2	M0114	BN61-02500A	HOLDER-WIRE;NYLON6.6,NATURAL	4	S.N.A	
..2	M0115	BN61-02947A	BRACKET-STAND LINK;JASMINE 32",SECC,T1.6	1	S.N.A	
..2	M0146	BN61-03265A	BRACKET-PANEL SIDE;JASMINE,SECC 1.2,AMLC	2	S.N.A	
..2	T0447	BN96-06958A	ASSY BRACKET P-PANEL;32L450,AM,CMO,AUO,G	1	S.N.A	
...3	M0131	AA63-01236A	GASKET;FIRENZE,Conductive Fabric,3mm,12m	1	S.N.A	
...3	M0131	AA63-01401A	GASKET;LE40R71BX,Conductive Fabric,22mm,	2	S.N.A	
...3	M0131	AA63-01437A	GASKET;Bordeaux,Conductive Fabric,20mm,9	1	S.N.A	
...3	M0146	BN61-03678A	BRACKET-PANEL TOP;32L450,GPSP,T1.0	1	S.N.A	
...3	B/GMAIN	BN61-03683A	BRACKET-GUIDE MAIN;L450 32INCH,GPSP,T1.0	1	S.N.A	
...3	B/PBOTTOM	BN61-03685A	BRACKET-PANEL BOTTOM;L450 32INCH,GPSP,T1	1	S.N.A	
...3	B/GPRIGHT	BN61-03686A	BRACKET-GUIDE POWER;L450 32INCH,gpsp,T1.	1	S.N.A	
...3	B/GPLEFT	BN61-03691A	BRACKET-GUIDE POWER;L450 32INCH,gpsp,T1.	1	S.N.A	
...3	M0081	6003-000115	SCREW-TAPTITE;BH,+,B,M3,L6,ZPC(BLK),SWRC	2	S.A	
...3	M0081	6003-000115	SCREW-TAPTITE;BH,+,B,M3,L6,ZPC(BLK),SWRC	2	S.A	
...3	M0081	6003-000115	SCREW-TAPTITE;BH,+,B,M3,L6,ZPC(BLK),SWRC	2	S.A	
..2	M2893	BN39-00875B	LEAD CONNECTOR;LN32A450C1D,UL1571#30,30P	1	S.A	
..2	M0254	BN61-03699F	HOLDER-SIDE AV;32L450,UO,HIPS,V0,-,-,B	1	S.N.A	
0.1	A/LCD	BN91-02064F	ASSY LCD-AMLCD;LE32A457C1DXXC	1	S.N.A	
..2	M0215	BN07-00538A	LCD-PANEL;LTF320AB01	1	S.A	
0.1	M0113	BN92-03174A	ASSY P/MATERIAL;32L450,UO,,,	1	S.N.A	
..2	T0003	BH69-00418A	BAG WRAPPING;E770S/UM,LDPE,-,1828M,762,-	3.35	S.N.A	
..2	T0524	6902-000738	BAG PE;HDPE/HDPE/NITRON,T0.015/T0.015/T1	1	S.N.A	
0.1	M0045	BN92-03213C	ASSY ACCESSORY;LN32A450C1DXZA	1	S.N.A	
..2	M0045	BN96-06514A	ASSY ACCESSORY-CABLE;CORAL/ZA,ZC,ZX	1	S.A	
...3	T0268	3903-000144	CBF-POWER CORD;DT,US,BP3/Y,U(IEC C13-RA)	1	S.A	
...3	T0524	6902-000110	BAG PE;LDPE,T0.05,W250,L400,TRP,28,2,-,9	1	S.N.A	
...3	CLOTH	BN63-01798A	CLOTH-CLEAN;RE40**,CLOTH,180,200,RHCM	1	S.N.A	
...3	T0074	BN59-00687A	REMOCON;TM-96B,49,AMERICA	1	S.A	
..2	M0045	BN96-06913A	ASSY ACCESSORY-MANUAL;LN32A450C1DXZA	1	S.A	
...3	T0524	6902-000110	BAG PE;LDPE,T0.05,W250,L400,TRP,28,2,-,9	1	S.N.A	
...3	REV 06	AA68-00371C	MARK RECYCLE-CARD WARRANTY,07,,SEA,W/P10	1	S.N.A	
...3	M0560	BN96-01800A	ASSY ACCESSORY-SCREW ZIPPER;ROME32,-,-,-	1	S.N.A	
...4	T0081	6002-001294	SCREW-TAPPING;BH,+,M4,L16,ZPC(BLK)	4	S.A	
...4	ACCESSORY	6902-000683	BAG ZIPPER;LDPE,T0.05,W60,L60,TRP,-,-,2-	1	S.N.A	
...3	M0560	BN96-01800D	ASSY ACCESSORY-SCREW ZIPPER;CORAL,Withou	1	S.N.A	
...4	M0081	6003-001334	SCREW-TAPTITE;BH,+,S,M4,L14,ZPC(BLK),SWR	3	S.N.A	
...4	B/ZIPPER	6902-000683	BAG ZIPPER;LDPE,T0.05,W60,L60,TRP,-,-,2-	1	S.N.A	
...3	M/STAND	BN68-01402A	MANUAL FLYER-STAND GUIDE;COMM,SAMSUNG,En	1	S.N.A	
...3	T0531	BN63-04269A	COVER-BOTTOM;22,26,32L450,HIPS,-,-,-,V0,	1	S.N.A	
...3		AA68-03242L	MANUAL FLYER-02,SAFETY GUIDE;comm,Samsun	1	S.N.A	
...3	M0156	BN68-01395A	MANUAL USERS-01;COMM,SAMSUNG,Eng/Spa,N.A	1	S.N.A	
...3		BN68-01396A	MANUAL FLYER-QSG;COMM,SAMSUNG,Eng,N.Amer	1	S.N.A	
...3		BN68-01600A	MANUAL FLYER-01,QSG;COMM,SAMSUNG,Eng,N/A	1	S.N.A	
..2		BN68-01402A	MANUAL FLYER-STAND GUIDE;COMM,SAMSUNG,En	1	S.N.A	
0.1	M0250	BN81-01705A	A/S-T-CON BOARD;LTF320AB01-A01,00538A,-,	1	S.A	

5. Exploded View & Part List

Level	Location No.	Code No.	Description & Specification	Q'ty	SA/SNA	Remark
0.1	M0215	BN81-01776A	A/S-INVERTER BOARD;LTF320AB01-A,BN07-005	1	S.A	

5-4. LN37A450C1D Parts List

Level	Location No.	Code No.	Description & Specification	Q'ty	SA/SNA	Remark
		LN37A450C1DXZC	LN37A450C1D,N45B/37AC1-GCR,37,LCD-TV,CAN			
0.1	M0001	BN90-01502A	ASSY COVER FRONT;37L450,UO,,,	1	S.N.A	
..2	T0175	BN96-06818A	ASSY SPEAKER P;8ohm,CORAL,LCD,PDP,10W,4p	1	S.A	
..2	T0003	BN96-06785J	ASSY COVER P-FRONT;37L450,UO,PC+ABS,V0,B	1	S.A	
...3	M0081	6003-001188	SCREW-TAPTITE;BH,+,-,B,M4,L10,ZPC(WHT),S	1	S.A	
...3	M0081	6003-001188	SCREW-TAPTITE;BH,+,-,B,M4,L10,ZPC(WHT),S	2	S.A	
...3	M0279	AA63-01637A	FELT;50P9,FELT,0.5,10,80	1	S.N.A	
...3	CCM1	BN63-02183G	COVER-SHEET;Rhcm,PE Vinyl,T0.05,1100mm,2	0.992	S.N.A	
...3	M0112	BN63-04169A	COVER-FRONT;37L450,UO,PC+ABS,-,-,-,V0,-,	1	S.N.A	
...3	T0059	BN64-00379A	INDICATOR LED;ROME-II,23,PC,CLEAR	1	S.N.A	
...3	T0061	BN64-00453A	WINDOW-REMOCON;32R71,PC,VIOLET,DIFFUSER(1	S.N.A	
...3	T0022	BN64-00755A	KNOB-CONTROL;32L450,ABS,V0,BK07	1	S.N.A	
...3	DECO/BOT	BN64-00761A	DECORATION-BOTTOM;L450 37INCH,PC,-,-,-,-	1	S.N.A	
...3	A/HBOSS	BN96-06795A	ASSY HOLDER P-BOSS;37,40L450,UO,HIPS,V0,	1	S.N.A	
....4	H/BOSS	BN61-03677A	HOLDER-BOSS BOTTOM;37,40L450,UO,HIPS,V0,	1	S.N.A	
....4	BOSS/T	BN61-03261B	BOSS-TAPE;Tulip,ACRYL,T1.1,W20mm,GRAY,TA	0.74	S.N.A	
...3	T0069	BP60-00015T	SPACER-FELT;L450 37",FELT,L830,BLK,T0.5,	2	S.N.A	
...3	T0069	BP60-00015U	SPACER-FELT;L450 37",FELT,L470,BLK,T0.5,	2	S.N.A	
...3	M0145	BN96-07269A	ASSY BOARD P-FUNCTION;LN40A450C1D,CT5000	1	S.A	
...3	M0146	BN96-07270D	ASSY BOARD P-POWER & IR;LN32A450C1D,CT50	1	S.A	
0.1	M0002	BN90-01507A	ASSY COVER REAR;37L450,UO,,,	1	S.N.A	
..2	T0081	6002-001294	SCREW-TAPPING;BH,+,,M4,L16,ZPC(BLK)	1	S.A	
..2	T0081	6002-001294	SCREW-TAPPING;BH,+,,M4,L16,ZPC(BLK)	1	S.A	
..2	T0081	6002-001294	SCREW-TAPPING;BH,+,,M4,L16,ZPC(BLK)	1	S.A	
..2	T0081	6002-001294	SCREW-TAPPING;BH,+,,M4,L16,ZPC(BLK)	14	S.A	
..2	M0013	BN96-06789A	ASSY COVER P-REAR;37L450,UO,HIPS,V0,BK50	1	S.A	
...3	M0081	6003-001188	SCREW-TAPTITE;BH,+,-,B,M4,L10,ZPC(WHT),S	2	S.A	
...3	T0101	BN61-03348A	BRACKET-WALL;LCD TV 32,SECC T1.2,-,-,-,-	2	S.N.A	
...3	M0006	BN63-04173A	COVER-REAR;37L450,UO,HIPS,-,-,-,V0,-,BK5	1	S.N.A	
...3	T0071	BN64-00759A	INLAY-TERMINAL;L450,UO,PS SHEET,T0.3,104	1	S.N.A	
...3	T0064	BN65-00002A	CLAMPER CORE;BORDEAUX,LDPE,-,-,BLK,-	1	S.N.A	
0.1	M0216	BN90-01513A	ASSY STAND;37L450,UO,,,	1	S.N.A	
..2	M0027	BN96-07182A	ASSY STAND P-BASE;37,40L450,UO,ABS+PMMA,	1	S.A	
...3	T0081	6002-001294	SCREW-TAPPING;BH,+,,M4,L16,ZPC(BLK)	4	S.A	
...3	M0081	6003-001239	SCREW-TAPTITE;FH,+,-,B,M4,L10,ZPC(WHT),S	8	S.A	
...3	H/SRTOP	BN61-02248A	HOLDER-SWIVEL RING;40R71,ACETAL NATUAL,T	1	S.N.A	
...3	B/SBOTTOM	BN61-02883A	BRACKET-STAND BOTTOM;BORDEAUX PLUS,40,SE	1	S.N.A	
...3	H/SRBOTTOM	BN61-02885A	HOLDER-SWIVEL RING;MURANO40,ACETAL NATUR	1	S.N.A	
...3	B/HINGE	BN61-02886A	BRACKET-HINGE SWIVEL;BORDEAUX PLUS,40,SE	1	S.N.A	
...3	T0920	BN61-03870A	GUIDE-STAND;L450 40INCH,PC+GF 20%,BLK	1	S.N.A	
...3	CCM1	BN63-02183E	COVER-SHEET;Rhcm,PE Vinyl,T0.05,750mm,20	0.5	S.N.A	
...3	T0004	BN63-03030A	COVER-STAND BASE;40R81,ABS+PMMA,-,-,-,HB	1	S.N.A	
...3	M0560	BN96-01800A	ASSY ACCESSORY-SCREW ZIPPER;ROME32,-,-,-	1	S.N.A	
....4	T0081	6002-001294	SCREW-TAPPING;BH,+,,M4,L16,ZPC(BLK)	4	S.A	
....4	ACCESSORY	6902-000683	BAG ZIPPER;LDPE,T0.05,W60,L60,TRP,-,-,2-	1	S.N.A	
...3	M0560	BN96-01800D	ASSY ACCESSORY-SCREW ZIPPER;CORAL,Withou	1	S.N.A	

Level	Location No.	Code No.	Description & Specification	Q'ty	SA/SNA	Remark
...4	M0081	6003-001334	SCREW-TAPTITE;BH,+,S,M4,L14,ZPC(BLK),SWR	3	S.N.A	
...4	B/ZIPPER	6902-000683	BAG ZIPPER;LDPE,T0.05,W60,L60,TRP,-,-,2-	1	S.N.A	
...3	ASTGUIDE	BN96-07936A	ASSY STAND P-GUIDE;L450 32INCH,PC+,GF(20	1	S.A	
...4		BN61-02932B	BRACKET-STOPPER NUT;L450,M4,OD8,-,-,L24,	3	S.N.A	
...4		BN61-03873A	GUIDE-STAND BOTTOM;L450 40INCH,PC+GF(20%	1	S.N.A	
...3	M0126	BN73-00052C	RUBBER-FOOT;LCD TV,CR RUBBER,T2.0 DIA19,	4	S.N.A	
...3		BN68-01402D	MANUAL FLYER-STAND GUIDE;COMM,SAMSUNG,En	1	S.N.A	
0.1	M0017	BN91-01973E	ASSY CHASSIS;LN37A450C1DX*,N45A	1	S.N.A	
..2	M0014	BN94-01638R	ASSY PCB MAIN-CPT;LN37A450C1DXZA	1	S.A	
...3	T0245	0202-001608	SOLDER-WIRE FLUX;LFC7-107,D0.8,99.3Sn/0.	0.25	S.N.A	
...3	JA801S	3701-001388	CONNECTOR-HDMI;20P,Phosphor Bronze,ANGLE	1	S.A	
...3	JA7003	3701-001400	CONNECTOR-DSUB;15P,3R,FEMALE,STRAIGHT,Ni	1	S.A	
...3	CN906	3707-001081	CONNECTOR-OPTICAL;STRAIGHT,SPDIF	1	S.A	
...3	CN330	3711-000058	HEADER-BOARD TO CABLE;BOX,4P,1R,2.5MM,AN	1	S.A	
...3	CN330	3711-003846	HEADER-BOARD TO CABLE;BOX,8P,1R,2mm,ANGL	1	S.A	
...3	CN330	3711-004484	HEADER-BOARD TO CABLE;BOX,5P,1R,2mm,STRA	1	S.A	
...3	CN330	3711-005606	HEADER-BOARD TO CABLE;BOX,30P,2R,2mm,STR	1	S.A	
...3	CN330	3711-005842	HEADER-BOARD TO CABLE;BOX,24P,2R,2MM,STR	1	S.A	
...3	JA330	3722-000143	JACK-PHONE;1P(VER),AG,BLK,ANGLE	1	S.A	
...3	JA330	3722-001061	JACK-PHONE;1P,3.6PI,AG,BLK,N	1	S.A	
...3	JA806S	3722-002275	JACK-DIN;4P,-,SN,BLK,-	1	S.A	
...3	JA7004	3722-002516	JACK-USB;4P/1C,AU30U,BLK,STRAIGHT,A TYPE	1	S.A	
...3	JA333	3722-002635	JACK-PIN;3P,Sn,YEL/WHT/RED,ANGLE	1	S.A	
...3	JA333	3722-002697	JACK-PIN;14P+1P(Shield+Gnd),NI,BLACK,STR	1	S.A	
...3	M0107	BN63-01847A	SHIELD-COVER;ROME,SPT,TO.3,49.5,79.5,HE	1	S.N.A	
...3	CCMM1	BN73-00024D	SILICON/RUBBER;BORDEAUX,SILICON,28x28XT6	1	S.A	
...3		BN97-00707A	ASSY HDCP;BN46-00018A,BR20/21BS_CS,MSTAR	1	S.N.A	
...4		BN46-00018A	KEY CODE-CERTIFICATE;(HDCP KEY)PPM42M5S,	1	S.N.A	
...3	T0174	BN97-01995E	ASSY SMD;LN37A450C1DXZA,CPT	1	S.N.A	
...4	SUB05	0202-001477	SOLDER-CREAM;LST309-M,-,D20~45um,96.5Sn/	2.094	S.N.A	
...4	D1011	0401-000133	DIODE-SWITCHING;RLS4148,75V,150mA,LL-34,	1	S.A	
...4	D9005	0401-000133	DIODE-SWITCHING;RLS4148,75V,150mA,LL-34,	1	S.A	
...4	D2002	0401-001056	DIODE-SWITCHING;MMBD4148SE,100V,200mA,SO	1	S.A	
...4	D2003	0401-001056	DIODE-SWITCHING;MMBD4148SE,100V,200mA,SO	1	S.A	
...4	D2004	0401-001056	DIODE-SWITCHING;MMBD4148SE,100V,200mA,SO	1	S.A	
...4	D2006	0401-001056	DIODE-SWITCHING;MMBD4148SE,100V,200mA,SO	1	S.A	
...4	D2008	0401-001056	DIODE-SWITCHING;MMBD4148SE,100V,200mA,SO	1	S.A	
...4	D5001	0401-001056	DIODE-SWITCHING;MMBD4148SE,100V,200mA,SO	1	S.A	
...4	D7002	0401-001056	DIODE-SWITCHING;MMBD4148SE,100V,200mA,SO	1	S.A	
...4	D7005	0401-001056	DIODE-SWITCHING;MMBD4148SE,100V,200mA,SO	1	S.A	
...4	D7011	0401-001056	DIODE-SWITCHING;MMBD4148SE,100V,200mA,SO	1	S.A	
...4	D7012	0401-001056	DIODE-SWITCHING;MMBD4148SE,100V,200mA,SO	1	S.A	
...4	D7013	0401-001056	DIODE-SWITCHING;MMBD4148SE,100V,200mA,SO	1	S.A	
...4	D7023	0401-001056	DIODE-SWITCHING;MMBD4148SE,100V,200mA,SO	1	S.A	
...4	D7025	0401-001056	DIODE-SWITCHING;MMBD4148SE,100V,200mA,SO	1	S.A	
...4	D8012S	0401-001056	DIODE-SWITCHING;MMBD4148SE,100V,200mA,SO	1	S.A	
...4	D8014S	0401-001056	DIODE-SWITCHING;MMBD4148SE,100V,200mA,SO	1	S.A	
...4	D1004	0401-001099	DIODE-SWITCHING;1N4148WS,75V,150mA,SOD-3	1	S.A	
...4	D1005	0401-001099	DIODE-SWITCHING;1N4148WS,75V,150mA,SOD-3	1	S.A	
...4	D1007	0401-001099	DIODE-SWITCHING;1N4148WS,75V,150mA,SOD-3	1	S.A	

5. Exploded View & Part List

Level	Location No.	Code No.	Description & Specification	Q'ty	SA/SNA	Remark
....4	D1008	0401-001099	DIODE-SWITCHING;1N4148WS,75V,150mA,SOD-3	1	S.A	
....4	D1009	0401-001099	DIODE-SWITCHING;1N4148WS,75V,150mA,SOD-3	1	S.A	
....4	D1010	0401-001099	DIODE-SWITCHING;1N4148WS,75V,150mA,SOD-3	1	S.A	
....4	D9004	0401-001099	DIODE-SWITCHING;1N4148WS,75V,150mA,SOD-3	1	S.A	
....4	D0254	0402-000553	DIODE-SCHOTTKY;SS24/B240,40V,2000mA,DO-2	1	S.A	
....4	D0254	0402-000553	DIODE-SCHOTTKY;SS24/B240,40V,2000mA,DO-2	1	S.A	
....4	D0254	0402-001207	DIODE-SCHOTTKY;UPS5819,40V,1000MA,DO-216	1	S.A	
....4	D1006	0403-000002	DIODE-ZENER;VLZ5V6B,5.45/5.73V,500mW,SOD	1	S.A	
....4	D7017	0403-000771	DIODE-ZENER;VLZ6V2B,5.96-6.27V,500mW,SOD	1	S.A	
....4	D7018	0403-000771	DIODE-ZENER;VLZ6V2B,5.96-6.27V,500mW,SOD	1	S.A	
....4	D7050	0403-000771	DIODE-ZENER;VLZ6V2B,5.96-6.27V,500mW,SOD	1	S.A	
....4	D8007S	0403-000771	DIODE-ZENER;VLZ6V2B,5.96-6.27V,500mW,SOD	1	S.A	
....4	D6002	0403-001052	DIODE-ZENER;RD8.2MB,7.7-8.7V,200mW,SOT-2	1	S.A	
....4	D6003	0403-001052	DIODE-ZENER;RD8.2MB,7.7-8.7V,200mW,SOT-2	1	S.A	
....4	D6004	0403-001052	DIODE-ZENER;RD8.2MB,7.7-8.7V,200mW,SOT-2	1	S.A	
....4	D6005	0403-001052	DIODE-ZENER;RD8.2MB,7.7-8.7V,200mW,SOT-2	1	S.A	
....4	D6007	0403-001052	DIODE-ZENER;RD8.2MB,7.7-8.7V,200mW,SOT-2	1	S.A	
....4	D6008	0403-001052	DIODE-ZENER;RD8.2MB,7.7-8.7V,200mW,SOT-2	1	S.A	
....4	D6013	0403-001052	DIODE-ZENER;RD8.2MB,7.7-8.7V,200mW,SOT-2	1	S.A	
....4	D6014	0403-001052	DIODE-ZENER;RD8.2MB,7.7-8.7V,200mW,SOT-2	1	S.A	
....4	D6016	0403-001052	DIODE-ZENER;RD8.2MB,7.7-8.7V,200mW,SOT-2	1	S.A	
....4	D6017	0403-001052	DIODE-ZENER;RD8.2MB,7.7-8.7V,200mW,SOT-2	1	S.A	
....4	D6019	0403-001052	DIODE-ZENER;RD8.2MB,7.7-8.7V,200mW,SOT-2	1	S.A	
....4	D6020	0403-001052	DIODE-ZENER;RD8.2MB,7.7-8.7V,200mW,SOT-2	1	S.A	
....4	D7019	0403-001052	DIODE-ZENER;RD8.2MB,7.7-8.7V,200mW,SOT-2	1	S.A	
....4	D7021	0403-001052	DIODE-ZENER;RD8.2MB,7.7-8.7V,200mW,SOT-2	1	S.A	
....4	D7027	0403-001052	DIODE-ZENER;RD8.2MB,7.7-8.7V,200mW,SOT-2	1	S.A	
....4	D7028	0403-001052	DIODE-ZENER;RD8.2MB,7.7-8.7V,200mW,SOT-2	1	S.A	
....4	D7030	0403-001052	DIODE-ZENER;RD8.2MB,7.7-8.7V,200mW,SOT-2	1	S.A	
....4	D7032	0403-001052	DIODE-ZENER;RD8.2MB,7.7-8.7V,200mW,SOT-2	1	S.A	
....4	D7034	0403-001052	DIODE-ZENER;RD8.2MB,7.7-8.7V,200mW,SOT-2	1	S.A	
....4	D8002S	0403-001052	DIODE-ZENER;RD8.2MB,7.7-8.7V,200mW,SOT-2	1	S.A	
....4	D8003S	0403-001052	DIODE-ZENER;RD8.2MB,7.7-8.7V,200mW,SOT-2	1	S.A	
....4	D8010S	0403-001052	DIODE-ZENER;RD8.2MB,7.7-8.7V,200mW,SOT-2	1	S.A	
....4	D8025S	0403-001052	DIODE-ZENER;RD8.2MB,7.7-8.7V,200mW,SOT-2	1	S.A	
....4	D8026S	0403-001052	DIODE-ZENER;RD8.2MB,7.7-8.7V,200mW,SOT-2	1	S.A	
....4	D8027S	0403-001052	DIODE-ZENER;RD8.2MB,7.7-8.7V,200mW,SOT-2	1	S.A	
....4	D8028S	0403-001052	DIODE-ZENER;RD8.2MB,7.7-8.7V,200mW,SOT-2	1	S.A	
....4	D5002	0403-001425	DIODE-ZENER;BZX84C33,31-35V,350mW,SOT-23	1	S.A	
....4	D6001	0406-001172	DIODE-TVS;CDS3C30GTH,48/-/50V,SMD	1	S.A	
....4	D6006	0406-001172	DIODE-TVS;CDS3C30GTH,48/-/50V,SMD	1	S.A	
....4	D6009	0406-001172	DIODE-TVS;CDS3C30GTH,48/-/50V,SMD	1	S.A	
....4	D6010	0406-001172	DIODE-TVS;CDS3C30GTH,48/-/50V,SMD	1	S.A	
....4	D6011	0406-001172	DIODE-TVS;CDS3C30GTH,48/-/50V,SMD	1	S.A	
....4	D6012	0406-001172	DIODE-TVS;CDS3C30GTH,48/-/50V,SMD	1	S.A	
....4	D6015	0406-001172	DIODE-TVS;CDS3C30GTH,48/-/50V,SMD	1	S.A	
....4	D6018	0406-001172	DIODE-TVS;CDS3C30GTH,48/-/50V,SMD	1	S.A	
....4	D6021	0406-001172	DIODE-TVS;CDS3C30GTH,48/-/50V,SMD	1	S.A	
....4	D6022	0406-001172	DIODE-TVS;CDS3C30GTH,48/-/50V,SMD	1	S.A	
....4	D6023	0406-001172	DIODE-TVS;CDS3C30GTH,48/-/50V,SMD	1	S.A	
....4	D6024	0406-001172	DIODE-TVS;CDS3C30GTH,48/-/50V,SMD	1	S.A	

Level	Location No.	Code No.	Description & Specification	Q'ty	SA/SNA	Remark
....4	D6025	0406-001172	DIODE-TVS;CDS3C30GTH,48/-/50V,SMD	1	S.A	
....4	D7001	0406-001172	DIODE-TVS;CDS3C30GTH,48/-/50V,SMD	1	S.A	
....4	D7003	0406-001172	DIODE-TVS;CDS3C30GTH,48/-/50V,SMD	1	S.A	
....4	D7010	0406-001172	DIODE-TVS;CDS3C30GTH,48/-/50V,SMD	1	S.A	
....4	D7024	0406-001172	DIODE-TVS;CDS3C30GTH,48/-/50V,SMD	1	S.A	
....4	D7041	0406-001172	DIODE-TVS;CDS3C30GTH,48/-/50V,SMD	1	S.A	
....4	D7042	0406-001172	DIODE-TVS;CDS3C30GTH,48/-/50V,SMD	1	S.A	
....4	D8004S	0406-001172	DIODE-TVS;CDS3C30GTH,48/-/50V,SMD	1	S.A	
....4	D8005S	0406-001172	DIODE-TVS;CDS3C30GTH,48/-/50V,SMD	1	S.A	
....4	D8008S	0406-001172	DIODE-TVS;CDS3C30GTH,48/-/50V,SMD	1	S.A	
....4	D8009S	0406-001172	DIODE-TVS;CDS3C30GTH,48/-/50V,SMD	1	S.A	
....4	D8015S	0406-001172	DIODE-TVS;CDS3C30GTH,48/-/50V,SMD	1	S.A	
....4	D8021S	0406-001172	DIODE-TVS;CDS3C30GTH,48/-/50V,SMD	1	S.A	
....4	D8022S	0406-001172	DIODE-TVS;CDS3C30GTH,48/-/50V,SMD	1	S.A	
....4	D8023S	0406-001172	DIODE-TVS;CDS3C30GTH,48/-/50V,SMD	1	S.A	
....4	D8024S	0406-001172	DIODE-TVS;CDS3C30GTH,48/-/50V,SMD	1	S.A	
....4	D7014	0406-001200	DIODE-TVS;RCLAMP0504F,6/-/-V,150W,SC-70	1	S.A	
....4	D7051	0406-001271	DIODE-TVS;RCLAMP0524P,6/-/-V,150W,SLP251	1	S.A	
....4	D7052	0406-001271	DIODE-TVS;RCLAMP0524P,6/-/-V,150W,SLP251	1	S.A	
....4	D7053	0406-001271	DIODE-TVS;RCLAMP0524P,6/-/-V,150W,SLP251	1	S.A	
....4	D7054	0406-001271	DIODE-TVS;RCLAMP0524P,6/-/-V,150W,SLP251	1	S.A	
....4	D8100S	0406-001271	DIODE-TVS;RCLAMP0524P,6/-/-V,150W,SLP251	1	S.A	
....4	D8101S	0406-001271	DIODE-TVS;RCLAMP0524P,6/-/-V,150W,SLP251	1	S.A	
....4	D7038	0407-000123	DIODE-ARRAY;DAN202K,80V,100mA,CA2-3,SOT-	1	S.A	
....4	D7039	0407-000123	DIODE-ARRAY;DAN202K,80V,100mA,CA2-3,SOT-	1	S.A	
....4	Q1000	0501-000434	TR-SMALL SIGNAL;KTC3875S-GR,NPN,150mW,SO	1	S.A	
....4	Q9004	0501-000434	TR-SMALL SIGNAL;KTC3875S-GR,NPN,150mW,SO	1	S.A	
....4	Q9005	0501-000434	TR-SMALL SIGNAL;KTC3875S-GR,NPN,150mW,SO	1	S.A	
....4	Q2003	0501-000445	TR-SMALL SIGNAL;KTC3875S-Y,NPN,150mW,SOT	1	S.A	
....4	Q3001L	0501-000445	TR-SMALL SIGNAL;KTC3875S-Y,NPN,150mW,SOT	1	S.A	
....4	Q5001	0501-000445	TR-SMALL SIGNAL;KTC3875S-Y,NPN,150mW,SOT	1	S.A	
....4	Q7003	0501-000445	TR-SMALL SIGNAL;KTC3875S-Y,NPN,150mW,SOT	1	S.A	
....4	Q7004	0501-000445	TR-SMALL SIGNAL;KTC3875S-Y,NPN,150mW,SOT	1	S.A	
....4	Q9002	0501-000669	TR-SMALL SIGNAL;KTA1505Y,PNP,150mW,SOT-2	1	S.A	
....4	Q1002L	0501-002080	TR-SMALL SIGNAL;2SC2412K,NPN,200mW,SC-59	1	S.A	
....4	Q1003L	0501-002080	TR-SMALL SIGNAL;2SC2412K,NPN,200mW,SC-59	1	S.A	
....4	Q409	0505-000110	FET-SILICON;2N7002,N,60V,115mA,7.5ohm,0.	1	S.A	
....4	Q409	0505-000110	FET-SILICON;2N7002,N,60V,115mA,7.5ohm,0.	1	S.A	
....4	Q409	0505-000110	FET-SILICON;2N7002,N,60V,115mA,7.5ohm,0.	1	S.A	
....4	Q409	0505-000110	FET-SILICON;2N7002,N,60V,115mA,7.5ohm,0.	1	S.A	
....4	Q409	0505-001165	FET-SILICON;SI3443BDV,P,-20V,+/-4.4A,65mo	1	S.A	
....4	IC104	0801-002633	IC-CMOS LOGIC;7WBD3125,2bit BUS SWITCH,S	1	S.A	
....4	IC104	0801-002633	IC-CMOS LOGIC;7WBD3125,2bit BUS SWITCH,S	1	S.A	
....4	IC2003	0904-001862	IC-I/O SUPPORT CHIP;PCF8574ATS,8Bit,SSOP	1	S.A	
....4	IC6003	1001-000164	IC-ANALOG MULTIPLEX;74HC4052,CMOS,SOP,16	1	S.A	
....4	IC106	1001-001082	IC-VIDEO SWITCH;BA7657F,-,SOP,24P,300MIL	1	S.A	
....4	IC106	1001-001513	IC-VIDEO SWITCH;TMDS351PAG,TQFP,64P,9x9m	1	S.A	
....4	IC6001	1006-001266	IC-LINE TRANSCEIVER;SP3232EEY,TSSOP,16P,	1	S.A	
....4	IC112	1103-000129	IC-EEPROM;24C02,2Kbit,256x8Bit,SOP,8P,5x	1	S.A	
....4	IC112	1103-000129	IC-EEPROM;24C02,2Kbit,256x8Bit,SOP,8P,5x	1	S.A	
....4	IC112	1103-000129	IC-EEPROM;24C02,2Kbit,256x8Bit,SOP,8P,5x	1	S.A	

5. Exploded View & Part List

[illegible]

5. Exploded View & Part List

[illegible]

5. Exploded View & Part List

[illegible]

[illegible]

5. Exploded View & Part List

[illegible]

5. Exploded View & Part List

[illegible]

5. Exploded View & Part List

[illegible]

5. Exploded View & Part List

[illegible]

5. Exploded View & Part List

[illegible]

5. Exploded View & Part List

[illegible]

5. Exploded View & Part List

[illegible]

Level	Location No.	Code No.	Description & Specification	Q'ty	SA/SNA	Remark
....4	C120	2203-000438	C-CER,CHIP;1nF,10%,50V,X7R,1005	1	S.A	
....4	C120	2203-000438	C-CER,CHIP;1nF,10%,50V,X7R,1005	1	S.A	
....4	C120	2203-000438	C-CER,CHIP;1nF,10%,50V,X7R,1005	1	S.A	
....4	C120	2203-000438	C-CER,CHIP;1nF,10%,50V,X7R,1005	1	S.A	
....4	C120	2203-000489	C-CER,CHIP;2.2nF,10%,50V,X7R,1005	1	S.A	
....4	C120	2203-000489	C-CER,CHIP;2.2nF,10%,50V,X7R,1005	1	S.A	
....4	C120	2203-000489	C-CER,CHIP;2.2nF,10%,50V,X7R,1005	1	S.A	
....4	C120	2203-000575	C-CER,CHIP;220nF,10%,25V,X7R,2012	1	S.A	
....4	C120	2203-000575	C-CER,CHIP;220nF,10%,25V,X7R,2012	1	S.A	
....4	C120	2203-000575	C-CER,CHIP;220nF,10%,25V,X7R,2012	1	S.A	
....4	C120	2203-000575	C-CER,CHIP;220nF,10%,25V,X7R,2012	1	S.A	
....4	C120	2203-000575	C-CER,CHIP;220nF,10%,25V,X7R,2012	1	S.A	
....4	C120	2203-000575	C-CER,CHIP;220nF,10%,25V,X7R,2012	1	S.A	
....4	C120	2203-000627	C-CER,CHIP;0.022nF,5%,50V,C0G,1005	1	S.N.A	
....4	C120	2203-000783	C-CER,CHIP;0.33nF,5%,50V,C0G,1608	1	S.A	
....4	C120	2203-000783	C-CER,CHIP;0.33nF,5%,50V,C0G,1608	1	S.A	
....4	C120	2203-000783	C-CER,CHIP;0.33nF,5%,50V,C0G,1608	1	S.A	
....4	C120	2203-000783	C-CER,CHIP;0.33nF,5%,50V,C0G,1608	1	S.A	
....4	C120	2203-000783	C-CER,CHIP;0.33nF,5%,50V,C0G,1608	1	S.A	
....4	C120	2203-000783	C-CER,CHIP;0.33nF,5%,50V,C0G,1608	1	S.A	
....4	C120	2203-000783	C-CER,CHIP;0.33nF,5%,50V,C0G,1608	1	S.A	
....4	C120	2203-000783	C-CER,CHIP;0.33nF,5%,50V,C0G,1608	1	S.A	
....4	C120	2203-000783	C-CER,CHIP;0.33nF,5%,50V,C0G,1608	1	S.A	
....4	C120	2203-000783	C-CER,CHIP;0.33nF,5%,50V,C0G,1608	1	S.A	
....4	C120	2203-000783	C-CER,CHIP;0.33nF,5%,50V,C0G,1608	1	S.A	
....4	C120	2203-000783	C-CER,CHIP;0.33nF,5%,50V,C0G,1608	1	S.A	
....4	C120	2203-000783	C-CER,CHIP;0.33nF,5%,50V,C0G,1608	1	S.A	
....4	C120	2203-000783	C-CER,CHIP;0.33nF,5%,50V,C0G,1608	1	S.A	
....4	C120	2203-000783	C-CER,CHIP;0.33nF,5%,50V,C0G,1608	1	S.A	
....4	C120	2203-000783	C-CER,CHIP;0.33nF,5%,50V,C0G,1608	1	S.A	
....4	C120	2203-000783	C-CER,CHIP;0.33nF,5%,50V,C0G,1608	1	S.A	
....4	C120	2203-000783	C-CER,CHIP;0.33nF,5%,50V,C0G,1608	1	S.A	
....4	C120	2203-000851	C-CER,CHIP;0.039nF,5%,50V,C0G,1608	1	S.A	
....4	C120	2203-000851	C-CER,CHIP;0.039nF,5%,50V,C0G,1608	1	S.A	
....4	C120	2203-000888	C-CER,CHIP;4.7nF,10%,50V,X7R,1608	1	S.A	
....4	C120	2203-000888	C-CER,CHIP;4.7nF,10%,50V,X7R,1608	1	S.A	
....4	C120	2203-000975	C-CER,CHIP;47nF,10%,25V,X7R,TP,1608,-	1	S.A	
....4	C120	2203-000995	C-CER,CHIP;0.047nF,5%,50V,C0G,1005	1	S.A	
....4	C120	2203-001072	C-CER,CHIP;0.056nF,5%,50V,NP0,1005	1	S.A	
....4	C120	2203-001153	C-CER,CHIP;0.068nF,5%,50V,NP0,1005	1	S.A	
....4	C120	2203-001153	C-CER,CHIP;0.068nF,5%,50V,NP0,1005	1	S.A	
....4	C120	2203-001412	C-CER,CHIP;0.03nF,5%,50V,NP0,TP,1005	1	S.N.A	
....4	C120	2203-001412	C-CER,CHIP;0.03nF,5%,50V,NP0,TP,1005	1	S.N.A	
....4	C120	2203-001598	C-CER,CHIP;2200nF,+80-20%,16V,Y5V,2012	1	S.A	
....4	C120	2203-001598	C-CER,CHIP;2200nF,+80-20%,16V,Y5V,2012	1	S.A	
....4	C120	2203-001598	C-CER,CHIP;2200nF,+80-20%,16V,Y5V,2012	1	S.A	
....4	C120	2203-001598	C-CER,CHIP;2200nF,+80-20%,16V,Y5V,2012	1	S.A	
....4	C120	2203-001598	C-CER,CHIP;2200nF,+80-20%,16V,Y5V,2012	1	S.A	
....4	C120	2203-001598	C-CER,CHIP;2200nF,+80-20%,16V,Y5V,2012	1	S.A	
....4	C120	2203-001598	C-CER,CHIP;2200nF,+80-20%,16V,Y5V,2012	1	S.A	
....4	C120	2203-001598	C-CER,CHIP;2200nF,+80-20%,16V,Y5V,2012	1	S.A	
....4	C120	2203-002525	C-CER,CHIP;0.56nF,10%,50V,X7R,TP,1005	1	S.N.A	
....4	C120	2203-002525	C-CER,CHIP;0.56nF,10%,50V,X7R,TP,1005	1	S.N.A	

5. Exploded View & Part List

[illegible]

5. Exploded View & Part List

[illegible]

5. Exploded View & Part List

[illegible]

5. Exploded View & Part List

[illegible]

5. Exploded View & Part List

Level	Location No.	Code No.	Description & Specification	Q'ty	SA/SNA	Remark
....4	C120	2203-006361	C-CER,CHIP;1000nF,10%,10V,X5R,2012	1	S.A	
....4	C120	2203-006361	C-CER,CHIP;1000nF,10%,10V,X5R,2012	1	S.A	
....4	C120	2203-006361	C-CER,CHIP;1000nF,10%,10V,X5R,2012	1	S.A	
....4	C120	2203-006361	C-CER,CHIP;1000nF,10%,10V,X5R,2012	1	S.A	
....4	C120	2203-006361	C-CER,CHIP;1000nF,10%,10V,X5R,2012	1	S.A	
....4	C120	2203-006361	C-CER,CHIP;1000nF,10%,10V,X5R,2012	1	S.A	
....4	C120	2203-006361	C-CER,CHIP;1000nF,10%,10V,X5R,2012	1	S.A	
....4	C120	2203-006361	C-CER,CHIP;1000nF,10%,10V,X5R,2012	1	S.A	
....4	C120	2203-006361	C-CER,CHIP;1000nF,10%,10V,X5R,2012	1	S.A	
....4	C120	2203-006361	C-CER,CHIP;1000nF,10%,10V,X5R,2012	1	S.A	
....4	C120	2203-006361	C-CER,CHIP;1000nF,10%,10V,X5R,2012	1	S.A	
....4	C120	2203-006361	C-CER,CHIP;1000nF,10%,10V,X5R,2012	1	S.A	
....4	C120	2203-006361	C-CER,CHIP;1000nF,10%,10V,X5R,2012	1	S.A	
....4	C120	2203-006361	C-CER,CHIP;1000nF,10%,10V,X5R,2012	1	S.A	
....4	C120	2203-006361	C-CER,CHIP;1000nF,10%,10V,X5R,2012	1	S.A	
....4	C120	2203-006361	C-CER,CHIP;1000nF,10%,10V,X5R,2012	1	S.A	
....4	C120	2203-006361	C-CER,CHIP;1000nF,10%,10V,X5R,2012	1	S.A	
....4	C120	2203-006361	C-CER,CHIP;1000nF,10%,10V,X5R,2012	1	S.A	
....4	C120	2203-006361	C-CER,CHIP;1000nF,10%,10V,X5R,2012	1	S.A	
....4	C120	2203-006361	C-CER,CHIP;1000nF,10%,10V,X5R,2012	1	S.A	
....4	C120	2203-006361	C-CER,CHIP;1000nF,10%,10V,X5R,2012	1	S.A	
....4	C120	2203-006361	C-CER,CHIP;1000nF,10%,10V,X5R,2012	1	S.A	
....4	C120	2203-006361	C-CER,CHIP;1000nF,10%,10V,X5R,2012	1	S.A	
....4	C120	2203-006361	C-CER,CHIP;1000nF,10%,10V,X5R,2012	1	S.A	
....4	C120	2203-006361	C-CER,CHIP;1000nF,10%,10V,X5R,2012	1	S.A	
....4	C120	2203-006361	C-CER,CHIP;1000nF,10%,10V,X5R,2012	1	S.A	
....4	C120	2203-006361	C-CER,CHIP;1000nF,10%,10V,X5R,2012	1	S.A	
....4	C120	2203-006361	C-CER,CHIP;1000nF,10%,10V,X5R,2012	1	S.A	
....4	C120	2203-006399	C-CER,CHIP;1000nF,10%,6.3V,X5R,1005	1	S.A	
....4	C120	2203-006399	C-CER,CHIP;1000nF,10%,6.3V,X5R,1005	1	S.A	
....4	C120	2203-006399	C-CER,CHIP;1000nF,10%,6.3V,X5R,1005	1	S.A	
....4	C120	2203-006399	C-CER,CHIP;1000nF,10%,6.3V,X5R,1005	1	S.A	
....4	C120	2203-006399	C-CER,CHIP;1000nF,10%,6.3V,X5R,1005	1	S.A	
....4	C120	2203-006399	C-CER,CHIP;1000nF,10%,6.3V,X5R,1005	1	S.A	
....4	C120	2203-006399	C-CER,CHIP;1000nF,10%,6.3V,X5R,1005	1	S.A	
....4	C120	2203-006399	C-CER,CHIP;1000nF,10%,6.3V,X5R,1005	1	S.A	
....4	C120	2203-007176	C-CER,CHIP;1000nF,10%,16V,X5R,TP,2012 (1	S.N.A	
....4	C120	2203-007176	C-CER,CHIP;1000nF,10%,16V,X5R,TP,2012 (1	S.N.A	
....4	C9014	2402-001323	C-AL,SMD;100uF,20%,25V,LZ,TP,6.3x8mm	1	S.A	

Level	Location No.	Code No.	Description & Specification	Q'ty	SA/SNA	Remark
....4	C9017	2402-001323	C-AL,SMD;100uF,20%,25V,LZ,TP,6.3x8mm	1	S.A	
....4	C1086	2409-001129	C-POLYMER ,CHIP;100uF,20%,6.3V,WT,TP,3.5	1	S.A	
....4	T0052	2703-000158	INDUCTOR-SMD;1uH,10%,2012	1	S.A	
....4	T0052	2703-000158	INDUCTOR-SMD;1uH,10%,2012	1	S.A	
....4	T0052	2703-000158	INDUCTOR-SMD;1uH,10%,2012	1	S.A	
....4	T0052	2703-000158	INDUCTOR-SMD;1uH,10%,2012	1	S.A	
....4	T0052	2703-000398	INDUCTOR-SMD;10uH,10%,3225	1	S.A	
....4	T0052	2703-000398	INDUCTOR-SMD;10uH,10%,3225	1	S.A	
....4	T0052	2703-000398	INDUCTOR-SMD;10uH,10%,3225	1	S.A	
....4	T0052	2703-000398	INDUCTOR-SMD;10uH,10%,3225	1	S.A	
....4	T0052	2703-000398	INDUCTOR-SMD;10uH,10%,3225	1	S.A	
....4	T0052	2703-000398	INDUCTOR-SMD;10uH,10%,3225	1	S.A	
....4	T0052	2703-000398	INDUCTOR-SMD;10uH,10%,3225	1	S.A	
....4	T0052	2703-000398	INDUCTOR-SMD;10uH,10%,3225	1	S.A	
....4	T0052	2703-000398	INDUCTOR-SMD;10uH,10%,3225	1	S.A	
....4	T0052	2703-000398	INDUCTOR-SMD;10uH,10%,3225	1	S.A	
....4	T0052	2703-000398	INDUCTOR-SMD;10uH,10%,3225	1	S.A	
....4	T0052	2703-000398	INDUCTOR-SMD;10uH,10%,3225	1	S.A	
....4	T0052	2703-000398	INDUCTOR-SMD;10uH,10%,3225	1	S.A	
....4	T0052	2703-000398	INDUCTOR-SMD;10uH,10%,3225	1	S.A	
....4	T0052	2703-000398	INDUCTOR-SMD;10uH,10%,3225	1	S.A	
....4	T0052	2703-000398	INDUCTOR-SMD;10uH,10%,3225	1	S.A	
....4	T0052	2703-000417	INDUCTOR-SMD;220uH,5%,3225	1	S.A	
....4	T0052	2703-001426	INDUCTOR-SMD;680uH,20%,7070	1	S.A	
....4	T0052	2703-001778	INDUCTOR-SMD;3.3uH,20%,3225	1	S.A	
....4	T0052	2703-001778	INDUCTOR-SMD;3.3uH,20%,3225	1	S.A	
....4	L9001	2704-000018	INDUCTOR-SMD-ARRAY;15uH,2000mA,2,0.124oh	1	S.N.A	
....4	L9002	2704-000018	INDUCTOR-SMD-ARRAY;15uH,2000mA,2,0.124oh	1	S.N.A	
....4	X202	2801-003773	CRYSTAL-SMD;12MHz,30ppm,28-AAN,20pF,50oh	1	S.A	
....4	X202	2801-004604	CRYSTAL-SMD;24.69MHz,30ppm,27pF,40ohm,TP	1	S.A	
....4	T0568	3301-000314	BEAD-SMD;120ohm,1.6x0.8x0.8mm,-,-,-	1	S.N.A	
....4	T0568	3301-000314	BEAD-SMD;120ohm,1.6x0.8x0.8mm,-,-,-	1	S.N.A	
....4	T0568	3301-001145	BEAD-SMD;60ohm,4516,TP,70ohm/45MHz,82ohm	1	S.N.A	
....4	T0568	3301-001145	BEAD-SMD;60ohm,4516,TP,70ohm/45MHz,82ohm	1	S.N.A	
....4	T0568	3301-001145	BEAD-SMD;60ohm,4516,TP,70ohm/45MHz,82ohm	1	S.N.A	
....4	T0568	3301-001145	BEAD-SMD;60ohm,4516,TP,70ohm/45MHz,82ohm	1	S.N.A	
....4	T0568	3301-001145	BEAD-SMD;60ohm,4516,TP,70ohm/45MHz,82ohm	1	S.N.A	
....4	T0568	3301-001145	BEAD-SMD;60ohm,4516,TP,70ohm/45MHz,82ohm	1	S.N.A	
....4	T0568	3301-001145	BEAD-SMD;60ohm,4516,TP,70ohm/45MHz,82ohm	1	S.N.A	
....4	T0568	3301-001145	BEAD-SMD;60ohm,4516,TP,70ohm/45MHz,82ohm	1	S.N.A	
....4	T0568	3301-001145	BEAD-SMD;60ohm,4516,TP,70ohm/45MHz,82ohm	1	S.N.A	
....4	T0568	3301-001145	BEAD-SMD;60ohm,4516,TP,70ohm/45MHz,82ohm	1	S.N.A	
....4	T0568	3301-001145	BEAD-SMD;60ohm,4516,TP,70ohm/45MHz,82ohm	1	S.N.A	
....4	T0568	3301-001145	BEAD-SMD;60ohm,4516,TP,70ohm/45MHz,82ohm	1	S.N.A	
....4	T0568	3301-001145	BEAD-SMD;60ohm,4516,TP,70ohm/45MHz,82ohm	1	S.N.A	
....4	T0568	3301-001145	BEAD-SMD;60ohm,4516,TP,70ohm/45MHz,82ohm	1	S.N.A	
....4	T0568	3301-001145	BEAD-SMD;60ohm,4516,TP,70ohm/45MHz,82ohm	1	S.N.A	
....4	T0568	3301-001145	BEAD-SMD;60ohm,4516,TP,70ohm/45MHz,82ohm	1	S.N.A	
....4	T0568	3301-001145	BEAD-SMD;60ohm,4516,TP,70ohm/45MHz,82ohm	1	S.N.A	
....4	T0568	3301-001145	BEAD-SMD;60ohm,4516,TP,70ohm/45MHz,82ohm	1	S.N.A	
....4	T0568	3301-001145	BEAD-SMD;60ohm,4516,TP,70ohm/45MHz,82ohm	1	S.N.A	
....4	T0568	3301-001236	BEAD-SMD;60ohm,1608,-,-,-	1	S.N.A	
....4	T0568	3301-001236	BEAD-SMD;60ohm,1608,-,-,-	1	S.N.A	
....4	T0568	3301-001236	BEAD-SMD;60ohm,1608,-,-,-	1	S.N.A	
....4	T0568	3301-001236	BEAD-SMD;60ohm,1608,-,-,-	1	S.N.A	
....4	T0568	3301-001236	BEAD-SMD;60ohm,1608,-,-,-	1	S.N.A	

5. Exploded View & Part List

Level	Location No.	Code No.	Description & Specification	Q'ty	SA/SNA	Remark
....4	T0568	3301-001236	BEAD-SMD;60ohm,1608,-,-,-	1	S.N.A	
....4	T0568	3301-001236	BEAD-SMD;60ohm,1608,-,-,-	1	S.N.A	
....4	T0568	3301-001324	BEAD-SMD;15ohm,2012,600mA,TP,,0.1ohm	1	S.A	
....4	T0568	3301-001324	BEAD-SMD;15ohm,2012,600mA,TP,,0.1ohm	1	S.A	
....4	T0568	3301-001324	BEAD-SMD;15ohm,2012,600mA,TP,,0.1ohm	1	S.A	
....4	T0568	3301-001324	BEAD-SMD;15ohm,2012,600mA,TP,,0.1ohm	1	S.A	
....4	T0568	3301-001404	BEAD-SMD;30ohm,2012,TP,15.9OHM/30MHz	1	S.A	
....4	T0568	3301-001404	BEAD-SMD;30ohm,2012,TP,15.9OHM/30MHz	1	S.A	
....4	T0568	3301-001404	BEAD-SMD;30ohm,2012,TP,15.9OHM/30MHz	1	S.A	
....4	T0568	3301-001404	BEAD-SMD;30ohm,2012,TP,15.9OHM/30MHz	1	S.A	
....4	T0568	3301-001404	BEAD-SMD;30ohm,2012,TP,15.9OHM/30MHz	1	S.A	
....4	T0568	3301-001526	BEAD-SMD;10ohm,1.6x0.8x0.8mm,1000mA,TP,,	1	S.N.A	
....4	T0568	3301-001526	BEAD-SMD;10ohm,1.6x0.8x0.8mm,1000mA,TP,,	1	S.N.A	
....4	T0568	3301-001526	BEAD-SMD;10ohm,1.6x0.8x0.8mm,1000mA,TP,,	1	S.N.A	
....4	T0568	3301-001526	BEAD-SMD;10ohm,1.6x0.8x0.8mm,1000mA,TP,,	1	S.N.A	
....4	T0568	3301-001526	BEAD-SMD;10ohm,1.6x0.8x0.8mm,1000mA,TP,,	1	S.N.A	
....4	T0568	3301-001526	BEAD-SMD;10ohm,1.6x0.8x0.8mm,1000mA,TP,,	1	S.N.A	
....4	T0568	3301-001526	BEAD-SMD;10ohm,1.6x0.8x0.8mm,1000mA,TP,,	1	S.N.A	
....4	T0568	3301-001526	BEAD-SMD;10ohm,1.6x0.8x0.8mm,1000mA,TP,,	1	S.N.A	
....4	T0568	3301-001560	BEAD-SMD;80ohm,1.6X0.8X0.8mm,200mA,TP,,	1	S.N.A	
....4	T0568	3301-001560	BEAD-SMD;80ohm,1.6X0.8X0.8mm,200mA,TP,,	1	S.N.A	
....4	T0568	3301-001560	BEAD-SMD;80ohm,1.6X0.8X0.8mm,200mA,TP,,	1	S.N.A	
....4	T0568	3301-001560	BEAD-SMD;80ohm,1.6X0.8X0.8mm,200mA,TP,,	1	S.N.A	
....4	T0568	3301-001560	BEAD-SMD;80ohm,1.6X0.8X0.8mm,200mA,TP,,	1	S.N.A	
....4	T0568	3301-001560	BEAD-SMD;80ohm,1.6X0.8X0.8mm,200mA,TP,,	1	S.N.A	
....4	T0568	3301-001560	BEAD-SMD;80ohm,1.6X0.8X0.8mm,200mA,TP,,	1	S.N.A	
....4	T0568	3301-001560	BEAD-SMD;80ohm,1.6X0.8X0.8mm,200mA,TP,,	1	S.N.A	
....4	T0568	3301-001560	BEAD-SMD;80ohm,1.6X0.8X0.8mm,200mA,TP,,	1	S.N.A	
....4	T0568	3301-001560	BEAD-SMD;80ohm,1.6X0.8X0.8mm,200mA,TP,,	1	S.N.A	
....4	T0568	3301-001560	BEAD-SMD;80ohm,1.6X0.8X0.8mm,200mA,TP,,	1	S.N.A	
....4	T0568	3301-001560	BEAD-SMD;80ohm,1.6X0.8X0.8mm,200mA,TP,,	1	S.N.A	
....4	T0313	3404-001207	SWITCH-TACT;12V,50mA,160gf,6.2X6.2,SPST	1	S.A	
....4	JA7001	3701-001367	CONNECTOR-HDMI;19P,2R,FEMALE,SMD,AU	1	S.A	
....4	JA7002	3701-001367	CONNECTOR-HDMI;19P,2R,FEMALE,SMD,AU	1	S.A	
....4	T0077	BN41-00963A	PCB MAIN;FR-4,4,1.2T,192*158	1	S.N.A	
....4	M0107	BN61-03858A	BRACKET-PCB;L450,BRASS(H62Y),T0.4,5mm,7m	1	S.N.A	
....4	M0107	BN61-03858A	BRACKET-PCB;L450,BRASS(H62Y),T0.4,5mm,7m	1	S.N.A	
....4	M0107	BN61-03858A	BRACKET-PCB;L450,BRASS(H62Y),T0.4,5mm,7m	1	S.N.A	
....4	M0107	BN61-03858A	BRACKET-PCB;L450,BRASS(H62Y),T0.4,5mm,7m	1	S.N.A	
....4	M0107	BN61-03858A	BRACKET-PCB;L450,BRASS(H62Y),T0.4,5mm,7m	1	S.N.A	
....4	M0018	BN97-02014A	ASSY MICOM;T-CRLAUSC-XXXX,N45A,2007.11.0	1	S.N.A	
....5	IC2005	1107-001735	IC-NOR FLASH;MX25L3205DM2I-12G,32Mbit,16	1	S.A	
....4	R110	2007-007587	R-CHIP;3.6Kohm,1%,1/16W,TP,1005	1	S.N.A	
....4	Q2005	0504-001129	TR-DIGITAL;KRC104S-I,NPN,200MW,47K/47K,S	1	S.A	
...3		BN61-02470C	HOLDER-CLAMP DMD;NYLON 6/6,NATURAL,DACN-	1	S.N.A	
...3	CIS3	BN40-00125A	TUNER;DTVS20FTL111A,DTVS20FTL111A,NTSC/V	1	S.A	
0.1	A/SHIELD	BN91-01979A	ASSY SHIELD-PEE;LN37A450C1DXZA	1	S.N.A	
..2	M0081	6003-000115	SCREW-TAPTITE;BH,+,B,M3,L6,ZPC(BLK),SWRC	4	S.A	
..2	M0081	6003-000115	SCREW-TAPTITE;BH,+,B,M3,L6,ZPC(BLK),SWRC	6	S.A	
..2	M0081	6003-001188	SCREW-TAPTITE;BH,+,B,M4,L10,ZPC(WHT),S	2	S.A	
..2	M0081	6003-001188	SCREW-TAPTITE;BH,+,B,M4,L10,ZPC(WHT),S	2	S.A	
..2	M0081	6003-001188	SCREW-TAPTITE;BH,+,B,M4,L10,ZPC(WHT),S	9	S.A	
..2	M0081	6003-001439	SCREW-TAPTITE;BH,+,S,M4,L8,ZPC(WHT),SW	1	S.N.A	
..2	M0081	6003-001439	SCREW-TAPTITE;BH,+,S,M4,L8,ZPC(WHT),SW	1	S.N.A	
..2	M0258	BN39-00615Q	CBF HARNESS-INLET SOCKET;LN40A450C1D,UL1	1	S.A	

Level	Location No.	Code No.	Description & Specification	Q'ty	SA/SNA	Remark
..2	M2893	BN39-00802S	LEAD CONNECTOR;LILY2 50",UL1007#26,24p/2	1	S.A	
..2	T0764	BN44-00217A	SMPS-LCDTV;MK37P5B,SEM,AC/DC,171W,AC100	1	S.A	
..2	M0146	BN61-02419A	BRACKET-PANEL SIDE;SONOMA 32,SECC,T1.2,A	4	S.N.A	
..2	M0115	BN61-02882A	BRACKET-STAND LINK;TULIP,40,SECC,T1.6,-,	1	S.N.A	
..2	T0447	BN96-06959C	ASSY BRACKET P-PANEL;37L450,CPT,AUO,,SEC	1	S.N.A	
...3	M0081	6003-000115	SCREW-TAPTITE;BH,+,B,M3,L6,ZPC(BLK),SWRC	3	S.A	
...3	M0081	6003-000115	SCREW-TAPTITE;BH,+,B,M3,L6,ZPC(BLK),SWRC	3	S.A	
...3	M0081	6003-000115	SCREW-TAPTITE;BH,+,B,M3,L6,ZPC(BLK),SWRC	2	S.A	
...3	M0081	6003-000115	SCREW-TAPTITE;BH,+,B,M3,L6,ZPC(BLK),SWRC	2	S.A	
...3	M0131	AA63-01438A	GASKET;Bordeaux,Conductive Fabric,7mm,8m	1	S.N.A	
...3	B/PBOTTOM	BN61-03689A	BRACKET-PANEL BOTTOM;L450 37INCH,SECC,T1	1	S.N.A	
...3	B/GMAIN	BN61-03692A	BRACKET-GUIDE MAIN;L450 37INCH,SECC,T1.0	1	S.N.A	
...3	B/GPRIGHT	BN61-03693A	BRACKET-GUIDE POWER;L450 37INCH,SECC,T1.	1	S.N.A	
...3	B/GPLEFT	BN61-03696A	BRACKET-GUIDE POWER;L450 37INCH,SECC,T1.	2	S.N.A	
...3	T0101	BN61-03698A	BRACKET-WALL;L450 37INCH,SECC,T1.2	1	S.N.A	
...3	M0131	BN63-02549A	GASKET;LE37R72B,Conductive Fabric,26mm,1	5	S.N.A	
...3	M0146	BN61-03684B	BRACKET-PANEL TOP;L450 37INCH,SECC,T1.0	1	S.N.A	
..2	M2893	BN39-00875A	LEAD CONNECTOR;LE32R86BDX,UL1571#30,30P,	1	S.A	
..2	M2893	BN39-00899A	LEAD CONNECTOR;BORDEAUX PLUS,UL1007#26,U	1	S.A	
..2	M2893	BN39-00849H	LEAD CONNECTOR;LE32A450,UL1007 #26,14P,3	1	S.A	
..2	M0114	BN61-02500A	HOLDER-WIRE;NYLON6.6,NATURAL	5	S.N.A	
..2	M0081	6003-001334	SCREW-TAPTITE;BH,+,S,M4,L14,ZPC(BLK),SWR	4	S.N.A	
..2	M0254	BN61-03699F	HOLDER-SIDE AV;32L450,UO,HIPS,V0,-,-,B	1	S.N.A	
0.1	A/LCD	BN91-01985B	ASSY LCD-CPT;LN37A450C1DXZA,CLAA370WF02S	1	S.N.A	
..2	M0215	BN07-00507A	LCD-PANEL;CLAA370WF02S	1	S.A	
0.1	M0113	BN92-03175A	ASSY P/MATERIAL;37L450,UO,,,	1	S.N.A	
..2	T0524	6902-000739	BAG PE;HDPE/HDPE/NITRON,T0.015/T0.015/T1	1	S.N.A	
..2	B/PP	6922-000013	BAND PP;PP,W18,L2300m,TRP,Roll Diameter	4.02	S.N.A	
..2	T0214	AA61-20285C	HOLDER-BOX;CORAL,PP,BLACK,HB	2	S.N.A	
0.1	M0045	BN92-03213L	ASSY ACCESSORY;LN37A450C1DXZC	1	S.N.A	
..2	M0045	BN96-07256A	ASSY ACCESSORY;LN40A450C1DXZC	1	S.A	
...3	T0268	3903-000144	CBF-POWER CORD;DT,US,BP3/Y,U(IEC C13-RA)	1	S.A	
...3	T0524	6902-000018	BAG PE;LDPE,T0.1,W280,L400,CLEAR,8,2,-,2	1	S.N.A	
...3	REV 05	AA68-00682C	CARD WARRANTY-05;PDP,W/P120(G),SECA,B5,B	1	S.N.A	
...3	CLOTH	BN63-01798A	CLOTH-CLEAN;RE40**,CLOTH,180,200,RHCM	1	S.N.A	
...3	T0531	BN63-04243A	COVER-BOTTOM;37,40L450,HIPS,-,-,V0,-,B	1	S.N.A	
...3		AA68-03242L	MANUAL FLYER-03,,SAFETY GUIDE;comm,Samsu	1	S.N.A	
...3	T0511	BN68-01395C	MANUAL USERS;COMM,SAMSUNG,Eng/CF,N.Ameri	1	S.N.A	
...3		BN68-01396C	MANUAL FLYER-QSG;COMM,SAMSUNG,Eng/CF,N.A	1	S.N.A	
...3	T0074	BN59-00687A	REMOCON;TM-96B,49,AMERICA	1	S.A	
..2		BN68-01402B	MANUAL FLYER-STAND GUIDE;COMM,SAMSUNG,En	1	S.N.A	
0.1	M0003	BN92-03169Q	ASSY BOX;37L450,ZC	1	S.N.A	
..2	B/OUT	BN69-02398B	BOX-SET,OUT;L450-37,CB,C-03,DY-01,AB,W99	1	S.N.A	
..2	B/IN	BN69-02399A	BOX-01,SET IN;L450-37,CB,C-01,DY-01,AB,W	1	S.N.A	
0.1	M0019	BN92-03212L	ASSY LABEL;LN37A450C1DXZC	1	S.N.A	

5. Exploded View & Part List

Level	Location No.	Code No.	Description & Specification	Q'ty	SA/SNA	Remark
0.1	M0590	BN81-01863A	AS-T-CON BOARD;CLAA370WF02S,00507A,-,-,-	1	S.N.A	