



SERVICE MANUAL

Television-Video Cassette Recorder

CHASSIS: CP-420

MODEL: 20F8T1



1. SPECIFICATIONS

1-1. TV PART

TV STANDARD	PAL B/G (F. FA MODEL), PAL BIG SECAM-L(L. LA MODEL) PAL I (P.PA MODEL) PAL/SECAM B/G D/K (D. DA MODEL)
SCREEN SIZE	20" : 48cm (A48JLL90X)
MAIN VOLTAGE	230V AC 50Hz, 110~250V AC 50Hz(DA MODEL)
POWER CONSUMPTION	STAND BY MODE : BELOW 3 Watts OPERATION MODE : 20" = 78 Watts
SOUND OUTPUT	1.5 Watts (at 60% mod. , 10% THD)
SPEAKER	3 Watts 16 Ohm
ANTENNA IMPEDANCE	75 Ohm unbalanced input
TUNING SYSTEM	FS (FREQUENCY SYNTHESIS) TUNING
RECEPTION CHANNEL UNIT	VHF-L : E2 - S7 VHF-H : S8 - S36 UHF : S37 - E69
MEMORY CHANNEL	70 PROGRAMS
AUX. TERMINAL	RCA TYPE AV INPUT JACK HEADPHONE JACK (3.5mm Ø)
REMOTE CONTROLLER	R-35 with 2 "AA" type batteries
TELETEXT	8page memory TOP and FLOF - West option : German/Deutch/Flemish,French,Italian, Spanish/Portuguese,Swedish/Finnish/Danish,Czech/Slovak -East option : Polish,Czech/Slovak,Rumanian,Hungarian,Servocroat German/Deutch/Flemish,French,Italian -Turkish option : Turkish,English,German/Deutch/Flemish,French, Italian,Spanish/Portuguese,Swedish/Finnish/Danish -Cyrillic option : Russian,Lettish/Lithuanian,Estonian,Ukranian, Czech/Slovak,Servocroat,English
OTHER FEATURE	ON SCREEN DISPLAY,SLEEP TIMER,ON/OFF TIMER AUTO TUNING CHILD LOCK TELETEXT PICTURE TYPE SELECTION 2-TUNER,TV/AV
WEIGHT	20" : 23.6kg(set)

1-2. VCR PART

GENERAL	temperature	5 °C ~ 35 °C (operating) -20 °C ~ 60 °C (storage temperature)
	format	standard
	tape width	12.65 mm
	tape speed	SP : 23.39mm/sec LP : 11.70mm/sec
	max. recording time with fullsize cassette	SP : 240min. with E-240 video cassette
		LP : 480min. with E-240 video cassette
AUDIO	recording system	longitudinal track
	input	-3.8dBm(500mVrms), more than 47Kohms, unbalanced.
	output	-3.8dBm(500mVrms),less than 1Kohm, unbalanced
	frequency range	100Hz to 8KHz
	signal to noise ratio	40dB(more than)
VIDEO	signal system	PAL/SECAM colour and CCIR mono chrome signals, 625lines/50fields.
	recording system	Rotary 2-head herical scan with a slant double azimuth combination video head.
	input	1Vp-p, 75 ohms, unbalanced
	output	1Vp-p, 75 ohms, unbalanced
	signal to noise ratio	45dB with NETTETE IMAGE control at center position.
	horizontal resolution	240 lines with NETTETE IMAGE control at center position

* Design and specifications can be subjected to change without notice.

CHANNEL COVERAGE

SYSTEM	PAL,SECAM-B/G PAL-I/I PAL,SECM-B/G,DK HYPER BAND	PAL,SECM-B/G HYPER BAND	PAL-I	OAK-B/H
CHANNEL	VHF ch 2 - 12 UHF ch 21 - 69 CATV ch X,Y,Z,S1-S41	VHF ch 2 - 12 UHF ch 21 - 69 CATV ch X,Y,Z,S1-S41	UHF ch21 -69	VHF LOW ch 1A- 5 VHF HIGH ch 5A-N11 UHF ch 21 - 69

IN/OUTPUT JACK TYPE

MODEL	EUROPE	MIDDLE EAST,ASIA,CIS AUSTRALIA
JACK TYPE	SCART TPYE & RCA TYPE	RCA TYPE

CP-420 CHASSIS SCHEMATIC DIAGRAM

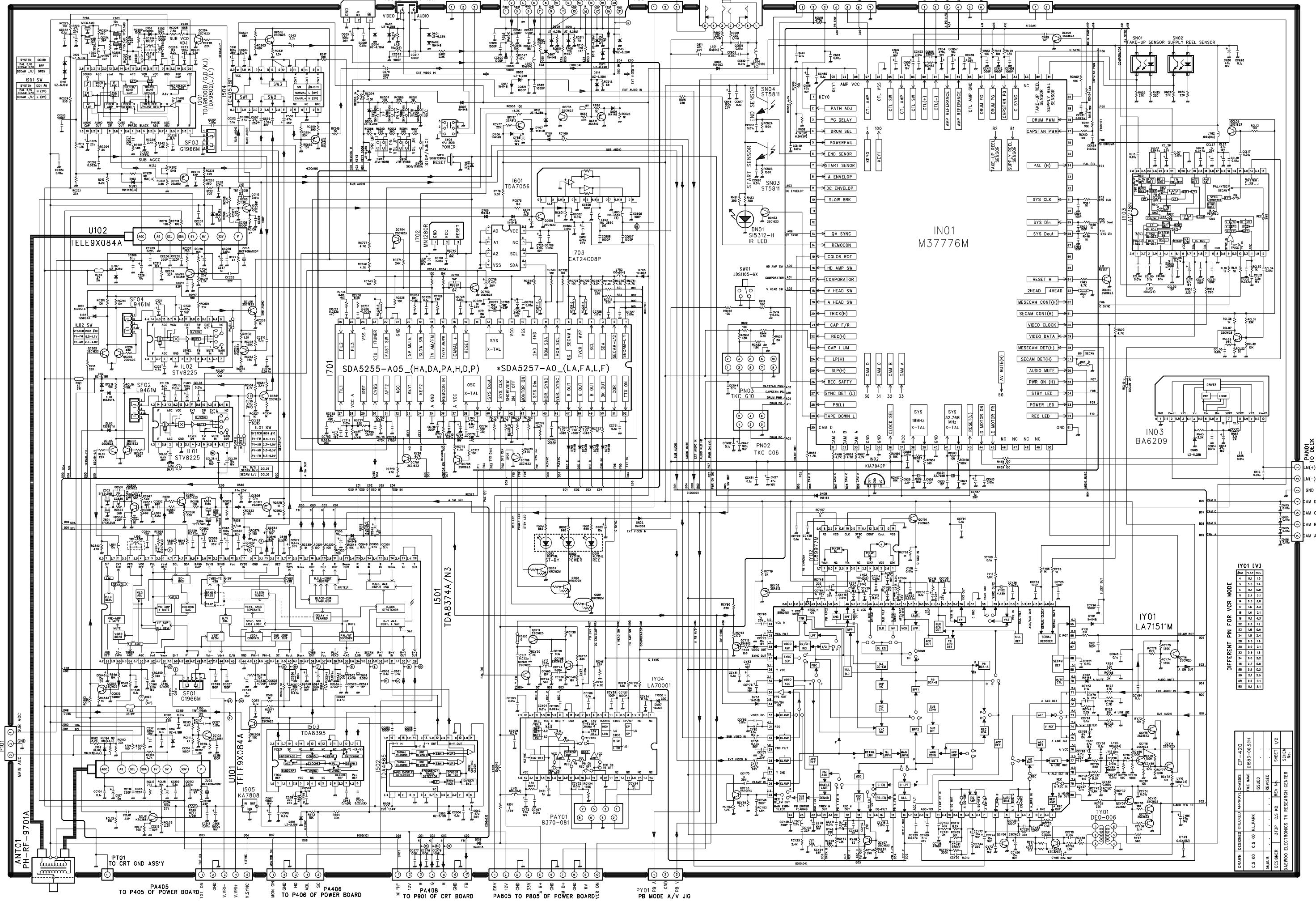

DIFFERENT PIN FOR VCR MODE

Pin	Function
1	AV MUTE
2	AV MUTE
3	AV MUTE
4	AV MUTE
5	AV MUTE
6	AV MUTE
7	AV MUTE
8	AV MUTE
9	AV MUTE
10	AV MUTE
11	AV MUTE
12	AV MUTE
13	AV MUTE
14	AV MUTE
15	AV MUTE
16	AV MUTE
17	AV MUTE
18	AV MUTE
19	AV MUTE
20	AV MUTE
21	AV MUTE
22	AV MUTE
23	AV MUTE
24	AV MUTE
25	AV MUTE
26	AV MUTE
27	AV MUTE
28	AV MUTE
29	AV MUTE
30	AV MUTE
31	AV MUTE
32	AV MUTE
33	AV MUTE
34	AV MUTE
35	AV MUTE
36	AV MUTE
37	AV MUTE
38	AV MUTE
39	AV MUTE
40	AV MUTE
41	AV MUTE
42	AV MUTE
43	AV MUTE
44	AV MUTE
45	AV MUTE
46	AV MUTE
47	AV MUTE
48	AV MUTE
49	AV MUTE
50	AV MUTE

DESIGNER	DATE	REV	NO.
DAEWOO ELECTRONICS TV RESEARCH CENTER	1993-06-01	1	1

SAFETY CAUTION :

BEFORE SERVICING THIS CHASSIS IT IS IMPORTANT THAT THE SERVICE TECHNICIAN READ AND FOLLOW THE "X-RAY RADIATION PRECAUTION. "SAFETY PRECAUTIONS" AND "PRODUCT SAFETY NOTICE" IN THE SERVICE MANUAL.

PRODUCT SAFETY NOTE :

COMPONENTS MARKED WITH⚠ ARE IMPORTANT FOR MAINTAINING. THE SAFETY OF THE SET AND SHOULD BE REPLACED ONLY WITH TYPES IDENTICAL TO THOSE IN THE ORIGINAL OR SPECIFIED ONE IN THE PARTS LIST. DON'T DEGRADE THE SAFETY OF THE SET THROUGH IMPROPER SERVICING.

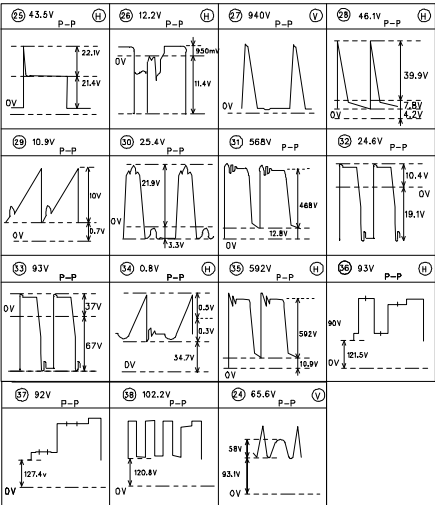

DIFFERENT PARTS FOR SIZE

NO	LOC	PART	14"	20"
1	L404	COIL H-LINEARITY	L-125	L-182
2	C415	C MYLAR	200V PU 0.47uF	200V PU 0.36uF
3	R834	R CARBON FILM	1/4W 100	1/4W 91
4	R833	R CARBON FILM	1/4W 4.7K	1/4W 5.1K
5	R301	R CARBON FILM	1/4W 1.8K	1/4W 2.2K
6	R419	R M-OXIDE FILM	1W 1.2	1W 2.4
7	R572	R CARBON FILM	1/6W 8.2K	1/6W 6.8K

DRAWN	DESIGNED	CHECKED	APPROVE	CHASSIS	CP-420
C.S. KO	C.S. KO	H.L.PARK		FILE NAME	10711-00.SCH
98.01.121				ISSUED	
DESIGNER	3T3P	C.S. KO	REV No.	SHEET	1/1
DAEWOO ELECTRONICS TV RESEARCH CENTER				SCHEM	No.

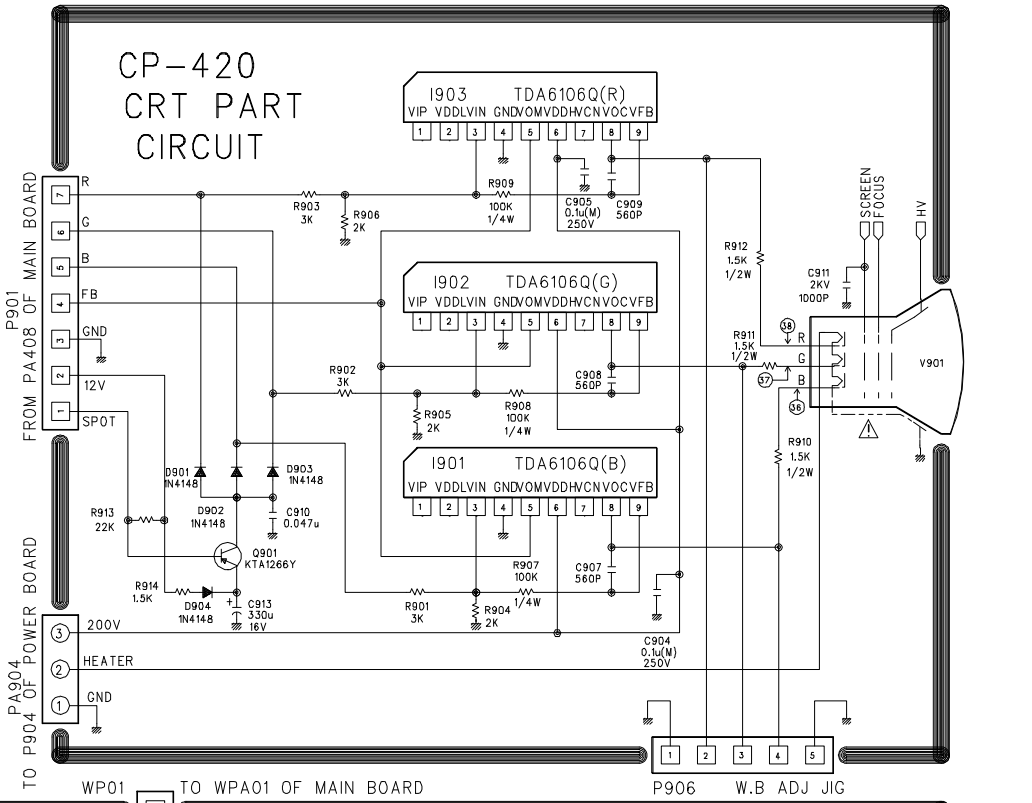

CP-420 POWER PART CIRCUIT

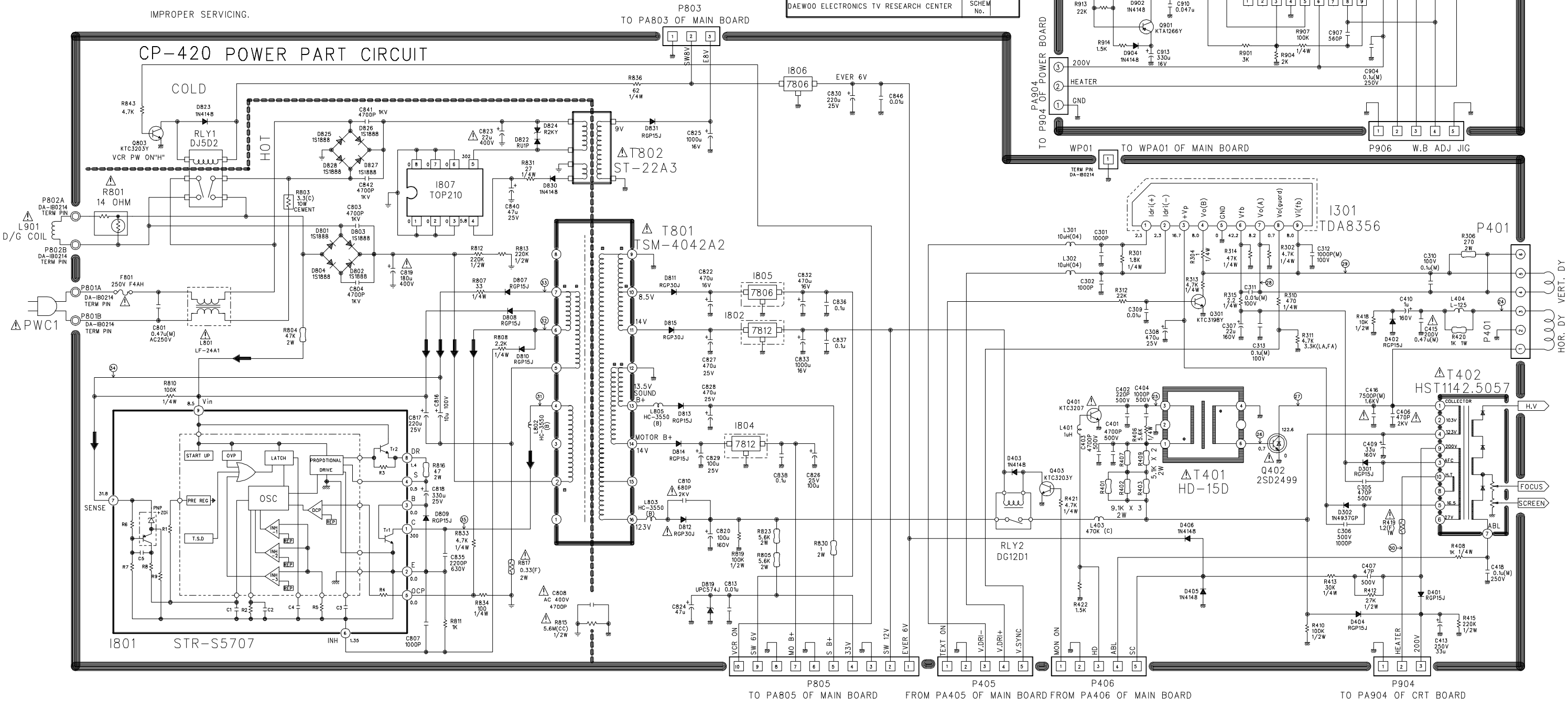

SCHEMATIC DIAGRAM
CHASSIS : CP - 420

* PAL - B/G

* PAL/SECAM – B/G, D/K
NTSC – 3.58/4.43 (AV)

* PAL - B/G
SECAM - L

* PAL - I

RUN NO.19 Jan.1998.

NOTES :

1. ALL RESISTORS ARE 1/8 WATT UNLESS OTHERWISE NOTED.
(CHIP RESISTORS ARE 1/10 WATT)
2. CAPACITANCE VALUES 1 AND ABOVE ARE IN μF EXCEPT AS INDICATED.
3. INDUCTOR VALUES ARE IN μH EXCEPT AS INDICATED.
4. ALL DIODE ARE 1N4148 EXCEPT AS INDICATED.
5. ALL NPN TRANSISTOR ARE 2SC1623, ALL PNP TRANSISTOR ARE 2SA812 EXCEPT AS INDICATED
6. ALL THE DC VOLTAGES IN EACH POINT ARE MEASURED WITH DIGITAL VOLTMETER
UNDER THE STANDARD PUL COLOUR BAR SIGNAL INPUT
(5 CHANNEL) AND ALL CONTROLS SET TO THE MAXIMUM POSITION.
AT NOMINAL LINE VOLTAGE AC 230V 50HZ
7. SINCE THIS SCHEMATIC DIAGRAM IS A STANDARD ONE THE CIRCUIT AND CIRCUIT CONSTANTS MAY BE SUBJECT TO CHANGE FOR IMPROVEMENT WITHOUT ANY NOTICE.

SAFETY CAUTION :

BEFORE SERVICING THIS CHASSIS IT IS IMPORTANT THAT THE SERVICE TECHNICIAN READ AND FOLLOW THE "X-RAY RADIATION PRECAUTION," "SAFETY PRECAUTIONS" AND "PRODUCT SAFETY NOTICE" IN THE SERVICE MANUAL.

PRODUCT SAFETY NOTE :

COMPONENTS MARKED WITH Δ ARE IMPORTANT FOR MAINTAINING THE SAFETY OF THE SET AND SHOULD BE REPLACED ONLY WITH TYPES IDENTICAL TO THOSE IN THE ORIGINAL OR SPECIFIED ONE IN THE PARTS LIST.
DON'T DEGRADE THE SAFETY OF THE SET THROUGH IMPROPER SERVICING.

WAVE FORMS

VIDEO : 8 STEP PAL COLOR BAR 87.5% AM
AUDIO : 1KHz SINE WAVE 60% FM

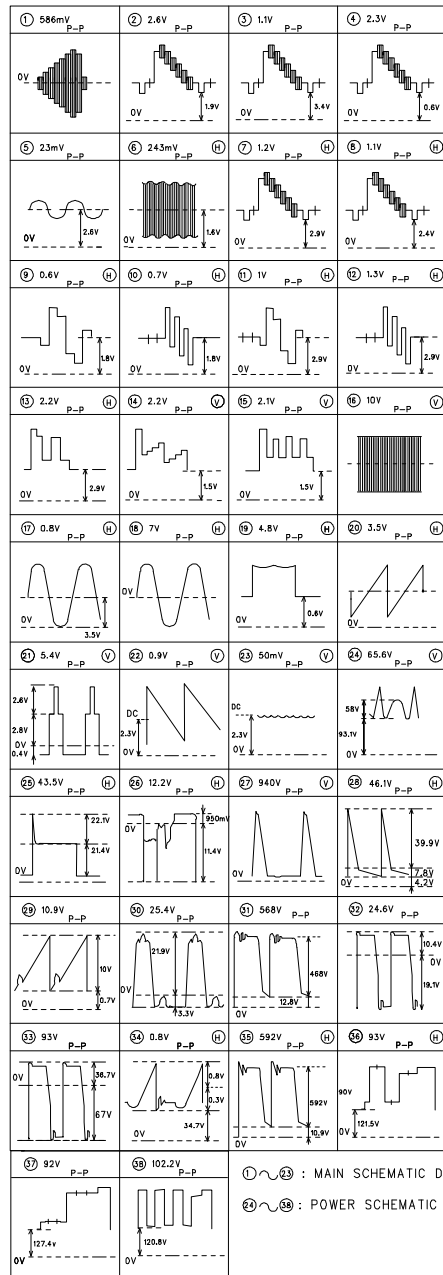

DIFFERENT PART FOR SYSTEM

Nº	LOC	PART	PAL B/G (FA)	P/S-B/G/D/K [DA]	P-I (PA)	P/S-B/G S-L/L' [LA]
1	C229	C ELECTRO	X	X	X	25V RSS 47uf
2	C231	C ELECTRO	X	X	X	50V RSS 4.7uf
3	C232	C ELECTRO	X	X	X	50V RSS 4.7uf
4	C545	C MYLAR	X	100V 0.1uf	X	100V 0.1uf
5	C555	C MYLAR	X	50V EU 0.22uf	X	50V EU 0.22uf
6	C558	C ELECTRO	X	25V RSS 47uf	X	25V RSS 47uf
7	DL07	C CERA	X	X	X	25V 0.01uf (A)
8	DL13	C CERA	X	X	X	25V 0.01uf (A)
9	DL22	C ELECTRO	X	X	X	16V RSM 47uf
10	DL23	C ELECTRO	X	X	X	16V RSM 47uf
11	CC101	C CHIP CERA	X	X	X	50V CH 22P
12	CC203	C CHIP CERA	X	X	X	50V CH 22P
13	CC204	C CHIP CERA	X	X	X	50V CH 22P
14	CC211	C CHIP CERA	X	X	X	50V CH 82P
15	CC217	C CHIP CERA	X	X	X	50V 1000P
16	CC218	C CHIP CERA	X	X	X	50V 1000P
17	CC219	C CHIP CERA	50V CH 8P	50V CH 8P	50V CH 8P	X
18	CC222	C CHIP CERA	X	X	X	50V 0.1uf
19	CC504	C CHIP CERA	X	50V 0.1uf	X	50V 0.1uf
20	CC710	C CHIP CERA	X	X	X	50V CH 16P
21	CC718	C CHIP TANTAL	X	X	X	35V 0.47uf
22	CC101	C CHIP CERA	X	X	X	50V CH 22P
23	CC102	C CHIP CERA	X	X	X	50V CH 15P
24	CC103	C CHIP CERA	X	X	X	50V 0.01uf
25	CC104	C CHIP CERA	X	X	X	50V 0.01uf
26	CC105	C CHIP CERA	X	X	X	50V 0.1uf
27	CC106	C CHIP CERA	X	X	X	50V 0.1uf
28	CC108	C CHIP CERA	X	X	X	50V 0.01uf
29	CC110	C CHIP CERA	X	X	X	50V CH 100P
30	CC112	C CHIP CERA	X	X	X	50V 0.035uf
31	CC114	C CHIP CERA	X	X	X	50V 0.047uf
32	CC115	C CHIP CERA	X	X	X	50V 0.01uf
33	CC116	C CHIP CERA	X	X	X	50V CH 82P
34	CC117	C CHIP CERA	X	X	X	50V 0.01uf
35	CC118	C CHIP CERA	X	X	X	50V 0.047uf
36	CC119	C CHIP CERA	X	X	X	50V 0.01uf
37	CC120	C CHIP TANTAL	X	X	X	25V 4.7uf
38	CC121	C CHIP TANTAL	X	X	X	16V 2.2uf
39	CC126	C CHIP TANTAL	X	X	X	25V 1uf
40	CC127	C CHIP TANTAL	X	X	X	25V 1uf
41	CC129	C CHIP TANTAL	16V 10uf	16V 10uf	16V 10uf	X
42	CC130	C CHIP TANTAL	X	X	X	25V 4.7uf
43	CC131	C CHIP CERA	X	X	X	50V CH 100P
44	CC134	C CHIP CERA	X	X	X	50V 0.01uf
45	CC135	C CHIP CERA	X	X	X	50V 0.01uf
46	CC136	C CHIP TANTAL	X	X	X	16V 10uf
47	D101	DIODE	X	X	X	1S2186
48	D102	DIODE	X	X	X	1S2186
49	D108	DIODE	X	X	X	BB909A
50	D109	DIODE ZENER	X	X	X	UZ_-5.1BM
51	D110	DIODE	X	X	X	UZ_-5.1BM
52	DL01	DIODE	X	X	X	1S2186
53	DL02	DIODE	X	X	X	1S2186
54	I201	IC	TDA8900	TDA8900	TDA8900	TDA8902
55	I501	IC	TDAB374A/N3	TDAB374A/N3	TDAB374A/N3	TDAB374/N3
56	I503	IC	X	TDAB3395	X	TDAB3395
57	IL01	IC	X	X	X	STV8225
58	IL02	IC	X	X	X	STV8225
59	IL03	IC	X	X	X	TA1238N
60	J014	WIRE COPPER	X	X	X	JUMPER WIRE
61	J029	WIRE COPPER	X	X	X	JUMPER WIRE
62	J032	WIRE COPPER	X	X	X	JUMPER WIRE
63	J039	WIRE COPPER	X	X	X	JUMPER WIRE
64	J050	WIRE COPPER	X	X	X	JUMPER WIRE
65	J085	WIRE COPPER	X	X	X	JUMPER WIRE
66	J103	WIRE COPPER	JUMPER WIRE	JUMPER WIRE	JUMPER WIRE	X
67	J113	WIRE COPPER	X	X	X	JUMPER WIRE
68	J114	WIRE COPPER	X	X	X	JUMPER WIRE
69	J115	WIRE COPPER	X	X	X	JUMPER WIRE
70	J179	WIRE COPPER	X	X	X	JUM

DIFFERENT PART FOR SYSTEM

NO	LOC	PART	PAL B/G [FA]	P/S-B/G,D/K [DA]	P-I [PA]	P/S-B/G S-L/L' [LA]
71	J88	WIRE COPPER	X	X	X	JUMPER WIRE
72	J219	WIRE COPPER	X	X	X	JUMPER WIRE
73	J238	WIRE COPPER	X	X	X	JUMPER WIRE
74	J269	WIRE COPPER	X	X	X	JUMPER WIRE
75	J274	WIRE COPPER	X	X	X	JUMPER WIRE
76	J289	WIRE COPPER	X	X	X	JUMPER WIRE
77	J295	WIRE COPPER	X	X	X	JUMPER WIRE
78	LL03	COL PEAKING	X	X	X	100uH (04)
79	LY02	COL PEAKING	X	X	X	100uH (04)
80	QC201	TR CHIP	X	X	X	KTC3881
81	QC202	TR CHIP	X	X	X	25C623
82	QC203	TR CHIP	X	X	X	25C623
83	QC204	TR CHIP	X	X	X	25C623
84	QC702	TR CHIP	X	X	X	25C623
85	QC704	TR CHIP	X	X	X	25C623
86	QCL01	TR CHIP	X	X	X	KTC3881
87	QCL02	TR CHIP	X	X	X	25C623
88	QCL03	TR CHIP	X	X	X	25C623
89	QCL05	TR CHIP	X	X	X	25C623
90	QCL07	TR CHIP	X	X	X	25C623
91	RC209	R CHIP	X	X	X	1/10W 100K
92	RC210	R CHIP	X	X	X	1/10W 15K
93	RC211	R CHIP	X	X	X	1/10W 2.2K
94	RC213	R CHIP	X	X	X	1/10W 10K
95	RC214	R CHIP	X	X	X	1/10W 10K
96	RC215	R CHIP	X	X	X	1/10W 10K
97	RC216	R CHIP	X	X	X	1/10W 68K
98	RC217	R CHIP	X	X	X	1/10W 100
99	RC225	R CHIP	X	X	X	1/10W 10K
100	RC226	R CHIP	X	X	X	1/10W 7.5K
101	RC228	R CHIP	X	X	X	1/10W 22K
102	RC229	R CHIP	X	X	X	1/10W 330
103	RC234	R CHIP	X	X	X	1/10W 47
104	RC237	R CHIP	X	X	X	1/10W 750
105	RC501	R CHIP	X	X	X	1/10W 33K
106	RC541	R CHIP	X	X	X	1/10W 10K
107	RC542	R CHIP	X	X	X	1/10W 10K
108	RC702	R CHIP	X	X	X	1/10W 10K
109	RC726	R CHIP	X	X	X	1/10W 24K
110	RC727	R CHIP	X	X	X	1/10W 4.7K
111	RC731	R CHIP	X	X	X	1/10W 10K
112	RC739	R CHIP	X	X	X	1/10W 4.7K
113	RC774	R CHIP	X	X	X	1/10W 24K
114	RCJ05	R CHIP	1/10W 0	1/10W 0	1/10W 0	X
115	RCJ06	R CHIP	1/10W 0	1/10W 0	1/10W 0	X
116	RCJ19	R CHIP	X	X	X	1/10W 0
117	RCJ26	R CHIP	1/10W 0	1/10W 0	1/10W 0	X
118	RCJ31	R CHIP	1/10W 0	1/10W 0	1/10W 0	X
119	RCJ33	R CHIP	X	X	X	1/10W 0
120	RCL02	R CHIP	X	X	X	1/10W 68K
121	RCL03	R CHIP	X	X	X	1/10W 2.2K
122	RCL07	R CHIP	X	X	X	1/10W 33K
123	RCL12	R CHIP	X	X	X	1/10W 10K
124	RCL13	R CHIP	X	X	X	1/10W 10K
125	RCL14	R CHIP	X	X	X	1/10W 10K
126	RCL15	R CHIP	X	X	X	1/10W 10K
127	RCL16	R CHIP	X	X	X	1/10W 100
128	RCL17	R CHIP	X	X	X	1/10W 750
129	RCL18	R CHIP	X	X	X	1/10W 15K
130	RCL30	R CHIP	X	X	X	1/10W 1K
131	RCL31	R CHIP	X	X	X	1/10W 33K
132	RCL32	R CHIP	X	X	X	1/10W 12K
133	RCL33	R CHIP	X	X	X	1/10W 2K
134	RCL34	R CHIP	X	X	X	1/10W 560
135	RCL36	R CHIP	X	X	X	1/10W 1K
136	R203	R CARBON FILN	X	X	X	1/6W 100K
137	R218	R CARBON FILN	X	X	X	1/6W 22K
138	R227	R CARBON FILN	X	X	X	1/6W 47
139	R240	R SEMI FIXED	X	X	X	10K8
140	R505	R CARBON FILN	X	1/4W 10	X	1/4W 10

DIFFERENT PART FOR SYSTEM

[illegible]

DIFFERENT PARTS FOR SIZE

NO	LOC	PART	14"	20"
1	L404	COIL, H-LINEARITY	L-125	L-102
2	C415	C MYLAR	200V PV 0.47uF	200V PV 0.36uF
3	R834	R CARBON FILM	1/4W 100	1/4W 91
4	R833	R CARBON FILM	1/4W 4.7K	1/4W 5.1K
5	R301	R CARBON FILM	1/4W 1.8K	1/4W 2.2K
6	R419	R M-OXIDE FILM	1W 12	1W 2.4
7	R572	R CARBON FILM	1/6W 8.2K	1/6W 6.8K

RESISTOR

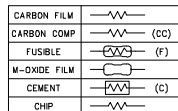

COIL

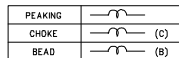

CAPACITOR

ELECTRO	
ELECTRO NONPOLAR	(NP)
TANTAL	
CERAMIC	
MYLAR	(M)
CHIP	

DIFFERENT PARTS FOR 1,2TUNER

NO	LOC	PART	DVT-14FL6 (2 TUNER)	DVT-14FL6 (1 TUNER)
1	ANT01	MODULE RF	PH-RF -9701A	
2	C225	C ELECTRO	50V R55 22uF	X
3	C226	C ELECTRO	25V R55 47uF	X
4	C227	C ELECTRO	50V R55 1uF	X
5	C229	C ELECTRO	25V R55 47uF	X
6	C230	C ELECTRO	50V R55 470uF	X
7	C331	C ELECTRO	50V R55 4.7uF	X
8	C232	C ELECTRO	50V R55 4.7uF	X
9	C233	C ELECTRO	25V R55 100uF	X
10	C514	C CERA	X	50V 0.047uF
11	C556	C ELECTRO	25V R55 47uF	X
12	C557	C ELECTRO	25V R55 47uF	X
13	C724	C ELECTRO	25V R55 220uF	X
14	CC108	C CHIP CERA	50V 1000PF	X
15	CC110	C CHIP CERA	50V 0.01uF	X
16	CC111	C CHIP CERA	50V 0.01uF	X
17	CC112	C CHIP CERA	50V 0.01uF	X
18	CC201	C CHIP CERA	50V 0.533uF	X
19	CC202	C CHIP CERA	50V 0.622uF	X
20	CC203	C CHIP CERA	50V CH 22PF	X
21	CC204	C CHIP CERA	50V CH 22PF	X
22	CC205	C CHIP CERA	50V CH 82PF	X
23	CC206	C CHIP CERA	50V 0.1uF	X
24	CC207	C CHIP CERA	50V 0.1uF	X
25	CC208	C CHIP CERA	50V 0.01uF	X
26	CC209	C CHIP CERA	25V 0.22uF	X
27	CC211	C CHIP CERA	50V CH 82PF	X
28	CC212	C CHIP CERA	50V 0.1uF	X
29	CC213	C CHIP CERA	50V 1000PF	X
30	CC214	C CHIP CERA	50V CH 39PF	X

DIFFERENT PARTS FOR 1,2TUNER

NO	LOC	PART	DVT-14FL6 (2 TUNER)	DVT-14FL6 (1 TUNER)
31	CC215	C CHIP CERA	50V CH 22PF	X
32	CC217	C CHIP CERA	50V 1000PF	X
33	CC218	C CHIP CERA	50V 1000PF	X
34	CC220	C CHIP CERA	50V 4700PF	X
35	CC221	C CHIP CERA	50V 0.1uF	X
36	CC222	C CHIP CERA	50V 0.1uF	X
37	CC223	C CHIP CERA	50V 0.033uF	X
38	CC224	C CHIP CERA	50V 0.01uF	X
39	CC225	C CHIP CERA	50V 0.1uF	X
40	CC228	C CHIP TANTAL	16V 2.2uF	X
41	CC235	C CHIP CERA	50V CH 220PF	X
42	CC236	C CHIP CERA	50V CH 220PF	X
43	CC509	C CHIP CERA	50V 0.1uF	X
44	D101	DIODE	1S2186	X
45	D102	DIODE	1S2186	X
46	D103	DIODE	JUMPER WIRE	X
47	D108	DIODE	BB909A	X
48	D109	DIODE	UZ-5.1BM	X
49	D110	DIODE	UZ-5.1BM	X
50	D111	DIODE	UZ-5.1BM	X
51	D113	DIODE	X	UZ-5.1BM
52	D707	DIODE	UZ-9.1BM	X
53	I201	IC	TD49802	X
54	I504	IC	1C40538P	X
55	I102	IC	STV8225	X
56	J012	WIRE COPPER	JUMPER WIRE	X
57	J038	WIRE COPPER	JUMPER WIRE	X
58	J039	WIRE COPPER	JUMPER WIRE	X
59	J041	WIRE COPPER	JUMPER WIRE	X
60	J042	WIRE COPPER	JUMPER WIRE	X

DIFFERENT PARTS FOR 1,2TUNER

NO	LOC	PART	DVT-14FLA (2 TUNER)	DVT-14FL1 (1 TUNER)
61	J043	WIRE COPPER	JUMPER WIRE	X
62	J044	WIRE COPPER	JUMPER WIRE	X
63	J045	WIRE COPPER	JUMPER WIRE	X
64	J049	WIRE COPPER	JUMPER WIRE	X
65	J060	WIRE COPPER	JUMPER WIRE	X
66	J066	WIRE COPPER	JUMPER WIRE	X
67	J067	WIRE COPPER	JUMPER WIRE	X
68	J101	WIRE COPPER	JUMPER WIRE	X
69	J115	WIRE COPPER	JUMPER WIRE	X
70	J132	WIRE COPPER	JUMPER WIRE	X
71	J188	WIRE COPPER	JUMPER WIRE	X
72	J259	WIRE COPPER	X	JUMPER WIRE
73	J266	WIRE COPPER	X	JUMPER WIRE
74	J271	WIRE COPPER	JUMPER WIRE	X
75	J272	WIRE COPPER	JUMPER WIRE	X
76	J278	WIRE COPPER	JUMPER WIRE	X
77	L101	COIL CHOKE	TRF-1201B	X
78	L201	COIL PIF	TRF-7780A	X
79	L202	COIL PEAKING	15uH	X
80	L203	COIL PEAKING	22uH	X
81	QC001	TR CHIP	KTC3881	X
82	QC002	TR CHIP	25A812	X
83	QC001	TR CHIP	KTC3881	X
84	QC002	TR CHIP	25C1623	X
85	QC003	TR CHIP	25C1623	X
86	QC004	TR CHIP	25C1623	X
87	QC005	TR CHIP	25C1623	X
88	QCL06	TR CHIP	25C1623	X
89	R112	R CARBON FILM	1/6W 1.2K	X
90	R122	R CARBON FILM	1/6W 220	X

DIFFERENT PARTS FOR 1,2TUNER

NO	LOC	PART	DVT-14FLA (2 TUNER)	DVT-14FL1 (1 TUNER)
91	R202	R SEMI FIXED	20K	
92	R203	R CARBON FILM	1/6W 100K	X
93	R218	R CARBON FILM	1/6W 22K	X
94	R219	R CARBON FILM	1/6W 8.5K	X
95	R227	R CARBON FILM	1/6W 47	X
96	R240	R SEMI FIXED	10K	X
97	R517	R CARBON FILM	1/6W 100	X
98	R738	R M-OXIDE FILM	2W 27	X
99	RC106	R CHP	1/10W 47	X
100	RC107	R CHP	1/10W 1.2K	X
101	RC108	R CHP	1/10W 4.7K	X
102	RC109	R CHP	1/10W 100	X
103	RC110	R CHP	1/10W 1.2K	X
104	RC201	R CHP	1/10W 1.8K	X
105	RC204	R CHP	1/10W 3K	X
106	RC205	R CHP	1/10W 270	X
107	RC207	R CHP	1/10W 22K	X
108	RC208	R CHP	1/10W 22K	X
109	RC209	R CHP	1/10W 100K	X
110	RC210	R CHP	1/10W 15K	X
111	RC211	R CHP	1/10W 22K	X
112	RC213	R CHP	1/10W 10K	X
113	RC214	R CHP	1/10W 10K	X
114	RC215	R CHP	1/10W 10K	X
115	RC216	R CHP	1/10W 68K	X
116	RC217	R CHP	1/10W 100	X
117	RC221	R CHP	1/10W 33K	X
118	RC224	R CHP	1/10W 56K	X
119	RC225	R CHP	1/10W 10K	X
120	RC226	R CHP	1/10W 7.5K	X

DIFFERENT PARTS FOR 1,2TUNER

NO	LOC	PART	DVT-14FLA (2 TUNER)	DVT-14FL (1 TUNER)
121	RC228	R CHIP	1/10W 23K	X
122	RC229	R CHIP	1/10W 330	X
123	RC230	R CHIP	1/10W 1.5K	X
124	RC231	R CHIP	1/10W 1K	X
125	RC233	R CHIP	1/10W 1K	X
126	RC235	R CHIP	1/10W 560	X
127	RC236	R CHIP	1/10W 470	X
128	RC237	R CHIP	1/10W 750	X
129	RC239	R CHIP	1/10W 2.4K	X
130	RC501	R CHIP	1/10W 33K	X
131	RC528	R CHIP	1/10W 1K	1/10W 470
132	RC582	R CHIP	1/10W 0	1/10W 470
133	RC718	R CHIP	1/10W 100	X
134	RC719	R CHIP	1/10W 100	X
135	RC745	R CHIP	X	1/10W 10K
136	RCJ13	R CHIP	1/10W 0	X
137	RCJ28	R CHIP	1/10W 0	X
138	RCJ34	R CHIP	X	1/10W 0
139	FD05	FILTER SAW	E1966M	X
140	SF04	FILTER SAW	19457M	X
141	U102	TUNER VARATOR	TELEOP84A	X
142	U102A	JACK PHONE PLUG	250mm	X
143	Z204	FILTER CERA	SF5HS.5WB	X
144	Z205	FILTER CERA	MKT40WA100P	X
145	Z206	FILTER CERA	TP5S.5WB	X
146				
147				
148				
149				
150				

3. Block Diagram

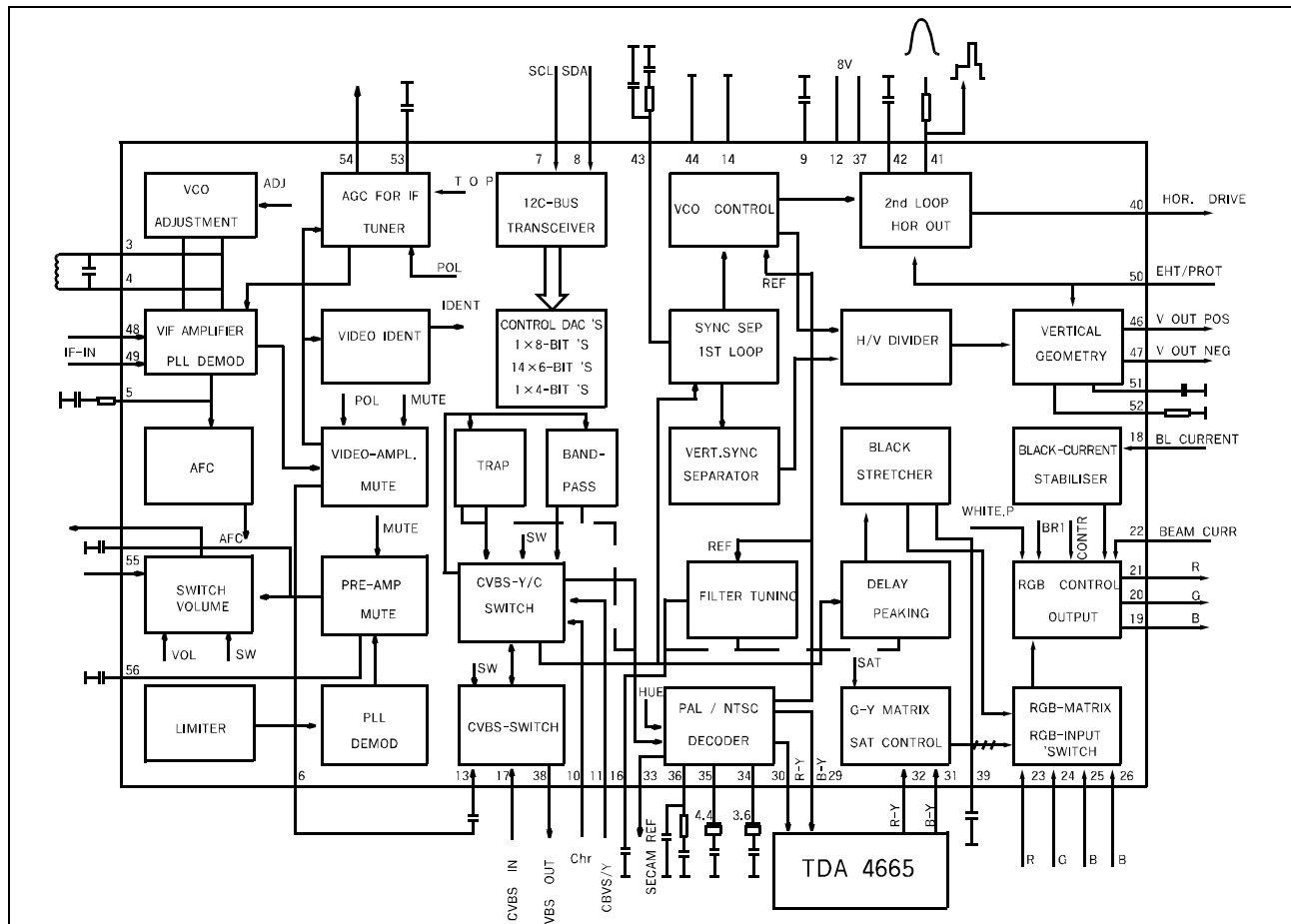

3. BLOCK DIAGRAM

3-1. Audio Signal Flow

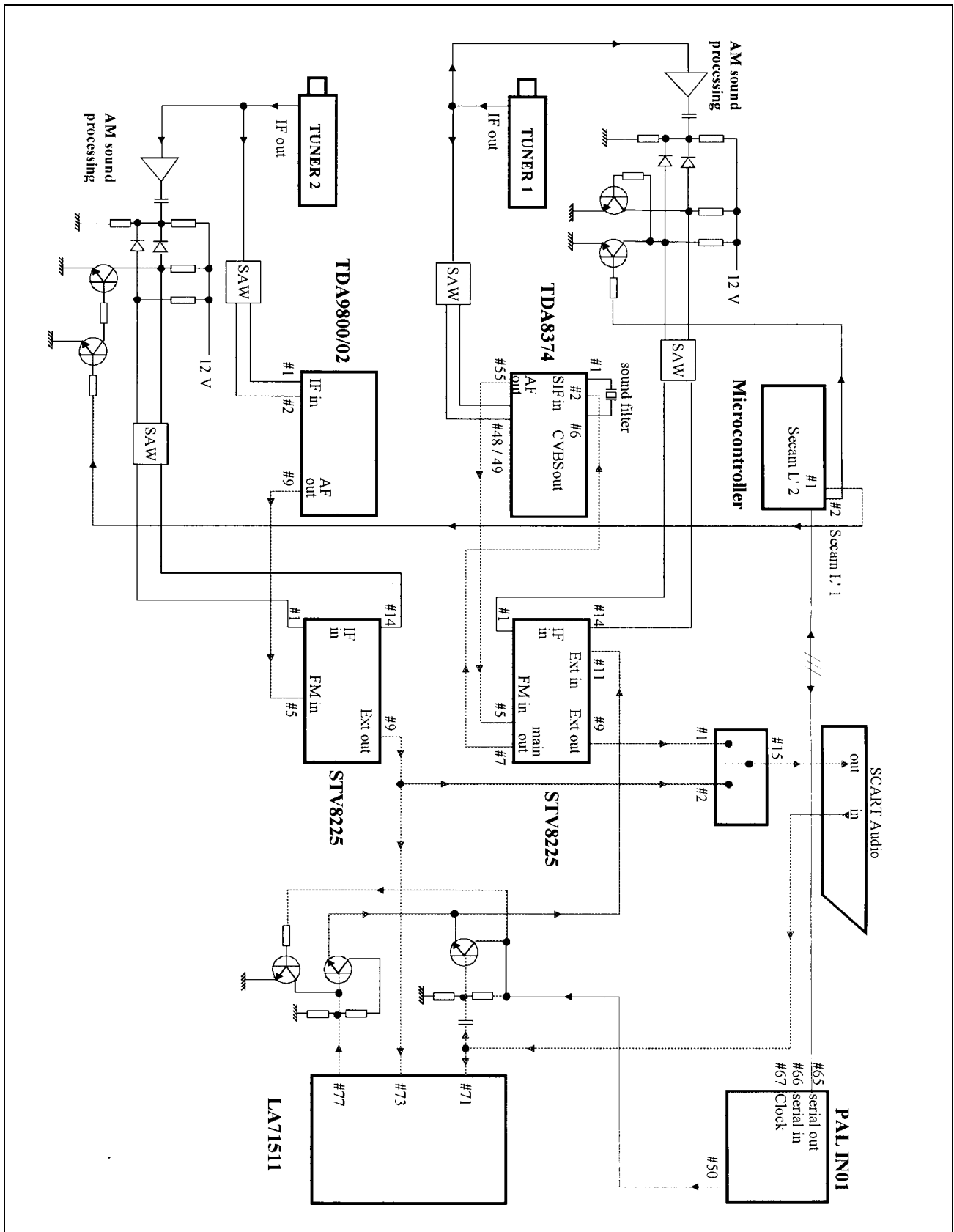

3-2. Video Signal Flow

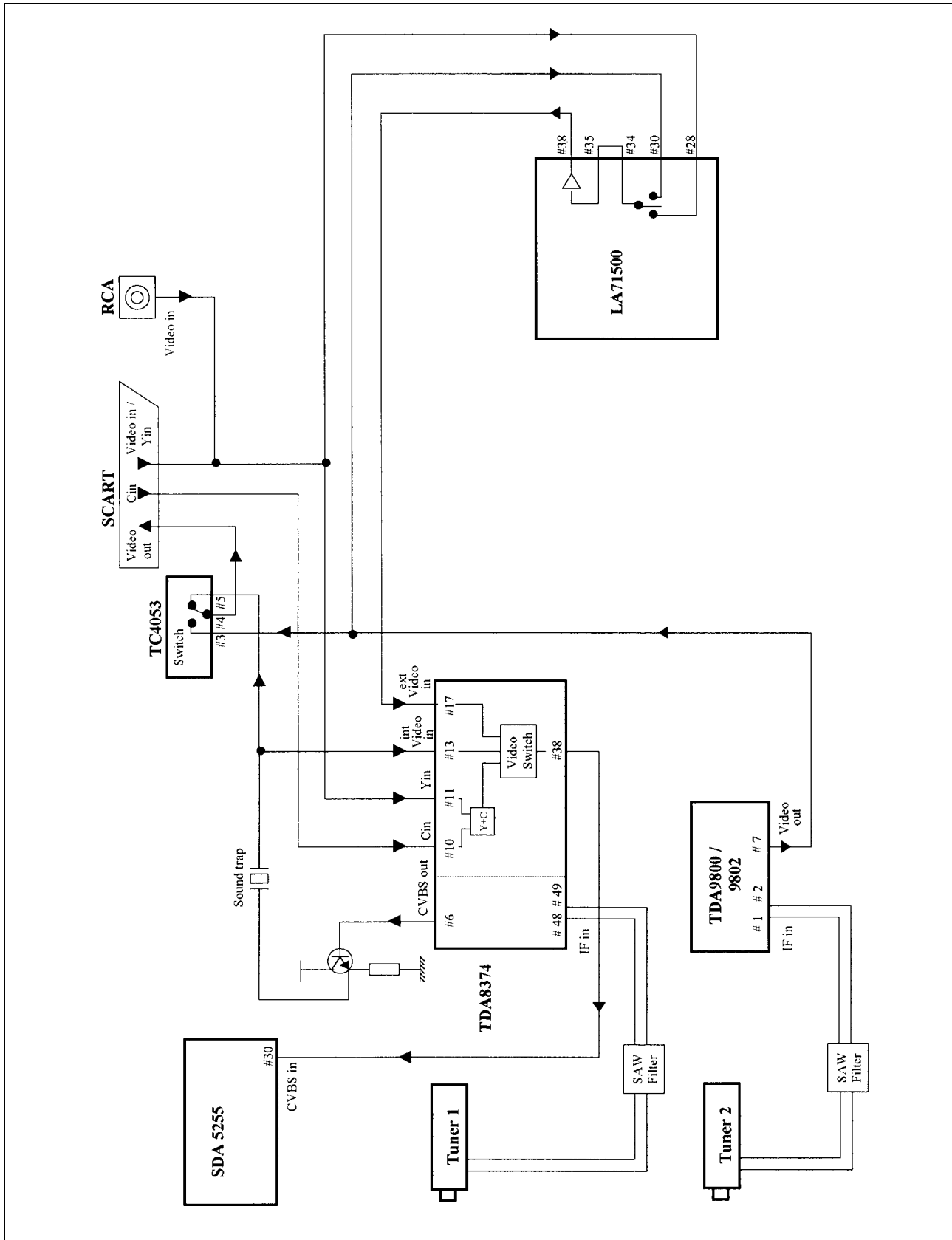

3-3. TV and monitor power switching

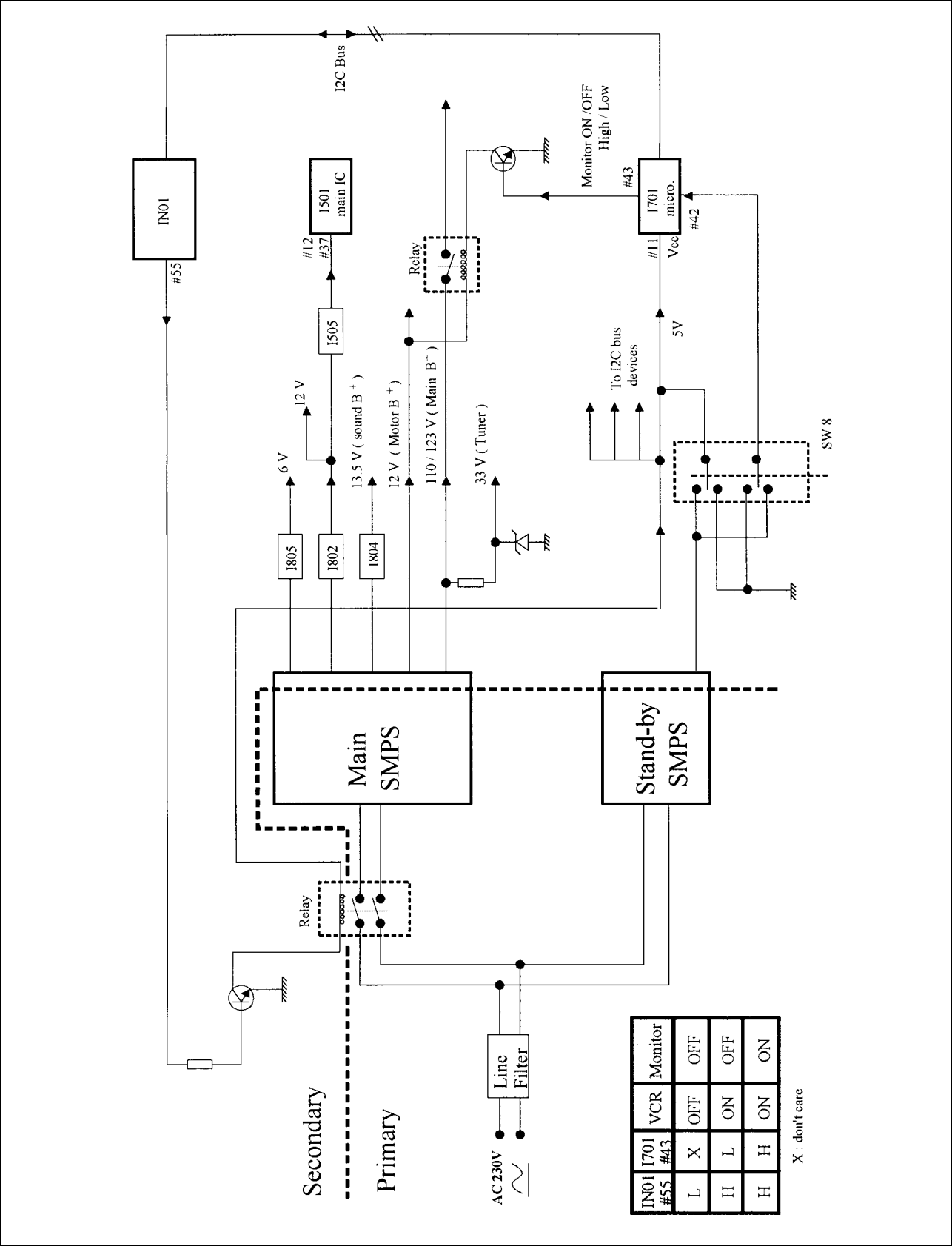

DVT-14F8

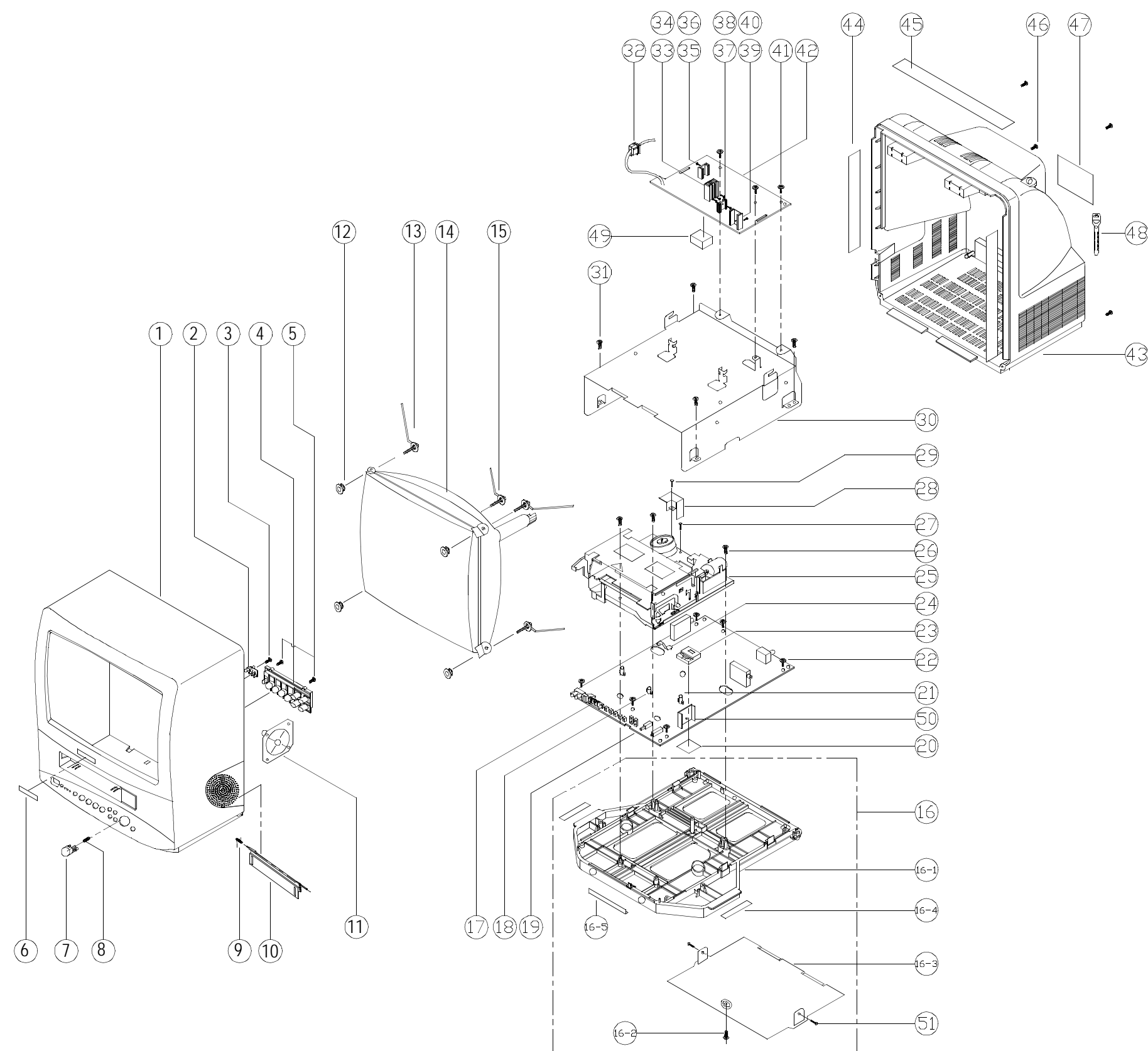

No	PART CODE	PART NAME	Qty	MATERIAL	REMARKS
51	7128301212	SCREW TAPPING	2	T2S WAS 3X12 MFZN BK	30+52
50	4857018900	PLT HT SINK IC	1	AL	
49	4857913304	RUBBER SPONGE	1	13.5X11X30	
48	97P4602700	CLAMP CORD	1	NYLON 66 BLK 5280N	
47	4855415800	SPEC PLATE	1	150ART P/E FILM	
46	7122401612	SCREW TAPPING	4	T2S TRS 4X16 MFZN BK	1+43
45	4857817610	CLOTH BLACK	2	FELT T0.7 L=300	
44	4857817630	CLOTH BLACK	1	FELT T0.7 L=400	
43	4852149311	COVER BACK	1	HIPS BK	
42		POWER PCB	1		
41	7128301212	SCREW TAPPING	3	T2S WAS 3X12 MFZN BK	30+42
40	7174301011	SCREW TAPPTITE	2	TT2 RND 3X10 MFZN	
39	4857024617	HEAT SINK	1	AL EX	
38	7174301011	SCREW TAPPTITE	1	TT2 RND 3X10 MFZN	
37	4857024510	HEAT SINK	1	AL EX	
36	7174301011	SCREW TAPPTITE	1	TT2 RND 3X10 MFZN	
35	4857026900	HEAT SINK	1	AL EX	
34	7174301011	SCREW TAPPTITE	3	TT2 RND 3X10 MFZN	
33	4857027301	HEAT SINK	1	AL EX	
32	97P2316600	HOLDER AC CORD	1	NYLON66 UL/CSA	
31	7122401612	SCREW TAPPING	4	T2S TRS 4X16 MFZN BK	16+30
30	4857242900	COVER TOP	1	SPTH-C T=0.8	
29	7174301011	SCREW TAPPTITE	1	TT2 RND 3X10 MFZN	25+28
28	4857243300	SHIELD COVER	1	SPTH-C T0.3	
27	7124301211	SCREW TAPPING	1	T2S RND 3X12 MFZN	16+25
26	7122401612	SCREW TAPPING	3	T2S TRS 4X16 MFZN BK	16+25
25	4851930100	DECK AS	1	DRP-7103(2HD,SP)	
24	4853948400	BRKT EARTH	1	CS212P-1/2H T0.15	
23	4851923500	SHIELD CASE AS	1	DVN-14F7JA	
22	7128301212	SCREW TAPPING	6	T2S WAS 3X12 MFZN BK	16+19
21	97P2338200	HOLDER TR	2	ABS	
20	4857242000	SHIELD PLATE	1	SPTH-C T0.3	
19		MAIN PCB	1		
18	97P2339600	HOLDER IR	1	ABS	
17	4853530800	HOLDER LED	1	FR HIPS BK	
16-5	4857817640	CLOTH BLACK	1	FELT T0.7 L=100	
16-4	4857817620	CLOTH BLACK	2	FELT T0.5 L=100	
16-3	4857243000	SHIELD BUTTOM	1	SPTH T0.3	
16-2	7122401612	SCREW TAPPING	1	T2S TRS4X16 MFZN BK	16+52
16-1	4853816000	FRAME MAIN PCB	1	FR HIPS BK	
16	4851931601	M/FRAME P ASS'Y	1		
15	4856013302	SCREW CRT FIXING AS	2	L=190MM	
14		CRT(14")	1		
13	4856013300	SCREW CRT FIXING AS	2	L=70MM	
12	4856215402	WASHER RUBBER	4	CR T2 0	
11	4858309110	SPEAKER	1	3W 8OHM A30C-560	
10	4851926400	DOOR F/L AS	1	2817701+7823301	
9	4856723100	SPRING F/L DOOR	1	SWPB PIE 0.45	
8	4856715600	SPRING	1	SWPA	
7	4854849901	BUTTON POWER	1	ABS BK	
6	48556136GU	MARK BRAND	1	A1050P-H24 T0.4	
5	7128301212	SCREW TAPPING	2	T2S WAS 3X12 MFZN BK	1+4
4	4851929700	BUTTON CTRL AS	1	4934501+HOLDER BUTTON	
3	7128301012	SCREW TAPPING	1	T2S WAS 3X10 MFZN BK	1+2
2	4851927000	DECO SENSOR AS	1	5532100+7817901	
1	4852063001	MASK FRONT	1	HIPS BK	

ELECTRICAL PARTS LIST

WARNING

COMPONENTS MARKED WITH THIS SYMBOL MUST ONLY BE REPLACED BY A COMPONENT HAVING IDENTICAL PHYSICAL CHARACTERISTICS.

LOC	PART CODE	PART NAME	PART TYPE	REMARK
M821	4858213800	BAG INSTRUCTION	L.D.P.E T0.05X250X400	⚠
M211	4852149321	COVER BACK	HIPS BK	
M541	4855415800	SPEC PLATE	150ART P/E FILM (C/TV)	
M781	4857817610	CLOTH BLACK	FELT T0.7 L=300	
M782	4857817611	CLOTH BLACK	FELT T0.7 L=200	
M641	6520010100	STAPLE PIN	18M/M J D O	
M801	4858035800	BOX CARTON	SW-3	
M811	4858182200	PAD	EPS 14F6	
M822	4858215700	BAG PE	1000X950	
ZZ131	48519A4610	CRT GROUND AS	1401H-1015-1P	
L901	58G0000084	COIL DEGAUSSING	DC-1450	
M191	4851927300	DECO SENSOR AS	5526100+7817901	
M191A	7128301011	SCREW TAPPING	T2S WAS 3X10 MFZN	
M192	4851926400	DOOR F/L AS	2817701+7823301	
M192A	4856719800	SPRING	SWPB 0.35	
M211A	7122401612	SCREW TAPPING	T2S TRS 4X16 MFZN BK	
M211C	97P4602700	CLAMP CORD	NYLON 66 BLK 5280N	
M481	4854845801	BUTTON POWER	ABS BK	
M481A	4856715600	SPRING	SWPA	
M491	4854930001	BUTTON	ABS BK	
M491A	7128301011	SCREW TAPPING	T2S WAS 3X10 MFZN	
M561	4855613600	MARK BRAND	COPPER T0.4	
M601A	4856013300	SCREW CRT FIXING AS	30X80 BK	
M601B	4856013301	SCREW CRT FIXING AS	30X140 YL	
M622	4856215402	WASHER RUBBER	CR	
V01	58D1000046	COIL DY	ODY-M1401	
V02	48A96R004-	RUBBER WEDGE	HMR 28 SR (I0X54)	
V03	4850PM001-	MAGNET CP	NY-225 (MINI NECK)	
V04	2TG00020--	TAPE GLASS	20MMX30M	
V05	2224050033	BOND SILICON	RTV 252	

LOC	PART CODE	PART NAME	PART TYPE	REMARK
V901	48A96414P1	CRT BARE	A34JLL90X	⚠
M201	4852064301	MASK FRONT	HIPS BK	
PA601	4850703S03	CONN AS	YH025-03+YST025+ULW=200	
SP601	4858312410	SPEAKER	SP-77A04	
ANT01	4850M03110	MODULE RF	PH-RF-9701A	
D101	D1S2186---	DIODE	1S2186	
D102	D1S2186---	DIODE	1S2186	
D108	DBB909A---	DIODE	BB909A	
DL01	D1S2186---	DIODE	1S2186	
DL02	D1S2186---	DIODE	1S2186	
DN01	DS15312H--	LED IR	SI5312-H	
DN01A	97P2339600	HOLDER IR	ABS	
DQ01	DKLY114L--	LED	KLY 114-L (YELLOW)	
DQ02	DKLG114L--	LED	KLG-114L	
DQ03	DKLR114L--	LED	KLR114L	
HP601	4859102430	JACK EARPHONE	YSC-1538	
I201	1TDA9802--	IC	TDA9802	
I501	1TDA8374N3	IC VIDEO PROCESSOR	TDA8374/N3	
I502	1TDA4665V4	IC DELAY	TDA4665/V4	
I503	1TDA8395--	IC	TDA8395	
I504	1TC4053BP-	IC	TC4053BP	
I505	1KA7808---	IC REGULATOR	KA7808	
I601	PTB2SW8900	HEAT SINK ASS`Y	1TDA7056-- + 7174300811	
I601	1TDA7056--	IC	TDA7056	
I601A	4857018900	HEAT SINK IC	A1050P-H24 T1.6	
I601B	7174300811	SCREW TAPPTITE	TT2 RND 3X8 MFZN	
I702	1MN1280R--	IC	MN1280R	
I703	1CAT24C08P	IC	CAT24C08P	
IL01	1STV8225--	IC SIF	STV8225	
IL02	1STV8225--	IC SIF	STV8225	
IN02	1K1A7042P-	IC SWITCH	KIA7042P	
IN03	1BA6209---	IC	BA6209	
IQ01	1TFMW5380-	IC PREAMP	TFMW5380	
IY03	1TA1238N--	IC SECAM.L	TA1238N	
IY04	1LA70001--	IC PREAMP	LA70001 (2HD)	
JA01	4859104940	JACK PHONO	YSC02P-4100-13A	

LOC	PART CODE	PART NAME	PART TYPE	REMARK
JS01	4859200401	SOCKET RGB	SR-21A1 (ANGLE TYPE)	
L101	58C9780027	COIL CHOKE	TRF-1201B (0.97 UH)	
L102	58E0000S37	COIL AFT	TRF-A001	
L103	58C9780027	COIL CHOKE	TRF-1201B (0.97 UH)	
L201	58B0000S88	COIL PIF	TRF-7780A (STICK)	
L604	58C6R8J067	COIL CHOKE	TRF-1015C (6.8UH J)	
M193	4851930200	DECK AS	DRP-7203(2HD,SP/LP)	
M194	4851931601	FRAME MAIN PCB AS	3816000+7817620+7817640	
M194A	7122401612	SCREW TAPPING	T2S TRS 4X16 MFZN BK	
M194B	7121301212	SCREW TAPPING	T2S PAN 3X12 MFZN BK	
M194C	7128301212	SCREW TAPPING	T2S WAS 3X12 MFZN BK	
M231	97P2316600	HOLDER AC CORD	NYLON66 UL/CSA	
M351	4853530800	HOLDER LED	FR HIPS BK	
M391	4853948400	BRKT EARTH	C5212P-1/2M T0.15	
M681	4856812001	TIE CABLE	NYLON66 DA100	
M682	4856814600	CLAMP WIRE	NYLON 66	
M721	4857242900	SHIELD TOP	SECC-O T0.8	
M721A	7122401612	SCREW TAPPING	T2S TRS 4X16 MFZN BK	
M721B	7128301212	SCREW TAPPING	T2S WAS 3X12 MFZN BK	
M722	4851923500	SHIELD CASE AS	DVN-14F7JA	
M723	4857242000	SHIELD PLATE	SPTH-C T0.3	
M724	4857243300	SHIELD CASE	ET T0.3	
M724A	7174300811	SCREW TAPPTITE	TT2 RND 3X8 MFZN	
M725A	7128301011	SCREW TAPPING	T2S WAS 3X10 MFZN	
M791	4857913304	RUBBER CUSHION	FR RUBBER SPONGE	
PA405	4850705S02	CONN AS	YH025-05+YST025+ULW=200	
PA406	4850705S03	CONN AS	YH025-05+YST025+ULW=300	
PA408	4850707S12	CONN AS	YH025-07+YST025+UAW=400	
PA803	4850703S20	CONN AS	YH025-03+YST025+ULW=400	
PA805	4850710V04	CONN AS	YH025-10+YBNH250+ULW=200	
PAN01	4850707V04	CONN AS	60-8283-3078-45+ULW=200	
PAY01	4859245710	CONN HOUSING	00-8370-041-000-800	
PAY02	4850702V07	CONN AS	BIC-02H-20T+USW=100	
PAY03	4850706V10	CONN AS	60-8283-3068-45+UAW=150	
PN02	4859278120	CONN WAFER	TKC-G06P-A1	
PN03	4859278220	CONN WAFER	TKC-G10P-A1	
R580	RF-2Y100J-	R FUSIBLE	1/2W 10 OHM J	
SF01	5PG1966M--	FILTER SAW	G1966M	
SF02	5PL9461M--	FILTER SAW	L 9461-M	

LOC	PART CODE	PART NAME	PART TYPE	REMARK
SF03	5PG1966M--	FILTER SAW	G1966M	
SF04	5PL9461M--	FILTER SAW	L 9461-M	
SN01	1SG239S---	IC SENSOR	SG-239S	
SN02	1SG239S---	IC SENSOR	SG-239S	
SN03	TST5811---	TR PHOTO	ST-5811(D-RANK)	
SN03A	97P2338200	HOLDER TR	ABS	
SN04	TST5811---	TR PHOTO	ST-5811(D-RANK)	
SN04A	97P2338200	HOLDER TR	ABS	
SW01	5SN0101Z20	SW DETECT	JDS1105-6X	
SW06	5S50202002	SW TACT	JTM-1108B 2C-2P	
SW07	5S50202002	SW TACT	JTM-1108B 2C-2P	
SW08	5S40202013	SW PUSH	SPUJ19XSM011(KPJ 2S1B)	
TY01	5800000032	COIL OSC	DE0-006	
U101	4859717030	TUNER VARACTOR	TELE9-084A	
U101A	4859005350	JACK PHONE PLUG AS	PLUG+CABLE1365 AWG24=150D	
U102	4859717030	TUNER VARACTOR	TELE9-084A	
U102A	4859005450	JACK PHONE PLUG AS	PLUG+CABLE1365 AWG24=250D	
X701	5XE18R000E	CRYSTAL QUARTZ	HC-49/U 18.000MHZ 30PPM	
Z203	5PMKT40MA-	FILTER CERA	MKT40MA100P	
Z205	5PMKT40MA-	FILTER CERA	MKT40MA100P	
ZZ200	PTMPJ2A531	PCB CHIP MOUNT B AS	DVT-14F6LA	
CC101	HCQK220JCA	C CHIP CERA	50V CH 22PF J 2012	
CC102	HCFK104ZCA	C CHIP CERA	50V Y5V 0.1MF Z 2012	
CC103	HCFK103ZCA	C CHIP CERA	50V Y5V 0.01MF Z 2012	
CC104	HCFK104ZCA	C CHIP CERA	50V Y5V 0.1MF Z 2012	
CC105	HCFK104ZCA	C CHIP CERA	50V Y5V 0.1MF Z 2012	
CC108	HCBK102KCA	C CHIP CERA	50V X7R 1000PF K 2012	
CC109	HCQK101JCA	C CHIP CERA	50V CH 100PF J 2012	
CC110	HCFK103ZCA	C CHIP CERA	50V Y5V 0.01MF Z 2012	
CC111	HCFK103ZCA	C CHIP CERA	50V Y5V 0.01MF Z 2012	
CC112	HCFK103ZCA	C CHIP CERA	50V Y5V 0.01MF Z 2012	
CC113	HCFK103ZCA	C CHIP CERA	50V Y5V 0.01MF Z 2012	
CC114	HCQK102JCA	C CHIP CERA	50V CH 1000PF J 2012	
CC115	HCFK103ZCA	C CHIP CERA	50V Y5V 0.01MF Z 2012	
CC116	HCQK101JCA	C CHIP CERA	50V CH 100PF J 2012	
CC117	HCFK103ZCA	C CHIP CERA	50V Y5V 0.01MF Z 2012	
CC118	HCQK221JCA	C CHIP CERA	50V CH 220PF J 2012	
CC119	HCQK221JCA	C CHIP CERA	50V CH 220PF J 2012	
CC201	HCBK333KCA	C CHIP CERA	50V X7R 0.033MF K 2012	

LOC	PART CODE	PART NAME	PART TYPE	REMARK
CC202	HCBK223KCA	C CHIP CERA	50V X7R 0.022MF K 2012	
CC203	HCQK220JCA	C CHIP CERA	50V CH 22PF J 2012	
CC204	HCQK220JCA	C CHIP CERA	50V CH 22PF J 2012	
CC205	HCQK820JCA	C CHIP CERA	50V CH 82PF J 2012	
CC206	HCFK104ZCA	C CHIP CERA	50V Y5V 0.1MF Z 2012	
CC207	HCFK104ZCA	C CHIP CERA	50V Y5V 0.1MF Z 2012	
CC208	HCFK103ZCA	C CHIP CERA	50V Y5V 0.01MF Z 2012	
CC209	HCBH224KCA	C CHIP CERA	25V X7R 0.22MF K 2012	
CC211	HCQK820JCA	C CHIP CERA	50V CH 82PF J 2012	
CC212	HCFK104ZCA	C CHIP CERA	50V Y5V 0.1MF Z 2012	
CC213	HCBK102KCA	C CHIP CERA	50V X7R 1000PF K 2012	
CC214	HCQK390JCA	C CHIP CERA	50V CH 39PF J 2012	
CC215	HCQK220JCA	C CHIP CERA	50V CH 22PF J 2012	
CC217	HCBK102KCA	C CHIP CERA	50V X7R 1000PF K 2012	
CC218	HCBK102KCA	C CHIP CERA	50V X7R 1000PF K 2012	
CC220	HCBK472KCA	C CHIP CERA	50V X7R 4700PF K 2012	
CC221	HCFK104ZCA	C CHIP CERA	50V Y5V 0.1MF Z 2012	
CC222	HCFK104ZCA	C CHIP CERA	50V Y5V 0.1MF Z 2012	
CC223	HCBK333KCA	C CHIP CERA	50V X7R 0.033MF K 2012	
CC224	HCFK103ZCA	C CHIP CERA	50V Y5V 0.01MF Z 2012	
CC225	HCFK104ZCA	C CHIP CERA	50V Y5V 0.1MF Z 2012	
CC228	HCTAF229MB	C CHIP TANTAL	16V 2.2MF M 3216	
CC235	HCQK221JCA	C CHIP CERA	50V CH 220PF J 2012	
CC236	HCQK221JCA	C CHIP CERA	50V CH 220PF J 2012	
CC503	HCTAJ478MB	C CHIP TANTAL	35V 0.47MF M 3216	
CC504	HCFK104ZCA	C CHIP CERA	50V Y5V 0.1MF Z 2012	
CC505	HCTAJ478MB	C CHIP TANTAL	35V 0.47MF M 3216	
CC506	HCFK104ZCA	C CHIP CERA	50V Y5V 0.1MF Z 2012	
CC507	HCFK104ZCA	C CHIP CERA	50V Y5V 0.1MF Z 2012	
CC508	HCFK104ZCA	C CHIP CERA	50V Y5V 0.1MF Z 2012	
CC509	HCFK104ZCA	C CHIP CERA	50V Y5V 0.1MF Z 2012	
CC510	HCFK103ZCA	C CHIP CERA	50V Y5V 0.01MF Z 2012	
CC511	HCFK104ZCA	C CHIP CERA	50V Y5V 0.1MF Z 2012	
CC512	HCFK103ZCA	C CHIP CERA	50V Y5V 0.01MF Z 2012	
CC513	HCFK103ZCA	C CHIP CERA	50V Y5V 0.01MF Z 2012	
CC515	HCBK102KCA	C CHIP CERA	50V X7R 1000PF K 2012	
CC516	HCBK102KCA	C CHIP CERA	50V X7R 1000PF K 2012	
CC517	HCBK102KCA	C CHIP CERA	50V X7R 1000PF K 2012	
CC518	HCBK102KCA	C CHIP CERA	50V X7R 1000PF K 2012	

LOC	PART CODE	PART NAME	PART TYPE	REMARK
CC519	HCBK102KCA	C CHIP CERA	50V X7R 1000PF K 2012	
CC520	HCBK102KCA	C CHIP CERA	50V X7R 1000PF K 2012	
CC521	HCBK102KCA	C CHIP CERA	50V X7R 1000PF K 2012	
CC522	HCBK102KCA	C CHIP CERA	50V X7R 1000PF K 2012	
CC523	HCQK130JCA	C CHIP CERA	50V CH 13PF J 2012	
CC524	HCQK130JCA	C CHIP CERA	50V CH 13PF J 2012	
CC525	HCBK181KEA	C CHIP CERA	50V X7R 180PF K 3216	
CC526	HCBK181KEA	C CHIP CERA	50V X7R 180PF K 3216	
CC527	HCBK181KEA	C CHIP CERA	50V X7R 180PF K 3216	
CC528	HCBK181KEA	C CHIP CERA	50V X7R 180PF K 3216	
CC529	HCBK223KCA	C CHIP CERA	50V X7R 0.022MF K 2012	
CC531	HCQK151JCA	C CHIP CERA	50V CH 150PF J 2012	
CC532	HCQK680JCA	C CHIP CERA	50V CH 68PF J 2012	
CC533	HCBK392KCA	C CHIP CERA	50V X7R 3900PF K 2012	
CC534	HCBK472KCA	C CHIP CERA	50V X7R 4700PF K 2012	
CC535	HCBK472KCA	C CHIP CERA	50V X7R 4700PF K 2012	
CC536	HCBK332KCA	C CHIP CERA	50V X7R 3300PF K 2012	
CC537	HCQK560JCA	C CHIP CERA	50V CH 56PF J 2012	
CC538	HCBK223KCA	C CHIP CERA	50V X7R 0.022MF K 2012	
CC539	HCQK221JCA	C CHIP CERA	50V CH 220PF J 2012	
CC540	HCTBF100MB	C CHIP TANTAL	16V 10MF M 3528	
CC541	HCBK223KCA	C CHIP CERA	50V X7R 0.022MF K 2012	
CC542	HCTAJ478MB	C CHIP TANTAL	35V 0.47MF M 3216	
CC544	HCQK100DCA	C CHIP CERA	50V CH 10PF D 2012	
CC549	HCFK104ZCA	C CHIP CERA	50V Y5V 0.1MF Z 2012	
CC550	HCFK104ZCA	C CHIP CERA	50V Y5V 0.1MF Z 2012	
CC551	HCFK104ZCA	C CHIP CERA	50V Y5V 0.1MF Z 2012	
CC552	HCTAF229MB	C CHIP TANTAL	16V 2.2MF M 3216	
CC554	HCTAF229MB	C CHIP TANTAL	16V 2.2MF M 3216	
CC561	HCTAF229MB	C CHIP TANTAL	16V 2.2MF M 3216	
CC568	HCTAF229MB	C CHIP TANTAL	16V 2.2MF M 3216	
CC569	HCTAH109MB	C CHIP TANTAL	25V 1MF M 3216	
CC572	HCTAJ478MB	C CHIP TANTAL	35V 0.47MF M 3216	
CC573	HCFK103ZCA	C CHIP CERA	50V Y5V 0.01MF Z 2012	
CC574	HCBK102KCA	C CHIP CERA	50V X7R 1000PF K 2012	
CC575	HCTAF229MB	C CHIP TANTAL	16V 2.2MF M 3216	
CC576	HCBK473KCA	C CHIP CERA	50V X7R 0.047MF K 2012	
CC601	HCFK103ZCA	C CHIP CERA	50V Y5V 0.01MF Z 2012	
CC602	HCFK103ZCA	C CHIP CERA	50V Y5V 0.01MF Z 2012	

LOC	PART CODE	PART NAME	PART TYPE	REMARK
CC603	HCFK103ZCA	C CHIP CERA	50V Y5V 0.01MF Z 2012	
CC604	HCFK103ZCA	C CHIP CERA	50V Y5V 0.01MF Z 2012	
CC605	HCQK101JCA	C CHIP CERA	50V CH 100PF J 2012	
CC606	HCQK101JCA	C CHIP CERA	50V CH 100PF J 2012	
CC607	HCBK102KCA	C CHIP CERA	50V X7R 1000PF K 2012	
CC608	HCBK102KCA	C CHIP CERA	50V X7R 1000PF K 2012	
CC612	HCFK103ZCA	C CHIP CERA	50V Y5V 0.01MF Z 2012	
CC701	HCFK103ZCA	C CHIP CERA	50V Y5V 0.01MF Z 2012	
CC702	HCBK333KCA	C CHIP CERA	50V X7R 0.033MF K 2012	
CC703	HCBK333KCA	C CHIP CERA	50V X7R 0.033MF K 2012	
CC704	HCBK472KCA	C CHIP CERA	50V X7R 4700PF K 2012	
CC705	HCBH224KCA	C CHIP CERA	25V X7R 0.22MF K 2012	
CC706	HCFK103ZCA	C CHIP CERA	50V Y5V 0.01MF Z 2012	
CC707	HCQK150JCA	C CHIP CERA	50V CH 15PF J 2012	
CC708	HCQK180JCA	C CHIP CERA	50V CH 18PF J 2012	
CC709	HCFK103ZCA	C CHIP CERA	50V Y5V 0.01MF Z 2012	
CC710	HCQK160JCA	C CHIP CERA	50V CH 16PF J 2012	
CC712	HCQK390JCA	C CHIP CERA	50V CH 39PF J 2012	
CC713	HCFK103ZCA	C CHIP CERA	50V Y5V 0.01MF Z 2012	
CC714	HCQK330JCA	C CHIP CERA	50V CH 33PF J 2012	
CC715	HCFK103ZCA	C CHIP CERA	50V Y5V 0.01MF Z 2012	
CC716	HCQK221JCA	C CHIP CERA	50V CH 220PF J 2012	
CC717	HCBH224KCA	C CHIP CERA	25V X7R 0.22MF K 2012	
CC718	HCTAJ478MB	C CHIP TANTAL	35V 0.47MF M 3216	
CC720	HCFK104ZCA	C CHIP CERA	50V Y5V 0.1MF Z 2012	
CC721	HCFK104ZCA	C CHIP CERA	50V Y5V 0.1MF Z 2012	
CC725	HCFK103ZCA	C CHIP CERA	50V Y5V 0.01MF Z 2012	
CC727	HCFK103ZCA	C CHIP CERA	50V Y5V 0.01MF Z 2012	
CC728	HCFK103ZCA	C CHIP CERA	50V Y5V 0.01MF Z 2012	
CC729	HCTAH109MB	C CHIP TANTAL	25V 1MF M 3216	
CCL01	HCQK220JCA	C CHIP CERA	50V CH 22PF J 2012	
CCL02	HCQK150JCA	C CHIP CERA	50V CH 15PF J 2012	
CCL03	HCFK103ZCA	C CHIP CERA	50V Y5V 0.01MF Z 2012	
CCL04	HCFK103ZCA	C CHIP CERA	50V Y5V 0.01MF Z 2012	
CCL05	HCFK104ZCA	C CHIP CERA	50V Y5V 0.1MF Z 2012	
CCL06	HCFK104ZCA	C CHIP CERA	50V Y5V 0.1MF Z 2012	
CCL08	HCFK103ZCA	C CHIP CERA	50V Y5V 0.01MF Z 2012	
CCL10	HCQK101JCA	C CHIP CERA	50V CH 100PF J 2012	
CCL12	HCBK333KCA	C CHIP CERA	50V X7R 0.033MF K 2012	

LOC	PART CODE	PART NAME	PART TYPE	REMARK
CCL14	HCBK473KCA	C CHIP CERA	50V X7R 0.047MF K 2012	
CCL15	HCFK103ZCA	C CHIP CERA	50V Y5V 0.01MF Z 2012	
CCL16	HCQK820JCA	C CHIP CERA	50V CH 82PF J 2012	
CCL17	HCFK103ZCA	C CHIP CERA	50V Y5V 0.01MF Z 2012	
CCL18	HCBK473KCA	C CHIP CERA	50V X7R 0.047MF K 2012	
CCL19	HCFK103ZCA	C CHIP CERA	50V Y5V 0.01MF Z 2012	
CCL20	HCTBH479MB	C CHIP TANTAL	25V 4.7MF M 3528	
CCL21	HCTAF229MB	C CHIP TANTAL	16V 2.2MF M 3216	
CCL26	HCTAH109MB	C CHIP TANTAL	25V 1MF M 3216	
CCL27	HCTAH109MB	C CHIP TANTAL	25V 1MF M 3216	
CCL30	HCTBH479MB	C CHIP TANTAL	25V 4.7MF M 3528	
CCL31	HCQK101JCA	C CHIP CERA	50V CH 100PF J 2012	
CCL33	HRFT000-CA	R CHIP	1/10 0 OHM 2012	
CCL34	HCFK103ZCA	C CHIP CERA	50V Y5V 0.01MF Z 2012	
CCL35	HCFK103ZCA	C CHIP CERA	50V Y5V 0.01MF Z 2012	
CCL36	HCTBF100MB	C CHIP TANTAL	16V 10MF M 3528	
CCN02	HCFK104ZCA	C CHIP CERA	50V Y5V 0.1MF Z 2012	
CCN07	HCFK103ZCA	C CHIP CERA	50V Y5V 0.01MF Z 2012	
CCN08	HCBK102KCA	C CHIP CERA	50V X7R 1000PF K 2012	
CCN09	HCFK103ZCA	C CHIP CERA	50V Y5V 0.01MF Z 2012	
CCN10	HCFK103ZCA	C CHIP CERA	50V Y5V 0.01MF Z 2012	
CCN11	HCBK102KCA	C CHIP CERA	50V X7R 1000PF K 2012	
CCN12	HCBK102KCA	C CHIP CERA	50V X7R 1000PF K 2012	
CCN14	HCFK103ZCA	C CHIP CERA	50V Y5V 0.01MF Z 2012	
CCN15	HCBK332KCA	C CHIP CERA	50V X7R 3300PF K 2012	
CCN17	HCFK104ZCA	C CHIP CERA	50V Y5V 0.1MF Z 2012	
CCN20	HCFK103ZCA	C CHIP CERA	50V Y5V 0.01MF Z 2012	
CCN21	HCBK223KCA	C CHIP CERA	50V X7R 0.022MF K 2012	
CCN29	HCBK223KCA	C CHIP CERA	50V X7R 0.022MF K 2012	
CCN31	HCFK104ZCA	C CHIP CERA	50V Y5V 0.1MF Z 2012	
CCN37	HCTAH109MB	C CHIP TANTAL	25V 1MF M 3216	
CCN44	HCFK104ZCA	C CHIP CERA	50V Y5V 0.1MF Z 2012	
CCN45	HCFK104ZCA	C CHIP CERA	50V Y5V 0.1MF Z 2012	
CCN48	HCFK104ZCA	C CHIP CERA	50V Y5V 0.1MF Z 2012	
CCN49	HCFK103ZCA	C CHIP CERA	50V Y5V 0.01MF Z 2012	
CCN50	HCFK104ZCA	C CHIP CERA	50V Y5V 0.1MF Z 2012	
CCN52	HCFK103ZCA	C CHIP CERA	50V Y5V 0.01MF Z 2012	
CCN57	HCTBF100MB	C CHIP TANTAL	16V 10MF M 3528	
CCN58	HCTAH109MB	C CHIP TANTAL	25V 1MF M 3216	

LOC	PART CODE	PART NAME	PART TYPE	REMARK
CCN60	HCQK100DCA	C CHIP CERA	50V CH 10PF D 2012	
CCQ01	HCFK103ZCA	C CHIP CERA	50V Y5V 0.01MF Z 2012	
CCY01	HCFK103ZCA	C CHIP CERA	50V Y5V 0.01MF Z 2012	
CCY02	HCFK103ZCA	C CHIP CERA	50V Y5V 0.01MF Z 2012	
CCY03	HCFK103ZCA	C CHIP CERA	50V Y5V 0.01MF Z 2012	
CCY04	HCFK103ZCA	C CHIP CERA	50V Y5V 0.01MF Z 2012	
CCY05	HCBK223KCA	C CHIP CERA	50V X7R 0.022MF K 2012	
CCY06	HCFK104ZCA	C CHIP CERA	50V Y5V 0.1MF Z 2012	
CCY07	HCFK103ZCA	C CHIP CERA	50V Y5V 0.01MF Z 2012	
CCY08	HCFK103ZCA	C CHIP CERA	50V Y5V 0.01MF Z 2012	
CCY09	HCFK104ZCA	C CHIP CERA	50V Y5V 0.1MF Z 2012	
CCY10	HCFK103ZCA	C CHIP CERA	50V Y5V 0.01MF Z 2012	
CCY11	HCFK103ZCA	C CHIP CERA	50V Y5V 0.01MF Z 2012	
CCY14	HCFK103ZCA	C CHIP CERA	50V Y5V 0.01MF Z 2012	
CCY15	HCFK103ZCA	C CHIP CERA	50V Y5V 0.01MF Z 2012	
CCY16	HCFK103ZCA	C CHIP CERA	50V Y5V 0.01MF Z 2012	
CCY19	HCFK104ZCA	C CHIP CERA	50V Y5V 0.1MF Z 2012	
CCY20	HCFK103ZCA	C CHIP CERA	50V Y5V 0.01MF Z 2012	
CCY21	HCFK103ZCA	C CHIP CERA	50V Y5V 0.01MF Z 2012	
CCY22	HCFK104ZCA	C CHIP CERA	50V Y5V 0.1MF Z 2012	
CCY23	HCFK104ZCA	C CHIP CERA	50V Y5V 0.1MF Z 2012	
CCY24	HCFK104ZCA	C CHIP CERA	50V Y5V 0.1MF Z 2012	
CCY25	HCQK101JCA	C CHIP CERA	50V CH 100PF J 2012	
CCY26	HCFK104ZCA	C CHIP CERA	50V Y5V 0.1MF Z 2012	
CCY27	HCFK104ZCA	C CHIP CERA	50V Y5V 0.1MF Z 2012	
CCY28	HCFK104ZCA	C CHIP CERA	50V Y5V 0.1MF Z 2012	
CCY29	HCFK104ZCA	C CHIP CERA	50V Y5V 0.1MF Z 2012	
CCY30	HCFK104ZCA	C CHIP CERA	50V Y5V 0.1MF Z 2012	
CCY31	HCFK104ZCA	C CHIP CERA	50V Y5V 0.1MF Z 2012	
CCY32	HCBK153KCA	C CHIP CERA	50V X7R 0.015MF K 2012	
CCY33	HCQK101JCA	C CHIP CERA	50V CH 100PF J 2012	
CCY34	HCFK103ZCA	C CHIP CERA	50V Y5V 0.01MF Z 2012	
CCY35	HCBK473KCA	C CHIP CERA	50V X7R 0.047MF K 2012	
CCY36	HCBK473KCA	C CHIP CERA	50V X7R 0.047MF K 2012	
CCY37	HCBK102KCA	C CHIP CERA	50V X7R 1000PF K 2012	
CCY38	HCBK472KCA	C CHIP CERA	50V X7R 4700PF K 2012	
CCY39	HCQK220JCA	C CHIP CERA	50V CH 22PF J 2012	
CCY40	HCBK122KCA	C CHIP CERA	50V X7R 1200PF K 2012	
CCY42	HCQK270JCA	C CHIP CERA	50V CH 27PF J 2012	

LOC	PART CODE	PART NAME	PART TYPE	REMARK
CCY43	HCFK104ZCA	C CHIP CERA	50V Y5V 0.1MF Z 2012	
CCY44	HCFK103ZCA	C CHIP CERA	50V Y5V 0.01MF Z 2012	
CCY46	HCQK201JCA	C CHIP CERA	50V CH 200PF J 2012	
CCY47	HCBK333KCA	C CHIP CERA	50V X7R 0.033MF K 2012	
CCY48	HCQK391JCA	C CHIP CERA	50V CH 390PF J 2012	
CCY50	HCBK223KCA	C CHIP CERA	50V X7R 0.022MF K 2012	
CCY52	HCQK101JCA	C CHIP CERA	50V CH 100PF J 2012	
CCY53	HCBK152KCA	C CHIP CERA	50V X7R 1500PF K 2012	
CCY55	HCFK103ZCA	C CHIP CERA	50V Y5V 0.01MF Z 2012	
CCY56	HCTBF100MB	C CHIP TANTAL	16V 10MF M 3528	
CCY59	HCBK473KCA	C CHIP CERA	50V X7R 0.047MF K 2012	
CCY60	HCTAH109MB	C CHIP TANTAL	25V 1MF M 3216	
CCY62	HCTAH109MB	C CHIP TANTAL	25V 1MF M 3216	
CCY63	HCTBH479MB	C CHIP TANTAL	25V 4.7MF M 3528	
CCY64	HCTAH109MB	C CHIP TANTAL	25V 1MF M 3216	
CCY65	HCTAH109MB	C CHIP TANTAL	25V 1MF M 3216	
CCY66	HCTAH109MB	C CHIP TANTAL	25V 1MF M 3216	
CCY67	HCTAH109MB	C CHIP TANTAL	25V 1MF M 3216	
CCY68	HCTBF100MB	C CHIP TANTAL	16V 10MF M 3528	
CCY69	HCTAJ108MB	C CHIP TANTAL	35V 0.1MF M 3216	
CCY70	HCTAH109MB	C CHIP TANTAL	25V 1MF M 3216	
CCY71	HCTAH109MB	C CHIP TANTAL	25V 1MF M 3216	
CCY74	HCTBF100MB	C CHIP TANTAL	16V 10MF M 3528	
CCY75	HCTBF100MB	C CHIP TANTAL	16V 10MF M 3528	
CCY76	HCTBF100MB	C CHIP TANTAL	16V 10MF M 3528	
CCY77	HCTBF100MB	C CHIP TANTAL	16V 10MF M 3528	
CCY79	HCTAH109MB	C CHIP TANTAL	25V 1MF M 3216	
CCY84	HCFK103ZCA	C CHIP CERA	50V Y5V 0.01MF Z 2012	
CCY91	HCFK104ZCA	C CHIP CERA	50V Y5V 0.1MF Z 2012	
CCY92	HCQK330JCA	C CHIP CERA	50V CH 33PF J 2012	
CCY93	HCQK270JCA	C CHIP CERA	50V CH 27PF J 2012	
CCY94	HCQK680JCA	C CHIP CERA	50V CH 68PF J 2012	
CCY96	HCFK103ZCA	C CHIP CERA	50V Y5V 0.01MF Z 2012	
CCY97	HCFK103ZCA	C CHIP CERA	50V Y5V 0.01MF Z 2012	
CCY98	HCBK102KCA	C CHIP CERA	50V X7R 1000PF K 2012	
CCY99	HCFK103ZCA	C CHIP CERA	50V Y5V 0.01MF Z 2012	
IY01	1LA71511MQ	IC CHIP SIGNALPROC	LA71511M	
IY02	1LC89977MM	IC CHIP DELAY LINE	LC89977M	
QC101	TKTC3881-B	TR CHIP	KTC3881	

LOC	PART CODE	PART NAME	PART TYPE	REMARK
QC102	T2SA812T2B	TR CHIP	2SA812-T2B	
QC103	TKTC3881-B	TR CHIP	KTC3881	
QC201	TKTC3881-B	TR CHIP	KTC3881	
QC202	T2SC1623T2	TR CHIP	2SC1623-L6/T2B	
QC203	T2SC1623T2	TR CHIP	2SC1623-L6/T2B	
QC204	T2SC1623T2	TR CHIP	2SC1623-L6/T2B	
QC205	T2SC1623T2	TR CHIP	2SC1623-L6/T2B	
QC501	T2SC1623T2	TR CHIP	2SC1623-L6/T2B	
QC502	T2SC1623T2	TR CHIP	2SC1623-L6/T2B	
QC503	T2SC1623T2	TR CHIP	2SC1623-L6/T2B	
QC504	T2SC1623T2	TR CHIP	2SC1623-L6/T2B	
QC505	T2SC1623T2	TR CHIP	2SC1623-L6/T2B	
QC506	T2SC1623T2	TR CHIP	2SC1623-L6/T2B	
QC510	T2SA812T2B	TR CHIP	2SA812-T2B	
QC511	T2SA812T2B	TR CHIP	2SA812-T2B	
QC512	T2SA812T2B	TR CHIP	2SA812-T2B	
QC601	T2SC1623T2	TR CHIP	2SC1623-L6/T2B	
QC701	T2SC1623T2	TR CHIP	2SC1623-L6/T2B	
QC702	T2SC1623T2	TR CHIP	2SC1623-L6/T2B	
QC703	T2SC1623T2	TR CHIP	2SC1623-L6/T2B	
QC704	T2SC1623T2	TR CHIP	2SC1623-L6/T2B	
QC705	T2SC1623T2	TR CHIP	2SC1623-L6/T2B	
QC706	T2SC1623T2	TR CHIP	2SC1623-L6/T2B	
QCL01	TKTC3881-B	TR CHIP	KTC3881	
QCL02	T2SC1623T2	TR CHIP	2SC1623-L6/T2B	
QCL03	T2SC1623T2	TR CHIP	2SC1623-L6/T2B	
QCL05	T2SC1623T2	TR CHIP	2SC1623-L6/T2B	
QCL06	T2SC1623T2	TR CHIP	2SC1623-L6/T2B	
QCL07	T2SC1623T2	TR CHIP	2SC1623-L6/T2B	
QCN02	T2SC1623T2	TR CHIP	2SC1623-L6/T2B	
QCN03	T2SC1623T2	TR CHIP	2SC1623-L6/T2B	
QCN04	T2SC1623T2	TR CHIP	2SC1623-L6/T2B	
QCN05	T2SC1623T2	TR CHIP	2SC1623-L6/T2B	
QCY01	T2SC1623T2	TR CHIP	2SC1623-L6/T2B	
QCY02	T2SA812T2B	TR CHIP	2SA812-T2B	
QCY03	T2SC1623T2	TR CHIP	2SC1623-L6/T2B	
QCY06	T2SC1623T2	TR CHIP	2SC1623-L6/T2B	
QCY07	T2SC1623T2	TR CHIP	2SC1623-L6/T2B	
QCY08	T2SC1623T2	TR CHIP	2SC1623-L6/T2B	

LOC	PART CODE	PART NAME	PART TYPE	REMARK
QCY09	T2SA812T2B	TR CHIP	2SA812-T2B	
QCY10	T2SC1623T2	TR CHIP	2SC1623-L6/T2B	
QCY11	T2SC1623T2	TR CHIP	2SC1623-L6/T2B	
QCY12	T2SC1623T2	TR CHIP	2SC1623-L6/T2B	
QCY13	T2SA812T2B	TR CHIP	2SA812-T2B	
QCY14	T2SC1623T2	TR CHIP	2SC1623-L6/T2B	
QCY15	T2SC1623T2	TR CHIP	2SC1623-L6/T2B	
QCY16	T2SC1623T2	TR CHIP	2SC1623-L6/T2B	
QCY17	T2SC1623T2	TR CHIP	2SC1623-L6/T2B	
QCY18	T2SC1623T2	TR CHIP	2SC1623-L6/T2B	
RC103	HRFT333JCA	R CHIP	1/10 33K OHM J 2012	
RC105	HRFT472JCA	R CHIP	1/10 4.7K OHM J 2012	
RC106	HRFT470JCA	R CHIP	1/10 47 OHM J 2012	
RC107	HRFT122JCA	R CHIP	1/10 1.2K OHM J 2012	
RC108	HRFT472JCA	R CHIP	1/10 4.7K OHM J 2012	
RC109	HRFT101JCA	R CHIP	1/10 100 OHM J 2012	
RC110	HRFT122JCA	R CHIP	1/10 1.2K OHM J 2012	
RC111	HRFT470JCA	R CHIP	1/10 47 OHM J 2012	
RC112	HRFT122JCA	R CHIP	1/10 1.2K OHM J 2012	
RC113	HRFT472JCA	R CHIP	1/10 4.7K OHM J 2012	
RC114	HRFT101JCA	R CHIP	1/10 100 OHM J 2012	
RC115	HRFT511JCA	R CHIP	1/10 510 OHM J 2012	
RC116	HRFT221JCA	R CHIP	1/10 220 OHM J 2012	
RC201	HRFT182JCA	R CHIP	1/10 1.8K OHM J 2012	
RC204	HRFT302JCA	R CHIP	1/10 3K OHM J 2012	
RC205	HRFT271JCA	R CHIP	1/10 270 OHM J 2012	
RC207	HRFT223JCA	R CHIP	1/10 22K OHM J 2012	
RC208	HRFT223JCA	R CHIP	1/10 22K OHM J 2012	
RC209	HRFT104JCA	R CHIP	1/10 100K OHM J 2012	
RC210	HRFT153JCA	R CHIP	1/10 15K OHM J 2012	
RC211	HRFT222JCA	R CHIP	1/10 2.2K OHM J 2012	
RC213	HRFT103JCA	R CHIP	1/10 10K OHM J 2012	
RC214	HRFT103JCA	R CHIP	1/10 10K OHM J 2012	
RC215	HRFT103JCA	R CHIP	1/10 10K OHM J 2012	
RC216	HRFT683JCA	R CHIP	1/10 68K OHM J 2012	
RC217	HRFT101JCA	R CHIP	1/10 100 OHM J 2012	
RC221	HRFT333JCA	R CHIP	1/10 33K OHM J 2012	
RC224	HRFT561JCA	R CHIP	1/10 560 OHM J 2012	
RC225	HRFT103JCA	R CHIP	1/10 10K OHM J 2012	

LOC	PART CODE	PART NAME	PART TYPE	REMARK
RC226	HRFT752JCA	R CHIP	1/10 7.5K OHM J 2012	
RC228	HRFT223JCA	R CHIP	1/10 22K OHM J 2012	
RC229	HRFT331JCA	R CHIP	1/10 330 OHM J 2012	
RC230	HRFT152JCA	R CHIP	1/10 1.5K OHM J 2012	
RC231	HRFT102JCA	R CHIP	1/10 1K OHM J 2012	
RC233	HRFT102JCA	R CHIP	1/10 1K OHM J 2012	
RC234	HRFT470JCA	R CHIP	1/10 47 OHM J 2012	
RC235	HRFT561JCA	R CHIP	1/10 560 OHM J 2012	
RC236	HRFT471JCA	R CHIP	1/10 470 OHM J 2012	
RC237	HRFT751JCA	R CHIP	1/10 750 OHM J 2012	
RC239	HRFT242JCA	R CHIP	1/10 2.4K OHM J 2012	
RC501	HRFT333JCA	R CHIP	1/10 33K OHM J 2012	
RC503	HRFT223JCA	R CHIP	1/10 22K OHM J 2012	
RC507	HRFT683JCA	R CHIP	1/10 68K OHM J 2012	
RC509	HRFT391JCA	R CHIP	1/10 390 OHM J 2012	
RC510	HRFT750JCA	R CHIP	1/10 75 OHM J 2012	
RC511	HRFT750JCA	R CHIP	1/10 75 OHM J 2012	
RC512	HRFT750JCA	R CHIP	1/10 75 OHM J 2012	
RC513	HRFT750JCA	R CHIP	1/10 75 OHM J 2012	
RC514	HRFT750JCA	R CHIP	1/10 75 OHM J 2012	
RC515	HRFT560JCA	R CHIP	1/10 56 OHM J 2012	
RC518	HRFT101JCA	R CHIP	1/10 100 OHM J 2012	
RC519	HRFT000-CA	R CHIP	1/10 0 OHM 2012	
RC520	HRFT101JCA	R CHIP	1/10 100 OHM J 2012	
RC521	HRFT101JCA	R CHIP	1/10 100 OHM J 2012	
RC522	HRFT101JCA	R CHIP	1/10 100 OHM J 2012	
RC523	HRFT151JCA	R CHIP	1/10 150 OHM J 2012	
RC526	HRFT102JCA	R CHIP	1/10 1K OHM J 2012	
RC527	HRFT102JCA	R CHIP	1/10 1K OHM J 2012	
RC528	HRFT102JCA	R CHIP	1/10 1K OHM J 2012	
RC530	HRFT102JCA	R CHIP	1/10 1K OHM J 2012	
RC531	HRFT152JCA	R CHIP	1/10 1.5K OHM J 2012	
RC532	HRFT102JCA	R CHIP	1/10 1K OHM J 2012	
RC533	HRFT102JCA	R CHIP	1/10 1K OHM J 2012	
RC534	HRFT102JCA	R CHIP	1/10 1K OHM J 2012	
RC536	HRFT103JCA	R CHIP	1/10 10K OHM J 2012	
RC538	HRFT103JCA	R CHIP	1/10 10K OHM J 2012	
RC539	HRFT103JCA	R CHIP	1/10 10K OHM J 2012	
RC541	HRFT103JCA	R CHIP	1/10 10K OHM J 2012	

LOC	PART CODE	PART NAME	PART TYPE	REMARK
RC542	HRFT103JCA	R CHIP	1/10 10K OHM J 2012	
RC543	HRFT513JCA	R CHIP	1/10 51K OHM J 2012	
RC544	HRFT103JCA	R CHIP	1/10 10K OHM J 2012	
RC545	HRFT153JCA	R CHIP	1/10 15K OHM J 2012	
RC546	HRFT153JCA	R CHIP	1/10 15K OHM J 2012	
RC547	HRFT473JCA	R CHIP	1/10 47K OHM J 2012	
RC548	HRFT153JCA	R CHIP	1/10 15K OHM J 2012	
RC552	HRFT123JCA	R CHIP	1/10 12K OHM J 2012	
RC553	HRFT122JCA	R CHIP	1/10 1.2K OHM J 2012	
RC554	HRFT333JCA	R CHIP	1/10 33K OHM J 2012	
RC556	HRFT331JCA	R CHIP	1/10 330 OHM J 2012	
RC557	HRFT391JCA	R CHIP	1/10 390 OHM J 2012	
RC558	HRFT182JCA	R CHIP	1/10 1.8K OHM J 2012	
RC559	HRFT472JCA	R CHIP	1/10 4.7K OHM J 2012	
RC560	HRFT393JCA	R CHIP	1/10 39K OHM J 2012	
RC561	HRFT303JCA	R CHIP	1/10 30K OHM J 2012	
RC562	HRFT471JCA	R CHIP	1/10 470 OHM J 2012	
RC565	HRFT561JCA	R CHIP	1/10 560 OHM J 2012	
RC566	HRFT561JCA	R CHIP	1/10 560 OHM J 2012	
RC567	HRFT562JCA	R CHIP	1/10 5.6K OHM J 2012	
RC568	HRFT681JCA	R CHIP	1/10 680 OHM J 2012	
RC569	HRFT270JCA	R CHIP	1/10 27 OHM J 2012	
RC570	HRFT203JCA	R CHIP	1/10 20K OHM J 2012	
RC574	HRFT181JCA	R CHIP	1/10 180 OHM J 2012	
RC575	HRFT183JCA	R CHIP	1/10 18K OHM J 2012	
RC577	HRFT470JCA	R CHIP	1/10 47 OHM J 2012	
RC581	HRFT242JCA	R CHIP	1/10 2.4K OHM J 2012	
RC582	HRFT000-CA	R CHIP	1/10 0 OHM 2012	
RC601	HRFT102JCA	R CHIP	1/10 1K OHM J 2012	
RC702	HRFT103JCA	R CHIP	1/10 10K OHM J 2012	
RC703	HRFT103JCA	R CHIP	1/10 10K OHM J 2012	
RC704	HRFT103JCA	R CHIP	1/10 10K OHM J 2012	
RC705	HRFT472JCA	R CHIP	1/10 4.7K OHM J 2012	
RC706	HRFT332JCA	R CHIP	1/10 3.3K OHM J 2012	
RC707	HRFT332JCA	R CHIP	1/10 3.3K OHM J 2012	
RC711	HRFT221JCA	R CHIP	1/10 220 OHM J 2012	
RC712	HRFT221JCA	R CHIP	1/10 220 OHM J 2012	
RC715	HRFT474JCA	R CHIP	1/10 470K OHM J 2012	
RC717	HRFT103JCA	R CHIP	1/10 10K OHM J 2012	

LOC	PART CODE	PART NAME	PART TYPE	REMARK
RC718	HRFT101JCA	R CHIP	1/10 100 OHM J 2012	
RC719	HRFT101JCA	R CHIP	1/10 100 OHM J 2012	
RC722	HRFT102JCA	R CHIP	1/10 1K OHM J 2012	
RC723	HRFT122JCA	R CHIP	1/10 1.2K OHM J 2012	
RC724	HRFT122JCA	R CHIP	1/10 1.2K OHM J 2012	
RC725	HRFT122JCA	R CHIP	1/10 1.2K OHM J 2012	
RC726	HRFT243JCA	R CHIP	1/10 24K OHM J 2012	
RC727	HRFT472JCA	R CHIP	1/10 4.7K OHM J 2012	
RC729	HRFT473JCA	R CHIP	1/10 47K OHM J 2012	
RC731	HRFT103JCA	R CHIP	1/10 10K OHM J 2012	
RC732	HRFT103JCA	R CHIP	1/10 10K OHM J 2012	
RC733	HRFT103JCA	R CHIP	1/10 10K OHM J 2012	
RC734	HRFT682JCA	R CHIP	1/10 6.8K OHM J 2012	
RC735	HRFT682JCA	R CHIP	1/10 6.8K OHM J 2012	
RC736	HRFT822JCA	R CHIP	1/10 8.2K OHM J 2012	
RC739	HRFT472JCA	R CHIP	1/10 4.7K OHM J 2012	
RC740	HRFT103JCA	R CHIP	1/10 10K OHM J 2012	
RC774	HRFT243JCA	R CHIP	1/10 24K OHM J 2012	
RC775	HRFT472JCA	R CHIP	1/10 4.7K OHM J 2012	
RC776	HRFT472JCA	R CHIP	1/10 4.7K OHM J 2012	
RC777	HRFT472JCA	R CHIP	1/10 4.7K OHM J 2012	
RC778	HRFT472JCA	R CHIP	1/10 4.7K OHM J 2012	
RC780	HRFT473JCA	R CHIP	1/10 47K OHM J 2012	
RCJ01	HRFT000-CA	R CHIP	1/10 0 OHM 2012	
RCJ02	HRFT000-CA	R CHIP	1/10 0 OHM 2012	
RCJ03	HRFT000-CA	R CHIP	1/10 0 OHM 2012	
RCJ04	HRFT000-CA	R CHIP	1/10 0 OHM 2012	
RCJ08	HRFT000-CA	R CHIP	1/10 0 OHM 2012	
RCJ09	HRFT000-CA	R CHIP	1/10 0 OHM 2012	
RCJ10	HRFT000-CA	R CHIP	1/10 0 OHM 2012	
RCJ11	HRFT000-CA	R CHIP	1/10 0 OHM 2012	
RCJ12	HRFT000-CA	R CHIP	1/10 0 OHM 2012	
RCJ13	HRFT000-CA	R CHIP	1/10 0 OHM 2012	
RCJ14	HRFT000-CA	R CHIP	1/10 0 OHM 2012	
RCJ15	HRFT000-CA	R CHIP	1/10 0 OHM 2012	
RCJ16	HRFT000-CA	R CHIP	1/10 0 OHM 2012	
RCJ17	HRFT000-CA	R CHIP	1/10 0 OHM 2012	
RCJ18	HRFT000-CA	R CHIP	1/10 0 OHM 2012	
RCJ19	HRFT000-CA	R CHIP	1/10 0 OHM 2012	

LOC	PART CODE	PART NAME	PART TYPE	REMARK
RCJ20	HRFT000-CA	R CHIP	1/10 0 OHM 2012	
RCJ21	HRFT000-CA	R CHIP	1/10 0 OHM 2012	
RCJ22	HRFT000-CA	R CHIP	1/10 0 OHM 2012	
RCJ23	HRFT000-CA	R CHIP	1/10 0 OHM 2012	
RCJ24	HRFT000-CA	R CHIP	1/10 0 OHM 2012	
RCJ25	HRFT000-CA	R CHIP	1/10 0 OHM 2012	
RCJ27	HRFT000-CA	R CHIP	1/10 0 OHM 2012	
RCJ28	HRFT000-CA	R CHIP	1/10 0 OHM 2012	
RCJ29	HRFT000-CA	R CHIP	1/10 0 OHM 2012	
RCJ30	HRFT000-CA	R CHIP	1/10 0 OHM 2012	
RCJ32	HRFT000-CA	R CHIP	1/10 0 OHM 2012	
RCJ33	HRFT000-CA	R CHIP	1/10 0 OHM 2012	
RCJ35	HRFT000-CA	R CHIP	1/10 0 OHM 2012	
RCJ36	HRFT000-CA	R CHIP	1/10 0 OHM 2012	
RCJ37	HRFT000-CA	R CHIP	1/10 0 OHM 2012	
RCJ38	HRFT000-CA	R CHIP	1/10 0 OHM 2012	
RCJ39	HRFT000-CA	R CHIP	1/10 0 OHM 2012	
RCJ40	HRFT000-CA	R CHIP	1/10 0 OHM 2012	
RCL02	HRFT683JCA	R CHIP	1/10 68K OHM J 2012	
RCL03	HRFT222JCA	R CHIP	1/10 2.2K OHM J 2012	
RCL07	HRFT333JCA	R CHIP	1/10 33K OHM J 2012	
RCL12	HRFT103JCA	R CHIP	1/10 10K OHM J 2012	
RCL13	HRFT103JCA	R CHIP	1/10 10K OHM J 2012	
RCL14	HRFT103JCA	R CHIP	1/10 10K OHM J 2012	
RCL15	HRFT103JCA	R CHIP	1/10 10K OHM J 2012	
RCL16	HRFT101JCA	R CHIP	1/10 100 OHM J 2012	
RCL17	HRFT751JCA	R CHIP	1/10 750 OHM J 2012	
RCL18	HRFT153JCA	R CHIP	1/10 15K OHM J 2012	
RCL30	HRFT102JCA	R CHIP	1/10 1K OHM J 2012	
RCL31	HRFT333JCA	R CHIP	1/10 33K OHM J 2012	
RCL32	HRFT123JCA	R CHIP	1/10 12K OHM J 2012	
RCL33	HRFT202JCA	R CHIP	1/10 2K OHM J 2012	
RCL34	HRFT561JCA	R CHIP	1/10 560 OHM J 2012	
RCL36	HRFT102JCA	R CHIP	1/10 1K OHM J 2012	
RCN01	HRFT474JCA	R CHIP	1/10 470K OHM J 2012	
RCN07	HRFT103JCA	R CHIP	1/10 10K OHM J 2012	
RCN09	HRFT103JCA	R CHIP	1/10 10K OHM J 2012	
RCN10	HRFT103JCA	R CHIP	1/10 10K OHM J 2012	
RCN11	HRFT103JCA	R CHIP	1/10 10K OHM J 2012	

LOC	PART CODE	PART NAME	PART TYPE	REMARK
RCN20	HRFT103JCA	R CHIP	1/10 10K OHM J 2012	
RCN23	HRFT154JCA	R CHIP	1/10 150K OHM J 2012	
RCN24	HRFT154JCA	R CHIP	1/10 150K OHM J 2012	
RCN27	HRFT105JCA	R CHIP	1/10 1M OHM J 2012	
RCN31	HRFT182JCA	R CHIP	1/10 1.8K OHM J 2012	
RCN32	HRFT182JCA	R CHIP	1/10 1.8K OHM J 2012	
RCN34	HRFT333JCA	R CHIP	1/10 33K OHM J 2012	
RCN40	HRFT104JCA	R CHIP	1/10 100K OHM J 2012	
RCN41	HRFT106JCA	R CHIP	1/10 10M OHM J 2012	
RCN45	HRFT302JCA	R CHIP	1/10 3K OHM J 2012	
RCN51	HRFT511FCA	R CHIP	1/10 510 OHM F 2012	
RCN52	HRFT472JCA	R CHIP	1/10 4.7K OHM J 2012	
RCN60	HRFT103JCA	R CHIP	1/10 10K OHM J 2012	
RCN61	HRFT223JCA	R CHIP	1/10 22K OHM J 2012	
RCN62	HRFT103JCA	R CHIP	1/10 10K OHM J 2012	
RCQ04	HRFT102JCA	R CHIP	1/10 1K OHM J 2012	
RCQ05	HRFT102JCA	R CHIP	1/10 1K OHM J 2012	
RCQ06	HRFT161JCA	R CHIP	1/10 160 OHM J 2012	
RCQ07	HRFT161JCA	R CHIP	1/10 160 OHM J 2012	
RCQ09	HRFT221JCA	R CHIP	1/10 220 OHM J 2012	
RCQ10	HRFT221JCA	R CHIP	1/10 220 OHM J 2012	
RCQ11	HRFT202JCA	R CHIP	1/10 2K OHM J 2012	
RCQ13	HRFT361JCA	R CHIP	1/10 360 OHM J 2012	
RCQ14	HRFT511FCA	R CHIP	1/10 510 OHM F 2012	
RCY01	HRFT152JCA	R CHIP	1/10 1.5K OHM J 2012	
RCY02	HRFT152JCA	R CHIP	1/10 1.5K OHM J 2012	
RCY04	HRFT102JCA	R CHIP	1/10 1K OHM J 2012	
RCY07	HRFT102JCA	R CHIP	1/10 1K OHM J 2012	
RCY08	HRFT102JCA	R CHIP	1/10 1K OHM J 2012	
RCY09	HRFT123JCA	R CHIP	1/10 12K OHM J 2012	
RCY10	HRFT102JCA	R CHIP	1/10 1K OHM J 2012	
RCY11	HRFT823JCA	R CHIP	1/10 82K OHM J 2012	
RCY13	HRFT152JCA	R CHIP	1/10 1.5K OHM J 2012	
RCY15	HRFT471JCA	R CHIP	1/10 470 OHM J 2012	
RCY16	HRFT822JCA	R CHIP	1/10 8.2K OHM J 2012	
RCY17	HRFT822JCA	R CHIP	1/10 8.2K OHM J 2012	
RCY18	HRFT103JCA	R CHIP	1/10 10K OHM J 2012	
RCY19	HRFT202JCA	R CHIP	1/10 2K OHM J 2012	
RCY20	HRFT202JCA	R CHIP	1/10 2K OHM J 2012	

LOC	PART CODE	PART NAME	PART TYPE	REMARK
RCY23	HRFT132JCA	R CHIP	1/10 1.3K OHM J 2012	
RCY24	HRFT124JCA	R CHIP	1/10 120K OHM J 2012	
RCY25	HRFT392JCA	R CHIP	1/10 3.9K OHM J 2012	
RCY26	HRFT223JCA	R CHIP	1/10 22K OHM J 2012	
RCY29	HRFT303JCA	R CHIP	1/10 30K OHM J 2012	
RCY30	HRFT561JCA	R CHIP	1/10 560 OHM J 2012	
RCY32	HRFT103JCA	R CHIP	1/10 10K OHM J 2012	
RCY33	HRFT333JCA	R CHIP	1/10 33K OHM J 2012	
RCY34	HRFT432JCA	R CHIP	1/10 4.3K OHM J 2012	
RCY35	HRFT152JCA	R CHIP	1/10 1.5K OHM J 2012	
RCY36	HRFT202JCA	R CHIP	1/10 2K OHM J 2012	
RCY37	HRFT822JCA	R CHIP	1/10 8.2K OHM J 2012	
RCY38	HRFT511JCA	R CHIP	1/10 510 OHM J 2012	
RCY39	HRFT472JCA	R CHIP	1/10 4.7K OHM J 2012	
RCY40	HRFT183JCA	R CHIP	1/10 18K OHM J 2012	
RCY41	HRFT225JCA	R CHIP	1/10 2.2M OHM J 2012	
RCY42	HRFT561JCA	R CHIP	1/10 560 OHM J 2012	
RCY43	HRFT562JCA	R CHIP	1/10 5.6K OHM J 2012	
RCY44	HRFT201JCA	R CHIP	1/10 200 OHM J 2012	
RCY45	HRFT391JCA	R CHIP	1/10 390 OHM J 2012	
RCY48	HRFT331JCA	R CHIP	1/10 330 OHM J 2012	
RCY50	HRFT334JCA	R CHIP	1/10 330K OHM J 2012	
RCY51	HRFT302JCA	R CHIP	1/10 3K OHM J 2012	
RCY52	HRFT132JCA	R CHIP	1/10 1.3K OHM J 2012	
RCY53	HRFT122JCA	R CHIP	1/10 1.2K OHM J 2012	
RCY55	HRFT103JCA	R CHIP	1/10 10K OHM J 2012	
RCY56	HRFT512JCA	R CHIP	1/10 5.1K OHM J 2012	
RCY57	HRFT103JCA	R CHIP	1/10 10K OHM J 2012	
RCY59	HRFT470JCA	R CHIP	1/10 47 OHM J 2012	
RCY60	HRFT221JCA	R CHIP	1/10 220 OHM J 2012	
RCY61	HRFT271JCA	R CHIP	1/10 270 OHM J 2012	
RCY66	HRFT302JCA	R CHIP	1/10 3K OHM J 2012	
RCY67	HRFT101JCA	R CHIP	1/10 100 OHM J 2012	
RCY68	HRFT681JCA	R CHIP	1/10 680 OHM J 2012	
RCY69	HRFT122JCA	R CHIP	1/10 1.2K OHM J 2012	
RCY70	HRFT104JCA	R CHIP	1/10 100K OHM J 2012	
RCY71	HRFT104JCA	R CHIP	1/10 100K OHM J 2012	
RCY72	HRFT103JCA	R CHIP	1/10 10K OHM J 2012	
RCY74	HRFT154JCA	R CHIP	1/10 150K OHM J 2012	

LOC	PART CODE	PART NAME	PART TYPE	REMARK
RCY75	HRFT154JCA	R CHIP	1/10 150K OHM J 2012	
RCY77	HRFT223JCA	R CHIP	1/10 22K OHM J 2012	
RCY78	HRFT273JCA	R CHIP	1/10 27K OHM J 2012	
RCY79	HRFT104JCA	R CHIP	1/10 100K OHM J 2012	
RCY80	HRFT104JCA	R CHIP	1/10 100K OHM J 2012	
RCY81	HRFT103JCA	R CHIP	1/10 10K OHM J 2012	
XNC01	HXA32R768C	CRYSTAL CHIP QUARTZ	32.768KHZ 20PPM 8038	
C230	CEXF1C471V	C ELECTRO	16V RSS 470MF (10X12.5)TP	
C237	CEXF1E331V	C ELECTRO	25V RSS 330MF (10X12.5)TP	
C566	CEXF1C102V	C ELECTRO	16V RSS 1000MF (10X20) TP	
C567	CEXF1C102V	C ELECTRO	16V RSS 1000MF (10X20) TP	
C610	CEXF1E471C	C ELECTRO	25V RUS 470MF (10X16) TP	
P101	485923162S	CONN WAFER	YW025-03 (STICK)	
P601	485923162S	CONN WAFER	YW025-03 (STICK)	
PY04	485923202S	CONN WAFER	YW025-07 (STICK)	
R121	RS02Z200JS	R M-OXIDE FILM	2W 20 OHM J SMALL	
R738	RS02Z270JS	R M-OXIDE FILM	2W 27 OHM J SMALL	
RN53	RS02Z399JS	R M-OXIDE FILM	2W 3.9 OHM J SMALL	
C107	CEXF1E470V	C ELECTRO	25V RSS 47MF (5X11) TP	
C225	CEXF1H220V	C ELECTRO	50V RSS 22MF (5X11) TP	
C226	CEXF1E470V	C ELECTRO	25V RSS 47MF (5X11) TP	
C227	CEXF1H109V	C ELECTRO	50V RSS 1MF (5X11) TP	
C229	CEXF1E470V	C ELECTRO	25V RSS 47MF (5X11) TP	
C231	CEXF1H479V	C ELECTRO	50V RSS 4.7MF (5X11) TP	
C232	CEXF1H479V	C ELECTRO	50V RSS 4.7MF (5X11) TP	
C233	CEXF1E101V	C ELECTRO	25V RSS 100MF (6.3X11) TP	
C234	CEXF1E101V	C ELECTRO	25V RSS 100MF (6.3X11) TP	
C543	CEXF1H229V	C ELECTRO	50V RSS 2.2MF (5X11) TP	
C545	CMXM2A104J	C MYLAR	100V 0.1MF J (TP)	
C546	CMXM2A104J	C MYLAR	100V 0.1MF J (TP)	
C547	CMXM2A473J	C MYLAR	100V 0.047MF J (TP)	
C548	CMXM2A104J	C MYLAR	100V 0.1MF J (TP)	
C553	CEXF1H100V	C ELECTRO	50V RSS 10MF (5X11) TP	
C555	CMXB1H224J	C MYLAR	50V EU 0.22MF J (TP)	
C556	CEXF1E470V	C ELECTRO	25V RSS 47MF (5X11) TP	
C557	CEXF1E470V	C ELECTRO	25V RSS 47MF (5X11) TP	

LOC	PART CODE	PART NAME	PART TYPE	REMARK
C558	CEXF1E470V	C ELECTRO	25V RSS 47MF (5X11) TP	
C559	CEXF1E470V	C ELECTRO	25V RSS 47MF (5X11) TP	
C560	CEXF1E470V	C ELECTRO	25V RSS 47MF (5X11) TP	
C562	CEXF1E470V	C ELECTRO	25V RSS 47MF (5X11) TP	
C564	CEXF1E101V	C ELECTRO	25V RSS 100MF (6.3X11) TP	
C565	CEXF1E101V	C ELECTRO	25V RSS 100MF (6.3X11) TP	
C570	CEXF1E101V	C ELECTRO	25V RSS 100MF (6.3X11) TP	
C571	CEXF1H478V	C ELECTRO	50V RSS 0.47MF (5X11) TP	
C591	CEXF1E101V	C ELECTRO	25V RSS 100MF (6.3X11) TP	
C609	CEXF1E470V	C ELECTRO	25V RSS 47MF (5X11) TP	
C611	CEXF1E470V	C ELECTRO	25V RSS 47MF (5X11) TP	
C719	CEXF1C470A	C ELECTRO	16V RSM 47MF (5X7) TP	
C720	CEXF1A471V	C ELECTRO	10V RSS 470MF 8X11.5	
C721	CEXF1C101A	C ELECTRO	16V RSM 100MF (6.3X7) TP	
C722	CEXF1A471V	C ELECTRO	10V RSS 470MF 8X11.5	
C723	CEXF1C101A	C ELECTRO	16V RSM 100MF (6.3X7) TP	
C724	CEXF1E221V	C ELECTRO	25V RSS 220MF (8X11.5) TP	
CL22	CEXF1C470A	C ELECTRO	16V RSM 47MF (5X7) TP	
CL23	CEXF1C470A	C ELECTRO	16V RSM 47MF (5X7) TP	
CL28	CEXD1H229F	C ELECTRO	50V RND 2.2MF (5X11) TP	
CL30	CEXD1H229F	C ELECTRO	50V RND 2.2MF (5X11) TP	
CN23	CXCH1H180J	C CERA	50V CH 18PF J (TAPPING)	
CN24	CXCH1H180J	C CERA	50V CH 18PF J (TAPPING)	
CN25	CXCH1H220J	C CERA	50V CH 22PF J (TAPPING)	
CN26	CXCH1H220J	C CERA	50V CH 22PF J (TAPPING)	
CN27	CEXF1C470A	C ELECTRO	16V RSM 47MF (5X7) TP	
CN30	CEXF1C470A	C ELECTRO	16V RSM 47MF (5X7) TP	
CN31	CEXF1C470A	C ELECTRO	16V RSM 47MF (5X7) TP	
CN34	CEXF1A471V	C ELECTRO	10V RSS 470MF 8X11.5	
CN35	CEXF1C470A	C ELECTRO	16V RSM 47MF (5X7) TP	
CN36	CEXF1C470A	C ELECTRO	16V RSM 47MF (5X7) TP	
CN46	CEXF1E221V	C ELECTRO	25V RSS 220MF (8X11.5) TP	
CN47	CEXF1C101A	C ELECTRO	16V RSM 100MF (6.3X7) TP	
CN56	CEXF1C470A	C ELECTRO	16V RSM 47MF (5X7) TP	
CQ02	CEXF1H100V	C ELECTRO	50V RSS 10MF (5X11) TP	
CQ03	CEXF1E101V	C ELECTRO	25V RSS 100MF (6.3X11) TP	
CY49	CMXM2A223J	C MYLAR	100V 0.022MF J TP	
CY57	CEXF1H478A	C ELECTRO	50V RSM 0.47MF (4X7)	
CY58	CEXF1H478A	C ELECTRO	50V RSM 0.47MF (4X7)	

LOC	PART CODE	PART NAME	PART TYPE	REMARK
CY61	CEXF1H109A	C ELECTRO	50V RSM 1MF (4X7) TP	
CY72	CEXF1C470A	C ELECTRO	16V RSM 47MF (5X7) TP	
CY73	CEXF1C470A	C ELECTRO	16V RSM 47MF (5X7) TP	
CY78	CEXF1C220A	C ELECTRO	16V RSM 22MF (5X7)	
CY80	CEXF1C470A	C ELECTRO	16V RSM 47MF (5X7) TP	
CY81	CEXF1C470A	C ELECTRO	16V RSM 47MF (5X7) TP	
CY82	CEXF1C470A	C ELECTRO	16V RSM 47MF (5X7) TP	
CY83	CEXF1C470A	C ELECTRO	16V RSM 47MF (5X7) TP	
CY85	CEXF1H220V	C ELECTRO	50V RSS 22MF (5X11) TP	
CY86	CEXF1C470A	C ELECTRO	16V RSM 47MF (5X7) TP	
CY88	CEXF1C220A	C ELECTRO	16V RSM 22MF (5X7)	
CY90	CEXF1C470A	C ELECTRO	16V RSM 47MF (5X7) TP	
LY12	5CPX103J--	COIL PEAKING	10MH 5MM J RADIAL	
QQ01	TKRC102M--	TR	KRC 102-M (TAPPING)	
QQ02	TKRC102M--	TR	KRC 102-M (TAPPING)	
QQ03	TKRC102M--	TR	KRC 102-M (TAPPING)	
QY04	TKTC3202Y-	TR	KTC3202Y (TP)	
R202	RV4121203-	R SEMI FIXED	NVZ6TH1 20K OHM	
R240	RV5426103P	R SEMI FIXED	RH0638C 10K OHM B	
SW02	5S50101090	SW TACT	SKHV17910A	
SW03	5S50101090	SW TACT	SKHV17910A	
SW04	5S50101090	SW TACT	SKHV17910A	
SW05	5S50101090	SW TACT	SKHV17910A	
SW09	5S50101090	SW TACT	SKHV17910A	
SW10	5S50101Z90	SW TACT	SKHV10910A	
X501	5XEX3R579C	CRYSTAL QUARTZ	HC-49U 3.579545M (TP)	
X502	5XEX4R436C	CRYSTAL QUARTZ	HC-49U 4.433619M 20PP TA	
XL01	5XJX4R286C	CRYSTAL QUARTZ	HC-49S 4.286000M 20PPM TP	
XN02	5XJX16R00E	CRYSTAL QUARTZ	HC-49S 16.00000M 30PPM TP	
XY02	5XJX4R433B	CRYSTAL QUARTZ	HC-49S 4.433619M 15PPM TP	
Z204	5PXF5H5R5M	FILTER CERA	SFSH5.5MCB-TF21 (TP)	
Z206	5PXPS5R5MB	FILTER CERA	TPS5.5MB-TF21 (TP)	
Z502	5PXF5H5R5M	FILTER CERA	SFSH5.5MCB-TF21 (TP)	
Z504	5PXPS5R5MB	FILTER CERA	TPS5.5MB-TF21 (TP)	
A001	4859801593	PCB MAIN	330X246 D1B	
C501	CBZF1H104Z	C CERA AXIAL	50V F 0.1MF Z	
C502	CBZF1H104Z	C CERA AXIAL	50V F 0.1MF Z	
CL07	CCZF1E103Z	C CERA	25V F 0.01MF Z (AXIAL)	

LOC	PART CODE	PART NAME	PART TYPE	REMARK
CL13	CCZF1E103Z	C CERA	25V F 0.01MF Z (AXIAL)	
CN01	CCZF1E103Z	C CERA	25V F 0.01MF Z (AXIAL)	
CN03	CCZF1E103Z	C CERA	25V F 0.01MF Z (AXIAL)	
CN04	CCZF1E103Z	C CERA	25V F 0.01MF Z (AXIAL)	
CN05	CCZF1E103Z	C CERA	25V F 0.01MF Z (AXIAL)	
CN06	CCZF1E103Z	C CERA	25V F 0.01MF Z (AXIAL)	
CN13	CCZF1E103Z	C CERA	25V F 0.01MF Z (AXIAL)	
CN18	CCZF1E103Z	C CERA	25V F 0.01MF Z (AXIAL)	
CN19	CCZF1E103Z	C CERA	25V F 0.01MF Z (AXIAL)	
CN33	CBZF1H104Z	C CERA AXIAL	50V F 0.1MF Z	
CN51	CCZB1H101K	C CERA AXIAL	50V B 100PF K	
CN53	CCZB1H101K	C CERA AXIAL	50V B 100PF K	
CN54	CCZB1H101K	C CERA AXIAL	50V B 100PF K	
CN55	CCZB1H101K	C CERA AXIAL	50V B 100PF K	
CN59	CCZF1E223Z	C CERA AXIAL	25V F 0.022MF Z	
CY07	CCZF1E103Z	C CERA	25V F 0.01MF Z (AXIAL)	
CY12	CCZF1E103Z	C CERA	25V F 0.01MF Z (AXIAL)	
CY13	CCZF1E103Z	C CERA	25V F 0.01MF Z (AXIAL)	
CY17	CCZF1E223Z	C CERA AXIAL	25V F 0.022MF Z	
CY18	CCZF1E103Z	C CERA	25V F 0.01MF Z (AXIAL)	
CY87	CBZF1H104Z	C CERA AXIAL	50V F 0.1MF Z	
CY95	CBZR1C562M	C CERA AXIAL	16V Y5R 5600PF M	
D103	85801065GY	WIRE COPPER	AWG22 1/0.65 TIN COATING	
D104	85801065GY	WIRE COPPER	AWG22 1/0.65 TIN COATING	
D106	D1N4003---	DIODE	1N4003 (TAPPING)	
D109	DUZ5R1BM--	DIODE ZENER	UZ-5.1BM	
D110	DUZ5R1BM--	DIODE ZENER	UZ-5.1BM	
D111	DUZ5R1BM--	DIODE ZENER	UZ-5.1BM	
D112	DUZ9R1BM--	DIODE ZENER	UZ-9.1BM 9.1V	
D501	DUZ5R1BM--	DIODE ZENER	UZ-5.1BM	
D502	D1N4148---	DIODE	1N4148 (TAPPING)	
D503	DUZ5R1BM--	DIODE ZENER	UZ-5.1BM	
D504	D1N4148---	DIODE	1N4148 (TAPPING)	
D507	D1N4148---	DIODE	1N4148 (TAPPING)	
D508	DUZ6R2BM--	DIODE ZENER	UZ-6.2BM 6.2V	
D509	DUZ6R2BM--	DIODE ZENER	UZ-6.2BM 6.2V	
D510	DUZ6R2BM--	DIODE ZENER	UZ-6.2BM 6.2V	
D511	DUZ6R2BM--	DIODE ZENER	UZ-6.2BM 6.2V	
D512	DUZ6R2BM--	DIODE ZENER	UZ-6.2BM 6.2V	

LOC	PART CODE	PART NAME	PART TYPE	REMARK
D513	DUZ6R2BM--	DIODE ZENER	UZ-6.2BM 6.2V	
D514	DUZ6R2BM--	DIODE ZENER	UZ-6.2BM 6.2V	
D515	DUZ6R2BM--	DIODE ZENER	UZ-6.2BM 6.2V	
D516	DUZ6R2BM--	DIODE ZENER	UZ-6.2BM 6.2V	
D517	D1N4148---	DIODE	1N4148 (TAPPING)	
D701	D1N4148---	DIODE	1N4148 (TAPPING)	
D702	D1N4148---	DIODE	1N4148 (TAPPING)	
D703	D1N4148---	DIODE	1N4148 (TAPPING)	
D704	D1N4148---	DIODE	1N4148 (TAPPING)	
D705	D1N4003---	DIODE	1N4003 (TAPPING)	
D706	D1N4148---	DIODE	1N4148 (TAPPING)	
D707	DUZ9R1BM--	DIODE ZENER	UZ-9.1BM 9.1V	
D709	D1N4148---	DIODE	1N4148 (TAPPING)	
DA01	DUZ6R2BM--	DIODE ZENER	UZ-6.2BM 6.2V	
DA02	D1N4148---	DIODE	1N4148 (TAPPING)	
DA03	DMTZ6R2B--	DIODE ZENER	MTZ 6.2-B (TAPPING)	
DN02	D1N4003---	DIODE	1N4003 (TAPPING)	
DN03	D1N4003---	DIODE	1N4003 (TAPPING)	
DN05	DUZ6R2BM--	DIODE ZENER	UZ-6.2BM 6.2V	
DN07	D1N4148---	DIODE	1N4148 (TAPPING)	
DN08	D1N4148---	DIODE	1N4148 (TAPPING)	
DQ04	DUZ6R2BM--	DIODE ZENER	UZ-6.2BM 6.2V	
DQ05	DUZ6R2BM--	DIODE ZENER	UZ-6.2BM 6.2V	
DQ06	DUZ6R2BM--	DIODE ZENER	UZ-6.2BM 6.2V	
DQ07	D1N4148---	DIODE	1N4148 (TAPPING)	
DY01	D1N4148---	DIODE	1N4148 (TAPPING)	
DY02	D1N4148---	DIODE	1N4148 (TAPPING)	
DY03	D1N4148---	DIODE	1N4148 (TAPPING)	
DY04	D1N4148---	DIODE	1N4148 (TAPPING)	
DY05	D1N4148---	DIODE	1N4148 (TAPPING)	
DY06	D1N4148---	DIODE	1N4148 (TAPPING)	
DY07	D1N4148---	DIODE	1N4148 (TAPPING)	
L202	5CPZ150K02	COIL PEAKING	15UH K (AXIAL 3.5MM)	
L203	5CPZ220K02	COIL PEAKING	22UH K (AXIAL 3.5MM)	
L501	5CPZ100K04	COIL PEAKING	10UH 10.5MM K (LAL04TB)	
L502	5CPZ100K04	COIL PEAKING	10UH 10.5MM K (LAL04TB)	
L503	5CPZ100K04	COIL PEAKING	10UH 10.5MM K (LAL04TB)	
L504	5CPZ100K02	COIL PEAKING	10UH K (AXIAL 3.5MM)	
L505	5CPZ829K02	COIL PEAKING	8.2UH K (AXIAL 3.5MM)	

LOC	PART CODE	PART NAME	PART TYPE	REMARK
L506	5CPZ569K02	COIL PEAKING	5.6UH K (AXIAL 3.5MM)	
L601	5CPZ100K04	COIL PEAKING	10UH 10.5MM K (LAL04TB)	
L602	5MC0000100	COIL BEAD	BI-3857	
L603	5MC0000100	COIL BEAD	BI-3857	
L702	5CPZ101K04	COIL PEAKING	100UH K (AXIAL 10.5MM)	
L703	5CPZ689K02	COIL PEAKING	6.8UH K (AXIAL 3.5MM)	
LA01	5CPZ100K04	COIL PEAKING	10UH 10.5MM K (LAL04TB)	
LL03	5CPZ101K04	COIL PEAKING	100UH K (AXIAL 10.5MM)	
LY01	5CPZ101K04	COIL PEAKING	100UH K (AXIAL 10.5MM)	
LY02	5CPZ101K04	COIL PEAKING	100UH K (AXIAL 10.5MM)	
LY03	5CPZ101K04	COIL PEAKING	100UH K (AXIAL 10.5MM)	
LY04	5CPZ101K04	COIL PEAKING	100UH K (AXIAL 10.5MM)	
LY05	5CPZ101K04	COIL PEAKING	100UH K (AXIAL 10.5MM)	
LY06	5CPZ560K02	COIL PEAKING	56UH K (AXIAL 3.5MM)	
LY07	5CPZ121K02	COIL PEAKING	120UH K (AXIAL 3.5MM)	
LY08	5CPZ150K02	COIL PEAKING	15UH K (AXIAL 3.5MM)	
LY10	5CPZ101K04	COIL PEAKING	100UH K (AXIAL 10.5MM)	
LY11	5CPZ270K02	COIL PEAKING	27UH K (AXIAL 3.5MM)	
LY13	5CPZ221K02	COIL PEAKING	220UH 3.5MM K (LAL02TB)	
R101	RD-2Z159J-	R CARBON FILM	1/2 1.5 OHM J	
R102	RD-AZ822J-	R CARBON FILM	1/6 8.2K OHM J	
R112	RD-AZ122J-	R CARBON FILM	1/6 1.2K OHM J	
R122	RD-AZ221J-	R CARBON FILM	1/6 220 OHM J	
R203	RD-AZ104J-	R CARBON FILM	1/6 100K OHM J	
R218	RD-AZ223J-	R CARBON FILM	1/6 22K OHM J	
R219	RD-AZ822J-	R CARBON FILM	1/6 8.2K OHM J	
R227	RD-AZ470J-	R CARBON FILM	1/6 47 OHM J	
R504	RD-4Z109J-	R CARBON FILM	1/4 1 OHM J	
R505	RD-4Z100J-	R CARBON FILM	1/4 10 OHM J	
R506	RD-4Z109J-	R CARBON FILM	1/4 1 OHM J	
R508	RD-4Z271J-	R CARBON FILM	1/4 270 OHM J	
R516	RD-AZ102J-	R CARBON FILM	1/6 1K OHM J	
R517	RD-AZ101J-	R CARBON FILM	1/6 100 OHM J	
R525	RD-AZ102J-	R CARBON FILM	1/6 1K OHM J	
R529	RD-AZ102J-	R CARBON FILM	1/6 1K OHM J	
R540	RD-AZ103J-	R CARBON FILM	1/6 10K OHM J	
R549	RD-AZ221J-	R CARBON FILM	1/6 220 OHM J	
R550	RD-AZ221J-	R CARBON FILM	1/6 220 OHM J	
R551	85801065GY	WIRE COPPER	AWG22 1/0.65 TIN COATING	

LOC	PART CODE	PART NAME	PART TYPE	REMARK
R563	RD-AZ473J-	R CARBON FILM	1/6 47K OHM J	
R572	RD-AZ822J-	R CARBON FILM	1/6 8.2K OHM J	
R573	RD-AZ103J-	R CARBON FILM	1/6 10K OHM J	
R576	RD-AZ122J-	R CARBON FILM	1/6 1.2K OHM J	
R601	RD-4Z221J-	R CARBON FILM	1/4 220 OHM J	
R602	RD-4Z221J-	R CARBON FILM	1/4 220 OHM J	
R701	RD-4Z100J-	R CARBON FILM	1/4 10 OHM J	
R708	RD-AZ121J-	R CARBON FILM	1/6 120 OHM J	
R709	RD-AZ121J-	R CARBON FILM	1/6 120 OHM J	
R710	RD-AZ121J-	R CARBON FILM	1/6 120 OHM J	
R713	RD-AZ101J-	R CARBON FILM	1/6 100 OHM J	
R720	RD-AZ101J-	R CARBON FILM	1/6 100 OHM J	
R721	RD-AZ101J-	R CARBON FILM	1/6 100 OHM J	
R728	RD-AZ472J-	R CARBON FILM	1/6 4.7K OHM J	
R737	RD-AZ823J-	R CARBON FILM	1/6 82K OHM J	
RA01	RD-AZ222J-	R CARBON FILM	1/6 2.2K OHM J	
RL01	RD-AZ223J-	R CARBON FILM	1/6 22K OHM J	
RL10	RD-AZ102J-	R CARBON FILM	1/6 1K OHM J	
RL11	RD-AZ102J-	R CARBON FILM	1/6 1K OHM J	
RN04	RD-AZ221J-	R CARBON FILM	1/6 220 OHM J	
RN05	RD-AZ221J-	R CARBON FILM	1/6 220 OHM J	
RN06	RD-AZ223J-	R CARBON FILM	1/6 22K OHM J	
RN08	RD-AZ432J-	R CARBON FILM	1/6 4.3K OHM J	
RN12	RD-AZ103J-	R CARBON FILM	1/6 10K OHM J	
RN13	RD-AZ103J-	R CARBON FILM	1/6 10K OHM J	
RN14	RD-AZ103J-	R CARBON FILM	1/6 10K OHM J	
RN15	RD-AZ103J-	R CARBON FILM	1/6 10K OHM J	
RN19	RD-AZ103J-	R CARBON FILM	1/6 10K OHM J	
RN20	RD-AZ472J-	R CARBON FILM	1/6 4.7K OHM J	
RN21	RD-AZ301J-	R CARBON FILM	1/6 300 OHM J	
RN22	RD-AZ301J-	R CARBON FILM	1/6 300 OHM J	
RN25	RD-AZ273J-	R CARBON FILM	1/6 27K OHM J	
RN26	RD-AZ273J-	R CARBON FILM	1/6 27K OHM J	
RN29	RD-AZ182J-	R CARBON FILM	1/6 1.8K OHM J	
RN33	RD-AZ153J-	R CARBON FILM	1/6 15K OHM J	
RN35	RD-AZ221J-	R CARBON FILM	1/6 220 OHM J	
RN36	RD-AZ221J-	R CARBON FILM	1/6 220 OHM J	
RN38	RD-AZ101J-	R CARBON FILM	1/6 100 OHM J	
RN39	RD-AZ101J-	R CARBON FILM	1/6 100 OHM J	

LOC	PART CODE	PART NAME	PART TYPE	REMARK
RN43	RD-AZ332J-	R CARBON FILM	1/6 3.3K OHM J	
RN44	RD-AZ332J-	R CARBON FILM	1/6 3.3K OHM J	
RN46	RD-AZ102J-	R CARBON FILM	1/6 1K OHM J	
RN47	RD-AZ102J-	R CARBON FILM	1/6 1K OHM J	
RN48	RD-AZ102J-	R CARBON FILM	1/6 1K OHM J	
RN56	RD-AZ472J-	R CARBON FILM	1/6 4.7K OHM J	
RN57	RD-AZ472J-	R CARBON FILM	1/6 4.7K OHM J	
RN58	RD-AZ472J-	R CARBON FILM	1/6 4.7K OHM J	
RN59	RD-AZ472J-	R CARBON FILM	1/6 4.7K OHM J	
RN63	RD-AZ472J-	R CARBON FILM	1/6 4.7K OHM J	
RQ01	RD-AZ561J-	R CARBON FILM	1/6 560 OHM J	
RQ02	RD-AZ561J-	R CARBON FILM	1/6 560 OHM J	
RQ03	RD-AZ561J-	R CARBON FILM	1/6 560 OHM J	
RQ12	RD-AZ112J-	R CARBON FILM	1/6 1.1K OHM J	
RQ15	RD-AZ221J-	R CARBON FILM	1/6 220 OHM J	
RY05	RD-AZ102J-	R CARBON FILM	1/6 1K OHM J	
RY06	RD-AZ102J-	R CARBON FILM	1/6 1K OHM J	
RY12	RD-AZ182J-	R CARBON FILM	1/6 1.8K OHM J	
RY21	RD-AZ229J-	R CARBON FILM	1/6 2.2 OHM J	
RY22	RD-AZ229J-	R CARBON FILM	1/6 2.2 OHM J	
RY27	RD-AZ513J-	R CARBON FILM	1/6 51K OHM J	
RY28	RD-AZ333J-	R CARBON FILM	1/6 33K OHM J	
RY31	RD-AZ513J-	R CARBON FILM	1/6 51K OHM J	
RY46	RD-AZ391J-	R CARBON FILM	1/6 390 OHM J	
RY47	RD-AZ561J-	R CARBON FILM	1/6 560 OHM J	
RY48	RD-AZ820J-	R CARBON FILM	1/6 82 OHM J	
RY54	RD-AZ122J-	R CARBON FILM	1/6 1.2K OHM J	
RY58	RD-AZ151J-	R CARBON FILM	1/6 150 OHM J	
RY60	RD-AZ472J-	R CARBON FILM	1/6 4.7K OHM J	
RY73	RD-AZ103J-	R CARBON FILM	1/6 10K OHM J	
RY76	RD-AZ332J-	R CARBON FILM	1/6 3.3K OHM J	
C415	CMYE2D474J	C MYLAR	200V PU 0.47MF J	⚠
C416	CMYH3C752J	C MYLAR	1.6KV BUP 7500PF J	⚠
C801	CL1JB3474K	C LINE ACROSS	AC250V 0.47MF U/C/SNDF/SV	
C808	CH1FFF472M	C CERA AC	AC400V 4700PF F DE7150F	⚠
C819	CEYN2G181P	C ELECTRO	400V LHS 180MF (25X35)	⚠
D811	DBYW95C---	DIODE	BYW95C (TAPPING)	
D812	DBYW95C---	DIODE	BYW95C (TAPPING)	⚠

LOC	PART CODE	PART NAME	PART TYPE	REMARK
D815	DBYW95C---	DIODE	BYW95C (TAPPING)	⚠
D819	1UPC574J--	IC	UPC574J	
F801	5FSCB4022R	FUSE CERA	SEMKO F4AH 4A 250V MF51	
I301	PTA2SW4617	HEAT SINK ASS`Y	1TDA8356-- + 7174301011	
I301	1TDA8356--	IC VERTICAL	TDA8356	
I301A	4857024617	HEAT SINK	AL EX	
I301B	7174301011	SCREW TAPPTITE	TT2 RND 3X10 MFZN	
I801	1STRS5707-	IC POWER	STR-S5707	
I801A	4857024602	HEAT SINK	AL EX (2160AS)	
I801B	7174301011	SCREW TAPPTITE	TT2 RND 3X10 MFZN	
I802	PTB2SW7301	HEAT SINK ASS`Y	1K1A7812P1 + 7174301011	
I802	1K1A7812P1	IC REGULATOR	KIA7812PI	
I802A	4857027301	HEAT SINK	AL 6063S-T5	
I802B	7174301011	SCREW TAPPTITE	TT2 RND 3X10 MFZN	
I804	1K1A7812P1	IC REGULATOR	KIA7812PI	
I804B	7174301011	SCREW TAPPTITE	TT2 RND 3X10 MFZN	
I805	1K1A7806P1	IC REGULATOR	KIA7806PI	
I805B	7174301011	SCREW TAPPTITE	TT2 RND 3X10 MFZN	
I806	1K1A7806P1	IC REGULATOR	KIA7806PI	
I807	1T0P210---	IC STAND BY	TOP210	
I901	1TDA6106Q-	IC AMP	TDA6106Q	⚠
I902	1TDA6106Q-	IC AMP	TDA6106Q	
I903	1TDA6106Q-	IC AMP	TDA6106Q	
L404	58H0000018	COIL H-LINEARITY	L-125 (125UH)	
L801	5PLF24A1--	FILTER LINE	LF-24A1	
P401	4859240020	CONN WAFER	YFW500-05	
P805	4859235320	CONN WAFER	YW025-10	
P906	4859249120	CONN WAFER	YF254-05	
PA904	4850703S19	CONN AS	YH025-03+YST025+ULW=300	
PWC1	4859903110	CORD POWER AS	CW4232+BL102NG+TUBE=2500	
A000	4859903511	CORD POWER	CW4232 H03VVH2-F=2250	⚠
Q402	T2SD2499--	TR	2SD2499	
Q402A	4857024510	HEAT SINK	AL EX	
Q402B	7174301011	SCREW TAPPTITE	TT2 RND 3X10 MFZN	
R801	DEC180M290	POSISTOR	ECPCC180M290	
R803	RX10T339J-	R CEMENT	10W 3.3 OHM J TRIPOD	
RLY1	5SC0202334	SW RELAY	DJ5D2-0(M)-0.25W	
RLY2	5SC0101003	SW RELAY	DG12D1-0(M)-II 1C-1P	

LOC	PART CODE	PART NAME	PART TYPE	REMARK
SCT01	4859303030	SOCKET CRT	ISMM03S	⚠
T401	50D0000022	TRANS DRIVE	HD-15D	⚠
T402	50H0000177	FBT	HST1142.5057	⚠
T801	50M4042A2J	TRANS SMPS	TSM-4042A2	⚠
T802	50MST22A3J	TRANS SMPS	ST-22A3	⚠
C307	CEXF2C470V	C ELECTRO	160V RSS 47MF (13X25) TP	
C308	CEXF1E471V	C ELECTRO	25V RSS 470MF (10X16) TP	
C406	CCXB3D471K	C CERA	2KV B 470PF K (TAPPING)	
C409	CEXF2C330V	C ELECTRO	160V RSS 33MF (13X20) TP	
C410	CEXF2C339V	C ELECTRO	160V RSS 3.3MF (8X16) TP	
C413	CEXF2E330V	C ELECTRO	250V RSS 33MF (13X25) TP	
C810	CCXB3D681K	C CERA	2KV B 680PF K (TAPPING)	
C816	CEXF2A100V	C ELECTRO	100V RSS 10MF (6.3X11) TP	
C817	CEXF1E221C	C ELECTRO	25V RUS 220MF (8X11.5) TP	
C818	CEXF1E331V	C ELECTRO	25V RSS 330MF (10X12.5)TP	
C820	CEXF2C101V	C ELECTRO	160V RSS 100MF (16X25) TP	
C822	CEXF1C471V	C ELECTRO	16V RSS 470MF (10X12.5)TP	
C823	CEXF2G220V	C ELECTRO	400V RSS 22MF (16X25) TP	
C825	CEXF1C102V	C ELECTRO	16V RSS 1000MF (10X20) TP	
C827	CEXF1E471V	C ELECTRO	25V RSS 470MF (10X16) TP	
C828	CEXF1E471V	C ELECTRO	25V RSS 470MF (10X16) TP	
C832	CEXF1C471V	C ELECTRO	16V RSS 470MF (10X12.5)TP	
C833	CEXF1C102V	C ELECTRO	16V RSS 1000MF (10X20) TP	
C835	CMXE2J222J	C MYLAR	PL 630V 2200PF J	
C911	CCXB3D102K	C CERA	2KV B 1000PF K (TAPPING)	
C913	CEXF1C331V	C ELECTRO	16V RSS 330MF (8X11.5) TP	
P405	485923182S	CONN WAFER	YW025-05 (STICK)	
P406	485923182S	CONN WAFER	YW025-05 (STICK)	
P801A	4857417500	TERM PIN	DA-IB0214(D2.3/DY PIN)	
P801B	4857417500	TERM PIN	DA-IB0214(D2.3/DY PIN)	
P802A	4857417500	TERM PIN	DA-IB0214(D2.3/DY PIN)	
P802B	4857417500	TERM PIN	DA-IB0214(D2.3/DY PIN)	
P803	485923162S	CONN WAFER	YW025-03 (STICK)	
P901	485923202S	CONN WAFER	YW025-07 (STICK)	
P904	485923162S	CONN WAFER	YW025-03 (STICK)	
P905	4857417500	TERM PIN	DA-IB0214(D2.3/DY PIN)	
R306	RS02Z271JS	R M-OXIDE FILM	2W 270 OHM J SMALL	

LOC	PART CODE	PART NAME	PART TYPE	REMARK
R401	RS02Z912JS	R M-OXIDE FILM	2W 9.1K OHM J SMALL	⚠
R402	RS02Z912JS	R M-OXIDE FILM	2W 9.1K OHM J SMALL	
R403	RS02Z912JS	R M-OXIDE FILM	2W 9.1K OHM J SMALL	
R407	RS02Z512JS	R M-OXIDE FILM	2W 5.1K OHM J SMALL	
R409	RS02Z512JS	R M-OXIDE FILM	2W 5.1K OHM J SMALL	
R419	RS01Z129J-	R M-OXIDE FILM	1W 1.2 OHM J (TAPPING)	
R420	RS01Z102J-	R M-OXIDE FILM	1W 1K OHM J (TAPPING)	
R804	RS02Z473JS	R M-OXIDE FILM	2W 47K OHM J SMALL	
R805	RS02Z562JS	R M-OXIDE FILM	2W 5.6K OHM J SMALL	
R816	RS02Z470JS	R M-OXIDE FILM	2W 47 OHM J SMALL	
R817	RF02Z338J-	R FUSIBLE	2W 0.33 OHM J (TAPPING)	
R823	RS02Z562JS	R M-OXIDE FILM	2W 5.6K OHM J SMALL	
R830	RS02Z109JS	R M-OXIDE FILM	2W 1 OHM J SMALL	
WP01	4857417500	TERM PIN	DA-IB0214(D2.3/DY PIN)	
C302	CCXB1H102K	C CERA	50V B 1000PF K (TAPPING)	⚠
C305	CCXB2H471K	C CERA	500V B 470PF K (TAPPING)	
C306	CCXB2H102K	C CERA	500V B 1000PF K (TAPPING)	
C310	CMXM2A104J	C MYLAR	100V 0.1MF J (TP)	
C401	CCXB2H472K	C CERA	500V B 4700PF K (TAPPING)	
C402	CCXB2H221K	C CERA	500V B 220PF K (TAPPING)	
C403	CCXB2H472K	C CERA	500V B 4700PF K (TAPPING)	
C404	CCXB2H102K	C CERA	500V B 1000PF K (TAPPING)	
C407	CXSL2H470J	C CERA	500V SL 47PF J (TAPPING)	
C418	CMXM2A104J	C MYLAR	100V 0.1MF J (TP)	
C803	CCXF3A472Z	C CERA	1KV F 4700PF Z (T)	
C804	CCXF3A472Z	C CERA	1KV F 4700PF Z (T)	
C813	CCXF1H103Z	C CERA	50V F 0.01MF Z (TAPPING)	
C824	CEXF1H470V	C ELECTRO	50V RSS 47MF (6.3X11) TP	
C826	CEXF1E101V	C ELECTRO	25V RSS 100MF (6.3X11) TP	
C829	CEXF1E101C	C ELECTRO	25V RUS 100MF (6.3X11) TP	
C830	CEXF1E221V	C ELECTRO	25V RSS 220MF (8X11.5) TP	
C840	CEXF1E470V	C ELECTRO	25V RSS 47MF (5X11) TP	
C841	CCXF3A472Z	C CERA	1KV F 4700PF Z (T)	
C842	CCXF3A472Z	C CERA	1KV F 4700PF Z (T)	
C904	CMXL2E104K	C MYLAR	250V MEU 0.1MF K	
C905	CMXL2E104K	C MYLAR	250V MEU 0.1MF K	
C907	CCXB1H561K	C CERA	50V B 560PF K (TAPPING)	
C908	CCXB1H561K	C CERA	50V B 560PF K (TAPPING)	

LOC	PART CODE	PART NAME	PART TYPE	REMARK
C909	CCXB1H561K	C CERA	50V B 560PF K (TAPPING)	△
C910	CCXF1H473Z	C CERA	50V F 0.047MF Z (TAPPING)	
F801A	4857415001	CLIP FUSE	PFC5000-0702	
F801B	4857415001	CLIP FUSE	PFC5000-0702	
L403	58C0000096	COIL CHOKE	610G0233(470K)	
Q301	TKTC3198Y-	TR	KTC3198Y	
Q401	TKTC3207--	TR	KTC3207 (TP)	
Q403	TKTC3202Y-	TR	KTC3202Y (TP)	
Q803	TKTC3202Y-	TR	KTC3202Y (TP)	
Q901	TKTA1266Y-	TR	KTA1266Y (TP)	
ZZ200	PTPWJAA531	PCB POWER AXIAL AS	DVT-14F6LA	
A001	4859810711	PCB POWER	330X123(330X246/2)D1B	
C301	CCZB1H102K	C CERA AXIAL	50V B 1000PF K	
C309	CCZF1E103Z	C CERA	25V F 0.01MF Z (AXIAL)	
C807	CCZB1H102K	C CERA AXIAL	50V B 1000PF K	
C836	CBZF1H104Z	C CERA AXIAL	50V F 0.1MF Z	
C837	CBZF1H104Z	C CERA AXIAL	50V F 0.1MF Z	
C838	CBZF1H104Z	C CERA AXIAL	50V F 0.1MF Z	
C846	CCZF1E103Z	C CERA	25V F 0.01MF Z (AXIAL)	
D301	D1N4937---	DIODE	1N4937 (TAPPING)	
D302	D1N4937---	DIODE	1N4937 (TAPPING)	
D401	D1N4937---	DIODE	1N4937 (TAPPING)	
D402	D1N4937---	DIODE	1N4937 (TAPPING)	
D403	D1N4148---	DIODE	1N4148 (TAPPING)	
D404	D1N4937---	DIODE	1N4937 (TAPPING)	
D405	D1N4148---	DIODE	1N4148 (TAPPING)	
D406	D1N4148---	DIODE	1N4148 (TAPPING)	
D801	D1S1888---	DIODE	1S1888 (TAPPING)	
D802	D1S1888---	DIODE	1S1888 (TAPPING)	
D803	D1S1888---	DIODE	1S1888 (TAPPING)	
D804	D1S1888---	DIODE	1S1888 (TAPPING)	
D807	D1N4937---	DIODE	1N4937 (TAPPING)	
D808	D1N4937---	DIODE	1N4937 (TAPPING)	
D809	DBYV95C---	DIODE	BYV95C (TAPPING)	
D810	D1N4937---	DIODE	1N4937 (TAPPING)	
D813	DBYV95C---	DIODE	BYV95C (TAPPING)	
D814	DBYV95C---	DIODE	BYV95C (TAPPING)	
D822	DRU1P-----	DIODE	RU 1P (TAPPING)	
D823	D1N4148---	DIODE	1N4148 (TAPPING)	

LOC	PART CODE	PART NAME	PART TYPE	REMARK
D824	DR2KY----	DIODE AVALANCHE	R 2-KY (TAPPING)	
D825	D1S1888---	DIODE	1S1888 (TAPPING)	
D826	D1S1888---	DIODE	1S1888 (TAPPING)	
D827	D1S1888---	DIODE	1S1888 (TAPPING)	
D828	D1S1888---	DIODE	1S1888 (TAPPING)	
D830	D1N4148---	DIODE	1N4148 (TAPPING)	
D831	DBYV95C---	DIODE	BYV95C (TAPPING)	
D901	D1N4148---	DIODE	1N4148 (TAPPING)	
D902	D1N4148---	DIODE	1N4148 (TAPPING)	
D903	D1N4148---	DIODE	1N4148 (TAPPING)	
D904	D1N4148---	DIODE	1N4148 (TAPPING)	
L301	5CPZ100K04	COIL PEAKING	10UH 10.5MM K (LAL04TB)	
L302	5CPZ100K04	COIL PEAKING	10UH 10.5MM K (LAL04TB)	
L401	5CPZ109M02	COIL PEAKING	1UH M (AXIAL 3.5MM)	
L802	5MC0000100	COIL BEAD	BI-3857	
L803	5MC0000100	COIL BEAD	BI-3857	
L805	5MC0000100	COIL BEAD	BI-3857	
R301	RD-4Z182J-	R CARBON FILM	1/4 1.8K OHM J	
R302	RD-4Z472J-	R CARBON FILM	1/4 4.7K OHM J	
R304	RD-4Z109J-	R CARBON FILM	1/4 1 OHM J	
R310	RD-4Z471J-	R CARBON FILM	1/4 470 OHM J	
R311	RD-4Z472J-	R CARBON FILM	1/4 4.7K OHM J	
R312	RD-AZ223J-	R CARBON FILM	1/6 22K OHM J	
R313	RD-4Z472J-	R CARBON FILM	1/4 4.7K OHM J	
R314	RD-4Z473J-	R CARBON FILM	1/4 47K OHM J	
R406	RD-4Z562J-	R CARBON FILM	1/4 5.6K OHM J	
R408	RD-4Z102J-	R CARBON FILM	1/4 1K OHM J	
R410	RD-2Z104J-	R CARBON FILM	1/2 100K OHM J	
R412	RD-2Z273J-	R CARBON FILM	1/2 27K OHM J	
R413	RD-4Z303J-	R CARBON FILM	1/4 30K OHM J	
R415	RD-2Z224J-	R CARBON FILM	1/2 220K OHM J	
R418	RD-2Z103J-	R CARBON FILM	1/2 10K OHM J	
R421	RD-4Z472J-	R CARBON FILM	1/4 4.7K OHM J	
R422	RD-AZ152J-	R CARBON FILM	1/6 1.5K OHM J	
R807	RD-4Z330J-	R CARBON FILM	1/4 33 OHM J	
R808	RD-4Z222J-	R CARBON FILM	1/4 2.2K OHM J	
R810	RD-4Z104J-	R CARBON FILM	1/4 100K OHM J	
R811	RD-AZ102J-	R CARBON FILM	1/6 1K OHM J	
R812	RD-2Z224J-	R CARBON FILM	1/2 220K OHM J	

LOC	PART CODE	PART NAME	PART TYPE	REMARK
R813	RD-2Z224J-	R CARBON FILM	1/2 220K OHM J	⚠
R815	RC-2Z565J-	R CARBON COMP	1/2 5.6M OHM J	
R819	RD-2Z104J-	R CARBON FILM	1/2 100K OHM J	
R831	RD-4Z270J-	R CARBON FILM	1/4 27 OHM J	
R833	RD-4Z472J-	R CARBON FILM	1/4 4.7K OHM J	
R834	RD-4Z101J-	R CARBON FILM	1/4 100 OHM J	
R836	RD-4Z680J-	R CARBON FILM	1/4 68 OHM J	
R843	RD-AZ472J-	R CARBON FILM	1/6 4.7K OHM J	
R901	RD-AZ302J-	R CARBON FILM	1/6 3K OHM J	
R902	RD-AZ302J-	R CARBON FILM	1/6 3K OHM J	
R903	RD-AZ302J-	R CARBON FILM	1/6 3K OHM J	
R904	RD-AZ202J-	R CARBON FILM	1/6 2K OHM J	
R905	RD-AZ202J-	R CARBON FILM	1/6 2K OHM J	
R906	RD-AZ202J-	R CARBON FILM	1/6 2K OHM J	
R907	RD-4Z104J-	R CARBON FILM	1/4 100K OHM J	
R908	RD-4Z104J-	R CARBON FILM	1/4 100K OHM J	
R909	RD-4Z104J-	R CARBON FILM	1/4 100K OHM J	
R910	RD-2Z152J-	R CARBON FILM	1/2 1.5K OHM J	
R911	RD-2Z152J-	R CARBON FILM	1/2 1.5K OHM J	
R912	RD-2Z152J-	R CARBON FILM	1/2 1.5K OHM J	
R913	RD-AZ223J-	R CARBON FILM	1/6 22K OHM J	
R914	RD-AZ152J-	R CARBON FILM	1/6 1.5K OHM J	

13. THE DIFFERENT PARTS FOR SYSTEM

LOC.	PART	PAL B/G [HA] (WITHOUT SCART)	P/S-B/G, D/K [DA] (WITHOUT SCART)	P/S-B/G, D/K [DA] (WITH SCART)	PAL B/G [FA] (WITH SCART)	PAL I [PA] (WITH SCART)	P/S-B/G [LA] (WITH SCART)
PWC1	CORD POWER AS	KKP560+BL102NG+T	CW4232 H03VVH2-	CW4232 H03VVH2-	CW4232 H03VVH2-	CW3222/240V 5A+	CW4232 H03VVH2-
C107	C ELECTRO	50V RSS 10MF	50V RSS 10MF	50V RSS 10MF	50V RSS 10MF	50V RSS 10MF	25V RSS 47MF
C226	C ELECTRO	50V RSS 10MF	50V RSS 10MF	50V RSS 10MF	50V RSS 10MF	50V RSS 10MF	25V RSS 47MF
C229	C ELECTRO	X	X	X	X	X	25V RSS 47MF
C231	C ELECTRO	X	X	X	X	X	50V RSS 4.7MF
C232	C ELECTRO	X	X	X	X	X	50V RSS 4.7MF
C545	C MYLAR	X	100V 0.1MF	100V 0.1MF	X	X	100V 0.1MF
C555	C MYLAR	X	50V EU 0.22MF	50V EU 0.22MF	X	X	50V EU 0.22MF
C558	C ELECTRO	X	25V RSS 47MF	25V RSS 47MF	X	X	25V RSS 47MF
C819	C ELECTRO	400V LHS 180MF	400V LHS 150MF	400V LHS 150MF	400V LHS 180MF	400V LHS 180MF	400V LHS 180MF
CC101	C CHIP CERA	X	X	X	X	X	50V CH 22PF J
CC203	C CHIP CERA	X	X	X	X	X	50V CH 22PF J
CC204	C CHIP CERA	X	X	X	X	X	50V CH 22PF J
CC211	C CHIP CERA	X	X	X	X	X	50V CH 82PF J
CC217	C CHIP CERA	X	X	X	X	X	50V X7R 1000PF
CC218	C CHIP CERA	X	X	X	X	X	50V X7R 1000PF
CC219	C CHIP CERA	50V CH 8PF D	50V CH 8PF D	50V CH 8PF D	50V CH 8PF D	50V CH 8PF D	X
CC222	C CHIP CERA	X	X	X	X	X	50V Y5V 0.1MF Z
CC504	C CHIP CERA	X	50V Y5V 0.1MF Z	50V Y5V 0.1MF Z	X	X	50V Y5V 0.1MF Z
CC530	C CHIP CERA	X	50V CH 150PF J	50V CH 150PF J	X	X	X
CC710	C CHIP CERA	X	X	X	X	X	50V CH 16PF J
CC718	C CHIP TANTAL	X	X	X	X	X	35V 0.47MF M 32
CCL01	C CHIP CERA	X	X	X	X	X	50V CH 22PF J
CCL02	C CHIP CERA	X	X	X	X	X	50V CH 15PF J
CCL03	C CHIP CERA	X	X	X	X	X	50V Y5V 0.01MF

LOC.	PART	PAL B/G [HA] (WITHOUT SCART)	P/S-B/G, D/K [DA] (WITHOUT SCART)	P/S-B/G, D/K [DA] (WITH SCART)	PAL B/G [FA] (WITH SCART)	PAL I [PA] (WITH SCART)	P/S-B/G [LA] (WITH SCART)
CCL04	C CHIP CERA	X	X	X	X	X	50V Y5V 0.01MF
CCL05	C CHIP CERA	X	X	X	X	X	50V Y5V 0.1MF
CCL06	C CHIP CERA	X	X	X	X	X	50V Y5V 0.1MF
CCL08	C CHIP CERA	X	X	X	X	X	50V Y5V 0.01MF
CCL10	C CHIP TANTAL	X	X	X	X	X	50V CH 100PF J
CCL12	C CHIP CERA	X	X	X	X	X	50V X7R 0.033MF
CCL14	C CHIP CERA	X	X	X	X	X	50V X7R 0.047MF
CCL15	C CHIP CERA	X	X	X	X	X	50V Y5V 0.01MF
CCL16	C CHIP CERA	X	X	X	X	X	50V CH 82PF J
CCL17	C CHIP CERA	X	X	X	X	X	50V Y5V 0.01MF
CCL18	C CHIP CERA	X	X	X	X	X	50V X7R 0.047MF
CCL19	C CHIP CERA	X	X	X	X	X	50V Y5V 0.01MF
CCL20	C CHIP TANTAL	X	X	X	X	X	25V 4.7MF M 352
CCL21	C CHIP TANTAL	X	X	X	X	X	16V 2.2MF M 321
CCL26	C CHIP TANTAL	X	X	X	X	X	25V 1MF M 3216
CCL27	C CHIP TANTAL	X	X	X	X	X	25V 1MF M 3216
CCL29	C CHIP TANTAL	16V 10MF M 3528	16V 10MF M 3528	16V 10MF M 3528	16V 10MF M 3528	16V 10MF M 3528	X
CCL30	C CHIP TANTAL	X	X	X	X	X	25V 4.7MF M 352
CCL31	C CHIP CERA	X	X	X	X	X	50V CH 100PF J
CCL34	C CHIP CERA	X	X	X	X	X	50V Y5V 0.01MF
CCL35	C CHIP CERA	X	X	X	X	X	50V Y5V 0.01MF
CCL36	C CHIP TANTAL	X	X	X	X	X	16V 10MF M 3528
CL07	C CERA	X	X	X	X	X	25V F 0.01MF Z
CL13	C CERA	X	X	X	X	X	25V F 0.01MF Z
CL22	C ELECTRO	X	X	X	X	X	16V RSM 47MF

LOC.	PART	PAL B/G [HA] (WITHOUT SCART)	P/S-B/G, D/K [DA] (WITHOUT SCART)	P/S-B/G, D/K [DA] (WITH SCART)	PAL B/G [FA] (WITH SCART)	PAL I [PA] (WITH SCART)	P/S-B/G [LA] (WITH SCART)
CL23	C ELECTRO	X	X	X	X	X	16V RSM 47MF
D101	DIODE	X	X	X	X	X	1S2186
D102	DIODE	X	X	X	X	X	1S2186
D108	DIODE	X	X	X	X	X	BB909A
D109	DIODE ZENER	X	X	X	X	X	UZ-5.1BM
D110	DIODE ZENER	X	X	X	X	X	UZ-5.1BM
DL01	DIODE	X	X	X	X	X	1S2186
DL02	DIODE	X	X	X	X	X	1S2186
I201	IC	TDA98002	TDA98002	TDA98002	TDA98002	TDA98002	TDA9802
I501	IC VIDEO PROC	TDA8374A/N3	TDA8374A/N3	TDA8374A/N3	TDA8374A/N3	TDA8374A/N3	TDA8374/N3
I503	IC	X	TDA8395	TDA8395	X	X	TDA8395
I504	IC	X	X	TC4053BP	TC4053BP	TC4053BP	TC4053BP
IL01	IC SIF	X	X	X	X	X	STV8225
IL02	IC SIF	X	X	X	X	X	STV8225
IY03	IC SECAM.L	X	X	X	X	X	TA1238N
J010	WIRE COPPER	X	X	AWG22 1/0.65 TI	AWG22 1/0.65 TI	AWG22 1/0.65 TI	AWG22 1/0.65 TI
J014	WIRE COPPER	X	X	AWG22 1/0.65 TI	AWG22 1/0.65 TI	AWG22 1/0.65 TI	AWG22 1/0.65 TI
J029	WIRE COPPER	X	X	X	X	X	AWG22 1/0.65 TI
J032	WIRE COPPER	X	X	X	X	X	AWG22 1/0.65 TI
J039	WIRE COPPER	X	X	X	X	X	AWG22 1/0.65 TI
J050	WIRE COPPER	X	X	X	X	X	AWG22 1/0.65 TI
J053	WIRE COPPER	X	X	AWG22 1/0.65 TI	AWG22 1/0.65 TI	AWG22 1/0.65 TI	AWG22 1/0.65 TI
J054	WIRE COPPER	X	X	AWG22 1/0.65 TI	AWG22 1/0.65 TI	AWG22 1/0.65 TI	AWG22 1/0.65 TI
J057	WIRE COPPER	X	X	AWG22 1/0.65 TI	AWG22 1/0.65 TI	AWG22 1/0.65 TI	AWG22 1/0.65 TI
J060	WIRE COPPER	X	X	AWG22 1/0.65 TI	AWG22 1/0.65 TI	AWG22 1/0.65 TI	AWG22 1/0.65 TI

LOC.	PART	PAL B/G [HA] (WITHOUT SCART)	P/S-B/G, D/K [DA] (WITHOUT SCART)	P/S-B/G, D/K [DA] (WITH SCART)	PAL B/G [FA] (WITH SCART)	PAL I [PA] (WITH SCART)	P/S-B/G [LA] (WITH SCART)
J063	WIRE COPPER	X	X	AWG22 1/0.65 TI	AWG22 1/0.65 TI	AWG22 1/0.65 TI	AWG22 1/0.65 TI
J065	WIRE COPPER	X	X	AWG22 1/0.65 TI	AWG22 1/0.65 TI	AWG22 1/0.65 TI	AWG22 1/0.65 TI
J085	WIRE COPPER	X	X	X	X	X	AWG22 1/0.65 TI
J103	WIRE COPPER	AWG22 1/0.65 TI	AWG22 1/0.65 TI	AWG22 1/0.65 TI	AWG22 1/0.65 TI	AWG22 1/0.65 TI	X
J113	WIRE COPPER	X	X	X	X	X	AWG22 1/0.65 TI
J114	WIRE COPPER	X	X	X	X	X	AWG22 1/0.65 TI
J115	WIRE COPPER	X	X	X	X	X	AWG22 1/0.65 TI
J132	WIRE COPPER	X	X	AWG22 1/0.65 TI	AWG22 1/0.65 TI	AWG22 1/0.65 TI	AWG22 1/0.65 TI
J179	WIRE COPPER	X	X	X	X	X	AWG22 1/0.65 TI
J188	WIRE COPPER	X	X	X	X	X	AWG22 1/0.65 TI
J219	WIRE COPPER	X	X	X	X	X	AWG22 1/0.65 TI
J238	WIRE COPPER	X	X	X	X	X	AWG22 1/0.65 TI
J254	WIRE COPPER	X	X	AWG22 1/0.65 TI	AWG22 1/0.65 TI	AWG22 1/0.65 TI	AWG22 1/0.65 TI
J269	WIRE COPPER	X	X	X	X	X	AWG22 1/0.65 TI
J274	WIRE COPPER	X	X	X	X	X	AWG22 1/0.65 TI
J280	WIRE COPPER	X	X	AWG22 1/0.65 TI	AWG22 1/0.65 TI	AWG22 1/0.65 TI	AWG22 1/0.65 TI
J289	WIRE COPPER	X	X	X	X	X	AWG22 1/0.65 TI
J295	WIRE COPPER	X	X	X	X	X	AWG22 1/0.65 TI
JS01	SOCKET RGB	X	X	SR-21A1 (ANGLE	SR-21A1 (ANGLE	SR-21A1 (ANGLE	SR-21A1 (ANGLE
LL03	COIL PEAKING	X	X	X	X	X	100UH K (04TYPE)
LY02	COIL PEAKING	X	X	X	X	X	100UH K (04TYPE)
QC201	TR CHIP	X	X	X	X	X	KTC3881
QC202	TR CHIP	X	X	X	X	X	2SC1623-L6/T2B
QC203	TR CHIP	X	X	X	X	X	2SC1623-L6/T2B
QC204	TR CHIP	X	X	X	X	X	2SC1623-L6/T2B

LOC.	PART	PAL B/G [HA] (WITHOUT SCART)	P/S-B/G, D/K [DA] (WITHOUT SCART)	P/S-B/G, D/K [DA] (WITH SCART)	PAL B/G [FA] (WITH SCART)	PAL I [PA] (WITH SCART)	P/S-B/G [LA] (WITH SCART)
QC511	TR CHIP	X	X	2SA812-T2B	2SA812-T2B	2SA812-T2B	2SA812-T2B
QC702	TR CHIP	X	X	X	X	X	2SC1623-L6/T2B
QC703	TR CHIP	X	X	2SC1623-L6/T2B	2SC1623-L6/T2B	2SC1623-L6/T2B	2SC1623-L6/T2B
QC704	TR CHIP	X	X	X	X	X	2SC1623-L6/T2B
QCL01	TR CHIP	X	X	X	X	X	KTC3881
QCL02	TR CHIP	X	X	X	X	X	2SC1623-L6/T2B
QCL03	TR CHIP	X	X	X	X	X	2SC1623-L6/T2B
QCL05	TR CHIP	X	X	X	X	X	2SC1623-L6/T2B
QCL07	TR CHIP	X	X	X	X	X	2SC1623-L6/T2B
R121	R M-OXIDE FIL	2W 30 OHM J	2W 30 OHM J	2W 30 OHM J	2W 30 OHM J	2W 30 OHM J	2W 20 OHM J
R203	R CARBON FILM	X	X	X	X	X	1/6 100K OHM J
R218	R CARBON FILM	X	X	X	X	X	1/6 22K OHM J
R227	R CARBON FILM						1/6 47 OHM J
R240	R SEMI FIXED						RH0638C 10K OHM
R505	R CARBON FILM	X	1/4 10 OHM J	1/4 10 OHM J	X	X	1/4 10 OHM J
R525	R CARBON FILM			1/6 1K OHM J	1/6 1K OHM J	1/6 1K OHM J	1/6 1K OHM J
R540	R CARBON FILM	X	X	1/6 10K OHM J	1/6 10K OHM J	1/6 10K OHM J	1/6 10K OHM J
R563	R CARBON FILM	X	X	1/6 47K OHM J	1/6 47K OHM J	1/6 47K OHM J	1/6 47K OHM J
R738	R M-OXIDE FIL	2W 33 OHM J	2W 33 OHM J	2W 33 OHM J	2W 33 OHM J	2W 33 OHM J	2W 27 OHM J
RC209	R CHIP	X	X	X	X	X	1/10 100K OHM J
RC210	R CHIP	X	X	X	X	X	1/10 15K OHM J
RC211	R CHIP	X	X	X	X	X	1/10 2.2K OHM J
RC213	R CHIP	X	X	X	X	X	1/10 10K OHM J
RC214	R CHIP	X	X	X	X	X	1/10 10K OHM J
RC215	R CHIP	X	X	X	X	X	1/10 10K OHM J

LOC.	PART	PAL B/G [HA] (WITHOUT SCART)	P/S-B/G, D/K [DA] (WITHOUT SCART)	P/S-B/G, D/K [DA] (WITH SCART)	PAL B/G [FA] (WITH SCART)	PAL I [PA] (WITH SCART)	P/S-B/G [LA] (WITH SCART)
RC216	R CHIP	X	X	X	X	X	1/10 68K OHM J
RC217	R CHIP	X	X	X	X	X	1/10 100 OHM J
RC225	R CHIP	X	X	X	X	X	1/10 10K OHM J
RC226	R CHIP	X	X	X	X	X	1/10 7.5K OHM J
RC228	R CHIP	X	X	X	X	X	1/10 22K OHM J
RC229	R CHIP	X	X	X	X	X	1/10 330 OHM J
RC234	R CHIP	X	X	X	X	X	1/10 47 OHM J
RC237	R CHIP	X	X	X	X	X	1/10 750 OHM J
RC501	R CHIP	X	X	X	X	X	1/10 33K OHM J
RC536	R CHIP	X	X	1/10 10K OHM J	1/10 10K OHM J	1/10 10K OHM J	1/10 10K OHM J
RC538	R CHIP	X	X	1/10 10K OHM J	1/10 10K OHM J	1/10 10K OHM J	1/10 10K OHM J
RC541	R CHIP	X	X	X	X	X	1/10 10K OHM J
RC542	R CHIP	X	X	X	X	X	1/10 10K OHM J
RC564	R CHIP	X	1/10 560 OHM J	1/10 560 OHM J	X	X	X
RC702	R CHIP	X	X	X	X	X	1/10 10K OHM J
RC704	R CHIP	X	X	1/10 10K OHM J	1/10 10K OHM J	1/10 10K OHM J	1/10 10K OHM J
RC726	R CHIP	X	X	X	X	X	1/10 24K OHM J
RC727	R CHIP	X	X	X	X	X	1/10 4.7K OHM J
RC731	R CHIP	X	X	X	X	X	1/10 10K OHM J
RC739	R CHIP	X	X	X	X	X	1/10 4.7K OHM J
RC774	R CHIP	X	X	X	X	X	1/10 24K OHM J
RCJ05	R CHIP	1/10 0 OHM 2012	1/10 0 OHM 2012	1/10 0 OHM 2012	1/10 0 OHM 2012	1/10 0 OHM 2012	X
RCJ06	R CHIP	X	1/10 0 OHM 2012	1/10 0 OHM 2012	1/10 0 OHM 2012	1/10 0 OHM 2012	X
RCJ19	R CHIP	X	X	X	X	X	1/10 0 OHM 2012
RCJ26	R CHIP	1/10 0 OHM 2012	1/10 0 OHM 2012	1/10 0 OHM 2012	1/10 0 OHM 2012	1/10 0 OHM 2012	X

LOC.	PART	PAL B/G [HA] (WITHOUT SCART)	P/S-B/G, D/K [DA] (WITHOUT SCART)	P/S-B/G, D/K [DA] (WITH SCART)	PAL B/G [FA] (WITH SCART)	PAL I [PA] (WITH SCART)	P/S-B/G [LA] (WITH SCART)
RCJ31	R CHIP	1/10 0 OHM 2012	1/10 0 OHM 2012	1/10 0 OHM 2012	1/10 0 OHM 2012	1/10 0 OHM 2012	X
RCJ33	R CHIP	X	X	X	X	X	1/10 0 OHM 2012
RCJ37	R CHIP	X	X	1/10 0 OHM 2012	1/10 0 OHM 2012	1/10 0 OHM 2012	1/10 0 OHM 2012
RCL02	R CHIP	X	X	X	X	X	1/10 68K OHM J
RCL03	R CHIP	X	X	X	X	X	1/10 2.2K OHM J
RCL07	R CHIP	X	X	X	X	X	1/10 33K OHM J
RCL12	R CHIP	X	X	X	X	X	1/10 10K OHM J
RCL13	R CHIP	X	X	X	X	X	1/10 10K OHM J
RCL14	R CHIP	X	X	X	X	X	1/10 10K OHM J
RCL15	R CHIP	X	X	X	X	X	1/10 10K OHM J
RCL16	R CHIP	X	X	X	X	X	1/10 100 OHM J
RCL17	R CHIP	X	X	X	X	X	1/10 750 OHM J
RCL18	R CHIP	X	X	X	X	X	1/10 15K OHM J
RCL30	R CHIP	X	X	X	X	X	1/10 1K OHM J
RCL31	R CHIP	X	X	X	X	X	1/10 33K OHM J
RCL32	R CHIP	X	X	X	X	X	1/10 12K OHM J
RCL33	R CHIP	X	X	X	X	X	1/10 2K OHM J
RCL34	R CHIP	X	X	X	X	X	1/10 560 OHM J
RCL36	R CHIP	X	X	X	X	X	1/10 1K OHM J
RL01	R CARBON FILM	X	X	X	X	X	1/6 22K OHM J
RL10	R CARBON FILM	X	X	X	X	X	1/6 1K OHM J
RL11	R CARBON FILM	X	X	X	X	X	1/6 1K OHM J
RN04	R CARBON FILM	X	X	X	X	X	1/6 220 OHM J
RN05	R CARBON FILM	X	X	X	X	X	1/6 220 OHM J
RN08	R CARBON FILM	1/6 6.8K OHM J	1/6 6.8K OHM J	1/6 6.8K OHM J	1/6 6.8K OHM J	1/6 4.3K OHM J	1/6 4.3K OHM J