

# Service Manual

## Color Television

**CHASSIS : CN-793N**

**Model : DTQ-27U8SC**

**DTQ-29U8SS**

**DTQ-29U8SSP**



### SPECIFICATIONS

| ITEMS                     | MODEL | DTQ-27U8SC  | DTQ-29U8SS      | DTQ-29U8SSP     |
|---------------------------|-------|---|-----------------|-----------------|
| TV Standard               |       | NTSC-M  |                 |                 |
| Power Input               |       | AC 120V 60Hz  | AC 120V 50/60Hz | AC 220V 50/60Hz |
| Power Consumption         |       | 125W  |                 |                 |
| Tuning ranges             |       | Frequency Synthesizer(FS)Tuning System<br>TV VHF(L):CH2-CH6<br>UHF(H):CH7-CH13<br>UHF :CH14-CH69<br>CATV VHF(L) :5A, A, B, A-5-A-1<br>CH2 - CH6<br>VHF(H) :C-W+11<br>CH7 - CH13<br>UHF :W+12-W+84   |                 |                 |
| Sound Output              |       | 5W+5W   | 7W+7W           | 7W+7W           |
| Speaker                   |       | 8ohm 12W  | 8ohm 12W×2EA    | 8ohm 12W×2EA    |
| Antenna Input Impedance   |       | 75ohm Unbalanced  |                 |                 |
| Auxiliary Input Terminal  |       | Front: Video, Audio(L,R)<br>Rear: Video, Audio(L,R)<br>Component Video, Audio(L,R)  |                 |                 |
| Auxiliary Output Terminal |       | REAR: Video, Audio(L,R)   |                 |                 |
| Intermediate Frequencies  |       | Picture IF Carrier Frequency : 45.75MHz<br>Sound IF Carrier Frequency : 41.25MHz<br>Color Sub-Carrier Frequency : 42.17MHz  |                 |                 |
| Remote Control            |       | R-43A07   |                 |                 |
| Special Function          |       | 1) Icon Type                      7) Surround<br>2) 3-Language OSD            8) AVC<br>3) With CAPTION              9) CVI(Component Video Input)<br>4) CH Label                    10) Wake-Up/Off Timer<br>5) V-Chip                        11) Sleep Timer<br>6) Dynamic Sound            12) Power Restore |                 |                 |

**DAEWOO ELECTRONICS CO., LTD**

<http://svc.dwe.co.kr>

**Apr. 2002**

## ✓ Caution

: In this Manual, some parts can be changed for improving, their performance without notice in the parts list. So, if you need the latest parts information, please refer to PPL(Parts Price List) in Service Information Center (<http://svc.dwe.co.kr>).

## TABLE OF CONTENTS

|                                     |           |
|-------------------------------------|-----------|
| <b>TABLE OF CONTENTS</b> .....      | <b>2</b>  |
| <b>CIRCUIT BLOCK DIAGRAM</b> .....  | <b>3</b>  |
| <b>ALIGNMENT INSTRUCTIONS</b> ..... | <b>4</b>  |
| YOUR REMOTE CONTROL .....           | 4         |
| SERVICE MODE ADJUSTMENT .....       | 5         |
| ASSEMBLY ADJUSTMENT .....           | 7         |
| <b>SCHEMATIC DIAGRAM</b> .....      | <b>10</b> |
| <b>ELECTRICAL PARTS LIST</b> .....  | <b>11</b> |
| 1. DIFFERENT PARTS LIST .....       | 22        |
| <b>EXPLODED VIEW</b> .....          | <b>25</b> |
| <b>PRINTED CIRCUIT BOARD</b> .....  | <b>27</b> |

## ***APPENDIX (Appendix is provide only by internet[<http://svc.dwe.co.kr>])***

|                                       |          |
|---------------------------------------|----------|
| <b>IC DESCRIPTION</b> .....           | <b>1</b> |
| <b>CHIP COMPONENTS POSITION</b> ..... | <b>3</b> |
| <b>TROUBLE SHOOTING GUIDE</b> .....   | <b>5</b> |
| NO POWER .....                        | 5        |
| NO PICTURE .....                      | 6        |
| NO SOUND .....                        | 7        |
| CH DON'T STOP .....                   | 8        |
| NO COLOR .....                        | 9        |
| NO VERTICAL DEFLECTION .....          | 9        |
| NO ON-SCREEN DISPLAY .....            | 10       |
| NO REMOCON RECEIPT .....              | 10       |

# SPECIFICATIONS

| ITEMS \ MODEL             | DTQ-27U8SC  | DTQ-29U8SS      | DTQ-29U8SSP     |
|---------------------------|---|-----------------|-----------------|
| TV Standard               | NTSC-M  |                 |                 |
| Power Input               | AC 120V 60Hz  | AC 120V 50/60Hz | AC 220V 50/60Hz |
| Power Consumption         | 125W  |                 |                 |
| Tuning ranges             | Frequency Synthesizer(FS)Tuning System<br>TV VHF(L):CH2-CH6<br>UHF(H):CH7-CH13<br>UHF :CH14-CH69<br>CATV VHF(L) :5A, A, B, A-5-A-1<br>CH2 - CH6<br>VHF(H) :C-W+11<br>CH7 - CH13<br>UHF :W+12-W+84                               |                 |                 |
| Sound Output              | 5W+5W   | 7W+7W           | 7W+7W           |
| Speaker                   | 8ohm 12W  | 8ohm 12W×2EA    | 8ohm 12W×2EA    |
| Antennena Input Impedance | 75ohm Unbalanced  |                 |                 |
| Auxiliary Input Terminal  | Front: Video, Audio(L,R)<br>Rear: Video, Audio(L,R)<br>Component Video, Audio(L,R)  |                 |                 |
| Auxiliary Output Terminal | REAR: Video, Audio(L,R)   |                 |                 |
| Intermediate Frequencies  | Picture IF Carrier Frequency : 45.75MHz<br>Sound IF Carrier Frequency : 41.25MHz<br>Color Sub-Carrier Frequency : 42.17MHz  |                 |                 |
| Remote Control            | R-43A07   |                 |                 |
| Special Function          | 1) Icon Type<br>2) 3-Language OSD<br>3) With CAPTION<br>4) CH Label<br>5) V-Chip<br>6) Dynamic Sound<br>7) Surround<br>8) AVC<br>9) CVI(Component Video Input)<br>10) Wake-Up/Off Timer<br>11) Sleep Timer<br>12) Power Restore |                 |                 |

# CIRCUIT BLOCK DIAGRAM

CN-793N BLOCK DIAGRAM

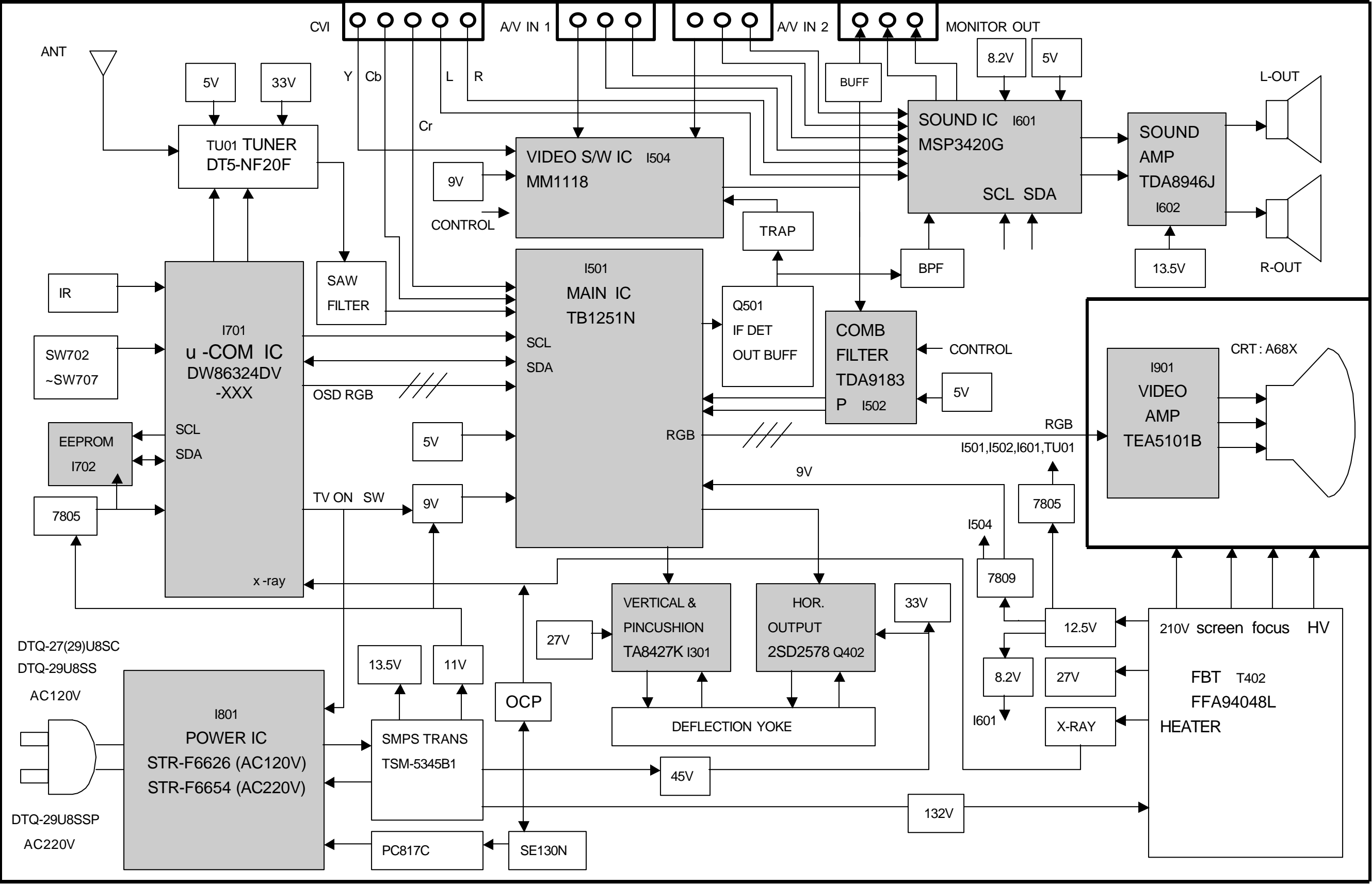

# ALIGNMENT INSTRUCTIONS

Your Remote Control(R-43A05)

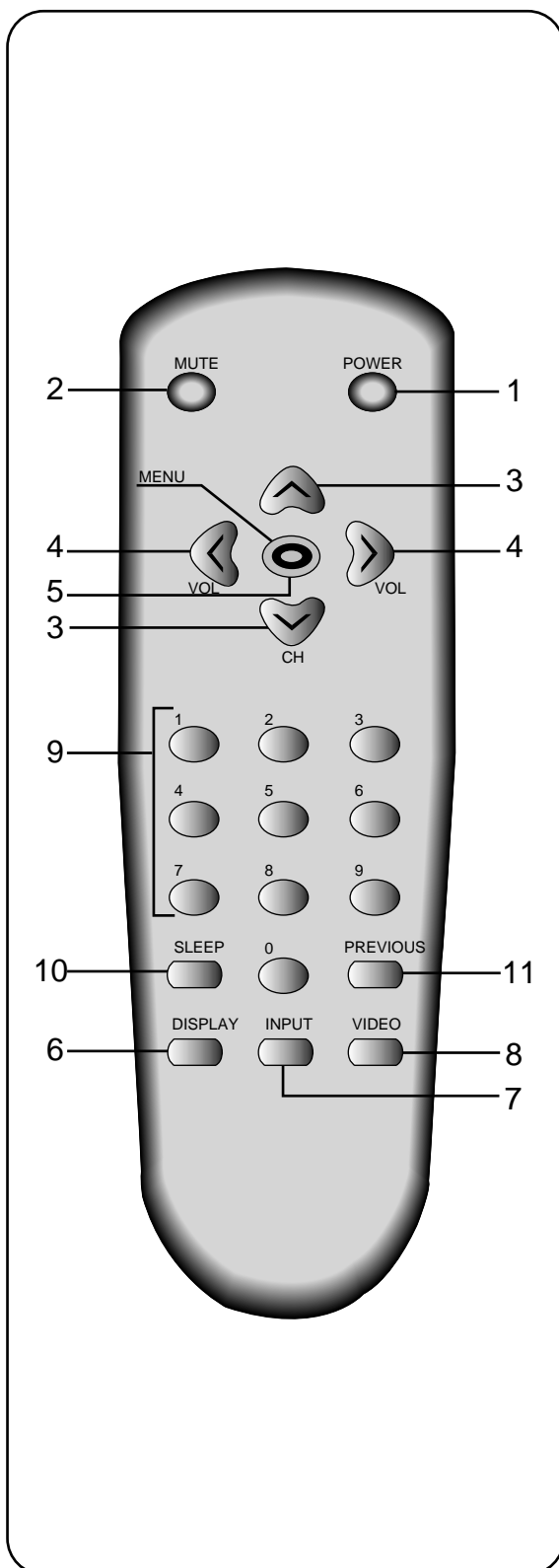

1. **POWER**  
Use this button to turn your TV on or off.
2. **MUTE**  
Use to turn the TV's sound on and off.
3. **▼CH▲**  
Use these buttons to change your TV's volume, to activate selections in the menu system.
4. **◀VOL▶**  
Use these buttons to change your TV's volume, to activate selections in the menu system, or to change audio and video settings.
5. **MENU**  
Use this button to turn the TV's menu system on and off.
6. **DISPLAY**  
Use this button to display the channel number and status.
7. **INPUT**  
Use this button to select the TV's signal source.
8. **VIDEO**  
Use this button to display video adjustment.
9. **0-9**  
Use these buttons to change channels.
10. **SLEEP**  
Use this button to program the TV to turn off after a certain time.
11. **PREVIOUS**  
Use this button to return to the previous channel you were watching.

## 1. SERVICE MODE ADJUSTMENTS

Follow the steps below whenever service adjustment is required. See Table- A and Table- B to determine if service adjustments are required.

### 1) How to enter the service mode using the user remote control.

- Turn the set on.
- Direct the remote control to the reception window of TV.
- Push buttons of remote control in sequence as follows.

**1 → MUTE → DISPLAY → MUTE**

- Then, the screen will appear as follows.

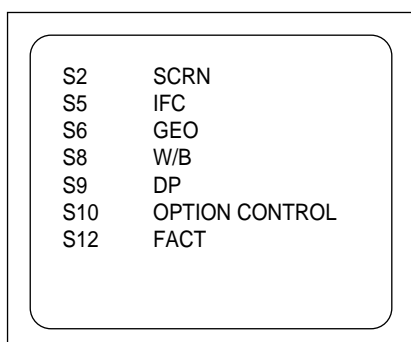

- Using the channel up or channel down button, select the item you wish to adjust.  
(The color of selected item turns into the red.)
- Press the volume up or down button to enter in the service mode you wish to adjust.

### 2) How to memorize the adjusted values in the service mode.

- Must press **DISPLAY** button the state which the screen is displaying each of service menus after all adjustments are completed each of all service menu.

**Table-A : Adjust the values of service mode when a part is replaced.**

| PART<br>REPLACED | ADJUSTMENT |             | NOTES   |
|------------------|------------|-------------|---|
|                  | NECESSARY  | UNNECESSARY |   |
| I701<br>(U-COM)  |            | <b>O</b>    | Data is stored in I703.   |
| I101<br>(MAIN)   |            | <b>O</b>    |   |
| I702<br>(EEPROM) | <b>O</b>   |             | Initial setting values are written from I701.<br>ADJUSTING ITEMS<br><br>S5 : RFAGCD<br>S6 : H.CENTER/V.CENTER/V.SIZE<br>S8 : GD/BD/RB/GB/BB<br>S9 : DP-brightness |
| CRT              | <b>O</b>   |             | Adjust items related to picture tube only.(White Balance adjustment)  |

## ALIGNMENT INSTRUCTIONS

Table-B

| MODE | ADJUSTMENT ITEMS  | DATA    |          | REMARKS   |
|------|-------------------|---------|----------|---|
|      |                   | INITIAL | RANGE    |   |
| S2   | Screen Adjustment | -       | -        |   |
| S5   | AT RAGC           |         |          |   |
|      | RF AGC D *        | 27      | 0 ~63    | Align RF AGC threshold                          |
|      | AGC POINT         | 3.75    | 3.25~4.0 | Select AGC reference voltage                    |
|      | AFT SEN           | 100K    | 25K/100K |   |
|      | OVR MSW           | 0       | 0/1      | Must be set to 0                                |
|      | Q/DT GN           | 0       | 0/1      | Must be set to 0                                |
|      | VCO CTR           | 0       | 0/1      | Must be set to 0                                |
|      | VCO REQ           | 0       | 0/1      | Must be set to 0                                |
|      | VCO STP           | 0       | 0/1      | Must be set to 0                                |
|      | CARRIER           | 0       | 0/1      | Must be set to 0                                |
|      | BUZ RED           | 0       | 0/1      | Must be set to 0                                |
|      | FM/AM CAL         | 16      | 0~255    | Must be set to 16                               |
|      | SCART SCAL        | 15      | 0~255    | Must be set to 15                               |
|      | MOTR VOL          | 127     | 0~255    | Must be set to 127                              |
| S6   | H-CENTER *        | 14      | 0~31     | Align sync to flyback pulse,using cross pattern |
|      | H-SIZE *          | 54      | 0~63     | Align sync to flyback pulse,using cross pattern |
|      | P-CUSHION *       | 18      | 0~63     | Align pincution,using cross pattern             |
|      | V-CENTER *        | 4       | 0~7      | Align vertical DC bias,using cross pattern      |
|      | V-SIZE *          | 41      | 0~63     | Align vertical amplitude,using cross pattern    |
|      | V-LIN *           | 9       | 0~15     | Align vertical linearity,using cross pattern    |
|      | EW-TRAPEZ *       | 14      | 0~31     | Align EW-TRAPEZ,using cross pattern             |
|      | V-S               | 8       | 0~15     | Must be set to 8                                |
|      | V-RAMP            | 1       | 0/1      | Must be set to 1                                |
|      | V-EHT             | 7       | 0~7      | Must be set to 7                                |
|      | EW-CORNER         | 8       | 0~15     | Must be set to 8                                |
|      | H-EHT             | 7       | 0~7      | Must be set to 7                                |
| S8   | G-DRIVE *         | 61      | 0~127    | Align green out AC level                        |
|      | B-DRIVE *         | 74      | 0~127    | Align blue out AC level                         |
|      | R-BIAS            | 127     | 0~255    | Must be set to 127                              |
|      | G-BIAS *          | 160     | 0~255    | Align green out DC level                        |
|      | B-BIAS *          | 138     | 0~255    | Align blue out DC level                         |
| S9   | DP-BRIGHT *       | 57      | 0~77     | Align common RGB DC level                       |
|      | DP-CONTRAST       | 15      | 0~27     |   |
|      | DP-SHARPNESS      | 38      | 0~38     |   |
|      | DP-COLOR          | 15      | 0~27     |   |
|      | DP-TINT           | 40      | 0~77     |   |
|      | CbCr COR          | 15      | 0~31     |   |
|      | CbCr TINT         | 3       | 0~31     |   |
|      | SUB CONT          | 5       | 0~15     |   |
| S10  | DIGITAL SENSOR    | NO      | -        |   |
|      | QUASI CHECK       | NO      | NO/YES   |   |
|      | NO SD POWER OFF   | YES     | NO/YES   |   |
| S12  | Forwarding Mode   | -       |          | Factory initialization                          |

\*Indicates the items with different settings each of sets.

\* indicates the items with different settings each of sets

## 2. ASSEMBLY ADJUSTMENTS

### 1) SCREEN ADJUSTMENT (S2)

- Enter the service mode and select service adjustment S2.
- You can see the one horizontal line on the screen.
- Adjust the Screen Control Volume (located on FBT) so that the horizontal line onscreen may be disappeared.
- Press the volume up or down button to exit in the screen adjustment mode.

## CAUTION

IN THE SCREEN ADJUSTMENT MODE, DONT PRESS OTHER BUTTONS EXCEPT VOLUME UP OR DOWN BUTTON.

### 2) FOCUS ADJUSTMENT

- Turn in a local station and adjust the Focus Control knob (located on FBT) for best picture details at high light condition.

### 3) RF AGC DELAY ADJUSTMENT (S5)

- Receive a good local channel.
- Enter the service mode and select service adjustment S5.
- You can see the OSD as shown in below.

|      |      |      |         |      |     |
|------|------|------|---------|------|-----|
| AT   | RAGC | STR  | VCO     | REQ  | 0   |
| RF   | AGCD | 27   | VCO     | STP  | 0   |
| AGC  | PNT  | 3.75 | CARRIER |      | 0   |
| AFT  | SEN  | 100K | BUZ     | RED  | 0   |
| OVR  | MSW  | 0    | FM/AM   | CAL  | 16  |
| Q/DT | GN   | 0    | SCART   | SCAL | 15  |
| VCO  | CTR  | 0    | MOTR    | VOL  | 127 |

▲MOVE   ◀▶ADJUST   RECALL : SET

- Select RFAGCD item, press the volume up or down button until noise or beat in picture disappears.
- Press the DISPLAY button to memorize the data.

### 4) GEOMETRIC ADJUSTMENTS (S6)

- Using the volume up or down button, select internal cross pattern.
- Select service adjustment S6
- You can see the OSD as shown in below.

|           |    |           |   |
|-----------|----|-----------|---|
| H-CENTER  | 14 | V-S       | 8 |
| H-SIZE    | 54 | V-RAMP    | 1 |
| P-CUSHION | 18 | V-EHT     | 7 |
| V-CENTER  | 4  | EW-CORNER | 8 |
| V-SIZE    | 41 | H-EHT     | 7 |
| V-LIN     | 9  |           |   |
| EW-TRAPEZ | 14 |           |   |

▲MOVE   ◀▶ADJUST   RECALL : SET



## ALIGNMENT INSTRUCTIONS

### 4-1. Horizontal Position Adjustment

- Select H-CENTER item, adjust H-CENTER data value to obtain proper horizontal centering of the internal cross pattern at the left and right of the screen.

### 4-2. Vertical Position Adjustment

- Select V-CENTER item, adjust V-CENTER data value to center the raster properly on the screen.

### 4-3. Vertical Size Adjustment

- Select "V.SIZE" item, adjust "V.SIZE" data value to proper vertical size as follows.

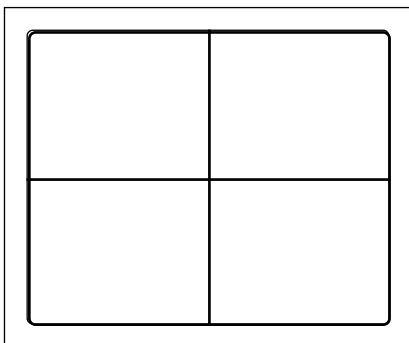

## 5) WHITE BALANCE ADJUSTMENT(S8)

- Receive a good local channel.
- Enter the service mode and select service adjustment S8.
- You can see the OSD as shown in below.

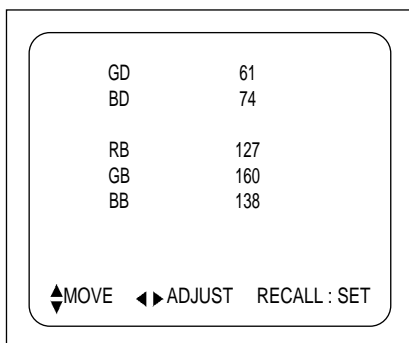

- Using volume up or volume down, adjust service adjustment data of RD/GD/BD and RB/GB/BB until a good gray scale with normal whites is obtained.
- Press the DISPLAY button to memorize the data.

**6) DIGITAL PRESET(D.P) ADJUSTMENTS(S9)****SUBBRIGHTNESS ADJUSTMENT**

- Receive a good local channel.
- Enter the service mode and select service adjustment S9.
- You can see the OSD as shown in below.

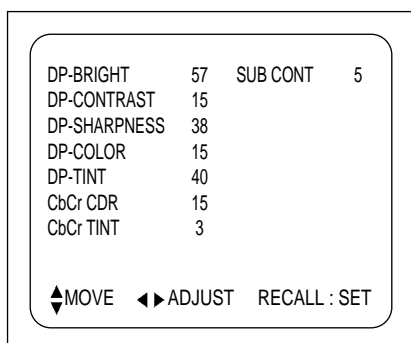

- Select Subbrightness item, adjust Subbrightness data value to obtain normal brightness level.
- Press the DISPLAY button to memorize the data.

**CONTRAST**

- Fixed value = 15

**TINT**

- Fixed value = 40

**COLOR**

- Fixed value = 15

**7) FACTORY OUTGOING MODE (S12 : FACT)**

- If you select the S12, then the set becomes factory outgoing status.
- You can see the OSD "outgoing OK"

# SCHEMATIC DIAGRAM

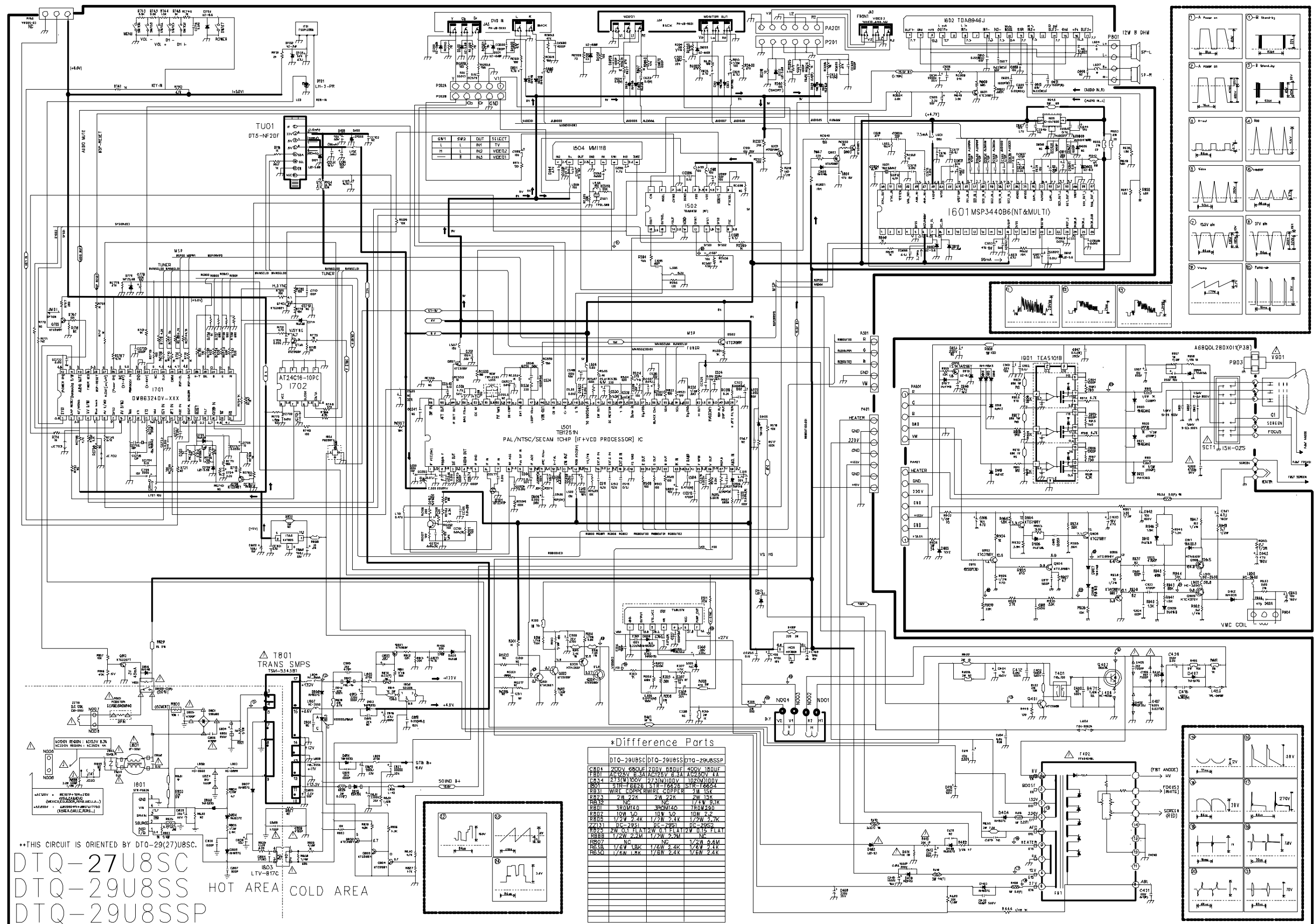

# ELECTRICAL PARTS LIST

✍ **CAUTION** : In this Service Manual, some parts can be changed for improving their performance without notice in the parts list. So, if you need the latest parts information, please refer to PPL(Parts Price List)in Service information Center(<http://svc.dwe.co.kr>)

| LOC   | PART CODE  | PART NAME           | PART DESCRIPTION          | REMARK | LOC   | PART CODE  | PART NAME          | PART DESCRIPTION          | REMARK |
|-------|------------|---------------------|---------------------------|--------|-------|------------|--------------------|---------------------------|--------|
| ZZ100 | 48B4343A07 | TRANSMITTER REMOCON | R-43A07 (AA)              | ®      | SP01  | 4858315210 | SPEAKER            | SP-78128F02               |        |
| ZZ110 | PTACPWJ936 | ACCESSORY AS        | DTQ-29U8FC                |        | SP01A | 7172401212 | SCREW TAPPTITE     | TT2 TRS 4X12 MFZNBK       |        |
| 0030  | 4850Q00810 | BATTERY             | R6P/LN                    |        | SP02  | 4858315210 | SPEAKER            | SP-78128F02               |        |
| 0040  | 48586793E1 | MANUAL INSTRUCTION  | ENGLISH                   |        | SP02A | 7172401212 | SCREW TAPPTITE     | TT2 TRS 4X12 MFZNBK       |        |
| M821  | 4858213800 | BAG INSTRUCTION     | L.D.P.E T0.05X250X400     |        | ZZ290 | PTMPMSJ936 | PCB MAIN MANUAL AS | DTQ-29U8FC                |        |
| ZZ120 | PTBCSHJ936 | COVER BACK AS       | DTQ-29U8FC                |        | 10    | 2193102005 | SOLDER BAR         | SN-PB=63:47 S63S-1320     |        |
| M211  | 4852160400 | COVER BACK          | FR HIPS GY 29U8           |        | 30    | 2291050616 | FLUX SOLDER        | JS-64T3                   |        |
| M591  | 4855936700 | DECO AV             | PVC T0.25                 |        | 40    | 2291050301 | FLUX SOLVENT       | IM-1000                   |        |
| M781  | 4857817630 | CLOTH BLACK         | FELT 400X20X0.7           |        | C308  | CEYF1E332V | C ELECTRO          | 25V RSS 3300MF (16X31.5)  |        |
| M782  | 4857817612 | CLOTH BLACK         | FELT 250X20X0.7           |        | C401  | CEYD1H689V | C ELECTRO          | 50V RUB 6.8MF (16*35.5)   |        |
| ZZ130 | PTPKCPJ904 | PACKING AS          | DTQ-29U8                  |        | C405  | CMYH3D722J | C MYLAR            | 2KV BUP 7200PF J          | △      |
| 10    | 6520010100 | STAPLE PIN          | AUTO W65                  |        | C406  | CMYH3D752J | C MYLAR            | 2KV BUP 7500PF J          | △      |
| M681  | 4856812400 | BAND PP AUTO        | T1.1XW17mmXL770M          |        | C407  | CMYE2J273J | C MYLAR            | 630V PU 0.027MF J         |        |
| M801  | 4858059700 | BOX CARTON          | DW-3 29U8                 |        | C416  | CMYE2G364J | C MYLAR            | 400V PU 0.36MF J          |        |
| M811  | 4858198100 | PAD                 | EPS 29U8                  |        | C802  | CL1UC3104M | C LINE ACROSS      | WORLD AC250V 0.1UF M R.47 | △      |
| M821  | 4858215600 | BAG P.E             | PE FOAM 10.5x1600x1270    |        | C803  | CL1UC3104M | C LINE ACROSS      | WORLD AC250V 0.1UF M R.47 | △      |
| ZZ131 | 58G0000143 | COIL DEGAUSSING     | DC-29S1                   | △      | C804  | CEYD2D681D | C ELECTRO          | 200V FHS 680MF (25X40)    |        |
| ZZ132 | 48519A4210 | CRT GROUND NET      | 2901H-1015-2P             |        | C809  | CH1BFE472M | C CERA AC          | AC400V 4700PF M U/C/V     | △      |
| ZZ140 | PTCACAJ948 | CABINET AS          | DTQ-29U8SC                |        | C813  | CEYN2D221T | C ELECTRO          | 200V FWS 220MF (22X30)    |        |
| M201A | 4856015821 | SCREW CRT FIX       | SWRM+SK5 L=35             |        | C821  | CEYF1E332V | C ELECTRO          | 25V RSS 3300MF (16X31.5)  |        |
| M201B | 4856215402 | WASHER RUBBER       | CR T2.0                   |        | C824  | C8YB3D152K | C CERA SEMI        | 2KV BL(N) 1500PF K        |        |
| M201E | 4856816300 | CLAMP WIRE          | NYLON 6 (V0)              |        | C831  | CEYF1E332V | C ELECTRO          | 25V RSS 3300MF (16X31.5)  |        |
| M211A | 7172401612 | SCREW TAPPTITE      | TT2 TRS 4X16 MFZN BK      |        | C888  | CH1BFE472M | C CERA AC          | AC400V 4700PF M U/C/V     | △      |
| M211B | 7172401612 | SCREW TAPPTITE      | TT2 TRS 4X16 MFZN BK      |        | D402  | DRGP30J—   | DIODE              | RGP30J                    | ®      |
| M211C | 7178301212 | SCREW TAPPTITE      | TT2 WAS 3X12 MFZN BK      |        | D431  | DDG3—      | DIODE              | DG3                       | ®      |
| M541  | 4855419800 | SPEC PLATE          | ART 150                   |        | D801  | PTC1SW8902 | HEAT SINK ASS'Y    | DPBS606GU- + 7174300811   | ®      |
| M686  | 4856812001 | TIE CABLE           | NYLON66 DA100             |        | D801  | DPBS606GU- | DIODE BRIDGE       | PBS606G                   | ®      |
| V901  | 4859635261 | CRT                 | A68QDL280X011(B) P45      | △      | D801A | 4857018902 | HEAT SINK          | A1050P-H24                | ®      |
| ZZ200 | PTFMSJJ936 | MASK FRONT AS       | DTQ-29U8FC                |        | D801B | 7174300811 | SCREW TAPPTITE     | TT2 RND 3X8 MFZN          | ®      |
| M191  | 4851944701 | DOOR AS             | 2823101+5544901 29U8      |        | D810  | PTS2SW6900 | HEAT SINK ASS'Y    | DFMLG16S— + 7128301011    | ®      |
| M201  | 4852078800 | MASK FRONT          | FR HIPS GY 29U8           |        | 00001 | DFMLG16S—  | DIODE              | FMLG-16S                  | ®      |
| M481  | 4854860900 | BUTTON POWER        | FR ABS GY 29U8            |        | 0000A | 4857026900 | HEAT SINK          | AL EX                     |        |
| M481A | 4856716000 | SPRING              | SWPA PIE0.5               |        | 0000B | 7174300811 | SCREW TAPPTITE     | TT2 RND 3X8 MFZN          |        |
| M491  | 4854950400 | BUTTON CH           | FR ABS GY 29U8            |        | D815  | DRGP30J—   | DIODE              | RGP30J                    | ®      |
| M491A | 7178301011 | SCREW TAPPTITE      | TT2 WAS 3X10 MFZN         |        | DF01  | DLH2PR—    | LED BLOCK          | LH-2P-R                   | ®      |
| M501  | 4855060301 | DECO CTRL           | PVC T0.25                 |        | F801  | 5F1GB6321L | FUSE GLASS TUBE    | UL/CSA TL 6.3A 125V MF51  | △      |
| M561  | 48556174SD | MARK BRAND          | SILVER DIA-CUTTING        |        | I301  | PTB2SW7904 | HEAT SINK ASS'Y    | 1TA8427K— + 7174300811    | ®      |
| M592  | 4855936301 | DECO EYE            | ABS BLUE                  |        | I301  | 1TA8427K—  | IC                 | TA8427K                   | ®      |
| M592A | 7178301011 | SCREW TAPPTITE      | TT2 WAS 3X10 MFZN         |        | I301A | 4857027904 | HEAT SINK          | AL EX (ANODIZE)           | ®      |
| M791  | 4857923300 | DOOR LOCK           | LA701(KIFCO)              |        | I301B | 7174300811 | SCREW TAPPTITE     | TT2 RND 3X8 MFZN          | ®      |
| ZZ202 | PTSPPWJ904 | SPEAKER AS          | DTQ-29U8                  |        | I409  | 1KA7809—   | IC REGULATOR       | KA7809                    | ®      |
| PA601 | 4850704S32 | CONNECTOR           | YH025-04+YRT205+ULW900500 |        | I501  | 1TB1251N—  | IC                 | TB1251CN                  | ®      |

“ △ ” is a safety part, so it must be used the same part.

“ ® ” is a recommendable part for essential stock.

# ELECTRICAL PARTS LIST

| LOC   | PART CODE  | PART NAME          | PART DESCRIPTION          | REMARK | LOC   | PART CODE  | PART NAME           | PART DESCRIPTION          | REMARK |
|-------|------------|--------------------|---------------------------|--------|-------|------------|---------------------|---------------------------|--------|
| I502  | 1TDA9183P- | IC COMBFILTER      | TDA9183P                  | (R)    | R802  | RX10T109KS | R CEMENT            | 10W 1 OHM K TRIPOD SMALL  |        |
| I504  | 1MM1118—   | IC A/V SWITCH      | MM1118                    | (R)    | R825  | RM02Y108K- | R METAL FLAT        | 2W 0.1 OHM K              | (R)    |
| I601  | 1MSP3420B8 | IC SOUND PROCESSOR | MSP3420G-P0-B8            | (R)    | SF101 | 5PTSF5241P | FILTER SAW          | TSF5241P                  |        |
| I602  | PTL2SW8210 | HEAT SINK ASS'Y    | 1TDA8946J- + 7174301011   | (R)    | SW707 | 5S50101035 | SW TACT             | KPT-1112 1C-1P            |        |
| 00001 | 1TDA8946J- | IC AUDIO AMP       | TDA8946J                  | (R)    | T401  | 5TD0000018 | TRANS DRIVE         | THD-120                   | (R)    |
| 0000A | 4857028210 | HEAT SINK          | AL EX                     | (R)    | T402  | 50H0000222 | FBT                 | BSC29-0197                | (A)    |
| 0000B | 7174301011 | SCREW TAPPTITE     | TT2 RND 3X10 MFZN         | (R)    | T402A | 7178301212 | SCREW TAPPTITE      | TT2 WAS 3X12 MFZN BK      | (A)    |
| I603  | PTJ2SW6902 | HEAT SINK ASS'Y    | 1KA7805— + 7178301212     | (R)    | T801  | 50M5345B1- | TRANS SMPS          | TSM-5345B1                | (A)    |
| 00001 | 1KA7805—   | IC REGULATOR       | KA7805                    | (R)    | TU01  | 4859719130 | TUNER VARACTOR      | DT5-NF20F                 | (R)    |
| 0000A | 4857026902 | HEAT SINK          | AL EX BK                  | (R)    | X601  | 5XE18R432E | CRYSTAL QUARTZ      | HC-49/U 18.43200MHZ 30PPM | (R)    |
| 0000B | 7178301212 | SCREW TAPPTITE     | TT2 WAS 3X12 MFZN BK      | (R)    | X702  | 5XYR03276C | CRYSTAL QUARTZ      | C-001R 32.768000KHZ 20PPM | (R)    |
| I701  | 1LC86F3248 | IC MICOM OTP       | LC86F3248A                | (R)    | Y801  | 5SC0101003 | SW RELAY            | DG12D1-0(M)-II 1C-1P      | (A)    |
| I702  | 1AT24C16PC | IC                 | AT24C16-10PC              | (R)    | Z501  | 5PYXT4R5MB | FILTER CERA         | XT 4.5MB                  | (R)    |
| I703  | 1KA7805—   | IC REGULATOR       | KA7805                    | (R)    | Z802  | DSVC471D14 | VARISTOR            | SVC471D14A                | (A)    |
| I801  | PTM2SW8210 | HEAT SINK ASS'Y    | 1STRF6626- + 7174301011   | (A)    | ZZ200 | PTMPJ2J936 | PCB CHIP MOUNT B AS | DTQ-29U8FC                |        |
| 00001 | 1STRF6626- | IC POWER           | STR-F6626                 | (A)    | CC101 | HCfk103ZCA | C CHIP CERA         | 50V Y5V 0.01MF Z 2012     |        |
| 0000A | 4857028210 | HEAT SINK          | AL EX                     | (A)    | CC103 | HCfk103ZCA | C CHIP CERA         | 50V Y5V 0.01MF Z 2012     |        |
| 0000B | 7174301011 | SCREW TAPPTITE     | TT2 RND 3X10 MFZN         | (R)    | CC104 | HCfk103ZCA | C CHIP CERA         | 50V Y5V 0.01MF Z 2012     |        |
| I802  | 1SE130N—   | IC                 | SE130N                    | (R)    | CC105 | HCfk103ZCA | C CHIP CERA         | 50V Y5V 0.01MF Z 2012     |        |
| I803  | 1KP1010C—  | IC PHOTO COUPLER   | KP-1010C                  | (A)    | CC151 | HCfk104ZCA | C CHIP CERA         | 50V Y5V 0.1MF Z 2012      |        |
| I804  | 1K78R09—   | IC REGULATOR       | KIA78R09PI                | (R)    | CC455 | HCfk104ZCA | C CHIP CERA         | 50V Y5V 0.1MF Z 2012      |        |
| I805  | TX0202DA—  | THYRISTOR          | X0202DA1BA2               | (R)    | CC502 | HCfk103ZCA | C CHIP CERA         | 50V Y5V 0.01MF Z 2012     |        |
| IF01  | 1TS0P1238W | IC PREAMP          | TS0P1238WI1               | (R)    | CC504 | HCfk103ZCA | C CHIP CERA         | 50V Y5V 0.01MF Z 2012     |        |
| JA01  | 4859107050 | JACK PIN BOARD     | PH-JB-9601 (PH06P-4120-C) |        | CC509 | HCfk103ZCA | C CHIP CERA         | 50V Y5V 0.01MF Z 2012     |        |
| JA02  | 4859108450 | JACK PIN BOARD     | YSC03P-4120-14A           |        | CC515 | HCBK472KCA | C CHIP CERA         | 50V X7R 4700PF K 2012     |        |
| JA03  | 4859111550 | JACK PIN BOARD     | YPJ501B                   |        | CC516 | HCBK223KCA | C CHIP CERA         | 50V X7R 0.022MF K 2012    |        |
| L403  | 58H0000047 | COIL H-LINEARITY   | TRL-190D                  | (R)    | CC521 | HCfk104ZCA | C CHIP CERA         | 50V Y5V 0.1MF Z 2012      |        |
| L404  | 58C7070085 | COIL CHOKE         | TLN-3062A                 | (R)    | CC525 | HCfk103ZCA | C CHIP CERA         | 50V Y5V 0.01MF Z 2012     |        |
| L555  | 58N0000046 | COIL VCO           | TRF-V012                  | (R)    | CC527 | HCfk103ZCA | C CHIP CERA         | 50V Y5V 0.01MF Z 2012     |        |
| L801  | 5PLF30A1—  | FILTER LINE        | LF-30A1                   |        | CC532 | HCfk103ZCA | C CHIP CERA         | 50V Y5V 0.01MF Z 2012     |        |
| L806  | 58C4500079 | COIL CHOKE         | L-45                      | (R)    | CC537 | HCfk103ZCA | C CHIP CERA         | 50V Y5V 0.01MF Z 2012     |        |
| M371A | 4853747800 | RETA PCB           | NYLON 66                  |        | CC540 | HCfk104ZCA | C CHIP CERA         | 50V Y5V 0.1MF Z 2012      |        |
| M682  | 4856813600 | HOLDER WIRE        | NYLON 66 DAWH-13NA        |        | CC546 | HCfk103ZCA | C CHIP CERA         | 50V Y5V 0.01MF Z 2012     |        |
| M683  | 4856812001 | TIE CABLE          | NYLON66 DA100             |        | CC566 | HCfk104ZCA | C CHIP CERA         | 50V Y5V 0.1MF Z 2012      |        |
| P202A | 4850705N07 | CONNECTOR          | BIC-05T-25T+ULW=200       |        | CC573 | HCBK102KCA | C CHIP CERA         | 50V X7R 1000PF K 2012     |        |
| PA201 | 4850706S02 | CONNECTOR          | YH025-06+YST025+ULW=400   |        | CC574 | HCBK102KCA | C CHIP CERA         | 50V X7R 1000PF K 2012     |        |
| PWC1  | 4859907810 | CORD POWER AS      | ME301P+TER=2100           | (A)    | CC577 | HCfk103ZCA | C CHIP CERA         | 50V Y5V 0.01MF Z 2012     |        |
| Q304  | PTE2SW7607 | HEAT SINK ASS'Y    | TKTC2026Y- + 7178301212   | (R)    | CC579 | HCfk104ZCA | C CHIP CERA         | 50V Y5V 0.1MF Z 2012      |        |
| 00001 | TKTC2026Y- | TR                 | KTC2026Y                  | (R)    | CC591 | HCfk104ZCA | C CHIP CERA         | 50V Y5V 0.1MF Z 2012      |        |
| 0000A | 4857027607 | HEAT SINK          | AL EX                     | (R)    | CC600 | HCBK102KCA | C CHIP CERA         | 50V X7R 1000PF K 2012     |        |
| 0000B | 7178301212 | SCREW TAPPTITE     | TT2 WAS 3X12 MFZN BK      |        | CC601 | HCQK479CCA | C CHIP CERA         | 50V CH 4.7PF C 2012       |        |
| Q401  | TKTC3229—  | TR                 | KTC3229                   | (R)    | CC609 | HCBK102KCA | C CHIP CERA         | 50V X7R 1000PF K 2012     |        |
| Q402  | PTF2SW7607 | HEAT SINK ASS'Y    | T2SD2578— + 7174301011    | (R)    | CC612 | HCQK479CCA | C CHIP CERA         | 50V CH 4.7PF C 2012       |        |
| 00001 | T2SD2578—  | TR                 | 2SD2578                   | (R)    | CC613 | HCfk103ZCA | C CHIP CERA         | 50V Y5V 0.01MF Z 2012     |        |
| 0000A | 4857027607 | HEAT SINK          | AL EX                     | (R)    | CC614 | HCBK102KCA | C CHIP CERA         | 50V X7R 1000PF K 2012     |        |
| 0000B | 7174301011 | SCREW TAPPTITE     | TT2 RND 3X10 MFZN         | (R)    | CC615 | HCfk103ZCA | C CHIP CERA         | 50V Y5V 0.01MF Z 2012     |        |
| Q801  | TKTA968AY- | TR                 | KTA968AY                  | (R)    | CC617 | HCfk104ZCA | C CHIP CERA         | 50V Y5V 0.1MF Z 2012      |        |
| R801  | DDB3R0M140 | POSISTOR           | ECPBD3R0M140              | (A)    | CC620 | HCQK200JCA | C CHIP CERA         | 50V CH 20PF J 2012        |        |

# **ELECTRICAL PARTS LIST**

| LOC   | PART CODE  | PART NAME   | PART DESCRIPTION       | REMARK | LOC   | PART CODE  | PART NAME | PART DESCRIPTION     | REMARK |
|-------|------------|-------------|------------------------|--------|-------|------------|-----------|----------------------|--------|
| CC621 | HCFK104ZCA | C CHIP CERA | 50V Y5V 0.1MF Z 2012   |        | RC501 | HRFT750JCA | R CHIP    | 1/10 75 OHM J 2012   |        |
| CC626 | HCBK102KCA | C CHIP CERA | 50V X7R 1000PF K 2012  |        | RC503 | HRFT101JCA | R CHIP    | 1/10 100 OHM J 2012  |        |
| CC627 | HCBK102KCA | C CHIP CERA | 50V X7R 1000PF K 2012  |        | RC505 | HRFT102JCA | R CHIP    | 1/10 1K OHM J 2012   |        |
| CC628 | HCQK471JCA | C CHIP CERA | 50V CH 470PF J 2012    |        | RC506 | HRFT102JCA | R CHIP    | 1/10 1K OHM J 2012   |        |
| CC629 | HCBK102KCA | C CHIP CERA | 50V X7R 1000PF K 2012  |        | RC508 | HRFT331JCA | R CHIP    | 1/10 330 OHM J 2012  |        |
| CC630 | HCQK471JCA | C CHIP CERA | 50V CH 470PF J 2012    |        | RC509 | HRFT101JCA | R CHIP    | 1/10 100 OHM J 2012  |        |
| CC631 | HCQK471JCA | C CHIP CERA | 50V CH 470PF J 2012    |        | RC519 | HRFT822JCA | R CHIP    | 1/10 8.2K OHM J 2012 |        |
| CC633 | HCQK471JCA | C CHIP CERA | 50V CH 470PF J 2012    |        | RC523 | HRFT224JCA | R CHIP    | 1/10 220K OHM J 2012 |        |
| CC635 | HCQK471JCA | C CHIP CERA | 50V CH 470PF J 2012    |        | RC525 | HRFT331JCA | R CHIP    | 1/10 330 OHM J 2012  |        |
| CC636 | HCFK104ZCA | C CHIP CERA | 50V Y5V 0.1MF Z 2012   |        | RC530 | HRFT181JCA | R CHIP    | 1/10 180 OHM J 2012  |        |
| CC637 | HCQK471JCA | C CHIP CERA | 50V CH 470PF J 2012    |        | RC534 | HRFT102JCA | R CHIP    | 1/10 1K OHM J 2012   |        |
| CC641 | HCFK104ZCA | C CHIP CERA | 50V Y5V 0.1MF Z 2012   |        | RC536 | HRFT221JCA | R CHIP    | 1/10 220 OHM J 2012  |        |
| CC645 | HCFK104ZCA | C CHIP CERA | 50V Y5V 0.1MF Z 2012   |        | RC539 | HRFT103JCA | R CHIP    | 1/10 10K OHM J 2012  |        |
| CC648 | HCFK103ZCA | C CHIP CERA | 50V Y5V 0.01MF Z 2012  |        | RC550 | HRFT101JCA | R CHIP    | 1/10 100 OHM J 2012  |        |
| CC649 | HCFK103ZCA | C CHIP CERA | 50V Y5V 0.01MF Z 2012  |        | RC551 | HRFT102JCA | R CHIP    | 1/10 1K OHM J 2012   |        |
| CC650 | HCFK103ZCA | C CHIP CERA | 50V Y5V 0.01MF Z 2012  |        | RC557 | HRFT153JCA | R CHIP    | 1/10 15K OHM J 2012  |        |
| CC652 | HCFK104ZCA | C CHIP CERA | 50V Y5V 0.1MF Z 2012   |        | RC574 | HRFT303JCA | R CHIP    | 1/10 30K OHM J 2012  |        |
| CC666 | HCFK104ZCA | C CHIP CERA | 50V Y5V 0.1MF Z 2012   |        | RC595 | HRFT102JCA | R CHIP    | 1/10 1K OHM J 2012   |        |
| CC670 | HCBK102KCA | C CHIP CERA | 50V X7R 1000PF K 2012  |        | RC597 | HRFT152JCA | R CHIP    | 1/10 1.5K OHM J 2012 |        |
| CC680 | HCBK102KCA | C CHIP CERA | 50V X7R 1000PF K 2012  |        | RC599 | HRFT104JCA | R CHIP    | 1/10 100K OHM J 2012 |        |
| CC702 | HCFK103ZCA | C CHIP CERA | 50V Y5V 0.01MF Z 2012  |        | RC600 | HRFT473JCA | R CHIP    | 1/10 47K OHM J 2012  |        |
| CC716 | HCFK103ZCA | C CHIP CERA | 50V Y5V 0.01MF Z 2012  |        | RC601 | HRFT101JCA | R CHIP    | 1/10 100 OHM J 2012  |        |
| CC718 | HCQK120JCA | C CHIP CERA | 50V CH 12PF J 2012     |        | RC603 | HRFT473JCA | R CHIP    | 1/10 47K OHM J 2012  |        |
| CC720 | HCBK102KCA | C CHIP CERA | 50V X7R 1000PF K 2012  |        | RC604 | HRFT392JCA | R CHIP    | 1/10 3.9K OHM J 2012 |        |
| CC722 | HCFK103ZCA | C CHIP CERA | 50V Y5V 0.01MF Z 2012  |        | RC605 | HRFT473JCA | R CHIP    | 1/10 47K OHM J 2012  |        |
| CC723 | HCFK103ZCA | C CHIP CERA | 50V Y5V 0.01MF Z 2012  |        | RC609 | HRFT243JCA | R CHIP    | 1/10 24K OHM J 2012  |        |
| CC741 | HCQK221JCA | C CHIP CERA | 50V CH 220PF J 2012    |        | RC619 | HRFT101JCA | R CHIP    | 1/10 100 OHM J 2012  |        |
| CC752 | HCQK180JCA | C CHIP CERA | 50V CH 18PF J 2012     |        | RC630 | HRFT473JCA | R CHIP    | 1/10 47K OHM J 2012  |        |
| CC754 | HCFK104ZCA | C CHIP CERA | 50V Y5V 0.1MF Z 2012   |        | RC632 | HRFT473JCA | R CHIP    | 1/10 47K OHM J 2012  |        |
| CC757 | HCBK333KCA | C CHIP CERA | 50V X7R 0.033MF K 2012 |        | RC634 | HRFT102JCA | R CHIP    | 1/10 1K OHM J 2012   |        |
| CC777 | HCFK103ZCA | C CHIP CERA | 50V Y5V 0.01MF Z 2012  |        | RC635 | HRFT473JCA | R CHIP    | 1/10 47K OHM J 2012  |        |
| CC778 | HRFT473JCA | R CHIP      | 1/10 47K OHM J 2012    |        | RC639 | HRFT473JCA | R CHIP    | 1/10 47K OHM J 2012  |        |
| CC821 | HCFK104ZCA | C CHIP CERA | 50V Y5V 0.1MF Z 2012   |        | RC640 | HRFT473JCA | R CHIP    | 1/10 47K OHM J 2012  |        |
| RC101 | HRFT101JCA | R CHIP      | 1/10 100 OHM J 2012    |        | RC641 | HRFT102JCA | R CHIP    | 1/10 1K OHM J 2012   |        |
| RC102 | HRFT151JCA | R CHIP      | 1/10 150 OHM J 2012    |        | RC642 | HRFT101JCA | R CHIP    | 1/10 100 OHM J 2012  |        |
| RC103 | HRFT152JCA | R CHIP      | 1/10 1.5K OHM J 2012   |        | RC650 | HRFT202JCA | R CHIP    | 1/10 2K OHM J 2012   |        |
| RC104 | HRFT472JCA | R CHIP      | 1/10 4.7K OHM J 2012   |        | RC651 | HRFT153JCA | R CHIP    | 1/10 15K OHM J 2012  |        |
| RC105 | HRFT122JCA | R CHIP      | 1/10 1.2K OHM J 2012   |        | RC698 | HRFT102JCA | R CHIP    | 1/10 1K OHM J 2012   |        |
| RC106 | HRFT201JCA | R CHIP      | 1/10 200 OHM J 2012    |        | RC705 | HRFT471JCA | R CHIP    | 1/10 470 OHM J 2012  |        |
| RC107 | HRFT101JCA | R CHIP      | 1/10 100 OHM J 2012    |        | RC709 | HRFT102JCA | R CHIP    | 1/10 1K OHM J 2012   |        |
| RC201 | HRFT101JCA | R CHIP      | 1/10 100 OHM J 2012    |        | RC710 | HRFT102JCA | R CHIP    | 1/10 1K OHM J 2012   |        |
| RC203 | HRFT473JCA | R CHIP      | 1/10 47K OHM J 2012    |        | RC711 | HRFT121JCA | R CHIP    | 1/10 120 OHM J 2012  |        |
| RC207 | HRFT203JCA | R CHIP      | 1/10 20K OHM J 2012    |        | RC714 | HRFT472JCA | R CHIP    | 1/10 4.7K OHM J 2012 |        |
| RC209 | HRFT750JCA | R CHIP      | 1/10 75 OHM J 2012     |        | RC728 | HRFT102JCA | R CHIP    | 1/10 1K OHM J 2012   |        |
| RC210 | HRFT750JCA | R CHIP      | 1/10 75 OHM J 2012     |        | RC732 | HRFT621JCA | R CHIP    | 1/10 620 OHM J 2012  |        |
| RC216 | HRFT750JCA | R CHIP      | 1/10 75 OHM J 2012     |        | RC733 | HRFT621JCA | R CHIP    | 1/10 620 OHM J 2012  |        |
| RC321 | HRFT564JCA | R CHIP      | 1/10 560K OHM J 2012   |        | RC734 | HRFT621JCA | R CHIP    | 1/10 620 OHM J 2012  |        |
| RC500 | HRFT750JCA | R CHIP      | 1/10 75 OHM J 2012     |        | RC735 | HRFT621JCA | R CHIP    | 1/10 620 OHM J 2012  |        |

# ELECTRICAL PARTS LIST

| LOC   | PART CODE   | PART NAME         | PART DESCRIPTION          | REMARK | LOC  | PART CODE  | PART NAME | PART DESCRIPTION | REMARK |
|-------|-------------|-------------------|---------------------------|--------|------|------------|-----------|------------------|--------|
| RC746 | HRFT102JCA  | R CHIP            | 1/10 1K OHM J 2012        |        | E023 | 4856310600 | EYE LET   | BSR T0.2 (R2.3)  |        |
| RC749 | HRFT103JCA  | R CHIP            | 1/10 10K OHM J 2012       |        | E024 | 4856310600 | EYE LET   | BSR T0.2 (R2.3)  |        |
| RC757 | HRFT514JCA  | R CHIP            | 1/10 510K OHM J 2012      |        | E025 | 4856310600 | EYE LET   | BSR T0.2 (R2.3)  |        |
| RC767 | HRFT472JCA  | R CHIP            | 1/10 4.7K OHM J 2012      |        | E026 | 4856310600 | EYE LET   | BSR T0.2 (R2.3)  |        |
| RC779 | HRFT101JCA  | R CHIP            | 1/10 100 OHM J 2012       |        | E027 | 4856310600 | EYE LET   | BSR T0.2 (R2.3)  |        |
| RC780 | HRFT102JCA  | R CHIP            | 1/10 1K OHM J 2012        |        | E028 | 4856310600 | EYE LET   | BSR T0.2 (R2.3)  |        |
| RC784 | HRFT472JCA  | R CHIP            | 1/10 4.7K OHM J 2012      |        | E029 | 4856310600 | EYE LET   | BSR T0.2 (R2.3)  |        |
| RC798 | HRFT472JCA  | R CHIP            | 1/10 4.7K OHM J 2012      |        | E030 | 4856310600 | EYE LET   | BSR T0.2 (R2.3)  |        |
| RC799 | HRFT103JCA  | R CHIP            | 1/10 10K OHM J 2012       |        | E031 | 4856310600 | EYE LET   | BSR T0.2 (R2.3)  |        |
| ZZ200 | PTMPJ0J936  | PCB MAIN (RHU) AS | DTQ-29U8FC                |        | E032 | 4856310600 | EYE LET   | BSR T0.2 (R2.3)  |        |
| C303  | CEXF1V221V  | C ELECTRO         | 35V RSS 220MF (10X12.5)TP |        | E033 | 4856310300 | EYE LET   | BSR T0.2 (R1.6)  |        |
| C309  | CEXF1V471V  | C ELECTRO         | 35V RSS 470MF (10X20) TP  |        | E034 | 4856310300 | EYE LET   | BSR T0.2 (R1.6)  |        |
| C408  | CEXF1V221V  | C ELECTRO         | 35V RSS 220MF (10X12.5)TP |        | E035 | 4856310300 | EYE LET   | BSR T0.2 (R1.6)  |        |
| C410  | CEXF2C101C  | C ELECTRO         | 160V RUS 100MF (16X25) TP |        | E036 | 4856310300 | EYE LET   | BSR T0.2 (R1.6)  |        |
| C411  | CEXF2E100V  | C ELECTRO         | 250V RSS 10MF (10X20) TP  |        | E037 | 4856310300 | EYE LET   | BSR T0.2 (R1.6)  |        |
| C415  | CEXF1C102C  | C ELECTRO         | 16V RUS 1000MF (10X20) TP |        | E038 | 4856310300 | EYE LET   | BSR T0.2 (R1.6)  |        |
| C456  | CEXF1C471C  | C ELECTRO         | 16V RUS 470MF (10X12.5)TP |        | E039 | 4856310300 | EYE LET   | BSR T0.2 (R1.6)  |        |
| C634  | CEXF1E222V  | C ELECTRO         | 25V RSS 2200MF (16X25) TP |        | E040 | 4856310300 | EYE LET   | BSR T0.2 (R1.6)  |        |
| C805  | CH1BEE472M  | C CERA AC         | U/C/V 2.5KV 4700PF TP     | ⚠      | E041 | 4856310300 | EYE LET   | BSR T0.2 (R1.6)  |        |
| C806  | CH1BEE472M  | C CERA AC         | U/C/V 2.5KV 4700PF TP     | ⚠      | E042 | 4856310300 | EYE LET   | BSR T0.2 (R1.6)  |        |
| C810  | CBXB3D471K  | C CERA SEMI       | 2KV BL(N) 470PF K (T)     |        | E043 | 4856310300 | EYE LET   | BSR T0.2 (R1.6)  |        |
| C816  | CEXF2A470V  | C ELECTRO         | 100V RSS 47MF (10X16) TP  |        | E044 | 4856310300 | EYE LET   | BSR T0.2 (R1.6)  |        |
| C819  | CBXB3D102K  | C CERA SEMI       | 2KV BL(N) 1000PF K (T)    |        | E045 | 4856310300 | EYE LET   | BSR T0.2 (R1.6)  |        |
| C820  | CEXF1E102V  | C ELECTRO         | 25V RSS 1000MF (13X20) TP |        | E046 | 4856310300 | EYE LET   | BSR T0.2 (R1.6)  |        |
| ZZ200 | PTMPJB0J936 | PCB MAIN M-10 AS  | DTQ-29U8FC                |        | E047 | 4856310300 | EYE LET   | BSR T0.2 (R1.6)  |        |
| 10    | 2TM18006BE  | TAPE MASKING      | 6.2X500                   |        | E048 | 4856310300 | EYE LET   | BSR T0.2 (R1.6)  |        |
| E001  | 4856310600  | EYE LET           | BSR T0.2 (R2.3)           |        | E049 | 4856310300 | EYE LET   | BSR T0.2 (R1.6)  |        |
| E002  | 4856310600  | EYE LET           | BSR T0.2 (R2.3)           |        | E050 | 4856310300 | EYE LET   | BSR T0.2 (R1.6)  |        |
| E003  | 4856310600  | EYE LET           | BSR T0.2 (R2.3)           |        | E051 | 4856310300 | EYE LET   | BSR T0.2 (R1.6)  |        |
| E004  | 4856310600  | EYE LET           | BSR T0.2 (R2.3)           |        | E052 | 4856310300 | EYE LET   | BSR T0.2 (R1.6)  |        |
| E005  | 4856310600  | EYE LET           | BSR T0.2 (R2.3)           |        | E053 | 4856310300 | EYE LET   | BSR T0.2 (R1.6)  |        |
| E006  | 4856310600  | EYE LET           | BSR T0.2 (R2.3)           |        | E054 | 4856310300 | EYE LET   | BSR T0.2 (R1.6)  |        |
| E007  | 4856310600  | EYE LET           | BSR T0.2 (R2.3)           |        | E055 | 4856310300 | EYE LET   | BSR T0.2 (R1.6)  |        |
| E008  | 4856310600  | EYE LET           | BSR T0.2 (R2.3)           |        | E056 | 4856310300 | EYE LET   | BSR T0.2 (R1.6)  |        |
| E009  | 4856310600  | EYE LET           | BSR T0.2 (R2.3)           |        | E057 | 4856310300 | EYE LET   | BSR T0.2 (R1.6)  |        |
| E010  | 4856310600  | EYE LET           | BSR T0.2 (R2.3)           |        | E058 | 4856310300 | EYE LET   | BSR T0.2 (R1.6)  |        |
| E011  | 4856310600  | EYE LET           | BSR T0.2 (R2.3)           |        | E059 | 4856310300 | EYE LET   | BSR T0.2 (R1.6)  |        |
| E012  | 4856310600  | EYE LET           | BSR T0.2 (R2.3)           |        | E060 | 4856310300 | EYE LET   | BSR T0.2 (R1.6)  |        |
| E013  | 4856310600  | EYE LET           | BSR T0.2 (R2.3)           |        | E061 | 4856310300 | EYE LET   | BSR T0.2 (R1.6)  |        |
| E014  | 4856310600  | EYE LET           | BSR T0.2 (R2.3)           |        | E062 | 4856310300 | EYE LET   | BSR T0.2 (R1.6)  |        |
| E015  | 4856310600  | EYE LET           | BSR T0.2 (R2.3)           |        | E063 | 4856310300 | EYE LET   | BSR T0.2 (R1.6)  |        |
| E016  | 4856310600  | EYE LET           | BSR T0.2 (R2.3)           |        | E064 | 4856310300 | EYE LET   | BSR T0.2 (R1.6)  |        |
| E017  | 4856310600  | EYE LET           | BSR T0.2 (R2.3)           |        | E065 | 4856310300 | EYE LET   | BSR T0.2 (R1.6)  |        |
| E018  | 4856310600  | EYE LET           | BSR T0.2 (R2.3)           |        | E066 | 4856310300 | EYE LET   | BSR T0.2 (R1.6)  |        |
| E019  | 4856310600  | EYE LET           | BSR T0.2 (R2.3)           |        | E067 | 4856310300 | EYE LET   | BSR T0.2 (R1.6)  |        |
| E020  | 4856310600  | EYE LET           | BSR T0.2 (R2.3)           |        | E068 | 4856310300 | EYE LET   | BSR T0.2 (R1.6)  |        |
| E021  | 4856310600  | EYE LET           | BSR T0.2 (R2.3)           |        | E069 | 4856310300 | EYE LET   | BSR T0.2 (R1.6)  |        |
| E022  | 4856310600  | EYE LET           | BSR T0.2 (R2.3)           |        | E070 | 4856310300 | EYE LET   | BSR T0.2 (R1.6)  |        |

# ELECTRICAL PARTS LIST

| LOC   | PART CODE  | PART NAME          | PART DESCRIPTION          | REMARK | LOC  | PART CODE  | PART NAME | PART DESCRIPTION          | REMARK |
|-------|------------|--------------------|---------------------------|--------|------|------------|-----------|---------------------------|--------|
| E071  | 4856310300 | EYE LET            | BSR T0.2 (R1.6)           |        | C306 | CMXM2A473J | C MYLAR   | 100V 0.047MF J (TP)       |        |
| E072  | 4856310300 | EYE LET            | BSR T0.2 (R1.6)           |        | C307 | CEXD1H109Q | C ELECTRO | 50V RT 1MF (6.3X11) TP    |        |
| E079  | 4856310300 | EYE LET            | BSR T0.2 (R1.6)           |        | C327 | CMXM2A102J | C MYLAR   | 100V 1000PF J (TP)        |        |
| E080  | 4856310600 | EYE LET            | BSR T0.2 (R2.3)           |        | C328 | CMXB2A103J | C MYLAR   | 100V EU 0.01MF J (TP)     |        |
| E081  | 4856310600 | EYE LET            | BSR T0.2 (R2.3)           |        | C402 | CCXB2H102K | C CERA    | 500V B 1000PF K (TAPPING) |        |
| E082  | 4856310600 | EYE LET            | BSR T0.2 (R2.3)           |        | C404 | CEXF2C109V | C ELECTRO | 160V RSS 1MF (6.3X11) TP  |        |
| E083  | 4856310600 | EYE LET            | BSR T0.2 (R2.3)           |        | C412 | CCXF2H103Z | C CERA    | HIKF 500V 0.01MF Z        |        |
| E084  | 4856310300 | EYE LET            | BSR T0.2 (R1.6)           |        | C413 | CEXF1H220V | C ELECTRO | 50V RSS 22MF (5X11) TP    |        |
| E085  | 4856310300 | EYE LET            | BSR T0.2 (R1.6)           |        | C414 | CCXB2H102K | C CERA    | 500V B 1000PF K (TAPPING) |        |
| E086  | 4856310300 | EYE LET            | BSR T0.2 (R1.6)           |        | C420 | CCXB2H102K | C CERA    | 500V B 1000PF K (TAPPING) |        |
| E087  | 4856310300 | EYE LET            | BSR T0.2 (R1.6)           |        | C421 | CMXM2A104J | C MYLAR   | 100V 0.1MF J (TP)         |        |
| E090  | 4856310300 | EYE LET            | BSR T0.2 (R1.6)           |        | C459 | CEXF2E229V | C ELECTRO | 250V RSS 2.2MF (8X11.5)TP |        |
| E091  | 4856310300 | EYE LET            | BSR T0.2 (R1.6)           |        | C501 | CEXF1C101V | C ELECTRO | 16V RSS 100MF (6.3X11) TP |        |
| E092  | 4856310300 | EYE LET            | BSR T0.2 (R1.6)           |        | C503 | CEXF1H220V | C ELECTRO | 50V RSS 22MF (5X11) TP    |        |
| E095  | 4856310300 | EYE LET            | BSR T0.2 (R1.6)           |        | C505 | CEXF1H229C | C ELECTRO | 50V RUS 2.2MF (5X11) TP   |        |
| N001  | 4857417500 | TERM PIN           | DA-IB0214(D2.3/DY PIN)    |        | C506 | CEXF1H228V | C ELECTRO | 50V RSS 0.22MF (5X11) TP  |        |
| N002  | 4857417500 | TERM PIN           | DA-IB0214(D2.3/DY PIN)    |        | C510 | CEXF1C101V | C ELECTRO | 16V RSS 100MF (6.3X11) TP |        |
| N003  | 4857417500 | TERM PIN           | DA-IB0214(D2.3/DY PIN)    |        | C514 | CMXL1J474J | C MYLAR   | 63V MEU 0.47MF J          |        |
| N004  | 4857417500 | TERM PIN           | DA-IB0214(D2.3/DY PIN)    |        | C517 | CMXM2A222J | C MYLAR   | 100V 2200PF J (TP)        |        |
| N007  | 4857417500 | TERM PIN           | DA-IB0214(D2.3/DY PIN)    |        | C519 | CEXF1H479V | C ELECTRO | 50V RSS 4.7MF (5X11) TP   |        |
| N008  | 4857417500 | TERM PIN           | DA-IB0214(D2.3/DY PIN)    |        | C520 | CMXM2A393J | C MYLAR   | 100V 0.039MF J (TP)       |        |
| N012  | 4857417500 | TERM PIN           | DA-IB0214(D2.3/DY PIN)    |        | C522 | CEXF1H228V | C ELECTRO | 50V RSS 0.22MF (5X11) TP  |        |
| P201  | 485923192S | CONN WAFER         | YW025-06 (STICK)          |        | C523 | CMXM2A822J | C MYLAR   | 100V 8200PF J (TP)        |        |
| P401  | 485923202S | CONN WAFER         | YW025-07 (STICK)          |        | C524 | CEXF1C221V | C ELECTRO | 16V RSS 220MF (8X11.5) TP |        |
| P501  | 485923182S | CONN WAFER         | YW025-05 (STICK)          |        | C526 | CEXF1H100C | C ELECTRO | 50V RUS 10MF (5X11) TP    |        |
| P601  | 485923172S | CONN WAFER         | YW025-04 (STICK)          |        | C527 | CMXM2A222J | C MYLAR   | 100V 2200PF J (TP)        |        |
| R104  | RS02Z472JS | R M-OXIDE FILM     | 2W 4.7K OHM J SMALL       |        | C528 | CEXF1C100V | C ELECTRO | RSS 16V 10MF 47           |        |
| R306  | RS02Z109JS | R M-OXIDE FILM     | 2W 1 OHM J SMALL          |        | C529 | CMXL1J104J | C MYLAR   | 63V MEU 0.1MF J           |        |
| R403  | RS02Z100JS | R M-OXIDE FILM     | 2W 10 OHM J SMALL         |        | C530 | CMXL1J104J | C MYLAR   | 63V MEU 0.1MF J           |        |
| R407  | RS02Z102JS | R M-OXIDE FILM     | 2W 1K OHM J SMALL         |        | C531 | CEXF1H108V | C ELECTRO | 50V RSS 0.1MF (5X11) TP   |        |
| R408  | RF01Z229J- | R FUSIBLE          | 1W 2.2 OHM J (TAPPING)    |        | C534 | CMXM2A102J | C MYLAR   | 100V 1000PF J (TP)        |        |
| R410  | RF01Z229J- | R FUSIBLE          | 1W 2.2 OHM J (TAPPING)    |        | C535 | CEXF1H228V | C ELECTRO | 50V RSS 0.22MF (5X11) TP  |        |
| R416  | RF02Z159J- | R FUSIBLE          | 2W 1.5 OHM J (TAPPING)    |        | C538 | CEXF1H100C | C ELECTRO | 50V RUS 10MF (5X11) TP    |        |
| R419  | RF01Z229J- | R FUSIBLE          | 1W 2.2 OHM J (TAPPING)    |        | C539 | CEXF1H479V | C ELECTRO | 50V RSS 4.7MF (5X11) TP   |        |
| R495  | RS02Z153JS | R M-OXIDE FILM     | 2W 15K OHM J SMALL        |        | C548 | CEXF1C101V | C ELECTRO | 16V RSS 100MF (6.3X11) TP |        |
| R497  | RS02Z100JS | R M-OXIDE FILM     | 2W 10 OHM J SMALL         |        | C550 | CEXF1H100C | C ELECTRO | 50V RUS 10MF (5X11) TP    |        |
| R810  | RF01Z338K- | R FUSIBLE          | 1W 0.33 OHM K (TAPPING)   |        | C551 | CEXF1H100C | C ELECTRO | 50V RUS 10MF (5X11) TP    |        |
| R823  | RS02Z223JS | R M-OXIDE FILM     | 2W 22K OHM J SMALL        |        | C589 | CEXF1H100C | C ELECTRO | 50V RUS 10MF (5X11) TP    |        |
| R824  | RF02Z228K- | R FUSIBLE          | 2W 0.22 OHM K (TAPPING)   |        | C590 | CEXF1H479V | C ELECTRO | 50V RSS 4.7MF (5X11) TP   |        |
| R826  | RS02Z240JS | R M-OXIDE FILM     | 2W 24 OHM J SMALL         |        | C592 | CEXF1C470V | C ELECTRO | 16V RSS 47MF (5X11) TP    |        |
| ZZ200 | PTMPJRJ936 | PCB MAIN RADIAL AS | DTQ-29U8FC                |        | C593 | CEXF1H228V | C ELECTRO | 50V RSS 0.22MF (5X11) TP  |        |
| C103  | CEXF1H479V | C ELECTRO          | 50V RSS 4.7MF (5X11) TP   |        | C594 | CEXF1H479V | C ELECTRO | 50V RSS 4.7MF (5X11) TP   |        |
| C106  | CEXF1C101V | C ELECTRO          | 16V RSS 100MF (6.3X11) TP |        | C597 | CEXF1H100C | C ELECTRO | 50V RUS 10MF (5X11) TP    |        |
| C108  | CEXF1H100V | C ELECTRO          | 50V RSS 10MF (5X11) TP    |        | C599 | CEXF1H100C | C ELECTRO | 50V RUS 10MF (5X11) TP    |        |
| C201  | CEXF1H100V | C ELECTRO          | 50V RSS 10MF (5X11) TP    |        | C601 | CEXF1H479V | C ELECTRO | 50V RSS 4.7MF (5X11) TP   |        |
| C202  | CEXF1E221V | C ELECTRO          | 25V RSS 220MF (8X11.5) TP |        | C603 | CMXL1J224J | C MYLAR   | 63V MEU 0.22MF J (TP)     |        |
| C301  | CMXM2A224J | C MYLAR            | 100V 0.22MF J             |        | C604 | CEXF1C470V | C ELECTRO | 16V RSS 47MF (5X11) TP    |        |
| C305  | CMXB2A103J | C MYLAR            | 100V EU 0.01MF J (TP)     |        | C605 | CEXF1H229C | C ELECTRO | 50V RUS 2.2MF (5X11) TP   |        |



# ELECTRICAL PARTS LIST

| LOC   | PART CODE  | PART NAME    | PART DESCRIPTION          | REMARK | LOC   | PART CODE  | PART NAME         | PART DESCRIPTION         | REMARK |
|-------|------------|--------------|---------------------------|--------|-------|------------|-------------------|--------------------------|--------|
| C606  | CMXB2A103J | C MYLAR      | 100V EU 0.01MF J (TP)     |        | Q101  | TKTC3198Y- | TR                | KTC3198Y                 |        |
| C607  | CMXL1J224J | C MYLAR      | 63V MEU 0.22MF J (TP)     |        | Q201  | TKTC3198Y- | TR                | KTC3198Y                 |        |
| C610  | CMXL1J224J | C MYLAR      | 63V MEU 0.22MF J (TP)     |        | Q301  | TKTA1266Y- | TR                | KTA1266Y (TP)            |        |
| C611  | CEXF1H100C | C ELECTRO    | 50V RUS 10MF (5X11) TP    |        | Q302  | TKTC3198Y- | TR                | KTC3198Y                 |        |
| C613  | CMXL1J224J | C MYLAR      | 63V MEU 0.22MF J (TP)     |        | Q303  | TKTA1266Y- | TR                | KTA1266Y (TP)            |        |
| C616  | CEXF1H100C | C ELECTRO    | 50V RUS 10MF (5X11) TP    |        | Q501  | TKTC3198Y- | TR                | KTC3198Y                 |        |
| C619  | CEXF1H479V | C ELECTRO    | 50V RSS 4.7MF (5X11) TP   |        | Q502  | TKTC3198Y- | TR                | KTC3198Y                 |        |
| C621  | CMXM2A152J | C MYLAR      | 100V 1500PF J (TP)        |        | Q601  | TKTC3198Y- | TR                | KTC3198Y                 |        |
| C622  | CMXM2A152J | C MYLAR      | 100V 1500PF J (TP)        |        | Q602  | TKTC3198Y- | TR                | KTC3198Y                 |        |
| C623  | CMXL1J104J | C MYLAR      | 63V MEU 0.1MF J           |        | Q603  | TKTA1266Y- | TR                | KTA1266Y (TP)            |        |
| C624  | CMXL1J104J | C MYLAR      | 63V MEU 0.1MF J           |        | Q704  | TKTA1266Y- | TR                | KTA1266Y (TP)            |        |
| C625  | CMXL1J104J | C MYLAR      | 63V MEU 0.1MF J           |        | Q705  | TKTA1266Y- | TR                | KTA1266Y (TP)            |        |
| C626  | CMXL1J104J | C MYLAR      | 63V MEU 0.1MF J           |        | Q706  | TKTC3198Y- | TR                | KTC3198Y                 |        |
| C627  | CEXF1H100C | C ELECTRO    | 50V RUS 10MF (5X11) TP    |        | Q730  | TKTC3198Y- | TR                | KTC3198Y                 |        |
| C632  | CEXF1H479V | C ELECTRO    | 50V RSS 4.7MF (5X11) TP   |        | Q740  | TKTC3198Y- | TR                | KTC3198Y                 |        |
| C638  | CEXF1H339V | C ELECTRO    | 50V RSS 3.3MF (5X11) TP   |        | Q802  | TKTC3198Y- | TR                | KTC3198Y                 |        |
| C639  | CEXF1H100C | C ELECTRO    | 50V RUS 10MF (5X11) TP    |        | Q803  | TKTC3198Y- | TR                | KTC3198Y                 |        |
| C640  | CEXF1H100C | C ELECTRO    | 50V RUS 10MF (5X11) TP    |        | Q804  | TKTC3198Y- | TR                | KTC3198Y                 |        |
| C644  | CEXF1H100C | C ELECTRO    | 50V RUS 10MF (5X11) TP    |        | Q813  | TKTC3207—  | TR                | KTC3207 (TP)             |        |
| C647  | CEXF1C470V | C ELECTRO    | 16V RSS 47MF (5X11) TP    |        | R308  | RN02B471JS | R METAL FILM      | 2W 470 OHM J SMALL       |        |
| C651  | CEXF1H229C | C ELECTRO    | 50V RUS 2.2MF (5X11) TP   |        | R309  | RN02B271JS | R METAL FILM      | 2W 270 OHM J SMALL       |        |
| C653  | CEXF1C470V | C ELECTRO    | 16V RSS 47MF (5X11) TP    |        | R310  | RN02B102JS | R METAL FILM      | 2W 1K OHM J SMALL        |        |
| C669  | CEXF1H100C | C ELECTRO    | 50V RUS 10MF (5X11) TP    |        | R315  | RN01B272JS | R METAL FILM      | 1W 2.7K OHM J SMALL      |        |
| C690  | CEXF1H479V | C ELECTRO    | 50V RSS 4.7MF (5X11) TP   |        | R316  | RN01B562JS | R METAL FILM      | 1W 5.6K OHM J SMALL      |        |
| C703  | CEXF1H109V | C ELECTRO    | 50V RSS 1MF (5X11) TP     |        | R320  | RN01B750JS | R METAL FILM      | 1W 75 OHM J SMALL        |        |
| C704  | CEXF1H229C | C ELECTRO    | 50V RUS 2.2MF (5X11) TP   |        | R402  | RN02B103JS | R METAL FILM      | 2W 10K OHM J SMALL       |        |
| C705  | CEXF1H109V | C ELECTRO    | 50V RSS 1MF (5X11) TP     |        | R425  | RN02B752JS | R METAL FILM      | 2W 7.5K OHM J SMALL      |        |
| C706  | CEXF1H228V | C ELECTRO    | 50V RSS 0.22MF (5X11) TP  |        | R499  | RN02B221JS | R METAL FILM      | 2W 220 OHM J SMALL       |        |
| C709  | CEXF1C221V | C ELECTRO    | 16V RSS 220MF (8X11.5) TP |        | R642  | RN02B910JS | R METAL FILM      | 2W 91 OHM J SMALL        |        |
| C779  | CEXF1C101V | C ELECTRO    | 16V RSS 100MF (6.3X11) TP |        | R643  | RN02B680JS | R METAL FILM      | 2W 68 OHM J SMALL        |        |
| C807  | CCXB1H821K | C CERA       | 50V B 820PF K (TAPPING)   |        | R652  | RN02B200JS | R METAL FILM      | 2W 20 OHM J SMALL        |        |
| C808  | CEXF1H100C | C ELECTRO    | 50V RUS 10MF (5X11) TP    |        | R653  | RN02B200JS | R METAL FILM      | 2W 20 OHM J SMALL        |        |
| C814  | CXSL2H470J | C CERA       | 500V SL 47PF J (TAPPING)  |        | R814  | RN02B102JS | R METAL FILM      | 2W 1K OHM J SMALL        |        |
| C818  | CMXL1J224J | C MYLAR      | 63V MEU 0.22MF J (TP)     |        | R818  | RN02B472JS | R METAL FILM      | 2W 4.7K OHM J SMALL      |        |
| C822  | CEXF1C101V | C ELECTRO    | 16V RSS 100MF (6.3X11) TP |        | R828  | RN02B100JS | R METAL FILM      | 2W 10 OHM J SMALL        |        |
| C825  | CEXF1H229C | C ELECTRO    | 50V RUS 2.2MF (5X11) TP   |        | SW702 | 5S50101090 | SW TACT           | THVH472GCA               |        |
| C829  | CEXF1H470C | C ELECTRO    | 50V RUS 47MF (6.3X11) TP  |        | SW703 | 5S50101090 | SW TACT           | THVH472GCA               |        |
| C830  | CCXB1H152K | C CERA       | 50V B 1500PF K (TAPPING)  |        | SW704 | 5S50101090 | SW TACT           | THVH472GCA               |        |
| C832  | CEXF1H220V | C ELECTRO    | 50V RSS 22MF (5X11) TP    |        | SW705 | 5S50101090 | SW TACT           | THVH472GCA               |        |
| C833  | CEXF1H479V | C ELECTRO    | 50V RSS 4.7MF (5X11) TP   |        | SW706 | 5S50101090 | SW TACT           | THVH472GCA               |        |
| C834  | CMXM2A273J | C MYLAR      | 100V 0.027MF J (TP)       |        | X501  | 5XEX4R436C | CRYSTAL QUARTZ    | HC-49U 4.433619M 20PP TA |        |
| C862  | CEXF1E101V | C ELECTRO    | 25V RSS 100MF (6.3X11) TP |        | ZZ200 | PTMPJAJ936 | PCB MAIN AXIAL AS | DTQ-29U8FC               |        |
| CF01  | CEXF1C470C | C ELECTRO    | 16V RUS 47MF (5X11) TP    |        | 10    | 2TM14006LB | TAPE MASKING      | 3M #232 6.0X2000M        |        |
| F801A | 4857415001 | CLIP FUSE    | PFC5000-0702              |        | 20    | 2TM10006LB | TAPE MASKING      | 3M #232-MAP-C 6.2X2000M  |        |
| F801B | 4857415001 | CLIP FUSE    | PFC5000-0702              |        | A001  | 4859814491 | PCB MAIN          | 330X246 SIB              |        |
| L101  | 5CPX478M—  | COIL PEAKING | 0.47UH M RADIAL           |        | C304  | CCZB1H181K | C CERA            | 50V B 180PF K (AXIAL)    |        |
| L805  | 58C0000096 | COIL CHOKE   | 610G0233(470K)            |        | C511  | CBZF1H104Z | C CERA SEMI       | 50V F 0.1MF Z            |        |
| L809  | 58C0000096 | COIL CHOKE   | 610G0233(470K)            |        | C512  | CBZF1H104Z | C CERA SEMI       | 50V F 0.1MF Z            |        |

## ELECTRICAL PARTS LIST

| LOC  | PART CODE  | PART NAME   | PART DESCRIPTION       | REMARK | LOC  | PART CODE  | PART NAME   | PART DESCRIPTION         | REMARK |
|------|------------|-------------|------------------------|--------|------|------------|-------------|--------------------------|--------|
| C513 | CBZF1H104Z | C CERA SEMI | 50V F 0.1MF Z          |        | J001 | 85801065GY | WIRE COPPER | AWG22 1/0.65 TIN COATING |        |
| C533 | CCZF1H103Z | C CERA      | 50V F 0.01MF Z         |        | J002 | 85801065GY | WIRE COPPER | AWG22 1/0.65 TIN COATING |        |
| C536 | CZCH1H100J | C CERA      | 50V CH 10PF J          |        | J003 | 85801065GY | WIRE COPPER | AWG22 1/0.65 TIN COATING |        |
| C595 | CCZB1H820K | C CERA      | 50V B 82PF K (AXIAL)   |        | J004 | 85801065GY | WIRE COPPER | AWG22 1/0.65 TIN COATING |        |
| C598 | CBZF1H104Z | C CERA SEMI | 50V F 0.1MF Z          |        | J005 | 85801065GY | WIRE COPPER | AWG22 1/0.65 TIN COATING |        |
| C618 | CZSL1H470J | C CERA      | 50V SL 47PF J (AXIAL)  |        | J006 | 85801065GY | WIRE COPPER | AWG22 1/0.65 TIN COATING |        |
| C710 | CCZB1H101K | C CERA      | 50V B 100PF K (AXIAL)  |        | J007 | 85801065GY | WIRE COPPER | AWG22 1/0.65 TIN COATING |        |
| D102 | DUZ33B—    | DIODE ZENER | UZ-33B                 |        | J008 | 85801065GY | WIRE COPPER | AWG22 1/0.65 TIN COATING |        |
| D200 | DMTZJ5R6B- | DIODE ZENER | MTZJ 5.6B              |        | J009 | 85801065GY | WIRE COPPER | AWG22 1/0.65 TIN COATING |        |
| D201 | CCZB1H102K | C CERA      | 50V B 1000PF K (AXIAL) |        | J010 | 85801065GY | WIRE COPPER | AWG22 1/0.65 TIN COATING |        |
| D203 | DMTZJ5R6B- | DIODE ZENER | MTZJ 5.6B              |        | J011 | 85801065GY | WIRE COPPER | AWG22 1/0.65 TIN COATING |        |
| D212 | CCZB1H102K | C CERA      | 50V B 1000PF K (AXIAL) |        | J012 | 85801065GY | WIRE COPPER | AWG22 1/0.65 TIN COATING |        |
| D301 | D1N4004S—  | DIODE       | 1N4004S                |        | J013 | 85801065GY | WIRE COPPER | AWG22 1/0.65 TIN COATING |        |
| D302 | D1N4937G—  | DIODE       | 1N4937G (TAPPING)      |        | J014 | 85801065GY | WIRE COPPER | AWG22 1/0.65 TIN COATING |        |
| D403 | D1N4937G—  | DIODE       | 1N4937G (TAPPING)      |        | J015 | 85801065GY | WIRE COPPER | AWG22 1/0.65 TIN COATING |        |
| D404 | D1N4937G—  | DIODE       | 1N4937G (TAPPING)      |        | J016 | 85801065GY | WIRE COPPER | AWG22 1/0.65 TIN COATING |        |
| D405 | D1N4148—   | DIODE       | 1N4148 (TAPPING)       |        | J018 | 85801065GY | WIRE COPPER | AWG22 1/0.65 TIN COATING |        |
| D406 | DRGP15J—   | DIODE       | RGP15J                 |        | J019 | 85801065GY | WIRE COPPER | AWG22 1/0.65 TIN COATING |        |
| D413 | DUZ9R1BM—  | DIODE ZENER | UZ-9.1BM               |        | J020 | 85801065GY | WIRE COPPER | AWG22 1/0.65 TIN COATING |        |
| D482 | DUZ9R1BM—  | DIODE ZENER | UZ-9.1BM               | △      | J022 | 85801065GY | WIRE COPPER | AWG22 1/0.65 TIN COATING |        |
| D488 | D1N4937G—  | DIODE       | 1N4937G (TAPPING)      |        | J023 | 85801065GY | WIRE COPPER | AWG22 1/0.65 TIN COATING |        |
| D497 | D1N4937G—  | DIODE       | 1N4937G (TAPPING)      |        | J024 | 85801065GY | WIRE COPPER | AWG22 1/0.65 TIN COATING |        |
| D500 | DMTZJ5R6B- | DIODE ZENER | MTZJ 5.6B              |        | J025 | 85801065GY | WIRE COPPER | AWG22 1/0.65 TIN COATING |        |
| D501 | DMTZJ5R6B- | DIODE ZENER | MTZJ 5.6B              |        | J026 | 85801065GY | WIRE COPPER | AWG22 1/0.65 TIN COATING |        |
| D503 | D1N4148—   | DIODE       | 1N4148 (TAPPING)       |        | J027 | 85801065GY | WIRE COPPER | AWG22 1/0.65 TIN COATING |        |
| D506 | D1N4148—   | DIODE       | 1N4148 (TAPPING)       |        | J028 | 85801065GY | WIRE COPPER | AWG22 1/0.65 TIN COATING |        |
| D603 | D1N4148—   | DIODE       | 1N4148 (TAPPING)       |        | J029 | 85801065GY | WIRE COPPER | AWG22 1/0.65 TIN COATING |        |
| D605 | DUZ8R2BM—  | DIODE ZENER | UZ-8.2BM               |        | J030 | 85801065GY | WIRE COPPER | AWG22 1/0.65 TIN COATING |        |
| D607 | D1N4148—   | DIODE       | 1N4148 (TAPPING)       |        | J031 | 85801065GY | WIRE COPPER | AWG22 1/0.65 TIN COATING |        |
| D609 | D1N4148—   | DIODE       | 1N4148 (TAPPING)       |        | J032 | 85801065GY | WIRE COPPER | AWG22 1/0.65 TIN COATING |        |
| D610 | DMTZJ5R6B- | DIODE ZENER | MTZJ 5.6B              |        | J033 | 85801065GY | WIRE COPPER | AWG22 1/0.65 TIN COATING |        |
| D612 | DMTZJ5R6B- | DIODE ZENER | MTZJ 5.6B              |        | J034 | 85801065GY | WIRE COPPER | AWG22 1/0.65 TIN COATING |        |
| D660 | DMTZJ5R6B- | DIODE ZENER | MTZJ 5.6B              |        | J035 | 85801065GY | WIRE COPPER | AWG22 1/0.65 TIN COATING |        |
| D699 | D1N4148—   | DIODE       | 1N4148 (TAPPING)       |        | J036 | 85801065GY | WIRE COPPER | AWG22 1/0.65 TIN COATING |        |
| D704 | DMTZJ5R6B- | DIODE ZENER | MTZJ 5.6B              |        | J038 | 85801065GY | WIRE COPPER | AWG22 1/0.65 TIN COATING |        |
| D705 | D1N4148—   | DIODE       | 1N4148 (TAPPING)       |        | J039 | 85801065GY | WIRE COPPER | AWG22 1/0.65 TIN COATING |        |
| D706 | DUZ3R9B—   | DIODE ZENER | UZ-3.9B                |        | J040 | 85801065GY | WIRE COPPER | AWG22 1/0.65 TIN COATING |        |
| D714 | D1N4148—   | DIODE       | 1N4148 (TAPPING)       |        | J041 | 85801065GY | WIRE COPPER | AWG22 1/0.65 TIN COATING |        |
| D779 | DMTZJ5R6B- | DIODE ZENER | MTZJ 5.6B              |        | J042 | 85801065GY | WIRE COPPER | AWG22 1/0.65 TIN COATING |        |
| D803 | D1N4937G—  | DIODE       | 1N4937G (TAPPING)      |        | J043 | 85801065GY | WIRE COPPER | AWG22 1/0.65 TIN COATING |        |
| D804 | D1N4937G—  | DIODE       | 1N4937G (TAPPING)      |        | J044 | 85801065GY | WIRE COPPER | AWG22 1/0.65 TIN COATING |        |
| D805 | D1N4937G—  | DIODE       | 1N4937G (TAPPING)      |        | J045 | 85801065GY | WIRE COPPER | AWG22 1/0.65 TIN COATING |        |
| D807 | D1N4937G—  | DIODE       | 1N4937G (TAPPING)      |        | J046 | 85801065GY | WIRE COPPER | AWG22 1/0.65 TIN COATING |        |
| D808 | D1N4937G—  | DIODE       | 1N4937G (TAPPING)      |        | J047 | 85801065GY | WIRE COPPER | AWG22 1/0.65 TIN COATING |        |
| D812 | D1N4937G—  | DIODE       | 1N4937G (TAPPING)      |        | J048 | 85801065GY | WIRE COPPER | AWG22 1/0.65 TIN COATING |        |
| D814 | D1N4937G—  | DIODE       | 1N4937G (TAPPING)      |        | J049 | 85801065GY | WIRE COPPER | AWG22 1/0.65 TIN COATING |        |
| D816 | D1N4148—   | DIODE       | 1N4148 (TAPPING)       |        | J050 | 85801065GY | WIRE COPPER | AWG22 1/0.65 TIN COATING |        |
| DF02 | DMTZJ5R6B- | DIODE ZENER | MTZJ 5.6B              |        | J051 | 85801065GY | WIRE COPPER | AWG22 1/0.65 TIN COATING |        |

## ELECTRICAL PARTS LIST

[illegible]

## ELECTRICAL PARTS LIST

| LOC  | PART CODE  | PART NAME     | PART DESCRIPTION         | REMARK | LOC  | PART CODE  | PART NAME     | PART DESCRIPTION | REMARK |
|------|------------|---------------|--------------------------|--------|------|------------|---------------|------------------|--------|
| J148 | 85801065GY | WIRE COPPER   | AWG22 1/0.65 TIN COATING |        | R508 | RD-AZ101J- | R CARBON FILM | 1/6 100 OHM J    |        |
| L102 | 5CPZ569K04 | COIL PEAKING  | 5.6UH K (AXIAL 10.5MM)   |        | R510 | RD-AZ101J- | R CARBON FILM | 1/6 100 OHM J    |        |
| L406 | 5MC0000100 | COIL BEAD     | HC-3550                  |        | R511 | RD-AZ101J- | R CARBON FILM | 1/6 100 OHM J    |        |
| L501 | 5CPZ100K02 | COIL PEAKING  | 10UH K (AXIAL 3.5MM)     |        | R512 | RD-AZ101J- | R CARBON FILM | 1/6 100 OHM J    |        |
| L502 | 5CPZ100K02 | COIL PEAKING  | 10UH K (AXIAL 3.5MM)     |        | R514 | RD-AZ222J- | R CARBON FILM | 1/6 2.2K OHM J   |        |
| L504 | 5CPZ569K04 | COIL PEAKING  | 5.6UH K (AXIAL 10.5MM)   |        | R515 | RN-AZ5601F | R METAL FILM  | 1/6 5.6K OHM F   |        |
| L505 | 5CPZ100K02 | COIL PEAKING  | 10UH K (AXIAL 3.5MM)     |        | R517 | RD-AZ104J- | R CARBON FILM | 1/6 100K OHM J   |        |
| L507 | 5CPZ100K02 | COIL PEAKING  | 10UH K (AXIAL 3.5MM)     |        | R518 | RD-AZ103J- | R CARBON FILM | 1/6 10K OHM J    |        |
| L533 | 5CPZ150K02 | COIL PEAKING  | 15UH K (AXIAL 3.5MM)     |        | R520 | RD-4Z331J- | R CARBON FILM | 1/4 330 OHM J    |        |
| L595 | CZCH1H120J | C CERA        | 50V CH 12PF J (AXIAL)    |        | R521 | RD-AZ101J- | R CARBON FILM | 1/6 100 OHM J    |        |
| L598 | 5CPZ100K02 | COIL PEAKING  | 10UH K (AXIAL 3.5MM)     |        | R522 | RD-AZ101J- | R CARBON FILM | 1/6 100 OHM J    |        |
| L599 | 5CPZ100K02 | COIL PEAKING  | 10UH K (AXIAL 3.5MM)     |        | R524 | RD-4Z271J- | R CARBON FILM | 1/4 270 OHM J    |        |
| L601 | 5CPZ560K02 | COIL PEAKING  | 56UH K (AXIAL 3.5MM)     |        | R529 | RD-AZ103J- | R CARBON FILM | 1/6 10K OHM J    |        |
| L602 | 5CPZ150K02 | COIL PEAKING  | 15UH K (AXIAL 3.5MM)     |        | R534 | RD-AZ221J- | R CARBON FILM | 1/6 220 OHM J    |        |
| L603 | 5CPZ470K04 | COIL PEAKING  | 47UH 10.5MM K (LAL04TB)  |        | R535 | RD-AZ101J- | R CARBON FILM | 1/6 100 OHM J    |        |
| L701 | 5CPZ100K02 | COIL PEAKING  | 10UH K (AXIAL 3.5MM)     |        | R539 | RD-AZ221J- | R CARBON FILM | 1/6 220 OHM J    |        |
| L802 | 5MC0000100 | COIL BEAD     | HC-3550                  |        | R594 | RD-AZ101J- | R CARBON FILM | 1/6 100 OHM J    |        |
| L803 | 5MC0000100 | COIL BEAD     | HC-3550                  |        | R595 | RD-AZ561J- | R CARBON FILM | 1/6 560 OHM J    |        |
| L804 | 5MC0000100 | COIL BEAD     | HC-3550                  |        | R602 | RD-AZ224J- | R CARBON FILM | 1/6 220K OHM J   |        |
| L807 | 5MC0000100 | COIL BEAD     | HC-3550                  |        | R607 | RD-AZ102J- | R CARBON FILM | 1/6 1K OHM J     |        |
| L808 | 5MC0000100 | COIL BEAD     | HC-3550                  |        | R609 | RD-AZ681J- | R CARBON FILM | 1/6 680 OHM J    |        |
| R110 | RD-AZ680J- | R CARBON FILM | 1/6 68 OHM J             |        | R610 | RD-AZ101J- | R CARBON FILM | 1/6 100 OHM J    |        |
| R116 | RD-AZ102J- | R CARBON FILM | 1/6 1K OHM J             |        | R631 | RD-AZ101J- | R CARBON FILM | 1/6 100 OHM J    |        |
| R117 | RD-AZ102J- | R CARBON FILM | 1/6 1K OHM J             |        | R637 | RD-AZ102J- | R CARBON FILM | 1/6 1K OHM J     |        |
| R202 | RD-AZ203J- | R CARBON FILM | 1/6 20K OHM J            |        | R638 | RD-AZ182J- | R CARBON FILM | 1/6 1.8K OHM J   |        |
| R204 | RD-AZ680J- | R CARBON FILM | 1/6 68 OHM J             |        | R644 | RD-AZ103J- | R CARBON FILM | 1/6 10K OHM J    |        |
| R205 | RD-AZ101J- | R CARBON FILM | 1/6 100 OHM J            |        | R645 | RD-AZ102J- | R CARBON FILM | 1/6 1K OHM J     |        |
| R218 | RD-2Z151J- | R CARBON FILM | 1/2 150 OHM J            |        | R646 | RD-AZ102J- | R CARBON FILM | 1/6 1K OHM J     |        |
| R301 | RD-AZ102J- | R CARBON FILM | 1/6 1K OHM J             |        | R647 | RD-AZ223J- | R CARBON FILM | 1/6 22K OHM J    |        |
| R302 | RD-AZ514J- | R CARBON FILM | 1/6 510K OHM J           |        | R648 | RD-AZ122J- | R CARBON FILM | 1/6 1.2K OHM J   |        |
| R303 | RD-AZ102J- | R CARBON FILM | 1/6 1K OHM J             |        | R649 | RD-AZ392J- | R CARBON FILM | 1/6 3.9K OHM J   |        |
| R304 | RD-AZ683J- | R CARBON FILM | 1/6 68K OHM J            |        | R650 | RD-AZ182J- | R CARBON FILM | 1/6 1.8K OHM J   |        |
| R305 | RD-AZ363J- | R CARBON FILM | 1/6 36K OHM J            |        | R651 | RD-AZ122J- | R CARBON FILM | 1/6 1.2K OHM J   |        |
| R307 | RD-AZ473J- | R CARBON FILM | 1/6 47K OHM J            |        | R703 | RD-AZ102J- | R CARBON FILM | 1/6 1K OHM J     |        |
| R311 | RD-AZ203J- | R CARBON FILM | 1/6 20K OHM J            |        | R704 | RD-AZ102J- | R CARBON FILM | 1/6 1K OHM J     |        |
| R312 | RD-AZ102J- | R CARBON FILM | 1/6 1K OHM J             |        | R706 | RD-AZ103J- | R CARBON FILM | 1/6 10K OHM J    |        |
| R313 | RD-4Z153J- | R CARBON FILM | 1/4 15K OHM J            |        | R707 | RD-AZ103J- | R CARBON FILM | 1/6 10K OHM J    |        |
| R314 | RD-4Z362J- | R CARBON FILM | 1/4 3.6K OHM J           |        | R713 | RD-AZ102J- | R CARBON FILM | 1/6 1K OHM J     |        |
| R319 | RD-4Z752J- | R CARBON FILM | 1/4 7.5K OHM J           |        | R714 | RD-AZ102J- | R CARBON FILM | 1/6 1K OHM J     |        |
| R406 | RD-AZ203J- | R CARBON FILM | 1/6 20K OHM J            |        | R715 | RD-AZ102J- | R CARBON FILM | 1/6 1K OHM J     |        |
| R413 | RN-4Z1802F | R METAL FILM  | 1/4 18.0K OHM F          | △      | R717 | RD-AZ102J- | R CARBON FILM | 1/6 1K OHM J     |        |
| R414 | RN-4Z1602F | R METAL FILM  | 1/4 16.0K OHM F          | △      | R718 | RD-AZ103J- | R CARBON FILM | 1/6 10K OHM J    |        |
| R420 | RD-4Z203J- | R CARBON FILM | 1/4 20K OHM J            |        | R720 | RD-AZ102J- | R CARBON FILM | 1/6 1K OHM J     |        |
| R444 | RD-4Z102J- | R CARBON FILM | 1/4 1K OHM J             |        | R721 | RD-AZ471J- | R CARBON FILM | 1/6 470 OHM J    |        |
| R449 | RD-AZ151J- | R CARBON FILM | 1/6 150 OHM J            |        | R722 | RD-AZ512J- | R CARBON FILM | 1/6 5.1K OHM J   |        |
| R471 | RD-4Z220J- | R CARBON FILM | 1/4 22 OHM J             |        | R723 | RD-AZ103J- | R CARBON FILM | 1/6 10K OHM J    |        |
| R482 | RD-2Z470J- | R CARBON FILM | 1/2 47 OHM J             |        | R730 | RD-AZ102J- | R CARBON FILM | 1/6 1K OHM J     |        |
| R507 | RD-AZ564J- | R CARBON FILM | 1/6 560K OHM J           |        | R735 | RD-AZ102J- | R CARBON FILM | 1/6 1K OHM J     |        |

# ELECTRICAL PARTS LIST

| LOC   | PART CODE  | PART NAME         | PART DESCRIPTION         | REMARK | LOC   | PART CODE  | PART NAME            | PART DESCRIPTION          | REMARK |
|-------|------------|-------------------|--------------------------|--------|-------|------------|----------------------|---------------------------|--------|
| R736  | RD-AZ102J- | R CARBON FILM     | 1/6 1K OHM J             |        | I901B | 7174300811 | SCREW TAPPTITE       | TT2 RND 3X8 MFZN          |        |
| R737  | RD-AZ681J- | R CARBON FILM     | 1/6 680 OHM J            |        | M684  | 4856812001 | TIE CABLE            | NYLON66 DA100             |        |
| R738  | RD-AZ681J- | R CARBON FILM     | 1/6 680 OHM J            |        | P903  | 4859238620 | CONN WAFER           | YPW500-02                 |        |
| R739  | RD-AZ681J- | R CARBON FILM     | 1/6 680 OHM J            |        | P904  | 4859205620 | CONN WAFER           | LW-0640-03                |        |
| R741  | RD-AZ102J- | R CARBON FILM     | 1/6 1K OHM J             |        | PA401 | 4850707S02 | CONNECTOR            | YH025-07+YST025+ULW=400   |        |
| R742  | RD-AZ392J- | R CARBON FILM     | 1/6 3.9K OHM J           |        | PA501 | 4850705S12 | CONNECTOR            | YH025-05+YST025+ULW=500   |        |
| R743  | RD-AZ222J- | R CARBON FILM     | 1/6 2.2K OHM J           |        | Q908  | PTE2SW6901 | HEAT SINK ASS'Y      | TKTA1659Y- + 7174300811   |        |
| R744  | RD-AZ152J- | R CARBON FILM     | 1/6 1.5K OHM J           |        | 00001 | TKTA1659AY | TR                   | KTA1659AY                 | (®)    |
| R745  | RD-AZ102J- | R CARBON FILM     | 1/6 1K OHM J             |        | 0000A | 4857026901 | HEAT SINK            | AL EX BK                  | (®)    |
| R748  | RD-AZ471J- | R CARBON FILM     | 1/6 470 OHM J            |        | 0000B | 7174300811 | SCREW TAPPTITE       | TT2 RND 3X8 MFZN          | (®)    |
| R749  | RD-AZ101J- | R CARBON FILM     | 1/6 100 OHM J            |        | Q909  | PTB2SW6900 | HEAT SINK ASS'Y      | TKTC4370Y- + 7174300811   | (®)    |
| R755  | RD-AZ512J- | R CARBON FILM     | 1/6 5.1K OHM J           |        | 0000A | 4857026900 | HEAT SINK            | AL EX                     | (®)    |
| R760  | RD-AZ103J- | R CARBON FILM     | 1/6 10K OHM J            |        | 0000B | 7174300811 | SCREW TAPPTITE       | TT2 RND 3X8 MFZN          | (®)    |
| R769  | RD-AZ471J- | R CARBON FILM     | 1/6 470 OHM J            |        | 001—  | TKTC4370AY | TR                   | KTC4370AY                 | (®)    |
| R770  | RD-AZ101J- | R CARBON FILM     | 1/6 100 OHM J            |        | R951  | RS01Z331J- | R M-OXIDE FILM       | 1W 330 OHM J (TAPPING)    | (®)    |
| R771  | RD-AZ102J- | R CARBON FILM     | 1/6 1K OHM J             |        | SCT1  | 4859302830 | SOCKET CRT           | ISH-02S                   | (⚠)    |
| R775  | RD-AZ102J- | R CARBON FILM     | 1/6 1K OHM J             |        | ZZ200 | PTCPJ0J904 | PCB CRT ODD SHAPE AS | DTQ-29U8                  |        |
| R776  | RD-AZ562J- | R CARBON FILM     | 1/6 5.6K OHM J           |        | C907  | CEXF2E100V | C ELECTRO            | 250V RSS 10MF (10X20) TP  |        |
| R777  | RD-AZ562J- | R CARBON FILM     | 1/6 5.6K OHM J           |        | C908  | CEXF2E100V | C ELECTRO            | 250V RSS 10MF (10X20) TP  |        |
| R778  | RD-AZ103J- | R CARBON FILM     | 1/6 10K OHM J            |        | C909  | CH1BEE472M | C CERA AC            | U/C/V 2.5KV 4700PF TP     | (⚠)    |
| R779  | RD-AZ102J- | R CARBON FILM     | 1/6 1K OHM J             |        | C941  | CEXF2C470V | C ELECTRO            | 160V RSS 47MF (13X25) TP  |        |
| R790  | RD-AZ472J- | R CARBON FILM     | 1/6 4.7K OHM J           |        | C942  | CEXF2C100V | C ELECTRO            | 160V RSS 10MF (10X16) TP  |        |
| R797  | RD-AZ361J- | R CARBON FILM     | 1/6 360 OHM J            |        | C943  | CEXF2C470V | C ELECTRO            | 160V RSS 47MF (13X25) TP  |        |
| R803  | RD-4Z102J- | R CARBON FILM     | 1/4 1K OHM J             |        | C945  | CEXF2C100V | C ELECTRO            | 160V RSS 10MF (10X16) TP  |        |
| R804  | RD-2Z100J- | R CARBON FILM     | 1/2 10 OHM J             |        | ZZ200 | PTCPJB904  | PCB CRT M-10 AS      | DTQ-29U8                  |        |
| R805  | RD-2Z242J- | R CARBON FILM     | 1/2 2.4K OHM J           |        | R904  | RS01Z683J- | R M-OXIDE FILM       | 1W 68K OHM J (TAPPING)    |        |
| R806  | RD-AZ472J- | R CARBON FILM     | 1/6 4.7K OHM J           |        | R907  | RS01Z683J- | R M-OXIDE FILM       | 1W 68K OHM J (TAPPING)    |        |
| R808  | RD-4Z681J- | R CARBON FILM     | 1/4 680 OHM J            |        | R910  | RS01Z683J- | R M-OXIDE FILM       | 1W 68K OHM J (TAPPING)    |        |
| R809  | RD-4Z102J- | R CARBON FILM     | 1/4 1K OHM J             |        | R954  | RF01Z229J- | R FUSIBLE            | 1W 2.2 OHM J (TAPPING)    |        |
| R811  | RD-4Z363J- | R CARBON FILM     | 1/4 36K OHM J            |        | R956  | RS02Z102JS | R M-OXIDE FILM       | 2W 1K OHM J SMALL         |        |
| R812  | RD-AZ223J- | R CARBON FILM     | 1/6 22K OHM J            |        | ZZ200 | PTCPJR904  | PCB CRT RADIAL AS    | DTQ-29U8                  |        |
| R813  | RD-AZ203J- | R CARBON FILM     | 1/6 20K OHM J            |        | C901  | CEXF1H100C | C ELECTRO            | 50V RUS 10MF (5X11) TP    |        |
| R816  | RD-AZ473J- | R CARBON FILM     | 1/6 47K OHM J            |        | C902  | CMXM2A104J | C MYLAR              | 100V 0.1MF J (TP)         |        |
| R817  | RD-AZ103J- | R CARBON FILM     | 1/6 10K OHM J            |        | C904  | CCXB2H102K | C CERA               | 500V B 1000PF K (TAPPING) |        |
| R819  | RD-AZ682J- | R CARBON FILM     | 1/6 6.8K OHM J           |        | C905  | CCXB2H102K | C CERA               | 500V B 1000PF K (TAPPING) |        |
| R821  | RD-2Z105J- | R CARBON FILM     | 1/2 1M OHM J             |        | C906  | CCXB2H102K | C CERA               | 500V B 1000PF K (TAPPING) |        |
| R827  | RD-AZ473J- | R CARBON FILM     | 1/6 47K OHM J            |        | C915  | CMXM2A822J | C MYLAR              | 100V 8200PF J (TP)        |        |
| R829  | RD-4Z622J- | R CARBON FILM     | 1/4 6.2K OHM J           |        | C916  | CEXF1E470C | C ELECTRO            | 25V RUS 47MF (5X11) TP    |        |
| R830  | RD-AZ472J- | R CARBON FILM     | 1/6 4.7K OHM J           |        | C920  | CEXF1E470C | C ELECTRO            | 25V RUS 47MF (5X11) TP    |        |
| R831  | 85801065GY | WIRE COPPER       | AWG22 1/0.65 TIN COATING |        | C922  | CCXB1H472K | C CERA               | 50V B 4700PF K (TAPPING)  |        |
| R833  | RD-AZ103J- | R CARBON FILM     | 1/6 10K OHM J            |        | C923  | CCXB1H472K | C CERA               | 50V B 4700PF K (TAPPING)  |        |
| R834  | RD-4Z109J- | R CARBON FILM     | 1/4 1 OHM J              |        | C944  | CXSL2H470J | C CERA               | 500V SL 47PF J (TAPPING)  |        |
| R888  | RC-2Z225KP | R CARBON COMP     | 1/2 2.2M OHM K           | (⚠)    | C946  | CEXF1C470V | C ELECTRO            | 16V RSS 47MF (5X11) TP    |        |
| RF11  | RD-AZ240J- | R CARBON FILM     | 1/6 24 OHM J             |        | C947  | CMXL2E104K | C MYLAR              | 250V MEU 0.1MF K          |        |
| ZZ600 | PTCPMSJ904 | PCB CRT MANUAL AS | DTQ-29U8                 |        | G901  | 4SG0DX0001 | SPARK GAP            | SSG-102-A1(1.0KV) TAP     |        |
| I901  | PTB2SW5403 | HEAT SINK ASS'Y   | 1TEA5101B- + 7174300811  |        | G902  | 4SG0DX0001 | SPARK GAP            | SSG-102-A1(1.0KV) TAP     |        |
| I901  | 1TEA5101B- | IC VIDEO AMP      | TEA5101B                 | (®)    | G903  | 4SG0DX0001 | SPARK GAP            | SSG-102-A1(1.0KV) TAP     |        |
| I901A | 4857025403 | HEAT SINK         | AL050P-H24 T=2           |        | Q902  | TKTC3198Y- | TR                   | KTC3198Y                  |        |

# ELECTRICAL PARTS LIST

| LOC   | PART CODE  | PART NAME        | PART DESCRIPTION         | REMARK | LOC  | PART CODE  | PART NAME     | PART DESCRIPTION | REMARK |
|-------|------------|------------------|--------------------------|--------|------|------------|---------------|------------------|--------|
| Q903  | TKTC3198Y- | TR               | KTC3198Y                 |        | L902 | 5MC0000100 | COIL BEAD     | HC-3550          |        |
| Q904  | TKTC3198Y- | TR               | KTC3198Y                 |        | L903 | 5MC0000100 | COIL BEAD     | HC-3550          |        |
| Q905  | TKTC3198Y- | TR               | KTC3198Y                 |        | R905 | RD-AZ911J- | R CARBON FILM | 1/6 910 OHM J    |        |
| Q906  | TKTC3198Y- | TR               | KTC3198Y                 |        | R906 | RD-AZ202J- | R CARBON FILM | 1/6 2K OHM J     |        |
| Q907  | TKTA1266Y- | TR               | KTA1266Y (TP)            |        | R908 | RD-AZ911J- | R CARBON FILM | 1/6 910 OHM J    |        |
| Q910  | TKTA1266Y- | TR               | KTA1266Y (TP)            |        | R909 | RD-AZ202J- | R CARBON FILM | 1/6 2K OHM J     |        |
| R903  | RN02B240JS | R METAL FILM     | 2W 24 OHM J SMALL        |        | R911 | RD-AZ911J- | R CARBON FILM | 1/6 910 OHM J    |        |
| R953  | RN02B221JS | R METAL FILM     | 2W 220 OHM J SMALL       |        | R912 | RD-AZ202J- | R CARBON FILM | 1/6 2K OHM J     |        |
| ZZ200 | PTCPJAJ904 | PCB CRT AXIAL AS | DTQ-29U8                 |        | R913 | RD-AZ751J- | R CARBON FILM | 1/6 750 OHM J    |        |
| A001  | 4859828413 | PCB CRT          | 165X113(330X246/2X2) SIB |        | R914 | RD-AZ472J- | R CARBON FILM | 1/6 4.7K OHM J   |        |
| C917  | CCZB1H561K | C CERA           | 50V B 560PF K            |        | R915 | RD-AZ751J- | R CARBON FILM | 1/6 750 OHM J    |        |
| C918  | CCZF1H103Z | C CERA           | 50V F 0.01MF Z           |        | R916 | RD-AZ472J- | R CARBON FILM | 1/6 4.7K OHM J   |        |
| C919  | CCZB1H102K | C CERA           | 50V B 1000PF K (AXIAL)   |        | R917 | RD-AZ751J- | R CARBON FILM | 1/6 750 OHM J    |        |
| C921  | CCZB1H101K | C CERA           | 50V B 100PF K (AXIAL)    |        | R918 | RD-AZ472J- | R CARBON FILM | 1/6 4.7K OHM J   |        |
| C924  | CCZB1H101K | C CERA           | 50V B 100PF K (AXIAL)    |        | R919 | RC-2Z102K- | R CARBON COMP | 1/2 1K OHM K     |        |
| D904  | DLT2A05G—  | DIODE            | LT2A05G (TP)             | (R)    | R920 | RC-2Z102K- | R CARBON COMP | 1/2 1K OHM K     |        |
| D905  | DUZ12BM—   | DIODE ZENER      | UZ-12BM (UNIZON)         |        | R921 | RC-2Z102K- | R CARBON COMP | 1/2 1K OHM K     |        |
| D906  | D1N4148—   | DIODE            | 1N4148 (TAPPING)         |        | R922 | RD-2Z100J- | R CARBON FILM | 1/2 10 OHM J     |        |
| D907  | D1N4148—   | DIODE            | 1N4148 (TAPPING)         |        | R924 | RD-AZ102J- | R CARBON FILM | 1/6 1K OHM J     |        |
| D908  | D1N4148—   | DIODE            | 1N4148 (TAPPING)         |        | R925 | RD-AZ471J- | R CARBON FILM | 1/6 470 OHM J    |        |
| D909  | D1N4148—   | DIODE            | 1N4148 (TAPPING)         |        | R926 | RD-2Z471J- | R CARBON FILM | 1/2 470 OHM J    |        |
| D910  | D1N4148—   | DIODE            | 1N4148 (TAPPING)         |        | R927 | RD-AZ470J- | R CARBON FILM | 1/6 47 OHM J     |        |
| D911  | D1N4004S—  | DIODE            | 1N4004S                  |        | R928 | RD-AZ223J- | R CARBON FILM | 1/6 22K OHM J    |        |
| D912  | D1N4004S—  | DIODE            | 1N4004S                  |        | R929 | RD-AZ273J- | R CARBON FILM | 1/6 27K OHM J    |        |
| D913  | DUZ9R1BM—  | DIODE ZENER      | UZ-9.1BM                 |        | R930 | RD-AZ333J- | R CARBON FILM | 1/6 33K OHM J    |        |
| D914  | D1N4148—   | DIODE            | 1N4148 (TAPPING)         |        | R932 | RD-AZ392J- | R CARBON FILM | 1/6 3.9K OHM J   |        |
| D915  | D1N4148—   | DIODE            | 1N4148 (TAPPING)         |        | R933 | RD-AZ392J- | R CARBON FILM | 1/6 3.9K OHM J   |        |
| D916  | D1N4148—   | DIODE            | 1N4148 (TAPPING)         |        | R934 | RD-AZ393J- | R CARBON FILM | 1/6 39K OHM J    |        |
| D917  | D1N4148—   | DIODE            | 1N4148 (TAPPING)         |        | R935 | RD-AZ563J- | R CARBON FILM | 1/6 56K OHM J    |        |
| D918  | DMTZJ5R6B- | DIODE ZENER      | MTZJ 5.6B                |        | R936 | RD-AZ103J- | R CARBON FILM | 1/6 10K OHM J    |        |
| D919  | DMTZJ5R6B- | DIODE ZENER      | MTZJ 5.6B                |        | R937 | RD-AZ820J- | R CARBON FILM | 1/6 82 OHM J     |        |
| D920  | D1N4937G—  | DIODE            | 1N4937G (TAPPING)        |        | R938 | RD-2Z100J- | R CARBON FILM | 1/2 10 OHM J     |        |
| D921  | D1N4937G—  | DIODE            | 1N4937G (TAPPING)        |        | R939 | RD-AZ820J- | R CARBON FILM | 1/6 82 OHM J     |        |
| D922  | D1N4937G—  | DIODE            | 1N4937G (TAPPING)        |        | R940 | RD-AZ122J- | R CARBON FILM | 1/6 1.2K OHM J   |        |
| J901  | 85801065GY | WIRE COPPER      | AWG22 1/0.65 TIN COATING |        | R941 | RD-AZ152J- | R CARBON FILM | 1/6 1.5K OHM J   |        |
| J902  | 85801065GY | WIRE COPPER      | AWG22 1/0.65 TIN COATING |        | R942 | RD-AZ683J- | R CARBON FILM | 1/6 68K OHM J    |        |
| J904  | 85801065GY | WIRE COPPER      | AWG22 1/0.65 TIN COATING |        | R943 | RD-AZ683J- | R CARBON FILM | 1/6 68K OHM J    |        |
| J906  | 85801065GY | WIRE COPPER      | AWG22 1/0.65 TIN COATING |        | R944 | RD-AZ123J- | R CARBON FILM | 1/6 12K OHM J    |        |
| J907  | 85801065GY | WIRE COPPER      | AWG22 1/0.65 TIN COATING |        | R945 | RD-AZ122J- | R CARBON FILM | 1/6 1.2K OHM J   |        |
| J908  | 85801065GY | WIRE COPPER      | AWG22 1/0.65 TIN COATING |        | R946 | RD-AZ152J- | R CARBON FILM | 1/6 1.5K OHM J   |        |
| J910  | 85801065GY | WIRE COPPER      | AWG22 1/0.65 TIN COATING |        | R947 | RD-4Z620J- | R CARBON FILM | 1/4 62 OHM J     |        |
| J913  | 85801065GY | WIRE COPPER      | AWG22 1/0.65 TIN COATING |        | R948 | RD-2Z279J- | R CARBON FILM | 1/2 2.7 OHM J    |        |
| J914  | 85801065GY | WIRE COPPER      | AWG22 1/0.65 TIN COATING |        | R950 | RD-2Z279J- | R CARBON FILM | 1/2 2.7 OHM J    |        |
| J915  | 85801065GY | WIRE COPPER      | AWG22 1/0.65 TIN COATING |        | R952 | RD-4Z620J- | R CARBON FILM | 1/4 62 OHM J     |        |
| J916  | 85801065GY | WIRE COPPER      | AWG22 1/0.65 TIN COATING |        | R955 | RD-AZ182J- | R CARBON FILM | 1/6 1.8K OHM J   |        |
| J918  | 85801065GY | WIRE COPPER      | AWG22 1/0.65 TIN COATING |        | R957 | RD-4Z105J- | R CARBON FILM | 1/4 1M OHM J     |        |
| J922  | 85801065GY | WIRE COPPER      | AWG22 1/0.65 TIN COATING |        | R958 | RD-2Z102J- | R CARBON FILM | 1/2 1K OHM J     |        |
| L901  | 5MC0000100 | COIL BEAD        | HC-3550                  |        | R959 | RD-AZ103J- | R CARBON FILM | 1/6 10K OHM J    |        |

## 1. DIFFERENT PARTS LIST ( DTQ-29U8SC VS DTQ-29U8SS )

| L/C   | PARTS NAME          | PARTS CODE | PARTS DESCRIPTION       | DTQ-29U8SC | DTQ-29U8SS |
|-------|---------------------|------------|-------------------------|------------|------------|
| 10    | TAPE MASKING        | 2TM18006BE | 6.2X500                 | PTMPJBJ936 |            |
| 10    | TAPE MASKING        | 2TM18006BE | 6.2X500                 |            | PTMPJBJ937 |
| M201  | MASK FRONT          | 4852078800 | FR HIPS GY 29U8         | PTFMSJJ936 |            |
| M201  | MASK FRONT          | 4852078801 | HIPS GY 29U8            |            | PTFMSJJ937 |
| M211  | COVER BACK          | 4852160400 | FR HIPS GY 29U8         | PTBCSHJ936 |            |
| M211  | COVER BACK          | 4852160401 | HIPS GY 29U8            |            | PTBCSHJ904 |
| M481  | BUTTON POWER        | 4854860900 | FR ABS GY 29U8          | PTFMSJJ936 |            |
| M481  | BUTTON POWER        | 4854860901 | ABS GY 29U8             |            | PTFMSJJ937 |
| M491  | BUTTON CH           | 4854950400 | FR ABS GY 29U8          | PTFMSJJ936 |            |
| M491  | BUTTON CH           | 4854950401 | ABS GY 29U8             |            | PTFMSJJ937 |
| PWC1  | CORD POWER AS       | 4859907810 | ME301P+TER=2100         | PTMPMSJ936 |            |
| PWC1  | CORD POWER AS       | 4859902710 | KJ-10+SPT-2+YPT018=2100 |            | PTMPMSJ937 |
| R638  | R CARBON FILM       | RD-AZ182J- | 1/6 1.8K OHM J          | PTMPJAJ936 |            |
| R638  | R CARBON FILM       | RD-AZ242J- | 1/6 2.4K OHM J          |            | PTMPJAJ937 |
| R650  | R CARBON FILM       | RD-AZ182J- | 1/6 1.8K OHM J          | PTMPJAJ936 |            |
| R650  | R CARBON FILM       | RD-AZ242J- | 1/6 2.4K OHM J          |            | PTMPJAJ937 |
| V901  | CRT                 | 4859635261 | A68QDL280X011(B) P45    | PTCACAJ948 |            |
| V901  | CRT                 | 4859635263 | A68QDL280X011(B) P23    |            | PTCACAJ949 |
| ZZ110 | ACCESSORY AS        | PTACPWJ936 | DTQ-29U8FC              | DTQ-29U8SC |            |
| ZZ110 | ACCESSORY AS        | PTACPWJ937 | DTQ-29U8FS              |            | DTQ-29U8SS |
| ZZ120 | COVER BACK AS       | PTBCSHJ936 | DTQ-29U8FC              | DTQ-29U8SC |            |
| ZZ120 | COVER BACK AS       | PTBCSHJ904 | DTQ-29U8                |            | DTQ-29U8SS |
| ZZ140 | CABINET AS          | PTCACAJ948 | DTQ-29U8SC              | DTQ-29U8SC |            |
| ZZ140 | CABINET AS          | PTCACAJ949 | DTQ-29U8SS              |            | DTQ-29U8SS |
| ZZ200 | MASK FRONT AS       | PTFMSJJ936 | DTQ-29U8FC              | PTCACAJ948 |            |
| ZZ200 | PCB MAIN M-10 AS    | PTMPJBJ936 | DTQ-29U8FC              | PTMPJ0J936 |            |
| ZZ200 | PCB MAIN (RHU) AS   | PTMPJ0J936 | DTQ-29U8FC              | PTMPJ2J936 |            |
| ZZ200 | PCB MAIN RADIAL AS  | PTMPJRJ936 | DTQ-29U8FC              | PTMPJBJ936 |            |
| ZZ200 | PCB MAIN AXIAL AS   | PTMPJAJ936 | DTQ-29U8FC              | PTMPJRJ936 |            |
| ZZ200 | PCB CHIP MOUNT B AS | PTMPJ2J936 | DTQ-29U8FC              | PTMPMSJ936 |            |
| ZZ200 | MASK FRONT AS       | PTFMSJJ937 | DTQ-29U8FS              |            | PTCACAJ949 |
| ZZ200 | PCB MAIN M-10 AS    | PTMPJBJ937 | DTQ-29U8FS              |            | PTMPJ0J937 |
| ZZ200 | PCB MAIN (RHU) AS   | PTMPJ0J937 | DTQ-29U8FS              |            | PTMPJ2J937 |
| ZZ200 | PCB MAIN RADIAL AS  | PTMPJRJ937 | DTQ-29U8FS              |            | PTMPJBJ937 |
| ZZ200 | PCB MAIN AXIAL AS   | PTMPJAJ937 | DTQ-29U8FS              |            | PTMPJRJ937 |
| ZZ200 | PCB CHIP MOUNT B AS | PTMPJ2J937 | DTQ-29U8FS              |            | PTMPMSJ937 |
| ZZ290 | PCB MAIN MANUAL AS  | PTMPMSJ936 | DTQ-29U8FC              | PTCACAJ948 |            |
| ZZ290 | PCB MAIN MANUAL AS  | PTMPMSJ937 | DTQ-29U8FS              |            | PTCACAJ949 |

# ELECTRICAL PARTS LIST

| L/C   | PARTS NAME      | PARTS CODE | PARTS DESCRIPTION        | DTQ-29U8SC | DTQ-29U8SSP |
|-------|-----------------|------------|--------------------------|------------|-------------|
| 00001 | IC POWER        | 1STRF6626- | STR-F6626                | PTM2SW8210 |             |
| 00001 | IC SMPS         | 1STRF6654- | STR-F6654                |            | PTK2SW8210  |
| 0000A | HEAT SINK       | 4857028210 | AL EX                    | PTM2SW8210 |             |
| 0000A | HEAT SINK       | 4857028210 | AL EX                    |            | PTK2SW8210  |
| 0000B | SCREW TAPPTITE  | 7174301011 | TT2 RND 3X10 MFZN        | PTM2SW8210 |             |
| 0000B | SCREW TAPPTITE  | 7174301011 | TT2 RND 3X10 MFZN        |            | PTK2SW8210  |
| 10    | TAPE MASKING    | 2TM14006LB | 3M #232 6.0X2000M        | PTMPJAJ936 |             |
| 10    | TAPE MASKING    | 2TM18006BE | 6.2X500                  | PTMPJBJ936 |             |
| 10    | TAPE MASKING    | 2TM14006LB | 3M #232 6.0X2000M        |            | PTMPJAJ938  |
| 10    | TAPE MASKING    | 2TM18006BE | 6.2X500                  |            | PTMPJBJ938  |
| 20    | TAPE MASKING    | 2TM10006LB | 3M #232-MAP-C 6.2X2000M  | PTMPJAJ936 |             |
| 20    | TAPE MASKING    | 2TM10006LB | 3M #232-MAP-C 6.2X2000M  |            | PTMPJAJ938  |
| C804  | C ELECTRO       | CEYD2D681D | 200V FHS 680MF (25X40)   | PTMPMSJ936 |             |
| C804  | C ELECTRO       | CEYN2G181P | 400V LHS 180MF (25X35)   |            | PTMPMSJ938  |
| C809  | C CERA AC       | CH1BFE472M | AC400V 4700PF M U/C/V    | PTMPMSJ936 |             |
| C834  | C MYLAR         | CMXM2A273J | 100V 0.027MF J (TP)      | PTMPJRJ936 |             |
| C834  | C MYLAR         | CMXM2A102J | 100V 1000PF J (TP)       |            | PTMPJRJ938  |
| C888  | C CERA AC       | CH1BFE472M | AC400V 4700PF M U/C/V    | PTMPMSJ936 |             |
| C889  | C CERA AC       | CH1BFE472M | AC400V 4700PF M U/C/V    |            | PTMPMSJ938  |
| D801  | DIODE BRIDGE    | DPBS606GU- | PBS606G                  | PTC1SW8902 |             |
| D801  | HEAT SINK ASS'Y | PTC1SW8902 | DPBS606GU- + 7174300811  | PTMPMSJ936 |             |
| D801  | DIODE BRIDGE    | DPBS606GU- | PBS606G                  |            | PTMPMSJ938  |
| D801A | HEAT SINK       | 4857018902 | A1050P-H24               | PTC1SW8902 |             |
| D801B | SCREW TAPPTITE  | 7174300811 | TT2 RND 3X8 MFZN         | PTC1SW8902 |             |
| F801  | FUSE GLASS TUBE | 5F1GB6321L | UL/CSA TL 6.3A 125V MF51 | PTMPMSJ936 |             |
| F801  | FUSE GLASS TUBE | 5FKGB4022R | KS MF51 4A 250V NR       |            | PTMPMSJ938  |
| I801  | HEAT SINK ASS'Y | PTM2SW8210 | 1STRF6626- + 7174301011  | PTMPMSJ936 |             |
| I801  | HEAT SINK ASS'Y | PTK2SW8210 | 1STRF6654- + 7174301011  |            | PTMPMSJ938  |
| M201  | MASK FRONT      | 4852078800 | FR HIPS GY 29U8          | PTFMSJJ936 |             |
| M201  | MASK FRONT      | 4852078801 | HIPS GY 29U8             |            | PTFMSJJ938  |
| M211  | COVER BACK      | 4852160400 | FR HIPS GY 29U8          | PTBCSHJ936 |             |
| M211  | COVER BACK      | 4852160401 | HIPS GY 29U8             |            | PTBCSHJ904  |
| M481  | BUTTON POWER    | 4854860900 | FR ABS GY 29U8           | PTFMSJJ936 |             |
| M481  | BUTTON POWER    | 4854860901 | ABS GY 29U8              |            | PTFMSJJ938  |
| M491  | BUTTON CH       | 4854950400 | FR ABS GY 29U8           | PTFMSJJ936 |             |
| M491  | BUTTON CH       | 4854950401 | ABS GY 29U8              |            | PTFMSJJ938  |
| PWC1  | CORD POWER AS   | 4859907810 | ME301P+TER=2100          | PTMPMSJ936 |             |
| PWC1  | CORD POWER AS   | 4859908410 | MP229+H03VVH2-F+TER=2100 |            | PTMPMSJ938  |
| R638  | R CARBON FILM   | RD-AZ182J- | 1/6 1.8K OHM J           | PTMPJAJ936 |             |
| R638  | R CARBON FILM   | RD-AZ242J- | 1/6 2.4K OHM J           |            | PTMPJAJ938  |
| R650  | R CARBON FILM   | RD-AZ182J- | 1/6 1.8K OHM J           | PTMPJAJ936 |             |



# ELECTRICAL PARTS LIST

| L/C   | PARTS NAME          | PARTS CODE | PARTS DESCRIPTION         | DTQ-29U8SC | DTQ-29U8SSP |
|-------|---------------------|------------|---------------------------|------------|-------------|
| R650  | R CARBON FILM       | RD-AZ242J- | 1/6 2.4K OHM J            |            | PTMPJAJ938  |
| R801  | POSISTOR            | DDB3R0M140 | ECPBD3R0M140              | PTMPMSJ936 |             |
| R801  | POSISTOR            | DDB7R0M290 | ECPBD7R0M290              |            | PTMPMSJ938  |
| R802  | R CEMENT            | RX10T109KS | 10W 1 OHM K TRIPOD SMALL  | PTMPMSJ936 |             |
| R802  | R CEMENT            | RX10T229KS | 10W 2.2 OHM K TRIPOD SMAL |            | PTMPMSJ938  |
| R805  | R CARBON FILM       | RD-2Z242J- | 1/2 2.4K OHM J            | PTMPJAJ936 |             |
| R805  | R CARBON FILM       | RD-2Z272J- | 1/2 2.7K OHM J            |            | PTMPJAJ938  |
| R807  | R CARBON COMP       | RC-2Z565KP | 1/2 5.6M OHM K            |            | PTMPJAJ938  |
| R823  | R M-OXIDE FILM      | RS02Z223JS | 2W 22K OHM J SMALL        | PTMPJB936  |             |
| R823  | R M-OXIDE FILM      | RS02Z153JS | 2W 15K OHM J SMALL        |            | PTMPJB938   |
| R825  | R METAL FLAT        | RM02Y108K- | 2W 0.1 OHM K              | PTMPMSJ936 |             |
| R825  | R METAL FLAT        | RM02Y158J- | 2W 0.15 OHM J             |            | PTMPMSJ938  |
| R831  | WIRE COPPER         | 85801065GY | AWG22 1/0.65 TIN COATING  | PTMPJAJ936 |             |
| R831  | R M-OXIDE FILM      | RS02Z153JS | 2W 15K OHM J SMALL        |            | PTMPJB938   |
| R832  | R CARBON FILM       | RD-4Z912J- | 1/4 9.1K OHM J            |            | PTMPJAJ938  |
| R888  | R CARBON COMP       | RC-2Z225KP | 1/2 2.2M OHM K            | PTMPJAJ936 |             |
| V901  | CRT                 | 4859635261 | A68QDL280X011(B) P45      | PTCACA948  |             |
| V901  | CRT                 | 4859635267 | A68QDL280X011(B) M16      |            | PTCACA950   |
| ZZ110 | ACCESSORY AS        | PTACPWJ936 | DTQ-29U8FC                | DTQ-29U8SC |             |
| ZZ110 | ACCESSORY AS        | PTACPWJ937 | DTQ-29U8FS                |            | DTQ-29U8SSP |
| ZZ120 | COVER BACK AS       | PTBCSHJ936 | DTQ-29U8FC                | DTQ-29U8SC |             |
| ZZ120 | COVER BACK AS       | PTBCSHJ904 | DTQ-29U8                  |            | DTQ-29U8SSP |
| ZZ131 | COIL DEGAUSSING     | 58G0000143 | DC-29S1                   | DTQ-29U8SC |             |
| ZZ131 | COIL DEGAUSSING     | 58G0000145 | DC-29S2                   |            | DTQ-29U8SSP |
| ZZ140 | CABINET AS          | PTCACA948  | DTQ-29U8SC                | DTQ-29U8SC |             |
| ZZ140 | CABINET AS          | PTCACA950  | DTQ-29U8SSP               |            | DTQ-29U8SSP |
| ZZ200 | MASK FRONT AS       | PTFMSJJ936 | DTQ-29U8FC                | PTCACA948  |             |
| ZZ200 | PCB MAIN M-10 AS    | PTMPJB936  | DTQ-29U8FC                | PTMPJ0J936 |             |
| ZZ200 | PCB MAIN (RHU) AS   | PTMPJ0J936 | DTQ-29U8FC                | PTMPJ2J936 |             |
| ZZ200 | PCB MAIN RADIAL AS  | PTMPJR936  | DTQ-29U8FC                | PTMPJB936  |             |
| ZZ200 | PCB MAIN AXIAL AS   | PTMPJAJ936 | DTQ-29U8FC                | PTMPJR936  |             |
| ZZ200 | PCB CHIP MOUNT B AS | PTMPJ2J936 | DTQ-29U8FC                | PTMPMSJ936 |             |
| ZZ200 | MASK FRONT AS       | PTFMSJJ938 | DTQ-29U8FSP               |            | PTCACA950   |
| ZZ200 | PCB MAIN M-10 AS    | PTMPJB938  | DTQ-29U8FSP               |            | PTMPJ0J938  |
| ZZ200 | PCB MAIN (RHU) AS   | PTMPJ0J938 | DTQ-29U8FSP               |            | PTMPJ2J938  |
| ZZ200 | PCB MAIN RADIAL AS  | PTMPJR938  | DTQ-29U8FSP               |            | PTMPJB938   |
| ZZ200 | PCB MAIN AXIAL AS   | PTMPJAJ938 | DTQ-29U8FSP               |            | PTMPJR938   |
| ZZ200 | PCB CHIP MOUNT B AS | PTMPJ2J938 | DTQ-29U8FSP               |            | PTMPMSJ938  |
| ZZ290 | PCB MAIN MANUAL AS  | PTMPMSJ936 | DTQ-29U8FC                | PTCACA948  |             |
| ZZ290 | PCB MAIN MANUAL AS  | PTMPMSJ938 | DTQ-29U8FSP               |            | PTCACA950   |

# EXPLODED VIEW

| REV | LIST OF MODIFICATION | REASON OF MODIFICATION | DATE | NAME | APPROV |
|-----|----------------------|------------------------|------|------|--------|
| 1   |                      |                        |      |      |        |

R485009HA

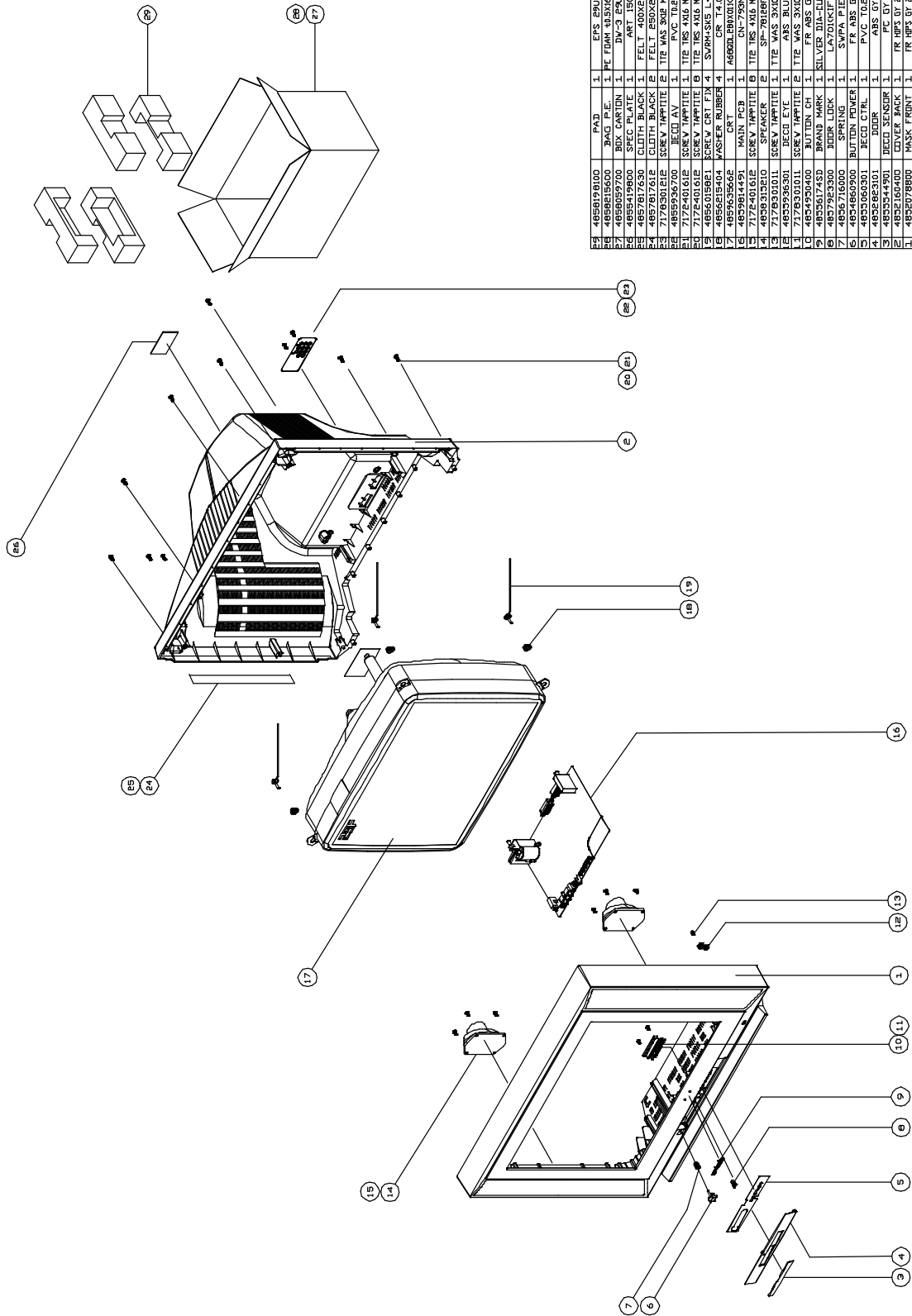

| NO | PART CODE  | PART NAME   | QTY | MATERIAL              | REMARKS |
|----|------------|-------------|-----|-----------------------|---------|
| 1  | 4850090100 | PAD         | 1   | EPS 50LB              |         |
| 2  | 4850090101 | BOX P.E.    | 1   | PE TDM 30.5X1500X1278 |         |
| 3  | 4850090102 | BOX CARTON  | 1   | DW-C-6 PMB            |         |
| 4  | 4850090103 | SPEC PLATE  | 1   | ART 150               |         |
| 5  | 4850090104 | CLOTH BLACK | 1   | FELT 400X200X0.7      |         |
| 6  | 4850090105 | CLOTH BLACK | 1   | FELT 500X200X0.7      |         |
| 7  | 4850090106 | SCREW TORX  | 1   | T10 TORX 4X6 N7ZN BK  |         |
| 8  | 4850090107 | SCREW TORX  | 1   | T10 TORX 4X6 N7ZN BK  |         |
| 9  | 4850090108 | SCREW TORX  | 1   | T10 TORX 4X6 N7ZN BK  |         |
| 10 | 4850090109 | SCREW TORX  | 1   | T10 TORX 4X6 N7ZN BK  |         |
| 11 | 4850090110 | SCREW TORX  | 1   | T10 TORX 4X6 N7ZN BK  |         |
| 12 | 4850090111 | SCREW TORX  | 1   | T10 TORX 4X6 N7ZN BK  |         |
| 13 | 4850090112 | SCREW TORX  | 1   | T10 TORX 4X6 N7ZN BK  |         |
| 14 | 4850090113 | SCREW TORX  | 1   | T10 TORX 4X6 N7ZN BK  |         |
| 15 | 4850090114 | SCREW TORX  | 1   | T10 TORX 4X6 N7ZN BK  |         |
| 16 | 4850090115 | SCREW TORX  | 1   | T10 TORX 4X6 N7ZN BK  |         |
| 17 | 4850090116 | SCREW TORX  | 1   | T10 TORX 4X6 N7ZN BK  |         |
| 18 | 4850090117 | SCREW TORX  | 1   | T10 TORX 4X6 N7ZN BK  |         |
| 19 | 4850090118 | SCREW TORX  | 1   | T10 TORX 4X6 N7ZN BK  |         |
| 20 | 4850090119 | SCREW TORX  | 1   | T10 TORX 4X6 N7ZN BK  |         |
| 21 | 4850090120 | SCREW TORX  | 1   | T10 TORX 4X6 N7ZN BK  |         |
| 22 | 4850090121 | SCREW TORX  | 1   | T10 TORX 4X6 N7ZN BK  |         |
| 23 | 4850090122 | SCREW TORX  | 1   | T10 TORX 4X6 N7ZN BK  |         |
| 24 | 4850090123 | SCREW TORX  | 1   | T10 TORX 4X6 N7ZN BK  |         |
| 25 | 4850090124 | SCREW TORX  | 1   | T10 TORX 4X6 N7ZN BK  |         |
| 26 | 4850090125 | SCREW TORX  | 1   | T10 TORX 4X6 N7ZN BK  |         |
| 27 | 4850090126 | SCREW TORX  | 1   | T10 TORX 4X6 N7ZN BK  |         |
| 28 | 4850090127 | SCREW TORX  | 1   | T10 TORX 4X6 N7ZN BK  |         |
| 29 | 4850090128 | SCREW TORX  | 1   | T10 TORX 4X6 N7ZN BK  |         |

| UNITS | mm | inch | SAVED | SCALE | DATE | MODEL | DEVELOPMENT | DWG-25 | REVISION | REFERENCE |
|-------|----|------|-------|-------|------|-------|-------------|--------|----------|-----------|
| 1     |    |      |       |       |      |       |             |        |          |           |

EXPLODED VIEW

| REV | LIST OF MODIFICATION | REASON OF MODIFICATION | DATE | NAME | APPR |
|-----|----------------------|------------------------|------|------|------|
| A   |                      |                        |      |      |      |
| A   |                      |                        |      |      |      |

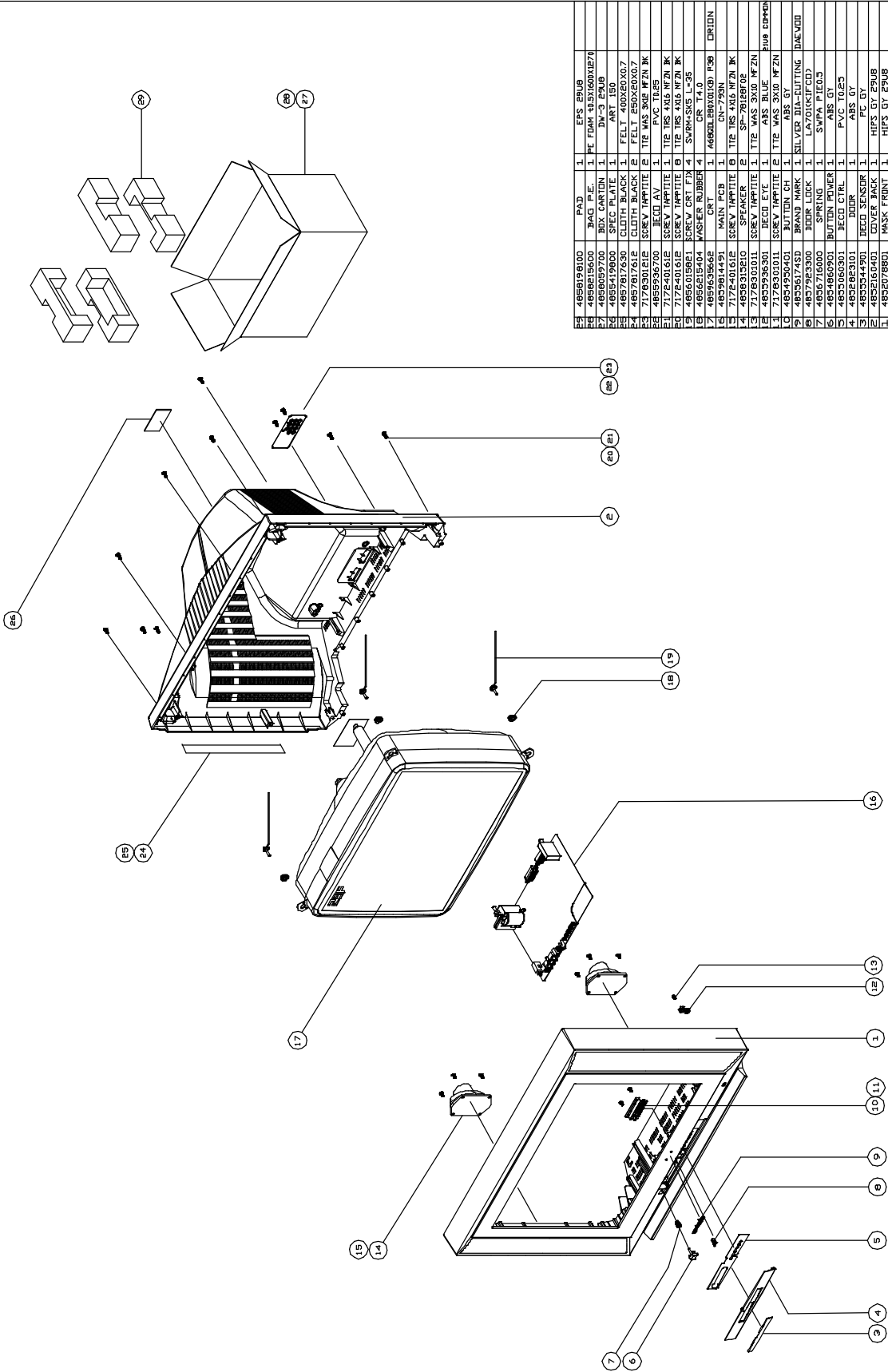

|    |             |                |   |                           |            |
|----|-------------|----------------|---|---------------------------|------------|
| 1  | 4856191000  | PAD            | 1 | ERS 8019                  |            |
| 2  | 4856215600  | BAG P.E.       | 1 | PE FDM 48562000278        |            |
| 3  | 4856059700  | BOX CARTON     | 1 | DW-3 E208                 |            |
| 4  | 4855419600  | SPEC PLATE     | 1 | ART 150                   |            |
| 5  | 4857817630  | CLOTH BLACK    | 1 | FELT 400X200X0.7          |            |
| 6  | 4857817612  | CLOTH BLACK    | 2 | FELT 250X200X0.7          |            |
| 7  | 7172301212  | SCREW TAPITITE | 2 | T12 WAS 3X6 HFZN BK       |            |
| 8  | 7172301212  | SCREW TAPITITE | 2 | T12 WAS 3X6 HFZN BK       |            |
| 9  | 7172401612  | SCREW TAPITITE | 1 | T12 TIS 4X6 HFZN BK       |            |
| 10 | 7172401612  | SCREW TAPITITE | 2 | T12 TIS 4X6 HFZN BK       |            |
| 11 | 48556015961 | SCREW CRT FIX  | 4 | SVARMAS L=35              |            |
| 12 | 4855615404  | WASHER RUBBER  | 4 | CR T4.0                   |            |
| 13 | 4859635662  | CRT            | 1 | A6900189001009 P96        | ORION      |
| 14 | 48559814491 | MAIN PCB       | 1 | ON-725N                   |            |
| 15 | 48559814491 | SCREW TAPITITE | 2 | T12 WAS 3X10 HFZN BK      |            |
| 16 | 4856313210  | SPEAKER        | 2 | SP-7818R02                |            |
| 17 | 7178310311  | SCREW TAPITITE | 2 | T12 WAS 3X10 HFZN         |            |
| 18 | 4855936301  | DECO EYE       | 1 | ABS BLUE                  | PHO DESIGN |
| 19 | 7178310311  | SCREW TAPITITE | 2 | T12 WAS 3X10 HFZN         |            |
| 20 | 4854959401  | BUTTON GH      | 1 | ABS GY                    |            |
| 21 | 485551745D  | BRAND MARK     | 1 | SILVER DIA-LEUTING DIAVOD |            |
| 22 | 485551745D  | BRAND MARK     | 1 | SILVER DIA-LEUTING DIAVOD |            |
| 23 | 4856313210  | SCREW TAPITITE | 1 | SVPA P1E03                |            |
| 24 | 4854860901  | BUTTON POWER   | 1 | ABS GY                    |            |
| 25 | 4855060301  | DECO CTRL      | 1 | PVC TO.25                 |            |
| 26 | 4852823101  | DOOR           | 1 | ABS GY                    |            |
| 27 | 4855944901  | DECO SENSOR    | 1 | PC GY                     |            |
| 28 | 4852816401  | COVER BACK     | 1 | HPS GY E208               |            |
| 29 | 4852816401  | COVER FRONT    | 1 | HPS GY E208               |            |

| NO | PART CODE   | PART NAME      | QTY | MATERIAL                  | REMARKS    |
|----|-------------|----------------|-----|---------------------------|------------|
| 1  | 4856191000  | PAD            | 1   | ERS 8019                  |            |
| 2  | 4856215600  | BAG P.E.       | 1   | PE FDM 48562000278        |            |
| 3  | 4856059700  | BOX CARTON     | 1   | DW-3 E208                 |            |
| 4  | 4855419600  | SPEC PLATE     | 1   | ART 150                   |            |
| 5  | 4857817630  | CLOTH BLACK    | 1   | FELT 400X200X0.7          |            |
| 6  | 4857817612  | CLOTH BLACK    | 2   | FELT 250X200X0.7          |            |
| 7  | 7172301212  | SCREW TAPITITE | 2   | T12 WAS 3X6 HFZN BK       |            |
| 8  | 7172301212  | SCREW TAPITITE | 2   | T12 WAS 3X6 HFZN BK       |            |
| 9  | 7172401612  | SCREW TAPITITE | 1   | T12 TIS 4X6 HFZN BK       |            |
| 10 | 7172401612  | SCREW TAPITITE | 2   | T12 TIS 4X6 HFZN BK       |            |
| 11 | 48556015961 | SCREW CRT FIX  | 4   | SVARMAS L=35              |            |
| 12 | 4855615404  | WASHER RUBBER  | 4   | CR T4.0                   |            |
| 13 | 4859635662  | CRT            | 1   | A6900189001009 P96        | ORION      |
| 14 | 48559814491 | MAIN PCB       | 1   | ON-725N                   |            |
| 15 | 48559814491 | SCREW TAPITITE | 2   | T12 WAS 3X10 HFZN BK      |            |
| 16 | 4856313210  | SPEAKER        | 2   | SP-7818R02                |            |
| 17 | 7178310311  | SCREW TAPITITE | 2   | T12 WAS 3X10 HFZN         |            |
| 18 | 4855936301  | DECO EYE       | 1   | ABS BLUE                  | PHO DESIGN |
| 19 | 7178310311  | SCREW TAPITITE | 2   | T12 WAS 3X10 HFZN         |            |
| 20 | 4854959401  | BUTTON GH      | 1   | ABS GY                    |            |
| 21 | 485551745D  | BRAND MARK     | 1   | SILVER DIA-LEUTING DIAVOD |            |
| 22 | 485551745D  | BRAND MARK     | 1   | SILVER DIA-LEUTING DIAVOD |            |
| 23 | 4856313210  | SCREW TAPITITE | 1   | SVPA P1E03                |            |
| 24 | 4854860901  | BUTTON POWER   | 1   | ABS GY                    |            |
| 25 | 4855060301  | DECO CTRL      | 1   | PVC TO.25                 |            |
| 26 | 4852823101  | DOOR           | 1   | ABS GY                    |            |
| 27 | 4855944901  | DECO SENSOR    | 1   | PC GY                     |            |
| 28 | 4852816401  | COVER BACK     | 1   | HPS GY E208               |            |
| 29 | 4852816401  | COVER FRONT    | 1   | HPS GY E208               |            |

4850091A

# PRINTED CIRCUIT BOARD

## U-COM (I701)

### DW863240V-RA1

|                |    |          |               |    |                       |
|----------------|----|----------|---------------|----|-----------------------|
| SYS1 (H)       | 1  | P10      | P07           | 42 | POWER ON(H)           |
| Write Protect  | 2  | P11      | P06           | 41 | Degaussing SW         |
| V-Chip         | 3  | P12      | P05           | 40 | AUDIO MUTE(H)         |
| AV S/W1        | 4  | P13/PWM1 | P04           | 39 | Timer LED             |
| 3-SYS          | 5  | P14/PWM2 | P03           | 38 | MSP RESET             |
| AV S/W2        | 6  | P15/PWM3 | P02           | 37 | H.OUT<br>ON(L)/OFF(H) |
| SYS2           | 7  | P16      | P01           | 36 | POWER ON              |
| AV S/W3        | 8  | P17/PWM  | P00           | 35 | ST-BY(H)              |
| Vss            | 9  | VSS      | P73/INT3/TOIN | 34 | REMOCON IN            |
| XT1            | 10 | XT1      | P72/INT2/TOIN | 33 | GND                   |
| XT2            | 11 | XT2      | P71/INT1      | 32 | X-RAY                 |
| VDD            | 12 | VDD      | P70/INT0      | 31 | NC                    |
| KEY IN         | 13 | P84/AN4  | P63/SCLK1     | 30 | T-CLOCK               |
| AFT IN         | 14 | P85/AN5  | P62/SDA1      | 29 | T-DATA                |
| AGC IN         | 15 | P86/AN6  | P61/SCLK0     | 28 | M-CLOCK               |
| Digital Sensor | 16 | P87/AN7  | P60/SDA0      | 27 | M-DATA                |
| RESET          | 17 | RES      | I             | 26 | H-T                   |
| FILTER         | 18 | FILT     | BL            | 25 | BL                    |
| CVBS           | 19 | CVIN     | B             | 24 | B                     |
| V Sync         | 20 | VS       | G             | 23 | G                     |
| H Sync         | 21 | HS       | R             | 22 | R                     |

- X'TAL : 32.768 KHz

| NO | PIN | PIN NAME       | DESCRIPTION ( LEVEL )                 |
|----|-----|----------------|---------------------------------------|
| 1  | 1   | SYS 1          | "L"                                   |
| 2  | 2   | WRITE PROTECT  | NC                                    |
| 3  | 3   | V-CHIP         | +5V                                   |
| 4  | 4   | AV S/W1        | I504 #6                               |
| 5  | 5   | 3-SYS          | NC                                    |
| 6  | 6   | AV S/W2        | I504 #8                               |
| 7  | 7   | SYS2           | "L"                                   |
| 8  | 8   | AV S/W3        | I502 #2, #15                          |
| 9  | 9   | Vss            | GND                                   |
| 10 | 10  | XT1            | 32.768KHz                             |
| 11 | 11  | XT2            | 32.768KHz                             |
| 12 | 12  | Vdd            | +5V                                   |
| 13 | 13  | KEY IN         | SW702~707                             |
| 14 | 14  | AFT IN         | I501 #55                              |
| 15 | 15  | AGC IN         | TU01, I501 #8                         |
| 16 | 16  | DIGITAL SENSOR | NC                                    |
| 17 | 17  | RESET          | RESET ACTIVE "L"                      |
| 18 | 18  | FILTER         | FILTER                                |
| 19 | 19  | CVBS           | I502 #12                              |
| 20 | 20  | VS             | I301 #7                               |
| 21 | 21  | HS             | I501 #30                              |
| 22 | 22  | R              | I501 #16                              |
| 23 | 23  | G              | I501 #17                              |
| 24 | 24  | B              | I501 #18                              |
| 25 | 25  | BL             | I501 #15                              |
| 26 | 26  | H-T            | NC                                    |
| 27 | 27  | MSP-DATA       | I601 #8                               |
| 28 | 28  | MSP-CLOCK      | I601 #7                               |
| 29 | 29  | T-DATA         | TU01, I501 #35                        |
| 30 | 30  | T-CLOCK        | TU01, I501 #34                        |
| 31 | 31  | NC             | NC                                    |
| 32 | 32  | XRAY           | ACTIVE "H", NORMAL: "L"               |
| 33 | 33  | GND            | GND                                   |
| 34 | 34  | REMOCON IN     | IF01                                  |
| 35 | 35  | STAND-BY       | NC                                    |
| 36 | 36  | PWR ON         | +5V                                   |
| 37 | 37  | H-OUT          | I804 SW(PQ09RF11)                     |
| 38 | 38  | MSP-RESET      | I601 #20 ACTIVE "L"                   |
| 39 | 39  | TIMER LED      | NC                                    |
| 40 | 40  | AUDIO MUTE     | I602 #10                              |
| 41 | 41  | Degaussing sw  | Q813 BASE (TO RELAY) Degaussing : "H" |
| 42 | 42  | PWR ON         | Q804 BASE(TO STR-F6656) TV ON : "H"   |

# CHIP COMPONENTS POSITION

## Appendix

### \*\*PCB MAIN

| N0 | L/C   | X         | Y        | ORIENT | N0 | L/C   | X      | Y      | ORIENT |
|----|-------|-----------|----------|--------|----|-------|--------|--------|--------|
| 1  | CC666 | 238.99985 | 63.2498  | 90     | 43 | CC635 | 256    | 54.25  | 270    |
| 2  | CC645 | 215.09985 | 39.6498  | 270    | 44 | CC646 | 208.5  | 41.75  | 90     |
| 3  | RC632 | 259.5     | 15       | 180    | 45 | RC630 | 259.5  | 11.5   | 180    |
| 4  | RC639 | 242.5     | 15.5     | 270    | 46 | RC321 | 183.75 | 53     | 90     |
| 5  | CC629 | 244.75    | 15.5     | 90     | 47 | RC322 | 181    | 53     | 90     |
| 6  | RC640 | 242.5     | 11       | 90     | 48 | RC318 | 188.75 | 55.25  | 90     |
| 7  | CC670 | 244.75    | 11       | 270    | 49 | RC317 | 186.25 | 53     | 90     |
| 8  | RC605 | 104.5     | 224.25   | 180    | 50 | CC716 | 214.39 | 231.27 | 270    |
| 9  | CC614 | 103.5     | 227      | 180    | 51 | CC455 | 189.5  | 22.25  | 270    |
| 10 | CC609 | 110.5     | 224.75   | 270    | 52 | RC604 | 230.5  | 106.4  | 90     |
| 11 | RC635 | 113       | 224.75   | 270    | 53 | RC651 | 278.5  | 88.75  | 180    |
| 12 | RC636 | 289.25    | 71.5     | 180    | 54 | CC579 | 278.75 | 137.25 | 270    |
| 13 | RC699 | 294.5     | 71.5     | 0      | 55 | CC521 | 281.25 | 137.25 | 270    |
| 14 | CC698 | 289.25    | 65.25    | 0      | 56 | CC713 | 211.75 | 205.75 | 90     |
| 15 | CC699 | 294.25    | 65.25    | 180    | 57 | RC508 | 307    | 151.5  | 270    |
| 16 | RC600 | 205.75    | 8        | 90     | 58 | RC642 | 311.75 | 67.25  | 270    |
| 17 | CC600 | 205.75    | 15.25    | 180    | 59 | RC506 | 311.75 | 168    | 180    |
| 18 | RC601 | 211.75    | 15       | 90     | 60 | CC573 | 297.25 | 128.75 | 270    |
| 19 | RC619 | 215       | 15       | 270    | 61 | CC574 | 295    | 128.75 | 270    |
| 20 | RC603 | 215       | 10.25    | 270    | 62 | RC201 | 302.25 | 172.75 | 180    |
| 21 | CC680 | 218.75    | 8.25     | 180    | 63 | RC503 | 276.5  | 137.25 | 270    |
| 22 | RC595 | 279.74985 | 128.7498 | 270    | 64 | RC509 | 283.5  | 137.25 | 270    |
| 23 | RC203 | 287.49985 | 17.2498  | 90     | 65 | CC541 | 301    | 137.25 | 270    |
| 24 | RC599 | 288       | 128.75   | 270    | 66 | RC210 | 284.5  | 175.5  | 180    |
| 25 | RC557 | 294       | 93.25    | 270    | 67 | RC500 | 291    | 171.5  | 270    |
| 26 | CC754 | 265.5     | 231.25   | 270    | 68 | RC501 | 295    | 172.75 | 0      |
| 27 | RC536 | 257.5     | 157      | 270    | 69 | RC209 | 302.25 | 175.75 | 0      |
| 28 | RC714 | 310.25    | 211.25   | 90     | 70 | RC101 | 308.5  | 58.25  | 180    |
| 29 | RC525 | 313.25    | 153.75   | 0      | 71 | CC101 | 305.25 | 98.75  | 0      |
| 30 | RC701 | 284       | 203.5    | 90     | 72 | CC103 | 300.75 | 109.25 | 0      |
| 31 | RC735 | 286.25    | 203.5    | 90     | 73 | CC104 | 301.5  | 116.75 | 270    |
| 32 | RC734 | 288.5     | 203.5    | 90     | 74 | CC105 | 311.75 | 108    | 270    |
| 33 | RC733 | 290.75    | 203.5    | 90     | 75 | RC102 | 302.25 | 102.5  | 90     |
| 34 | RC732 | 293       | 203.5    | 90     | 76 | RC103 | 299.75 | 102.5  | 90     |
| 35 | RC779 | 277.25    | 203.5    | 270    | 77 | RC104 | 309.25 | 103.25 | 270    |
| 36 | CC504 | 290.5     | 128.75   | 270    | 78 | RC105 | 300.75 | 106.5  | 180    |
| 37 | CC778 | 274.75    | 203.5    | 90     | 79 | RC106 | 309.25 | 108    | 90     |
| 38 | RC746 | 228.99985 | 239.4998 | 0      | 80 | RC107 | 299.25 | 116.75 | 90     |
| 39 | RC207 | 318.75    | 92.25    | 90     | 81 | RC574 | 283    | 115.5  | 90     |
| 40 | CC151 | 290.7     | 36.5     | 270    | 82 | RC550 | 255.25 | 167    | 0      |
| 41 | CC652 | 256.49985 | 62.9998  | 270    | 83 | RC551 | 246    | 105.5  | 90     |
| 42 | CC636 | 258.25    | 54.25    | 270    | 84 | RC216 | 300.25 | 71.5   | 0      |

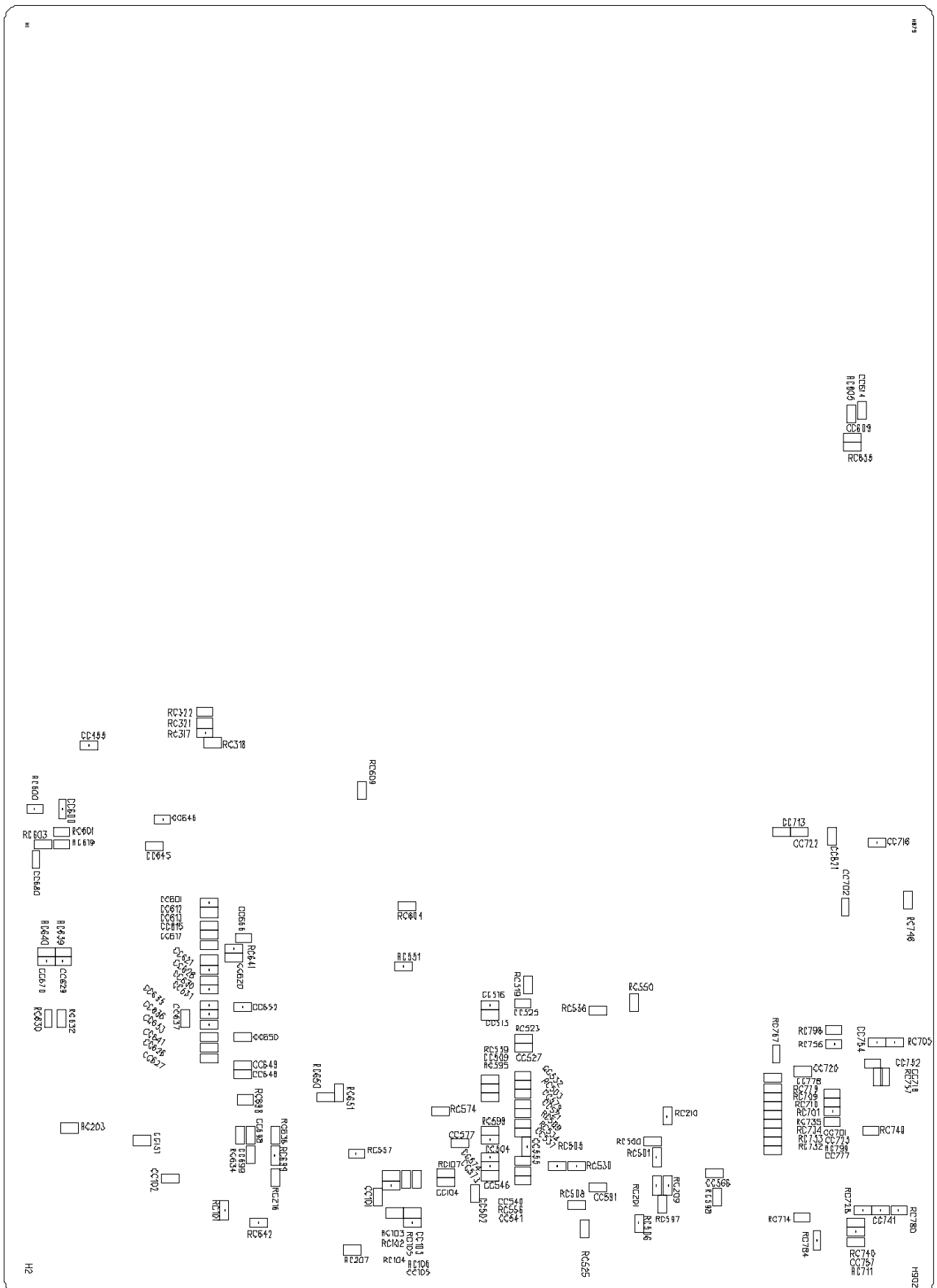





## 2. NO PICTURE

Check the waveform of I501 #54

NG : GO to the figure ©

OK : Go the figure ㉔

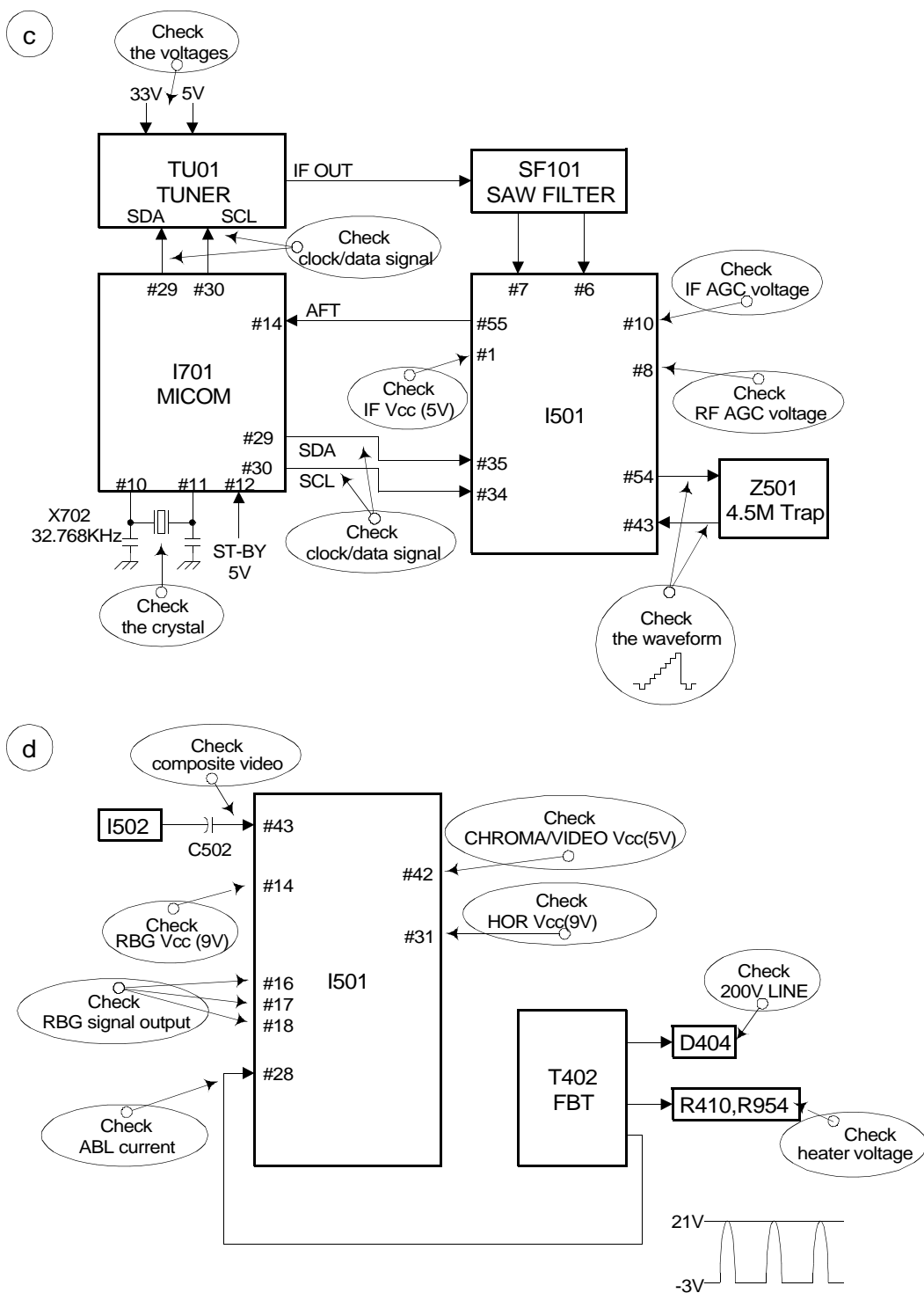

## 3. NO SOUND

Check audio output signal of I101 #1

NG : Go to the figure ⑤

OK : Go to the figure ⑥

e

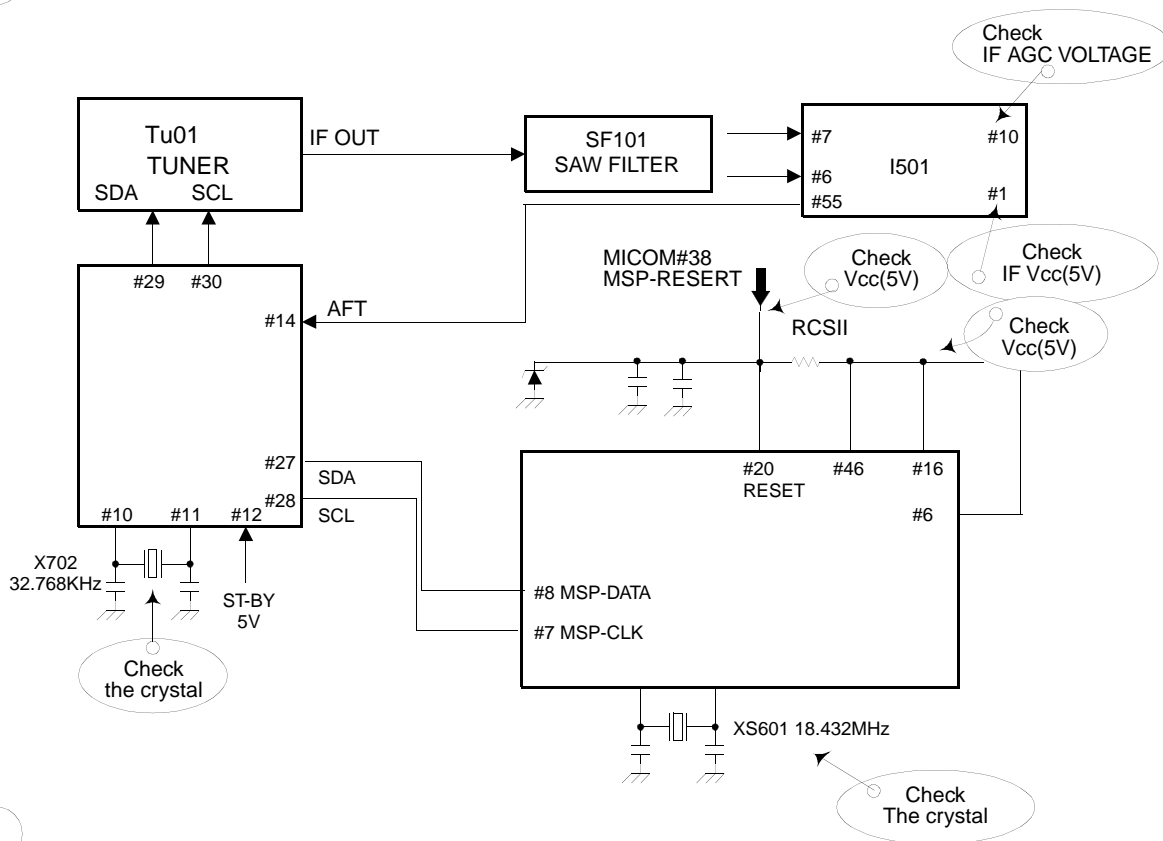

f

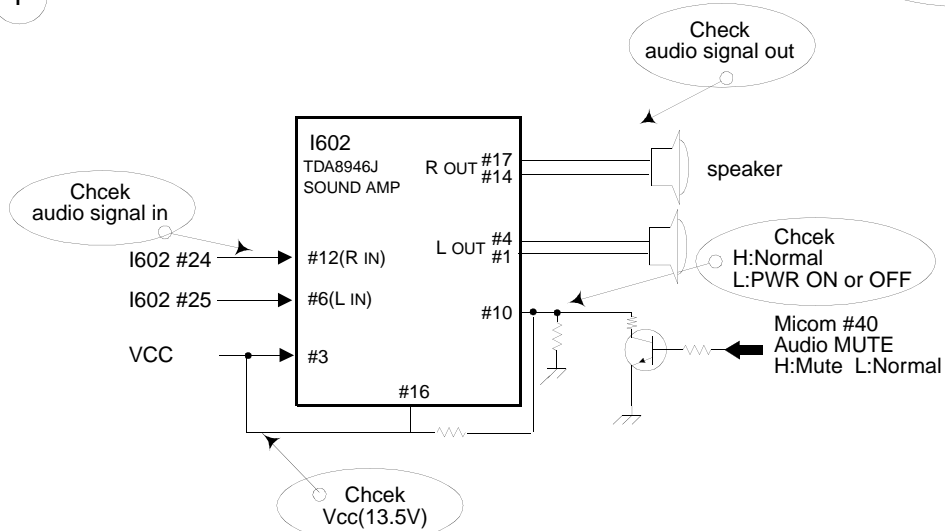

## 4. CH DON'T STOP

Check the input signal conditions

NG : Loss of signal or weak signal

OK : Go to the figure ⑨

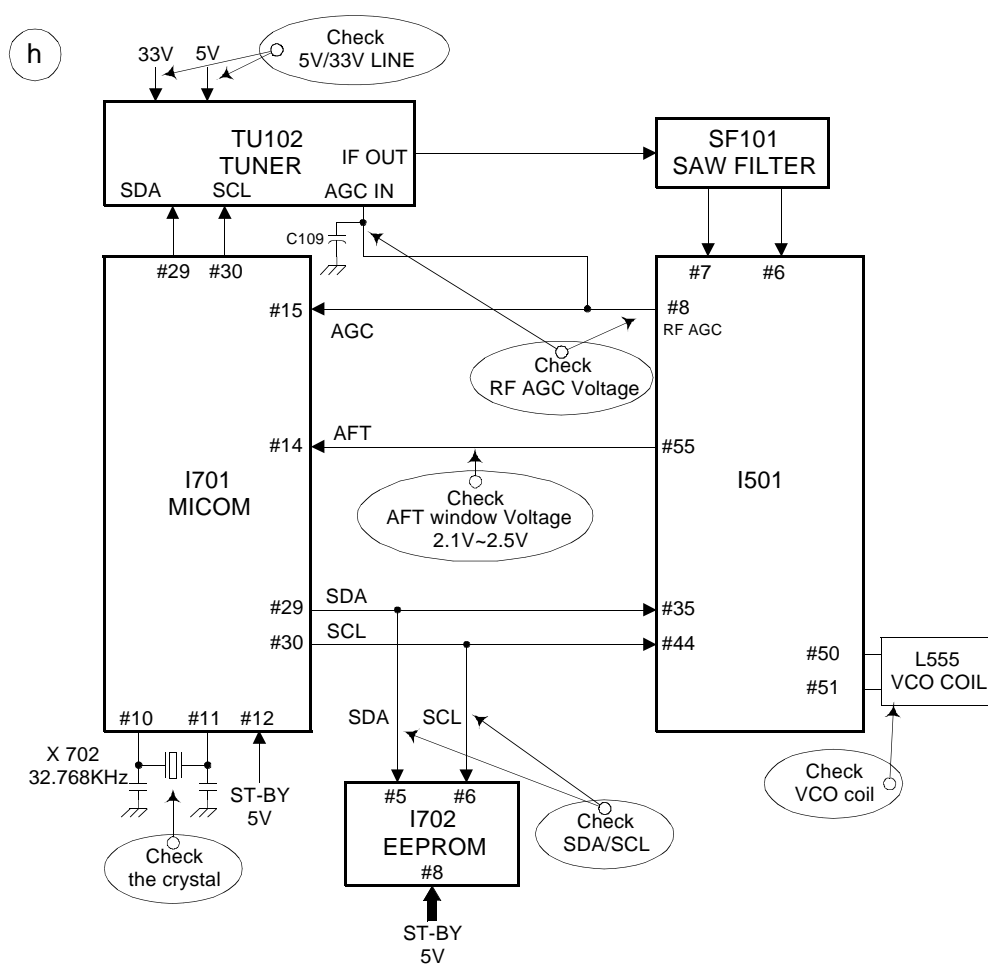

## 5. NO COLOR

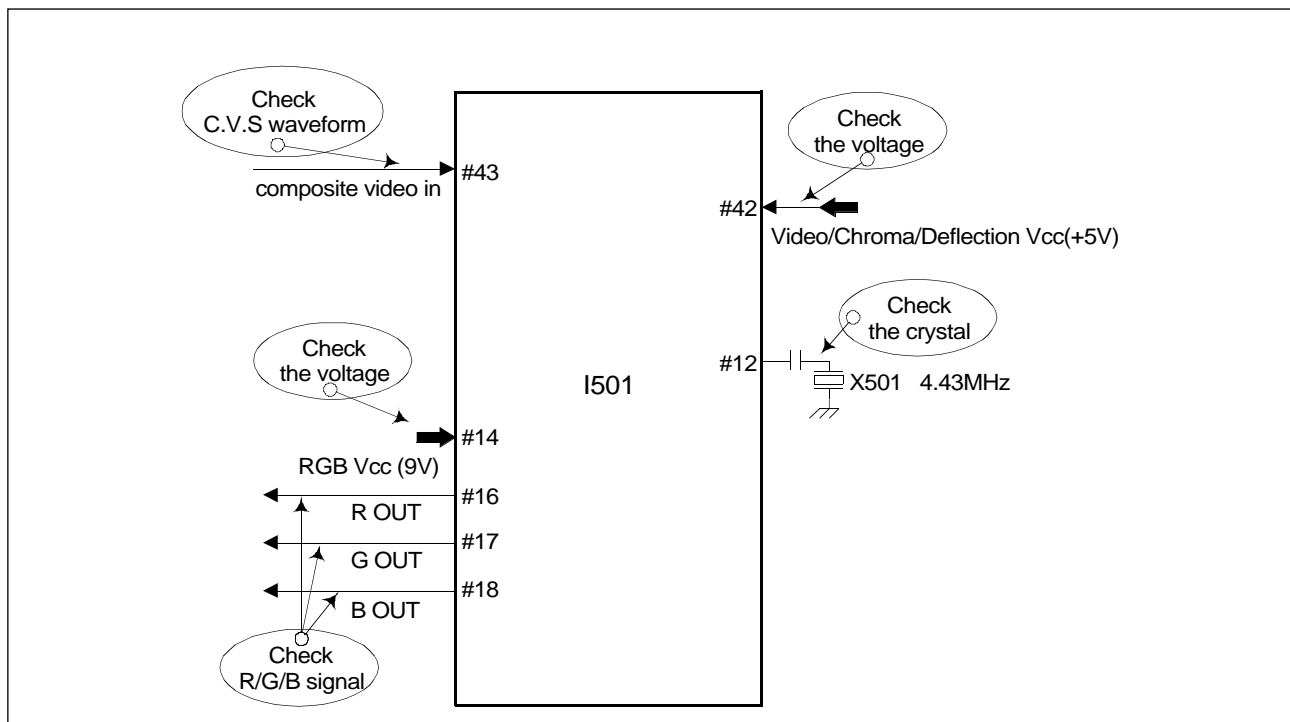

## 6. NO VERTICAL DEFLECTION

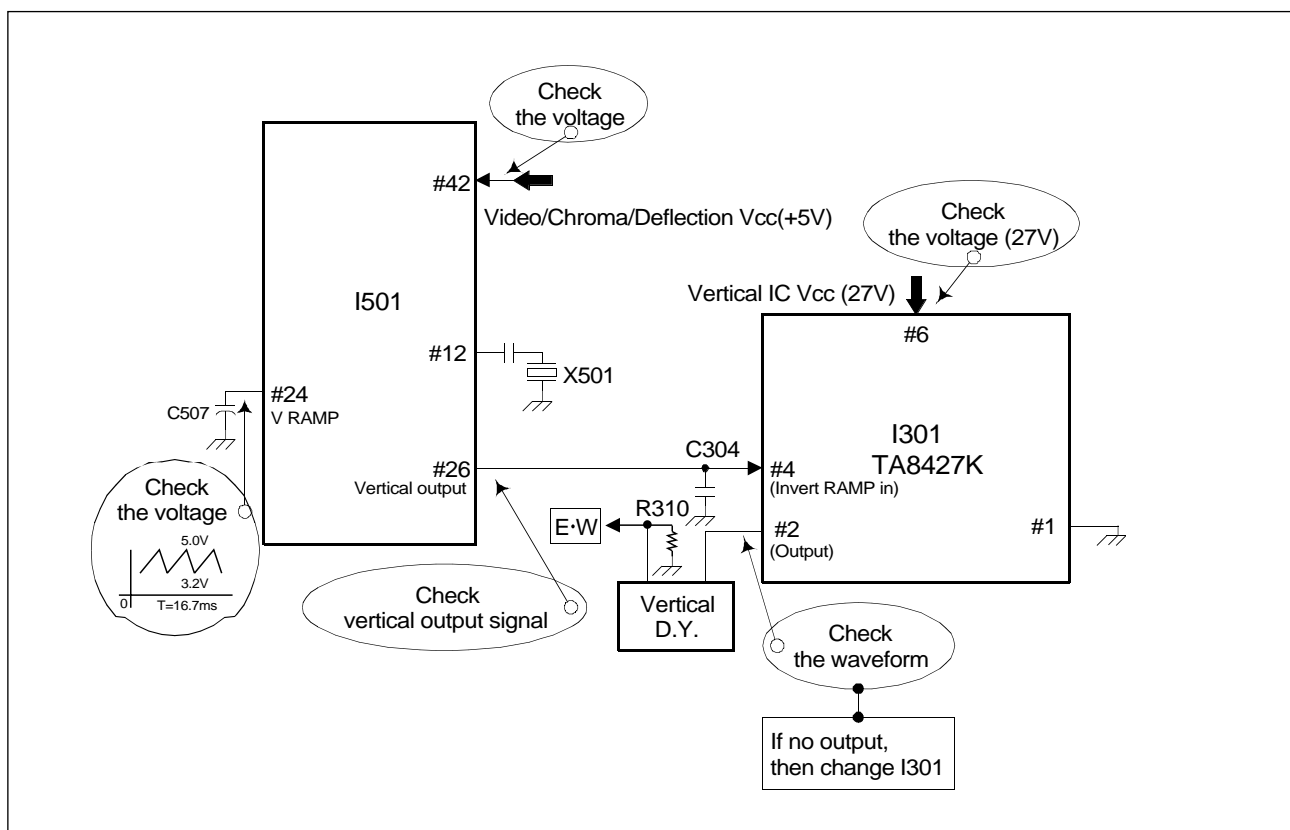

## 5. NO COLOR

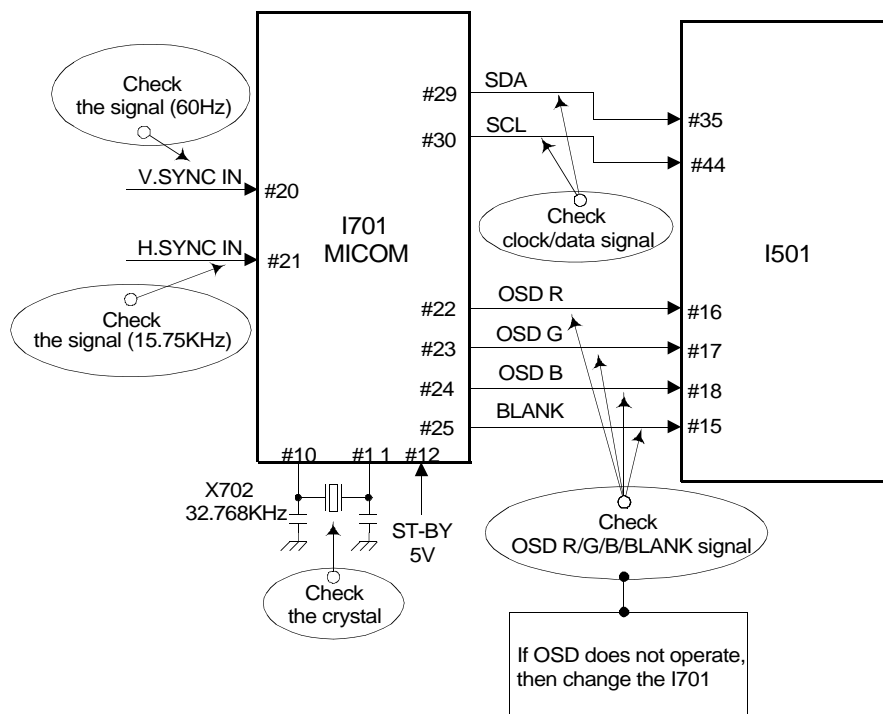

## 6. NO VERTICAL DEFLECTION

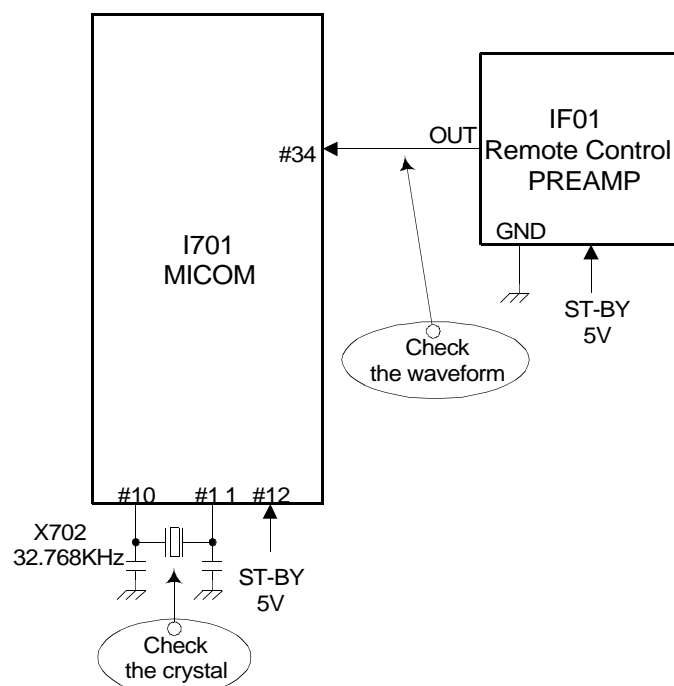

**DAEWOO**

**DAEWOO ELECTRONICS CO., LTD**

686, AHYEON-DONG MAPO-GU  
SEOUL, KOREA  
C.P.O. BOX 8003 SEOUL, KOREA  
TELEX : DWELEC K28177-8  
CABLE : "DAEWOOELEC"