

$$\{ \hat{A}^{\text{TM}} \hat{U}^{\text{TM}} \hat{a}^{\prime\prime} u_{\pm} \}$$

| | |
|---|--|
| o~ Q~ Q~ Q~ Q~ Q° Ö Ueg>CJCX | |
| .. x~ Q± f~ Q- u~ Q Ó RT1BAAg1FA@GAY' | |
| ©Û~ Q® ~ Q- u~ Q± çBCFh š ¢ š ™š cš - « i ¥ Q'' , ~ QCh | |
| ®_¤ î©Û® - u± ç± äBEH hy®®_ .. a ^š qš š š - š }šg¥W141B• BC š qš š š - š)š ¥ fYW14BD• GC š qš š š - š)š ¥ TReg14TBD• DI š qš š š - š)š ¥ | |
| š i lš †l~ l lš [l~ l š c~ lš - š i š †~ lš [~~lFŸt\$BcQ« âE • o | |
| £Ó~ Qª Ô~ Q©, ~ Q± ç Dh1~ 'lDh | |
| - Ì1ª È1™æ1~ 1º Q gYWlŠ qš œ~ lš l~ l® -lª È~ Q~~~~~ Á-È fYWiš qš œ~ lš l~ l® ~~~~~ Á-È TReglš qš œ~ lš l~ l® -lª È~ Q~~~~~ Á-È ª W™æ®k™l™æ1-lª È~~~~~ Á-È ª W™o™l¼™æ-lª È~~~~~ Á-È | |
| - ~ Q± ç~ Q- l~ Q'' „É« ¶ - ~~~~~ Bgf>f¶HF š Ð £óª Ô- ~~~~~ A?Fg...†@Ccl š Ðç á©ý d1É« ¶ ~ Q~ Q~ Q^SÖj~ QBgf>f¶HF Ð ~ Q~ Q~ Q^SÖj~ QA?Cl gf>fš , ~ lš i š xš HF<š Ð : | |
| ¤ ``~ Q q~ Qª »~ Q° Q HF?! 9~ . : • ~ QFQSA™TMf.: • ~ QE1Æ¶ S Ÿ:S | |
| £ ~ Q° ä~ Qª »~ Q° QFE?B 9~ . : • ~ QE1VSG™TMf.: • ~ QGH2Ge ¤ f ÝS | |
| ~ Q©u~ Q~ Q~ Q± ä DG Ý] | |
| - u Óš c~ lš y™æ- Ñ™Í C?B Ý V | |
| - ‡~ Q~ Q« È~ Q~ Q- z š ¢ š ™š cš - « ±ª ^¥Q~~~~~ Bš c -Æ ¤½-u~ ~~~~~ C š Rš - š vš lª ÈS ¤ ~~~~~ Bš c š }š H-n- "º y'' ~~~~~ B š c | |

[illegible]

š v š | š ...™ æ « ` ° ä

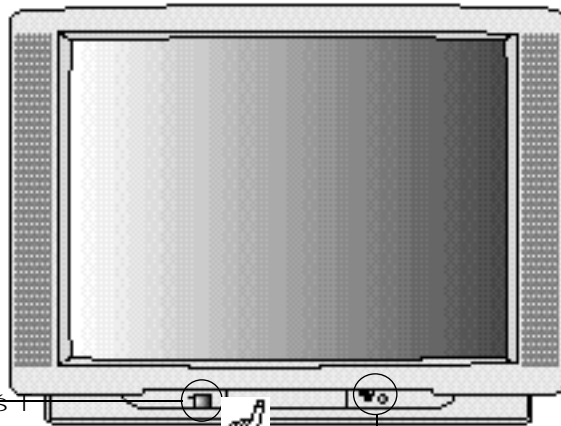

- u | 0 š i š o š - š, š i
 - m' Å š E š - š %™ Å © Ů™ Å™ p
 ™¼™ ™ Å™ Å™ ç š v š | š ... afdY™ß ° ' « æ š £ š - š %™ m' Å
 ° ' « æ™ æ - u | Ů™ - ™ ™ p U` ` c™ x [™ É™ p ~ V - u | 0 š i š o š - š, š T' m' Å š E š - š %
 ™ ç™ Ů™ ™ ™ S ™ ç™ Ů™ ™ ™

E 0 ± ä - lª ů š ' š o š -
 ~ V™ ½™ E 1 ™ Ń™ à E 0 ± ä™ Å« ŷ™ Å™ ç™ Å™ ~ R
 ~ Q™ ĺ™ E 1 ™ Ń™ à © Å™ ™ ç™ Å™ ™ ō™ Ń™ S
 ~ V E 0 ± ä™ Å« è E, ™ Ĩ™ p E ° ä™ æ š % š s š s _
 ~ Q™ m' Å™ Åª @™ ' ™ Å« . | Ů™ Ĩ™ ō™ Ń™ S

š ... š ŵ š Z D - ± ç - l'™
 š ... š ŵ š Z™ Ů š b™ Ĩ š - ™ Åª x [™ Ĩ™ Ů™ ō™ Ń™ S

š š š (š œ™ Ĩ š ' š o š -
 E 1 ™ Ń™ Ĩ™ Å™ Å š ~ š (š œ™ Ĩ
 E ° ä™ Å©, ™ ō™ Ń™ S

š q š š š - š) š ¥™ ĺ™ R™ ½ š ' š o š -
 ~ V™ ½™ E 1 ™ Ń™ à™ R B™ Å C™ Å D™ t™ t™ Å™
 ~ Q š q š š š - š) š ¥™ Åª ō™ x Ń™ ™ ™ ō™
 ~ V™ ĺ™ E 1 ™ Ń™ à™ R B C™ Å B B™ Å B A™ t™ t™
 ~ Q š q š š š - š) š ¥™ Åª ō™ x Ń™ ™ ™ ō™

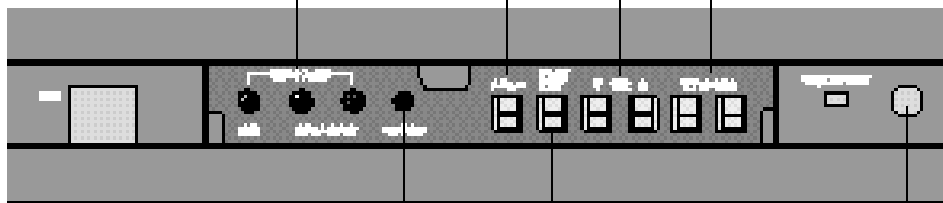

š Š š s š y š ' š - ™ Ĩ™
 š Š š s š y š ' š - ™ ™ Ů™ Å™ É™ Å™ i
 š Ĩ™ Ĩ š [™ Ĩ™ æ E 0™ Å© Ů™ Å™ R š Š š s
 š y š ' š - ™ Å™ ™ Ń™ É™ Å™ ō™ Ń™ S

š v š | š ... š ŵ š Z - lª ů š ' š o š - š x š ™ š c š - ™ Ĩ™
 ~ V š ... š ŵ š Z - ± ç - l'™ , ™ Å™ Ů™ Å™ Å™ ō™ š ŵ š Z
 ~ Q™ Ĩ™ Å™ Å™ Å™ Å™ - š ™ ß™ Ń™ S
 ~ V E 1 ™ Ń™ Ĩ™ Å™ Åª ō™ x Ń™ ™ ō™ Ń™ S

š vš | š ...TMæ | ý ° äTMàš ȡ š TMš

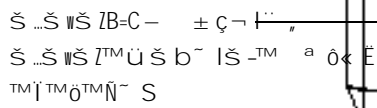

Š RŠ – Š VŠ \neg I'' //

a ® " ' š ' šoš =

TReg™æš pš Tš | š _š x« l¥á™ü š qš š š -š }š ¥

$$a \div \neg \quad \text{TM} \mathfrak{x}^{\text{TM}} \mathfrak{a}^{\text{TM}} \mathring{\mathbf{A}}^{\text{TM}} \mathfrak{x}^a \text{ (R) } \neg \} - \quad \pm \zeta^{\text{TM}} \mathfrak{a}^{\text{TM}} \mathfrak{a}^{\text{TM}} \quad \text{TM} \mathfrak{I}^{\text{TM}} \mathfrak{O}^{\text{TM}} \tilde{\mathbf{N}}^{\text{TM}} \text{ S}$$
[illegible]

š qš š š – š }š ¥ « Z¥ áš ' š oš –

š qš š š – š }š ¥™ š pš Tš | š _š x™ā« l¥™

Š Ŗ Š™Š cŠ – ®Ç| – ®

TM E TM æ ° ä TM Š v Š | Š ... ° ' « æ TM æ '' | - ®

$$| \quad {}^{\text{TM}}\dot{E}^{\text{TM}}p \ll -S \quad {}^{\text{TM}}\dot{I}^{\text{TM}}\ddot{O}^{\text{TM}}\ddot{N} \sim S$$

– u | 0š ' š oš –

$$^{\circ} \quad ' \quad \ll \quad \mathfrak{x}^{\text{TM}} \mathfrak{x} - \mathfrak{u} \mid \quad \acute{O}^{\text{TM}} \ddot{A} - \quad \text{TM} \hat{U}^{\text{TM}} \mathfrak{p}^{\text{TM}} \frac{1}{4}^{\text{TM}} \quad \text{TM} \grave{a}^{\text{TM}} \mathring{A}^{\text{TM}}$$
$${}^{\text{TM}}\ddot{E}^{\text{TM}}\mathfrak{z}\mathfrak{s}'\mathfrak{s}\mathfrak{o}\mathfrak{s}-{}^{\text{TM}}\beta-u|\mathfrak{o}^{\text{TM}}\mathfrak{x}-\sim V^a\mathfrak{o}^{\text{TM}}\ddot{A}$$
$$\S \, \dagger^{\text{TM}} \hat{a}^{\text{TM}} \hat{A}^{\text{TM}} \hat{O}^{\text{TM}} \tilde{N}^{\sim} \, S$$

š qš š š – š }š ¥š Rš sš %š pš Vš – š ’

$$^2 R \ll \ddot{E}^{TM} \dot{I}^{TM} p \dot{S} q \dot{S} \dot{S} \dot{S} - \dot{S} \dot{S} \ncong^{TM} \ddot{A}^- e^{TM} \dot{A}^{TM}$$
$${}^{\text{TM}}\ddot{O}{}^{\text{TM}}\check{N}^{\sim}S$$
$$\tilde{\sigma} \sim \tilde{S} \{ \tilde{S} \otimes \tilde{I} \in \tilde{\sigma} \tilde{a}^{\text{TM}} \tilde{\beta}^{\text{TM}} \tilde{\zeta} \tilde{\eta} \tilde{I}^a \tilde{E} \tilde{S} \tilde{\sigma}$$
$$\sim Q \ll l \ll$$

€ 0+ ä= Ĩ^a ùš ' š 0š -

$$\in \mathcal{O}^{\text{TM}} \mathfrak{a} \ll \ddot{y}^{\text{TM}} \mathring{A}^{\text{TM}} \mathring{I}^{\text{TM}} \mathring{A}^- \mathring{e}^{\text{TM}} \mathring{A}^{\text{TM}} \quad \text{TM} \quad \text{TM} \mathring{o}^{\text{TM}} \mathring{N}^- S$$
$$\sim \circ \check{S} \sim \check{S} \{ \check{S} \circ \check{S} \mid \in \circ \check{a}^{\text{TM}} \beta^{\text{TM}} \zeta \neg \check{I}^a \check{E} \check{S} - \circ$$
$$\sim Q_1 \oplus \dots \oplus \mathbb{F}^{\text{TM}} \oplus \dots \oplus \mathbb{F}$$

ŧ Őª Ő©ŪŸ" š 'š ős -

$$\in \mathcal{O}^{\text{TM}} \quad \mathbb{C} \quad \cdots \quad - \mathbb{Z}^{\text{TM}} \tilde{a} \odot \hat{\mathbb{U}}^{\text{TM}} \tilde{\mathbb{N}}^{\text{TM}} \tilde{a}^{\text{TM}} \tilde{\mathbb{A}} \in \mathbb{1}^{\text{TM}} \mathbb{I}^{\text{TM}} \mathbb{O}^{\text{TM}} \tilde{\mathbb{N}}$$

“ Ÿ @ ¯ μ @ š ™ š ~ š £ š ¥ š ’ š 0 š -

$$\in \mathcal{O}^a \quad \mathcal{O} - \mathcal{U} \pm v^{\text{TM}} \mathfrak{A} \ll l \ll \quad \text{TM} \quad \text{TM} \text{I}^{\text{TM}} \mathcal{O}^{\text{TM}} \tilde{\mathcal{N}} \sim S$$

š b̃ lš -š 'š oš -

$$\check{S} b^{-} | \check{S} - \mathbb{E} \quad {}^{\circ} \quad \check{a}^{\text{TM}} \bar{a}^a \quad \partial \propto \check{N}^{\text{TM}} \check{A}^{\text{TM}} \check{O}^{\text{TM}} \check{N}^{-} S$$

5

| —? | Š — Q° ò | š qš Wš sš — š 'š Tš — š x | — Ìª È Ü© | © ~ Q! © | — Ì1111ª È |
|----|---------------------------------|-------------------------------|-----------------------|------------------------------|---|
| E | cW>RXT | [AJD | SY© š™~ RXT—Ìª È | šy —ä© — « ± | B? — « ±ª ^š Ÿ™ Reo™β— uα V∓Ç— <™ GAuSš ä™ä™ä™ ~ Q!™ TM¾™ä™Ì™pª ^š Ÿ™Ň™ C?[AJD™äš Ìš gš Šš i š c~ Ìš %™ª ò« È™Ň™ D?SY© š™~ Ìš y™æRXT™äGD™ä™p[AJD™æ— uΦ Í ~ Q9° H?Dg~ @W™Ň™ E?RXT™ —Ìª È™Í© È™Ü™p— uΦ Í™Ä±™™Ü™ —ÌªæRXT™ Ì™ Q™ —Ìª È™Ň™ |
| F | ššhšoš¥ šŇ Ìš o | £ ° ä | SY© š™~ £« ¶ —Ìª È | šy —ä© — « ± | B?SY© š™~ Ìš y™æ£« ¶ —Ìª È™æ—Ì™ÄSY© ©, £Ň™ä— È™ Ì™ Qα ~ @W™Ň™ Ì™ Q9ª W™æ@k™ÍK<CC~ RE™™ÜK<Ì™ Rª W« αK<E: Ì™ Q~ª Ä@m£ « a™æ™x™Ü™ä±mSª™ä™Ç~ Šš i™Ň™™È™™ Ì™ Q™ Q™MOTM™ä™Ň™ C?SY© š™~ Ìš y£« ¶ —Ìª È™ SY© ©, £Ň™ä— È™D™ä—Ìª |
| G | ª™—0ª f~ ª™—0Çä~ ªœ~ xÇä~ | £ ° ä | SY© š™~ ª f~ —Ìª È | šy —ä© — « ± | B?—ä© — « ±™™ª ^™Ň™ C?£« ¶™™h©~© « Ì™ä™Ň™ D?SY© š™~ Ìš y™æª f~ —Ìª È™æ™™Rªœ™æ~ Ì™ Q™ —Ìª È™Íªœ™™ªœ™™Rªœ™æ~Ì™ä™ ~ Q™™¾™ä™Ň™ |
| H | ŠĐEVŠešTšj š,š Èš'~ Ìš È | £ ° ä | cECE=lcECG | š_šŠš i š Èššš <™™ª ^š Ÿ™ | B?cECE™ªœ~x`%v..ldtr€™ÄBA6™ä™ä™™™¾™ä Ì™ Q—Ìª È™Ň™ C?cECE™ £ ° äEV—Ì™Ä™ª FAŸ Q™æ©™ª™Ä™ö™Ü™Ň™ Ì™ Q™ä™™™¾™ä—Ìª È™Ň™ |
| I | £ü—u±Æ š%ššš vš_š o —Èš | | bIAF | —ä© — « ± | B?—ä© — « ±™™ª ^™Ň™ C?bIAF™æš<~ Ìš Ì™äX_U™æª Ì™äBChlI CA\šD™æ— Šc Ì™ Q™ª ò« È™Ň™ D?š%ššš vš_š o™Ä—Èš™Ÿ~ R~ Šc™™™Í™p™Ü—Èš Ì™ Q™¾™™È™ä™™α ~ @W™Ň™ E?šp™è™Ÿ—u! Őš i š Tššš q™™Ww`_™ä™Í~ RE« ¶™äÈ0 Ì™ Qª Í©™β™MOTM™È™ä™™α ~ @W™Ň™ |
| J | š™ÇÍ š%ššš vš_š o —Èš | | cFCE | —ä© — « ± | B?—ä© — « ±™™ª ^™Ÿ~ RE« ¶™ ŠB©Æ™ä™Ň™ C?cFCE™äBChIFB\šD™™Ü±ª ò« È™Ň™ D?Eª ä™ÄÇŸ™Ç™ä™™RS™ÇÍš%ššš vš_š o™Ä—Èš™Ÿ™ Ì™ Qα ~ @W™Ň™ E?™Ÿ—u! Őš i š Tššš q™™Ww`_™ä™Í~ RE« ¶™äÈ0™Ä Ì™ Qª Í©™β™MOTM™È™ä™™α ~ @W™Ň™ |

$$\neg \exists^a \tilde{E}^- \quad \circ \quad Q$$

UegCJcXTMaTMATM_¼p~ Ršŕshšoş¥ş%šŠSYKšssTMXššŞgşy«TMÄTMS ©¶TMiTMPTM_¼öNTM- S
©nTM_¼oTMiTMpşe- lš...si«êÊşş8TMTİSŞç-R' x±fTMiTMpE0¥jTMæ° QäTM şŕshšoş¥ş
9SY© šTMbYi.TMöNTM- S

[illegible]
$$\begin{aligned} & \mathfrak{oe} \mathfrak{Q} \mathfrak{S} \propto \mathfrak{S}^{\text{TM}} \mathfrak{S} \mathfrak{c} \mathfrak{S} - \text{TM} \mathfrak{a} \sim \mathfrak{S} \sim \mathfrak{S} \{ \mathfrak{S} \mathfrak{oe} \sim \text{I} \sim \mathfrak{e}^{\text{TM}} \} \mathfrak{B} \mathfrak{E} \sim \text{TM} \mathfrak{A}^{\text{TM}} \mathfrak{N} \\ & \mathfrak{oe} \mathfrak{R} - \mathfrak{u} \mid \mathfrak{O}^{\text{TM}} \mathfrak{a} \mathfrak{o}^{\text{TM}} \sim \text{TM} \mathfrak{a} \mathfrak{E} \mathfrak{C} \mathfrak{I} \text{TM} \mathfrak{I}^{\text{TM}} \sim \text{TM} \mathfrak{o}^{\text{TM}} \mathfrak{N} \end{aligned}$$

| | | | | | |
|----------------------------------|--|---|---|--|---|
| <p> $_?$ </p> | <p> $\mathbb{S} \sim \mathbb{Q}^\circ \hat{o}$ </p> | <p> $\mathbb{S} \mathbb{q} \mathbb{S} \mathbb{W} \mathbb{s} \mathbb{s} _$ $\mathbb{S} \text{' } \mathbb{S} \mathbb{T} \mathbb{S} _ \mathbb{S} \mathbb{x}$ </p> | <p> $_ \mathbb{I}^a \mathbb{E} \mathbb{I} \mathbb{U} \mathbb{C} \mathbb{D}$ </p> | <p> $\mathbb{C} _ \sim \mathbb{Q} \mathbb{I} \mathbb{C}$ </p> | <p> $_ \mathbb{I} \mathbb{I} \mathbb{I} \mathbb{I}^a \mathbb{E}$ </p> |
| <p> \mathbb{B} </p> | <p> $\mathbb{g} \mathbb{T} \text{' } \mathbb{S} \mathbb{C} \mathbb{S} \mathbb{T} \mathbb{S} \mathbb{Y}$ </p> | <p> $\mathbb{S} \mathbb{Y} \mathbb{C} _ \mathbb{S}^{\mathbb{TM}}$ $\mathbb{S} \mathbb{y} \mathbb{S} \mathbb{Y} \mathbb{C} _ \mathbb{S}^{\mathbb{TM}}$ </p> | <p> $\mathbb{S} \mathbb{y} \mathbb{I} \mathbb{N} \mathbb{F} \mathbb{I} \mathbb{H} \mathbb{F}^{\wedge} \mathbb{Y}$ $\mathbb{g} \mathbb{T} \text{' } \mathbb{A} _ \mathbb{E} _ \mathbb{I}^a \mathbb{E}$ </p> | <p> $\mathbb{S} \mathbb{y} \mathbb{I} \mathbb{N} \mathbb{F} \mathbb{I} \mathbb{H} \mathbb{F}^{\wedge} \mathbb{Y}$ $\mathbb{I} \mathbb{A} \mathbb{U} \mathbb{S} \mathbb{S} \mathbb{a}$ </p> | <p> $\mathbb{B} \mathbb{I} \mathbb{R} _ \mathbb{e} _ \pm \mathbb{C}^{\mathbb{TM}} \cdot \mathbb{f}^{\mathbb{TM}} \mathbb{I}^{\mathbb{TM}} \mathbb{p}^{\mathbb{TM}} \mathbb{R}^\circ \mathbb{I}^a \mathbb{A} \mathbb{S} \mathbb{Y} \mathbb{C} _ \ll \mathbb{I}^{\mathbb{TM}} \mathbb{a}^{\mathbb{TM}} \mathbb{a}^{\mathbb{TM}} \pm \mathbb{I}^{\mathbb{TM}} \mathbb{a}^{\mathbb{TM}}$ $\mathbb{C} \mathbb{I} \mathbb{S} \mathbb{q} \mathbb{S} \mathbb{C} \mathbb{e} _ \mathbb{I} \mathbb{S} \mathbb{I}^{\mathbb{TM}} \mathbb{a} \mathbb{W} \mathbb{I}^{\mathbb{TM}} \mathbb{f} \mathbb{e} \mathbb{a} \mathbb{f} \mathbb{e} _ \mathbb{I}^{\mathbb{TM}} \mathbb{a} \mathbb{I}^{\mathbb{TM}} \mathbb{N} \mathbb{F} \mathbb{I} \mathbb{H} \mathbb{F}^{\wedge} \mathbb{Y} _ \mathbb{R}$ $_ \mathbb{Q} \mathbb{I}^\circ \mathbb{I}^{\mathbb{TM}} \mathbb{e} _ \mathbb{I}^a \mathbb{A} \mathbb{S} \mathbb{Y} \mathbb{I} \mathbb{A} \mathbb{U} \mathbb{S}^{\mathbb{TM}} \mathbb{E} \mathbb{U}^{\mathbb{TM}} \mathbb{A}^{\mathbb{TM}} _ \mathbb{S}$ $\mathbb{D} \mathbb{I} \mathbb{S} \mathbb{Y} \mathbb{C} _ \mathbb{S}^{\mathbb{TM}} \mathbb{I} \mathbb{S} \mathbb{y}^{\mathbb{TM}} \mathbb{a}^{\mathbb{TM}} \mathbb{p} \mathbb{S} \mathbb{C} _ \mathbb{I} \mathbb{S} \mathbb{y} _ \mathbb{I}^a \mathbb{E}^{\mathbb{TM}} \ll \mathbb{I} \ll \mathbb{I}^{\mathbb{TM}} \mathbb{I} \mathbb{g} \mathbb{T} \text{' } \mathbb{A} _ \mathbb{E}$ $_ \mathbb{Q} \mathbb{I} _ \mathbb{I}^a \mathbb{E}^{\mathbb{TM}} _ \mathbb{U} \mathbb{S} \mathbb{I}^{\mathbb{TM}} \mathbb{N}^{\mathbb{TM}}$ $\mathbb{E} \mathbb{I} \mathbb{g} \mathbb{T} \text{' } \mathbb{I}^{\mathbb{TM}} \setminus \mathbb{I}^{\mathbb{TM}} \mathbb{d} \mathbb{U} \mathbb{I} \mathbb{C} \mathbb{V} \mathbb{U} \mathbb{I}^{\mathbb{TM}} \mathbb{a} _ \sim \mathbb{Q} \mathbb{W}^{\mathbb{TM}} \mathbb{N}^{\mathbb{TM}}$ </p> |
| <p> \mathbb{C} </p> | <p> $\mathbb{E} \mathbb{O}^a \mathbb{O} \mathbb{I}^{\mathbb{TM}} \mathbb{I}^{\mathbb{TM}} \mathbb{C} \mathbb{X}$ $\mathbb{S} \mathbb{C} \mathbb{S} \mathbb{T} \mathbb{S} \mathbb{Y}$ </p> | <p> $\mathbb{I} \mathbb{F} \mathbb{A} \mathbb{B}^{\mathbb{TM}} \mathbb{a}$ $\mathbb{F} \mathbb{E} \mathbb{S} \mathbb{I} \mathbb{S} _$ </p> | <p> $\mathbb{I} \mathbb{G} \mathbb{A} \mathbb{B}$ </p> | <p> $\mathbb{I} \mathbb{N} \mathbb{E} \mathbb{F}^{\wedge} \mathbb{Y}$ $\mathbb{W}^{\wedge} \mathbb{E} \mathbb{A} \mathbb{A} \mathbb{Y}$ $\mathbb{I}^{\mathbb{TM}} \mathbb{C} \mathbb{O} \mathbb{I} \mathbb{D} \mathbb{U} \mathbb{C} \mathbb{S} \mathbb{S} \mathbb{I}^{\mathbb{TM}}$ $\mathbb{I} \mathbb{D} \mathbb{U} \mathbb{C} \mathbb{S} \mathbb{S} \mathbb{a}$ </p> | <p> $\mathbb{B} \mathbb{I} \mathbb{I} \mathbb{F} \mathbb{A} \mathbb{B}^{\mathbb{TM}} \mathbb{a} \mathbb{E} \mathbb{H} \mathbb{S} \mathbb{I} \mathbb{S} _ \mathbb{I}^{\mathbb{TM}} \mathbb{a} \mathbb{I} \mathbb{N} \mathbb{E} \mathbb{F}^{\wedge} \mathbb{Y} _ \mathbb{R} \mathbb{W}^{\wedge} \mathbb{E} \mathbb{A} \mathbb{A} \mathbb{Y}$ $_ \mathbb{Q} \mathbb{I}^{\mathbb{TM}} \mathbb{C} \mathbb{O} \mathbb{I} \mathbb{D} \mathbb{U} \mathbb{C} \mathbb{S} \mathbb{S} \mathbb{I}^{\mathbb{TM}} \mathbb{E} \mathbb{U}^{\mathbb{TM}} \mathbb{A}^{\mathbb{TM}}$ $\mathbb{C} \mathbb{I} \mathbb{I} \mathbb{F} \mathbb{A} \mathbb{B}^{\mathbb{TM}} \mathbb{a} \mathbb{F} \mathbb{E} \mathbb{S} \mathbb{I} \mathbb{S} _ \mathbb{I}^{\mathbb{TM}} \mathbb{a} \mathbb{S} \mathbb{I} \mathbb{S} \mathbb{I} \mathbb{S} \mathbb{I} \mathbb{S} \mathbb{C} _ \mathbb{I} \mathbb{S} \mathbb{I}^{\mathbb{TM}} \mathbb{a}$ $\mathbb{D} \mathbb{I} \mathbb{C} \mathbb{X} \mathbb{I} \mathbb{W}^{\wedge} \mathbb{E} \mathbb{A} \mathbb{A} \mathbb{Y} \mathbb{I}^{\mathbb{TM}} \mathbb{A}^2 \mathbb{I}^{\mathbb{TM}} \mathbb{O}^{\mathbb{TM}} \mathbb{D}^{\mathbb{TM}} \mathbb{R} \mathbb{S} \mathbb{B} \ll \mathbb{y}^{\mathbb{TM}} \mathbb{a}^{\mathbb{TM}} \mathbb{a}^{\mathbb{TM}}$ $_ \mathbb{Q} \mathbb{I} \mathbb{I} \mathbb{G} \mathbb{A} \mathbb{B}^{\mathbb{TM}} _ \mathbb{I}^a \mathbb{E}^{\mathbb{TM}} \mathbb{N}^{\mathbb{TM}}$ </p> |
| <p> \mathbb{D} </p> | <p> $\mathbb{S} \mathbb{I} \mathbb{S} \mathbb{V} \mathbb{S} \mathbb{I} \mathbb{S} \mathbb{I}$ $_ \mathbb{A} \pm \mathbb{I} _ \mathbb{C}$ </p> | <p> $\mathbb{I} \mathbb{G} \mathbb{A} \mathbb{B}^{\mathbb{TM}} \mathbb{a}$ $\mathbb{I} \mathbb{S} \mathbb{I} \mathbb{S} _$ </p> | <p> $\mathbb{C} \mathbb{G} \mathbb{B} \mathbb{A}$ </p> | <p> $\mathbb{S} \mathbb{I} \mathbb{S} \mathbb{V} \mathbb{S} \mathbb{I} \mathbb{S} \mathbb{I}$ $\mathbb{I} \mathbb{B} \mathbb{I} \mathbb{V} \mathbb{Y} \mathbb{I} \mathbb{B} \mathbb{A} \mathbb{A} \mathbb{6} \mathbb{W}^{\wedge}$ $\mathbb{S}^{\mathbb{TM}} \mathbb{S} _ \mathbb{S} \mathbb{E} \mathbb{S} \mathbb{Y}^a$ </p> | <p> $\mathbb{B} \mathbb{I} \mathbb{S} \mathbb{I} \mathbb{S} \mathbb{V} \mathbb{S} \mathbb{I} \mathbb{S} \mathbb{I} \mathbb{I} \mathbb{B} \mathbb{I} \mathbb{V} \mathbb{Y} \mathbb{I} \mathbb{S}^{\mathbb{TM}} \mathbb{S} _ \mathbb{S} \mathbb{E} \mathbb{S} \mathbb{Y}^a \mathbb{A} \mathbb{S} \mathbb{Y}^{\mathbb{TM}}$ $\mathbb{C} \mathbb{I} \mathbb{I} \mathbb{G} \mathbb{A} \mathbb{B}^{\mathbb{TM}} \mathbb{a} \mathbb{I} \mathbb{S} \mathbb{I} \mathbb{S} _ \mathbb{I}^{\mathbb{TM}} \mathbb{a} \mathbb{S} \mathbb{I} \mathbb{S} \mathbb{I} \mathbb{S} \mathbb{I} \mathbb{S} \mathbb{C} _ \mathbb{I} \mathbb{S} \mathbb{I}^{\mathbb{TM}} \mathbb{a}$ $\mathbb{D} \mathbb{S} \mathbb{I} \mathbb{C} \ll \mathbb{I} \mathbb{E} \mathbb{O} \pm \mathbb{a} \mathbb{C} \mathbb{I}^{\mathbb{TM}} \mathbb{C} \mathbb{O} \mathbb{I} \mathbb{D} \mathbb{U} \mathbb{C} \mathbb{S} \mathbb{S} \mathbb{I}^{\mathbb{TM}} \mathbb{E} \mathbb{U}^{\mathbb{TM}} \mathbb{A}^{\mathbb{TM$</p> |

~ QE: a W^a ^ S YTM 90 00TM TM a W^a ^ S YTM aTM ÷ ©, TM 0TM 0TM 0TM:

~ Q

IFABTM EFŠ †Š – TM a – ± Ć^X Q 1111 > 1 > 1 > Š Ź Š Š Š > 1 > ± Ć → 1 E ~ 3 YŠ qŠ WŠ sŠ _
a ^ S YTM Ć^a í © TM ĀP



IFABTM BCŠ †Š – TM a @ Ć⁹ f Š Q 1111 > 1 > 1 > 1 FAB ¥ ETM ě ~ í E ~ 2 YŠ qŠ WŠ sŠ _
©, ± Ć^a ^ S YTM Ć^a í © TM ĀP



IFABTM BJ=ICA=ICBŠ †Š – TM a 1111 > Q 11 > 1 > 1 > 1
©, ± Ć^a ^ S YTM Ć^a í © TM ĀP

LJABTM B=IC=IDŠ †Š – Q 1111
a W^a ^ S YTM Ć^a í © TM ĀP



_X

TcelaTSTM LJAB , T^X > 1 > 1 > 1 > 1 > 1 TdeŠ qŠ WŠ sŠ _
Š qŠ WŠ sŠ _

D? - è! ~ V£ w« ¶ - ®

~ Q11~ ° ° ° « ` TMā~ R-u| 0Y™ 2š V™ Wš Šš _ TMŃ™ TMĖ™ ā~ S

~ QB:š £ š i š o~ l©, TM0

~ Q11~ Q~ ° ° ° « ` TMā~ R- è! š ¢~ lš _š ¢š }š _š o™ α~ ®W™ Ń™ TMĖ™ ā~ S

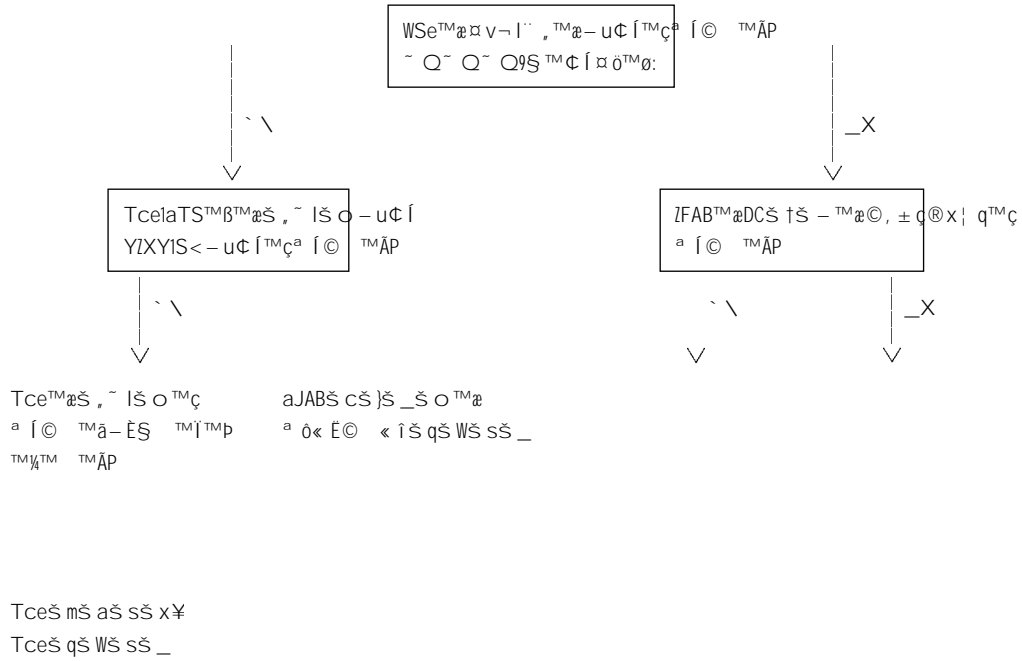

~ QC:a™ - 0~ è! 9£0¢0 a :

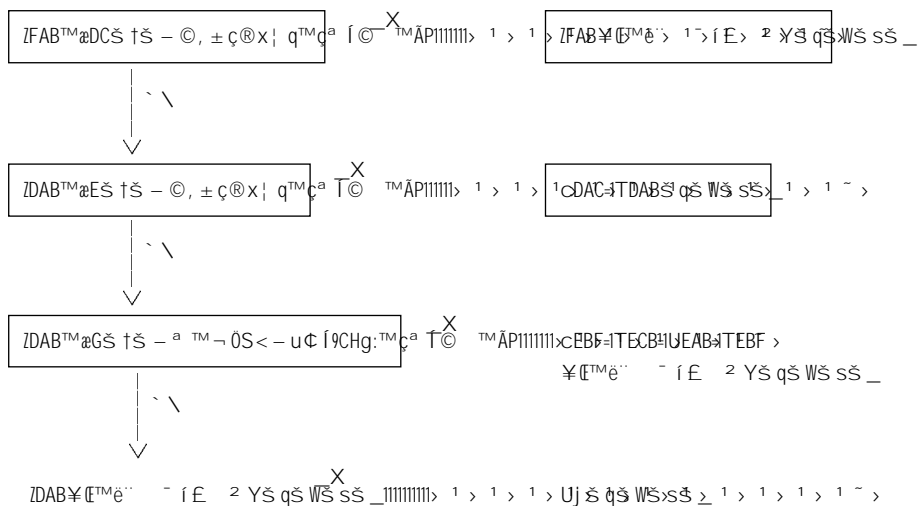

C? « ZŸ áŒ ² Y

~ Q11~ ° ² vŠ™~ lš y™æª ò² Ñ~ R- ± çª ò² Ñ~ Rš qš š š - š)š Ƴ~ RŒ 0± ä- ³™æŒ 0™Ä™ß™Ä™ä™¼© Š j™ç² vš]~

~ Q~ Q1š]~ lš "š xš ² š _š i Œ ² Y™ ² ~ @W™Ñ™™™™™ä~ S

~ QB:« ZŸ á~ Rš qš œ~ lš {š - š `™ß™Ä™™0

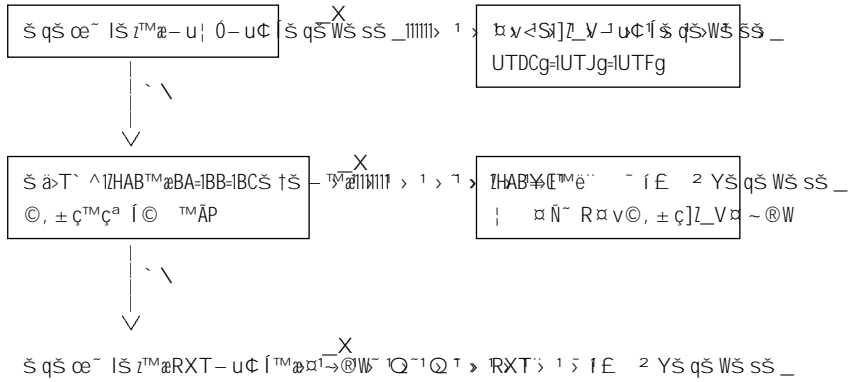

š qš œ~ lš lš qš Wš sš Q

~ QC:- ± çš™~ lš yª ò² Ñ™ß™Ä™™0

_X

`\

_X



ZCABƳ[™ë'' ~ í Œ ² Yš qš Wš sš _~ Rl² ² Ñ~ Q

$$|\mathfrak{A} \circ \hat{U}^a| \leq |W|$$

~ Q~ Q~ ° ' ° « ` TMā~ Rα vTMæš cš – š }š _š o~ |TMæª ó« Ě© « î TM α ~ ®WTMŊTM TMĚTMà~ S

$$B^? - u \mid \acute{O}\pounds \quad \approx \quad Y\bowtie \acute{d} \mid h$$

~ QB:š , š © ~ lš ǻ š | ~ l-È§ ™0™0

[illegible]

ZHAB™aDBŠ†Š-™aRÇa f©,±ç™Ça f© 1™ÄP^X QHABY(™e'' - í£ ²YŠqŠWŠsŠ.

ZHAB™EDIŠ†Š-™@©,±çα-①W↳QŠ-Q^X153,ZHAB™@™EŠ1-íE-2YšqšWššš_~QšZš-K11]~Q~QšZšK11Y

Š ¤ Š | ~ |¥ - Ě£ ² ⑧

—X

 X

ZI AB™æDŠ †Š -™æ@x| q™çª b©>™ÄP™>Q1b 1 5 5 xC!AJ-1T|BG-1U|AEŠ qŠ WŠ SŠ _

el AC™ aD=IEš †š –™ aHVMÍSR\ :™ çª Í©™ ĀP

- è! - ® Š q Š W š

| J`T | aRceT`UV | aRce_R^V | aRceUVdT |
|-------|-------------|---------------|----------------------|
| cTFCI | YcWeEHD[TR | ciTYIa | B@BAIEH\N`Y^I[ICABC |
| cTFD | YcWeBAD[TR | ciTYIa | B@BAIBA\N`Y^I[ICABC |
| cTFDC | YcWeICC[TR | ciTYIa | B@BAII`C\N`Y^I[ICABC |
| cTFDE | YcWeDDC[TR | ciTYIa | B@BAID`D\N`Y^I[ICABC |
| cTFDG | YcWeICD[TR | ciTYIa | B@BAII`C\N`Y^I[ICABC |
| cTFDH | YcWeBAD[TR | ciTYIa | B@BAIBA\N`Y^I[ICABC |
| cTFE | YcWeBAC[TR | ciTYIa | B@BAIB\N`Y^I[ICABC |
| cTFF | YcWeBAC[TR | ciTYIa | B@BAIB\N`Y^I[ICABC |
| cTFFA | YcWeBAC[TR | ciTYIa | B@BAIB\N`Y^I[ICABC |
| cTFFB | YcWeBAC[TR | ciTYIa | B@BAIB\N`Y^I[ICABC |
| cTFG | YcWeCCB[TR | ciTYIa | B@BAICCAI`Y^I[ICABC |
| cTFH | YcWeCCD[TR | ciTYIa | B@BAICC\N`Y^I[ICABC |
| cTFI | YcWeBAB[TR | ciTYIa | B@BAIBAAI`Y^I[ICABC |
| cTFJ | YcWeBAB[TR | ciTYIa | B@BAIBAAI`Y^I[ICABC |
| cTGA | YcWeBAB[TR | ciTYIa | B@BAIBAAI`Y^I[ICABC |
| cTGAC | YcWeBAC[TR | ciTYIa | B@BAIB\N`Y^I[ICABC |
| cTGAD | YcWeBAB[TR | ciTYIa | B@BAIBAAI`Y^I[ICABC |
| cTGAF | YcWeBAF[TR | ciTYIa | B@BAIB^N`Y^I[ICABC |
| cTGAH | YcWeBAD[TR | ciTYIa | B@BAIBA\N`Y^I[ICABC |
| cTGB | YcWeBAB[TR | ciTYIa | B@BAIBAAI`Y^I[ICABC |
| cTGC | YcWeAAA[TR | ciTYIa | B@BAIAI`Y^I[ICABC |
| cTGD | YcWeAAA[TR | ciTYIa | B@BAIAI`Y^I[ICABC |
| cTGE | YcWeBAC[TR | ciTYIa | B@BAIB\N`Y^I[ICABC |
| cTGF | YcWeBAC[TR | ciTYIa | B@BAIB\N`Y^I[ICABC |
| cTGFG | YcWeEHC[TR | ciTYIa | B@BAIE`H\N`Y^I[ICABC |
| cTGfH | YcWeDDC[TR | ciTYIa | B@BAID`D\N`Y^I[ICABC |
| cTGG | YcWeBAC[TR | ciTYIa | B@BAIB\N`Y^I[ICABC |
| cTGGb | YcWeEHC[TR | ciTYIa | B@BAIE`H\N`Y^I[ICABC |
| cTGGC | YcWeDDC[TR | ciTYIa | B@BAID`D\N`Y^I[ICABC |
| cTHAC | YcWeBAC[TR | ciTYIa | B@BAIB\N`Y^I[ICABC |
| cTHAD | YcWeBAC[TR | ciTYIa | B@BAIB\N`Y^I[ICABC |
| cWAB | cU>RkBI`C[> | ciTRcS`_1WZ]^ | B@GIB?I\N`Y^I[|
| cWAC | cU>RkCHC[> | ciTRcS`_1WZ]^ | B@GIC`H\N`Y^I[|
| cWAD | cU>RkFGC[> | ciTRcS`_1WZ]^ | B@GIF`G\N`Y^I[|
| cWAE | cU>RkBCD[> | ciTRcS`_1WZ]^ | B@GIBC\N`Y^I[|
| cWAF | cU>RkCHD[> | ciTRcS`_1WZ]^ | B@GICH\N`Y^I[|
| cWAG | cU>CkCHB[> | ciTRcS`_1WZ]^ | B@CICHAI`Y^I[|
| cWAH | cU>CkCHB[> | ciTRcS`_1WZ]^ | B@CICHAI`Y^I[|

| J`T | aRceT`UV | aRce_R^V | aRceUVdT |
|--------|---------------|-----------------------------|--------------------------|
| cWAI | cU>RkHFA[> | ciTRcS`_1WZ]^ | B@GIFI`Y^I[|
| cWAJ | cU>RkBAC[> | ciTRcS`_1WZ]^ | B@GIB\N`Y^I[|
| cWBA | cU>RkBAE[> | ciTRcS`_1WZ]^ | B@GIBAA\N`Y^I[|
| cWBB | cU>RkBAC[> | ciTRcS`_1WZ]^ | B@GIB\N`Y^I[|
| cWBC | cU>RkBAE[> | ciTRcS`_1WZ]^ | B@GIBAA\N`Y^I[|
| cWBD | cU>RkBAD[> | ciTRcS`_1WZ]^ | B@GIBA\N`Y^I[|
| cWBE | FTakFGJ\AC | T`Z]IaVR\J_X | F?GFY\N`9Ri`Zr]I0?F^A^: |
| cWBF | cU>RkCEC[> | ciTRcS`_1WZ]^ | B@GIC?E\N`Y^I[|
| cWBG | cU>RkBAB[> | ciTRcS`_1WZ]^ | B@GIBAAI`Y^I[|
| c]j`B | FdTABABDDD | dhIcV]Rj | caVW>BC>JAD |
| dTeB | EI`FJDACI`DA | d`T\VeITce | IaY>ACd |
| daAB | EI`FI`DBAI`BA | daVR\Vc | HhI1I`Y^I`WCCFAT>CBEB |
| daABR | HBCCEABCBC | dTcVhleRaaL_X | eCdIecdIEI`BCI^Wk_1S]RT\ |
| daAC | EI`FI`DBAI`BA | daVR\Vc | HhI1I`Y^I`WCCFAT>CBEB |
| daACR | HBCCEABCBC | dTcVhleRaaL_X | eCdIecdIEI`BCI^Wk_1S]RT\ |
| dhAB | FdEACACBEE | dhIaf`dY | daf`]BJ |
| dhAC | FdFABABAJA | dhIeR`Te | d\YgBHJBAR |
| dhAD | FdFABABAJA | dhIeR`Te | d\YgBHJBAR |
| dhAE | FdFABABAJA | dhIeR`Te | d\YgBHJBAR |
| dhAF | FdFABABAJA | dhIeR`Te | d\YgBHJBAR |
| dhAG | FdFABABAJA | dhIeR`Te | d\YgBHJBAR |
| dhAH | FdFABABAJA | dhIeR`Te | d\YgBHJBAR |
| eEAB | FeUAAAAABI | ecR_dIUcI`gV | eYU>BCA |
| eEAC | FAYAAAAABI`J | WSe | WWRJEAEl`] |
| el`AB | FAaAAAAABHH | ecR_dIa`hVc | eah>DFBD_ |
| el`AC | FA^EJFARE[| ecR_dId^ad | ed^>EJFARE |
| fBAB | EI`FJHBHI`DA | ef`VcI`gRcR`Te`c | eV][Ih>ADAR |
| gJAB | EI`FJGBHAGA | Tce | RGI`RVXCFI`ACIaEH |
| i`FAB | Fi`Vi`DcFHJT | Tcj`deR]Ib`fRcek | YT>EJFI`D/FHJFEF^I`9ea: |
| i`FAC | EI`FA]ACDBA | cVd`_Re`ciTVcR | TdSFADWDA |
| i`GAB | EI`FA]ABJBA | cVd`_Re`ciTVcR | TdSFADVH |
| i`HAB | EI`FA]ACHBA | cVd`_Re`ciTVcR | TdRI`AA^ek |
| kBAB | _aWFBa^>>> | WZ]eVcIdRh | WFBa^ |
| kCAB | Faf`X]DEJ_ | WZ]eVcI`T`^S | f`X]>DEJ_e |
| kgI`AB | UdgTCHBUBE | gRcIdc`c | dgTCHBUBER |
| kkBAA | EI`SDCCGSAD | ecR_d^leeVcIcV^`T`_`c>CGSAD | |
| kkBBA | aeRTah[GDG | RTTVdd`cjI`Rd | Ue_>CJXDW[|

| J` T | aRce>T` UV | aRce>_R^V | aRce>UVdT |
|-------|-------------|------------------|-----------------------|
| cJAE | cU>RkDAC[> | ciTRcS`_1WZ]^ | B@GID\i` Y^1[|
| cJAF | cU>RkDAC[> | ciTRcS`_1WZ]^ | B@GID\i` Y^1[|
| cJAG | cU>RkCAC[> | ciTRcS`_1WZ]^ | B@GIC\i` Y^1[|
| cJAH | cU>RkDAC[> | ciTRcS`_1WZ]^ | B@GID\i` Y^1[|
| cJAI | cU>RkDAC[> | ciTRcS`_1WZ]^ | B@GID\i` Y^1[|
| cJBA | cU>RkDAC[> | ciTRcS`_1WZ]^ | B@GID\i` Y^1[|
| cJBB | cU>EkBCE[> | ciTRcS`_1WZ]^ | B@EIBCAni` Y^1[|
| cJBC | cU>EkBCE[> | ciTRcS`_1WZ]^ | B@EIBCAni` Y^1[|
| cJBD | cU>EkBCE[> | ciTRcS`_1WZ]^ | B@EIBCAni` Y^1[|
| cJBE | cT>CkBAC[> | ciTRcS`_1T`^a | B@CIB\i` Y^1\ |
| cJBF | cT>CkBAC[> | ciTRcS`_1T`^a | B@CIB\i` Y^1\ |
| cJBG | cT>CkBAC[> | ciTRcS`_1T`^a | B@CIB\i` Y^1\ |
| cJBH | cU>RkCCE[> | ciTRcS`_1WZ]^ | B@GICCA\i` Y^1[|
| cJBI | cU>RkDJC[> | ciTRcS`_1WZ]^ | B@GIDJ\i` Y^1[|
| cJBj | cdABj BAA[> | ci^>` i 1UV1WZ]^ | Bh1BAI` Y^1[|
| cJCA | cU>CkBAF[> | ciTRcS`_1WZ]^ | B@CIB^i` Y^1[|
| cJCB | cU>CkBAC[> | ciTRcS`_1WZ]^ | B@CIB\i` Y^1[|
| cJCC | IF1ABAGFXj | h1cVIT`aaVc | RhXCC1B@AGF1e1T`Re1_X |
| cJCD | IF1ABAGFXj | h1cVIT`aaVc | RhXCC1B@AGF1e1T`Re1_X |
| cJCE | cU>RkBAD[> | ciTRcS`_1WZ]^ | B@GIBAni` Y^1[|
| cTAB | YcWeBAD[TR | ciTY1a | B@BAIBAni` Y^1[ICABC |
| cTAC | YcWeBAD[TR | ciTY1a | B@BAIBAni` Y^1[ICABC |
| cTAD | YcWeEHD[TR | ciTY1a | B@BAIEH\i` Y^1[ICABC |
| cTAE | YcWeDDC[TR | ciTY1a | B@BAID\i` Y^1[ICABC |
| cTAI | YcWeBAD[TR | ciTY1a | B@BAIBAni` Y^1[ICABC |
| cTBA | YcWeBAD[TR | ciTY1a | B@BAIBAni` Y^1[ICABC |
| cTBAF | YcWeBCB[TR | ciTY1a | B@BAIBCAi` Y^1[ICABC |
| cTBAI | YcWeBFC[TR | ciTY1a | B@BAIBF\i` Y^1[ICABC |
| cTBAJ | YcWeDDA[TR | ciTY1a | B@BAIDDi` Y^1[ICABC |
| cTBBA | YcWeDJB[TR | ciTY1a | B@BAIDJAI` Y^1[ICABC |
| cTBBB | YcWe1CB[TR | ciTY1a | B@BAI1CAI` Y^1[ICABC |
| cTBBD | YcWeFGB[TR | ciTY1a | B@BAIFGAI` Y^1[ICABC |
| cTBBE | YcWeBAC[TR | ciTY1a | B@BAIB\i` Y^1[ICABC |
| cTBBF | YcWeBFD[TR | ciTY1a | B@BAIBF\i` Y^1[ICABC |
| cTBD | YcWeBAC[TR | ciTY1a | B@BAIB\i` Y^1[ICABC |
| cTBE | YcWeBAC[TR | ciTY1a | B@BAIB\i` Y^1[ICABC |
| cTBF | YcWeBAC[TR | ciTY1a | B@BAIB\i` Y^1[ICABC |
| cTBG | YcWeBAD[TR | ciTY1a | B@BAIBAni` Y^1[ICABC |
| cTBH | YcWeBAD[TR | ciTY1a | B@BAIBAni` Y^1[ICABC |
| cTBI | YcWeBAD[TR | ciTY1a | B@BAIBAni` Y^1[ICABC |
| cTBj | YcWeBAC[TR | ciTY1a | B@BAIB\i` Y^1[ICABC |
| cTCA | YcWeBAD[TR | ciTY1a | B@BAIBAni` Y^1[ICABC |
| cTCAB | YcWeHFC[TR | ciTY1a | B@BAIH?F\i` Y^1[ICABC |
| cTCAD | YcWeCAC[TR | ciTY1a | B@BAIC\i` Y^1[ICABC |
| cTCAD | YcWeDDD[TR | ciTY1a | B@BAIDDi` Y^1[ICABC |
| cTCAE | YcWeBAC[TR | ciTY1a | B@BAIB\i` Y^1[ICABC |
| cTCAF | YcWeCHB[TR | ciTY1a | B@BAICHAi` Y^1[ICABC |
| cTCAG | YcWeDAB[TR | ciTY1a | B@BAIDAAi` Y^1[ICABC |
| cTCAH | YcWeB1C[TR | ciTY1a | B@BAIB?1\i` Y^1[ICABC |
| cTCAI | YcWe1CB[TR | ciTY1a | B@BAI1CAI` Y^1[ICABC |
| cTCB | YcWeBAC[TR | ciTY1a | B@BAIB\i` Y^1[ICABC |
| cTCC | YcWeBAD[TR | ciTY1a | B@BAIBAni` Y^1[ICABC |
| cTCEB | YcWeBAE[TR | ciTY1a | B@BAIBAA\i` Y^1[ICABC |
| cTCEC | YcWeBAC[TR | ciTY1a | B@BAIB\i` Y^1[ICABC |
| cTCED | YcWeBAE[TR | ciTY1a | B@BAIBAA\i` Y^1[ICABC |
| cTCEE | YcWeBAC[TR | ciTY1a | B@BAIB\i` Y^1[ICABC |
| cTCEF | YcWeHFA[TR | ciTY1a | B@BAIHFi` Y^1[ICABC |

| J` T | aRce>T` UV | aRce>_R^V | aRce>UVdT |
|-------|------------|-----------|-----------------------|
| cTCEH | YcWeBAE[TR | ciTY1a | B@BAIBAA\i` Y^1[ICABC |
| cTCEI | YcWeBAE[TR | ciTY1a | B@BAIBAA\i` Y^1[ICABC |
| cTCEJ | YcWeBAC[TR | ciTY1a | B@BAIB\i` Y^1[ICABC |
| cTCF | YcWeBAD[TR | ciTY1a | B@BAIBAni` Y^1[ICABC |
| cTCFA | YcWeHFA[TR | ciTY1a | B@BAIHFi` Y^1[ICABC |
| cTCFB | YcWeBAC[TR | ciTY1a | B@BAIB\i` Y^1[ICABC |
| cTCFC | YcWeBAB[TR | ciTY1a | B@BAIBAAi` Y^1[ICABC |
| cTCFD | YcWeBAB[TR | ciTY1a | B@BAIBAAi` Y^1[ICABC |
| cTCFE | YcWeBAB[TR | ciTY1a | B@BAIBAAi` Y^1[ICABC |
| cTCFF | YcWeDDC[TR | ciTY1a | B@BAID\i` Y^1[ICABC |
| cTCFG | YcWeBAB[TR | ciTY1a | B@BAIBAAi` Y^1[ICABC |
| cTCFI | YcWeBAB[TR | ciTY1a | B@BAIBAAi` Y^1[ICABC |
| cTCFJ | YcWeBAB[TR | ciTY1a | B@BAIBAAi` Y^1[ICABC |
| cTCG | YcWeCHE[TR | ciTY1a | B@BAICHA\i` Y^1[ICABC |
| cTCGA | YcWeBGB[TR | ciTY1a | B@BAIBGAI` Y^1[ICABC |
| cTCGB | YcWeBAD[TR | ciTY1a | B@BAIBAni` Y^1[ICABC |
| cTCGC | YcWeBAB[TR | ciTY1a | B@BAIBAAi` Y^1[ICABC |
| cTCGD | YcWeBAD[TR | ciTY1a | B@BAIBAni` Y^1[ICABC |
| cTCGF | YcWeHFA[TR | ciTY1a | B@BAIHFi` Y^1[ICABC |
| cTCGG | YcWeHFA[TR | ciTY1a | B@BAIHFi` Y^1[ICABC |
| cTCI | YcWeB1D[TR | ciTY1a | B@BAIB1` Y^1[ICABC |
| cTCJ | YcWeEHC[TR | ciTY1a | B@BAIE?H\i` Y^1[ICABC |
| cTDAF | YcWeEDE[TR | ciTY1a | B@BAIEDA\i` Y^1[ICABC |
| cTDAG | YcWeDJD[TR | ciTY1a | B@BAIDJ\i` Y^1[ICABC |
| cTDAH | YcWeDDD[TR | ciTY1a | B@BAIDD\i` Y^1[ICABC |
| cTDAJ | YcWe1CD[TR | ciTY1a | B@BAI1C\i` Y^1[ICABC |
| cTDB | YcWeBAD[TR | ciTY1a | B@BAIBAni` Y^1[ICABC |
| cTDI | YcWeBAD[TR | ciTY1a | B@BAIBAni` Y^1[ICABC |
| cTEAB | YcWeHFD[TR | ciTY1a | B@BAIHFi` Y^1[ICABC |
| cTEAC | YcWeBAD[TR | ciTY1a | B@BAIBAni` Y^1[ICABC |
| cTEAD | YcWeB1E[TR | ciTY1a | B@BAIB1A\i` Y^1[ICABC |
| cTEAE | YcWeDDD[TR | ciTY1a | B@BAIDDi` Y^1[ICABC |
| cTEAF | YcWeBAC[TR | ciTY1a | B@BAIB\i` Y^1[ICABC |
| cTEAG | YcWeCCC[TR | ciTY1a | B@BAIC?C\i` Y^1[ICABC |
| cTEAH | YcWeGGC[TR | ciTY1a | B@BAID?G\i` Y^1[ICABC |
| cTEAI | YcWeCAD[TR | ciTY1a | B@BAICAni` Y^1[ICABC |
| cTEAJ | YcWe1CC[TR | ciTY1a | B@BAI1C\i` Y^1[ICABC |
| cTED | YcWeBAB[TR | ciTY1a | B@BAIBAAi` Y^1[ICABC |
| cTEF | YcWeBAB[TR | ciTY1a | B@BAIBAAi` Y^1[ICABC |
| cTEG | YcWeBAD[TR | ciTY1a | B@BAIBAni` Y^1[ICABC |
| cTEI | YcWeCCD[TR | ciTY1a | B@BAICC\i` Y^1[ICABC |
| cTEJ | YcWeCCD[TR | ciTY1a | B@BAICC\i` Y^1[ICABC |
| cTFA | YcWeBAD[TR | ciTY1a | B@BAIBAni` Y^1[ICABC |
| cTFAB | YcWeBAD[TR | ciTY1a | B@BAIBAni` Y^1[ICABC |
| cTFAC | YcWeBAD[TR | ciTY1a | B@BAIBAni` Y^1[ICABC |
| cTFAD | YcWeBAD[TR | ciTY1a | B@BAIBAni` Y^1[ICABC |
| cTFAE | YcWeDGB[TR | ciTY1a | B@BAIDGAI` Y^1[ICABC |
| cTFAG | YcWeDDC[TR | ciTY1a | B@BAID\i` Y^1[ICABC |
| cTFAG | YcWeCCC[TR | ciTY1a | B@BAIC?C\i` Y^1[ICABC |
| cTFAI | YcWeBAC[TR | ciTY1a | B@BAIB\i` Y^1[ICABC |
| cTFB | YcWeBAD[TR | ciTY1a | B@BAIBAni` Y^1[ICABC |
| cTFBA | YcWeBAC[TR | ciTY1a | B@BAIB\i` Y^1[ICABC |
| cTFBC | YcWeBAC[TR | ciTY1a | B@BAIB\i` Y^1[ICABC |
| cTFBE | YcWeGCB[TR | ciTY1a | B@BAIGCAi` Y^1[ICABC |
| cTFBG | YcWeGCB[TR | ciTY1a | B@BAIGCAi` Y^1[ICABC |
| cTFBH | YcWeGCB[TR | ciTY1a | B@BAIGCAi` Y^1[ICABC |
| cTFC | YcWeBAD[TR | ciTY1a | B@BAIBAni` Y^1[ICABC |

|] | T | aRceT`UV | aRce_R^V | aRceUVdT |
|------|-------------|-----------------|--------------------------|----------|
| cDBA | cU>RkBAC[> | cITRcS`_1WZ]^ | B@IB\i`Y^I[| |
| cEAB | cdACKBCD[d | cl^> i 1UV1WZ]^ | Ch1BC\1AY^I[1d^R]] | |
| cEAD | cU>RkFGB[> | cITRcS`_1WZ]^ | B@IFGAI`Y^I[| |
| cEAE | cdABKEHC[> | cl^> i 1UV1WZ]^ | Bh1E7H\i`Y^I[1 9eRaaL_X: | |
| cEAF | ci BAeEAC[> | cITV^V_e | BAh1E\i`Y^I[1ec1a`U | |
| cEAJ | cdACKBAC[d | cl^> i 1UV1WZ]^ | Ch1B\i`Y^I[1d^R]] | |
| cEBA | cU>EkBAC[> | cITRcS`_1WZ]^ | B@EB\i`Y^I[| |
| cEBB | cdACKDGJ[d | cl^> i 1UV1WZ]^ | Ch1D7G\i`Y^I[1d^R]] | |
| cEBC | cdACKDGJ[d | cl^> i 1UV1WZ]^ | Ch1D7G\i`Y^I[1d^R]] | |
| cEBD | cWABkBAA[> | c1Wfd[S]V | Bh1BAI`Y^I[1 9eRaaL_X: | |
| cEBE | cU>CkCCE[> | cITRcS`_1WZ]^ | B@CICCA\i`Y^I[| |
| cEBF | cWABkBAJ[> | c1Wfd[S]V | Bh1BI`Y^I[1 9eRaaL_X: | |
| cEBH | cU>EkCAD[> | cITRcS`_1WZ]^ | B@EICA\i`Y^I[| |
| cEBI | cU>EkFGC[> | cITRcS`_1WZ]^ | B@E1F7G\i`Y^I[| |
| cEBJ | UcDCA\>>> | eYVc^7de`c | c>DCA\ | |
| cECA | cU>EkCHC[> | cITRcS`_1WZ]^ | B@E1C7H\i`Y^I[| |
| cECB | cdACKBAA[d | cl^> i 1UV1WZ]^ | Ch1BAI`Y^I[1d^R]] | |
| cECC | cU>EkGID[> | cITRcS`_1WZ]^ | B@EIG\i`Y^I[| |
| cECE | cgFECGCCDa | clDV^7WZi VU | cYAGDI T1CC\i`Y^I | |
| cECG | cgFECGCCDa | clDV^7WZi VU | cYAGDI T1CC\i`Y^I | |
| cEDA | cU>EkBFC[> | cITRcS`_1WZ]^ | B@E1B7F\i`Y^I[| |
| cEDB | cU>EkDGC[> | cITRcS`_1WZ]^ | B@E1D7G\i`Y^I[| |
| cEDC | cU>EkDDC[> | cITRcS`_1WZ]^ | B@E1D7D\i`Y^I[| |
| cFAH | cU>RkCAC[> | cITRcS`_1WZ]^ | B@GIC\i`Y^I[| |
| cFAJ | cU>RkBGC[> | cITRcS`_1WZ]^ | B@GIB7G\i`Y^I[| |
| cFBB | cU>RkBGC[> | cITRcS`_1WZ]^ | B@GIB7G\i`Y^I[| |
| cFBD | cU>RkBGC[> | cITRcS`_1WZ]^ | B@GIB7G\i`Y^I[| |
| cFBF | cdABkBI B[> | cl^> i 1UV1WZ]^ | Bh1BI AI`Y^I[1 9eRaaL_X: | |
| cFBI | cU>RkDJD[> | cITRcS`_1WZ]^ | B@GIDJ\i`Y^I[| |
| cFCD | cU>RkFGC[> | cITRcS`_1WZ]^ | B@G1F7G\i`Y^I[| |
| cFCE | c>RkI CACW | cl^VeR]1WZ]^ | B@GII C\i`Y^I1W | |
| cFCF | c>RkFBACW | cl^VeR]1WZ]^ | B@G1FB7A\i`Y^I1W | |
| cFCG | c>RkCEACW | cl^VeR]1WZ]^ | B@G1CE7A\i`Y^I1W | |
| cFCH | c>RkBAACW | cl^VeR]1WZ]^ | B@GIBAI`Y^I1W | |
| cFCJ | cU>RkBAC[> | cITRcS`_1WZ]^ | B@GIB\i`Y^I[| |
| cFDA | cdABkBAC[> | cl^> i 1UV1WZ]^ | Bh1B\i`Y^I[1 9eRaaL_X: | |
| cFDB | cU>RkCED[> | cITRcS`_1WZ]^ | B@GICE\i`Y^I[| |
| cFDD | cU>RkFGB[> | cITRcS`_1WZ]^ | B@GIFGAI`Y^I[| |
| cFDI | cU>RkBFE[> | cITRcS`_1WZ]^ | B@GIBFA\i`Y^I[| |
| cFEB | cU>RkICC[> | cITRcS`_1WZ]^ | B@GII 7C\i`Y^I[| |
| cFEC | cU>RkBAD[> | cITRcS`_1WZ]^ | B@GIBAI`Y^I[| |
| cFED | cU>RkBAF[> | cITRcS`_1WZ]^ | B@GIB^i`Y^I[| |
| cGAB | cU>RkBI C[> | cITRcS`_1WZ]^ | B@GIB7I \i`Y^I[| |
| cGAC | cU>RkEDB[> | cITRcS`_1WZ]^ | B@GIEDAI`Y^I[| |
| cGAE | cU>RkBAC[> | cITRcS`_1WZ]^ | B@GIB\i`Y^I[| |
| cGAF | cU>RkEDB[> | cITRcS`_1WZ]^ | B@GIEDAI`Y^I[| |
| cGAG | cU>RkBI C[> | cITRcS`_1WZ]^ | B@GIB7I \i`Y^I[| |
| cGAI | cU>RkBAB[> | cITRcS`_1WZ]^ | B@GIBAAI`Y^I[| |
| cGAJ | cU>RkDJB[> | cITRcS`_1WZ]^ | B@GIDJAI`Y^I[| |
| cGBA | cgFECGEHBa | clDV^7WZi VU | Ug>U[R>RADIEHAI`Y^IIS | |
| cGBB | cU>RkDJB[> | cITRcS`_1WZ]^ | B@GIDJAI`Y^I[| |
| cGBE | cU>RkEHC[> | cITRcS`_1WZ]^ | B@GIE7H\i`Y^I[| |
| cGBG | cU>RkEHC[> | cITRcS`_1WZ]^ | B@GIE7H\i`Y^I[| |
| cGBH | cU>RkBAC[> | cITRcS`_1WZ]^ | B@GIB\i`Y^I[| |
| cGBI | cU>RkBAD[> | cITRcS`_1WZ]^ | B@GIBAI`Y^I[| |
| cGBJ | cU>RkEHD[> | cITRcS`_1WZ]^ | B@GIEH\i`Y^I[| |
| cGFI | cU>RkCAB[> | cITRcS`_1WZ]^ | B@GICAAI`Y^I[| |

|] | T | aRceT`UV | aRce_R^V | aRceUVdT |
|-------|--------------|-----------------|------------------------------|----------|
| cGFJ | cU>EkICJ[> | cITRcS`_1WZ]^ | B@EII 7CI`Y^I[| |
| cGGA | cU>EkICJ[> | cITRcS`_1WZ]^ | B@EII 7CI`Y^I[| |
| CHAB | cU>RkBAB[> | cITRcS`_1WZ]^ | B@GIBAAI`Y^I[| |
| CHAC | cU>RkBAB[> | cITRcS`_1WZ]^ | B@GIBAAI`Y^I[| |
| CHAH | cU>RkBAD[> | cITRcS`_1WZ]^ | B@GIBAI`Y^I[| |
| CHAJ | cU>RkBFD[> | cITRcS`_1WZ]^ | B@GIBF\i`Y^I[| |
| CHCD | cU>RkBAC[> | cITRcS`_1WZ]^ | B@GIB\i`Y^I[| |
| CHCE | cU>RkBAD[> | cITRcS`_1WZ]^ | B@GIBAI`Y^I[| |
| CHCH | cU>RkFBC[> | cITRcS`_1WZ]^ | B@GIF7B\i`Y^I[| |
| CHDA | cU>RkBAC[> | cITRcS`_1WZ]^ | B@GIB\i`Y^I[| |
| CHDC | cU>RkBAD[> | cITRcS`_1WZ]^ | B@GIBAI`Y^I[| |
| CHDD | cU>RkBAC[> | cITRcS`_1WZ]^ | B@GIB\i`Y^I[| |
| CHDF | cU>RkBAC[> | cITRcS`_1WZ]^ | B@GIB\i`Y^I[| |
| CHDG | cU>RkBAC[> | cITRcS`_1WZ]^ | B@GIB\i`Y^I[| |
| CHDH | cU>RkBAD[> | cITRcS`_1WZ]^ | B@GIBAI`Y^I[| |
| CHDI | cU>RkBAD[> | cITRcS`_1WZ]^ | B@GIBAI`Y^I[| |
| CHEE | cU>RkBAA[> | cITRcS`_1WZ]^ | B@GIBAI`Y^I[| |
| cIAB | U[FAFA^BEA | a`d7de`c | [FADaFBUAFA^BEA | |
| ✚cIAD | ci BAeBFJ[> | cITV^V_e | BAh1B7FI`Y^I[1ec1a`U | |
| cIAE | cU>CkBAE[> | cITRcS`_1WZ]^ | B@CIBAAI`Y^I[| |
| cIAG | cdABKEHD[> | cl^> i 1UV1WZ]^ | Bh1EH\i`Y^I[1 9eRaaL_X: | |
| cIAJ | cdADkDDA[d | cl^> i 1UV1WZ]^ | Dh1DDI`Y^I[1d^R]]1 9eRaaL_X: | |
| cIBA | cdABkGIA[> | cl^> i 1UV1WZ]^ | Bh1GI\i`Y^I[1 9eRaaL_X: | |
| cIBB | cWABkDJA[> | c1Wfd[S]V | Bh1DJ\i`Y^I[1 9eRaaL_X: | |
| cIBC | cU>EkDDA[> | cITRcS`_1WZ]^ | B@EIDD\i`Y^I[| |
| cIBD | cdABkJBC[> | cl^> i 1UV1WZ]^ | Bh1JB\i`Y^I[1eRaaL_X: | |
| cIBE | cWABkGII[> | c1Wfd[S]V | Bh1A7GI\i`Y^I[1 9eRaaL_X: | |
| cIBF | cU>EkBIC[> | cITRcS`_1WZ]^ | B@EBI 7I \i`Y^I[| |
| cIBG | c^AQj CCI[> | cl^VeR]1WZ]^ | Ch1A7CCI`Y^I[| |
| cIBH | cU>EkBAC[> | cITRcS`_1WZ]^ | B@EB\i`Y^I[| |
| cIBI | cU>EkBDB[> | cITRcS`_1WZ]^ | B@EBDAI`Y^I[| |
| cIBJ | cU>EkHFC[> | cITRcS`_1WZ]^ | B@EIH7F\i`Y^I[| |
| cICA | cU>EkBAC[> | cITRcS`_1WZ]^ | B@EB\i`Y^I[| |
| cICB | cdABkBAJ[> | cl^> i 1UV1WZ]^ | Bh1BI`Y^I[1 9eRaaL_X: | |
| cICD | cU>RkCCC[> | cITRcS`_1WZ]^ | B@GIC7C\i`Y^I[| |
| cICE | cU>RkBAD[> | cITRcS`_1WZ]^ | B@GIBAI`Y^I[| |
| cICF | cU>RkDDD[> | cITRcS`_1WZ]^ | B@GIDD\i`Y^I[| |
| cICG | cU>RkDDC[> | cITRcS`_1WZ]^ | B@GID7D\i`Y^I[| |
| cICH | cU>RkDDC[> | cITRcS`_1WZ]^ | B@GID7D\i`Y^I[| |
| cICI | cU>RkBAC[> | cITRcS`_1WZ]^ | B@GIB\i`Y^I[| |
| cICJ | cU>RkBAC[> | cITRcS`_1WZ]^ | B@GIB\i`Y^I[| |
| cIDA | cU>CkEHC[> | cITRcS`_1WZ]^ | B@CIE7H\i`Y^I[| |
| cIDB | cU>CkGID[> | cITRcS`_1WZ]^ | B@CIC7C\i`Y^I[| |
| cIDC | cU>CkBFC[> | cITRcS`_1WZ]^ | B@CIB7F\i`Y^I[| |
| cIDD | cWABkGII[> | c1Wfd[S]V | Bh1A7GI\i`Y^I[1 9eRaaL_X: | |
| cIDE | cWABkGII[> | c1Wfd[S]V | Bh1A7GI\i`Y^I[1 9eRaaL_X: | |
| cIDF | cU>RkFGC[> | cITRcS`_1WZ]^ | B@GIF7G\i`Y^I[| |
| cIDG | cU>RkBAD[> | cITRcS`_1WZ]^ | B@GIBAI`Y^I[| |
| cIDH | cU>RkFGD[> | cITRcS`_1WZ]^ | B@GIFG\i`Y^I[| |
| cIDI | cWABkCCI[> | c1Wfd[S]V | Bh1A7CCI`Y^I[1 9eRaaL_X: | |
| cIEB | cU>RkBAC[> | cITRcS`_1WZ]^ | B@GIB\i`Y^I[| |
| cIFB | cU>CkCCD[> | cITRcS`_1WZ]^ | B@CICC7C\i`Y^I[| |
| cIFJ | cT>CkCCF[> | cITRcS`_1T`^a | B@CIC7C^i`Y^I[| |
| cIGA | cU>RkEHC[> | cITRcS`_1WZ]^ | B@CIE7H\i`Y^I[| |
| cIGB | cdABkBAC[> | cl^> i 1UV1WZ]^ | Bh1B\i`Y^I[1 9eRaaL_X: | |
| cJAC | I FI ABAGFXj | h7cVIT`aaVc | Rh7XCIB7A7G7FeL`IT`ReL_X | |
| cJAD | cU>RkJBB[> | cITRcS`_1WZ]^ | B@GIJBAI`Y^I[| |

| J`T | aRce>T`UV | aRce>_R^V | aRce>UVdT |
|-------|--------------|---------------|-------------------------|
|]IAJ | F^TAAABAA | T`J]ISVRU | YT>DFFA |
|]IBC | Fa]WDFDA> | WZ]eVcI]Z_V |]W>DFDA |
|]IBD | F^TAAABAA | T`J]ISVRU | YT>DFFA |
|]IBF | F^TAAABAA | T`J]ISVRU | YT>DFFA |
|]IBG | F^TAAABAA | T`J]ISVRU | YT>DFFA |
|]IBH | F^TAAABAA | T`J]ISVRU | YT>DFFA |
|]JAC | FTai DDA[> | T`J]laVR\Z_X | DDfYI[1 %cRUZR]: |
|]JAD | FTai DDA[> | T`J]laVR\Z_X | DDfYI[1 %cRUZR]: |
|]JAE | FTai DDA[> | T`J]laVR\Z_X | DDfYI[1 %cRUZR]: |
|]WAC | I FI ABAGFXj | hZcVIT`aaVc | RhXCCIB^AGFleZ_1T`ReZ_X |
| ^AAB | EI FGI BCAAB | eVITRS]V | _j`_GGIURBAA |
| ^AAC | EI FGI BCAAB | eVITRS]V | _j`_GGIURBAA |
| ^AAD | EI FGI BCAAB | eVITRS]V | _j`_GGIURBAA |
| ^AAE | EI FGI BGDA | T]R^aIhZcV | _j`_IGI %gA: |
| ^AAF | EI FGI BCAAB | eVITRS]V | _j`_GGIURBAA |
| ^AAG | CCCEAFAEC | [Vel^V]e | DHEI b |
| ^CAB | EI FCAGGAAB | ^Rd\Wc`_e | YladIS\ |
| ^CABR | EI FGABFI CA | dTcVhITcelWZi | dhc^<d\FI]NDF |
| ^CABS | EI FGCBFEAC | hRdYVclcfSSVc | Tc |
| ^CBB | EI FCBFACBA | T`gVcISRT\ | WclYladIS\ |
| ^CBBR | HBCCEABGBC | dTcVhleRaaZ_X | eCdlecdIEi BGI^Wk_IS\ |
| ^CBBS | HBCCEABGBC | dTcVhleRaaZ_X | eCdlecdIEi BGI^Wk_IS\ |
| ^CBBT | HBCI DABCBC | dTcVhleRaaZ_X | eCdIhRdIDi BCI^Wk_IS\ |
| ^CDB | EI FCDCEDAB | aR_V]I] | RSdIS\ |
| ^CDC | EI FCDCCEAB | aR_V]Ic | RSdIS\ |
| ^CIB | EI FCI CBBAB | U` `c | RSdIS\ |
| ^DFB | EI FDFCGGAA | Y` JUVcIT`cU | _j`_G %URTS:BI D: |
| ^DFBR | HBCCEABGBC | dTcVhleRaaZ_X | eCdlecdIEi BGI^Wk_IS\ |
| ^DIB | EI FDI BGEBA | WcR^VidfStaTS | WclYladIS\ |
| ^DIBR | HBCI DABCBC | dTcVhleRaaZ_X | eCdIhRdIDi BCI^Wk_IS\ |
| ^EIB | EI FEI FDCAB | Sfee`_la`hVc | RSdIS\ |
| ^EIBR | EI FGHBJAA | dacZ_X | dhaR |
| ^FAB | EI FFAFI ECB | UVT`ITec] | agTleA^CF |
| ^FEB | EI FFEFIAA | daVTla]ReV | BFARcela^VWZ]]^1 %T%eg: |
| ^FFB | EI FFFDEJAB | UVT`ldV_d`c | a^ ^RIT] |
| ^FFBR | HBCI DABCBC | dTcVhleRaaZ_X | eCdIhRdIDi BCI^Wk_IS\ |
| ^FGB | EI FFBHEDU | ^Rc\ScR_U | dZ]gVclUIR>TfeeZ_X |
| ^GEB | GFCABABAA | deRa]ViaZ_ | BI ^e^I[UI` |
| ^GIB | EI FGI BCEAA | SR_U | BI ^e^I ID^ |
| ^GIB | EI FGI BCAAB | eVITRS]V | _j`_GGIURBAA |
| ^HIB | EI FHI CAAB | TJ`eYIS]RT\ | TJ`eYIS]IBCI DCAI eA?F |
| ^HIC | EI FHI BHGDA | TJ`eYIS]RT\ | WV]eleA^HI]NEAA |
| ^HJB | EI FHJCDAA | U` `cl]T` \ |]RHAB %\ZWT`: |
| ^IAB | EI FIAFDBb\ | S` iITRce`_ | Uh>Ed |
| ^IAB | EI FGI BDGAA | Y` JUVclhZcV | _j`_IGGIURhY>BD_R |
| ^IBB | EI FIBI FBAB | aRU | VadICJXD |
| aGAB | EI FJCDFCCd | T`_JhRWVc | j hACF>AJ |
| aGAC | EI FJCDGCA | T`_JhRWVc | j hACF>AD |
| aGAD | EI FJCDGCA | T`_JhRWVc | j hACF>AD |
| aHAB | EI FJCDFCA | T`_JhRWVc | j hACF>BA |
| aHAC | EI FJCDFCCd | T`_JhRWVc | j hACF>AJ |
| aJAB | EI FJCDHCD | T`_JhRWVc | j hACF>AE |
| aJAC | EI FJCDBI Cd | T`_JhRWVc | j hACF>AF |
| aJAD | EI FJCDI GCA | T`_JhRWVc | j ahFAA>AC |
| aREAB | EI FAHAEdDE | T`_JIRd | j WYIAA>AE< |
| aRGAB | EI FAHAJdAB | T`_JIRd | j YACF>AJ< |
| aRGAC | EI FAHADdFE | T`_JIRd | j YACF>AD< |

| J`T | aRce>T`UV | aRce>_R^V | aRce>UVdT |
|-------|-------------|-----------------|---------------------------|
| aRGAD | EI FAHADdFE | T`_JIRd | j YACF>AD< |
| | | | DFAJI <f]hNGAA |
| aRHAB | EI FAHBagAE | T`_JIRd | j YACF>BA< |
| aRIAB | EI FAHABdAH | T`_JIRd | j WYIAA>AB< |
| aRJAB | EI FAHAEdAE | T`_JIRd | j YACF>AE |
| aRJAC | EI FAHAFdAE | T`_JIRd | j YACF>AF |
| aTAB | EI FJJAEebb | T`cUla`hVc | {a>gWWC>A^HF^ ^NCDFA |
| bBAB | e\eTDBJH> | ec | \eTDBJHI %ea: |
| bCAB | e\eTDBJIj> | ec | \eTDBJIj |
| bCAC | e\eTDBJIj> | ec | \eTDBJIj |
| bCAD | e\eRBCGGj> | ec | \eRBCGGj 1 %ea: |
| bCAE | e\eRBCGGj> | ec | \eRBCGGj 1 %ea: |
| bCAF | e\eTDBJIj> | ec | \eTDBJIj |
| bEAB | ae]CdHhGAC | YVReIdZ_\IRddqj | eCdUCFFD>]<IHBHEDABABB |
| bEAB | eCdUCFFD> | ec | CdUCFFD |
| bEABR | EI FHACHGAC | YVReIdZ_\ | R]Ivi |
| bEABS | HBHEDABABB | dTcVhleRaaeLeV | eeCic_UIDi BA1^Wk_ |
| bEAC | eCdTBFGJ> | ec | CdTBFgJ |
| bEAD | aeSCdhHGAC | YVReIdZ_\IRddqj | e\eUCAFIj>]<IHBHEDABABB |
| bEAE | e\eRBCGGj> | ec | \eRBCGGj 1 %ea: |
| bEAF | e\eTDBJIj> | ec | \eTDBJIj |
| bFAB | e\eTDBJIj> | ec | \eTDBJIj |
| bGAB | e\eTDBJIj> | ec | \eTDBJIj |
| bGBJ | e\eTDBJIj> | ec | \eTDBJIj |
| bGCA | e\eTDBJIj> | ec | \eTDBJIj |
| bGCB | e\eRBCGGj> | ec | \eRBCGGj 1 %ea: |
| bHAB | e\eTDBJIj> | ec | \eTDBJIj |
| bHAC | e\eTDBJIj> | ec | \eTDBJIj |
| bHAD | e\eTDBJIj> | ec | \eTDBJIj |
| bHAE | e\eTDBJIj> | ec | \eTDBJIj |
| bHAF | e\eTDBJIj> | ec | \eTDBJIj |
| bHAG | e\eTDBJIj> | ec | \eTDBJIj |
| bHAH | e\eTDBJIj> | ec | \eTDBJIj |
| bIAB | eCdTEHJD> | ec | CdTEHJD |
| bIAC | e\eTDBJIj> | ec | \eTDBJIj |
| bIAD | e\eTDBJIj> | ec | \eTDBJIj |
| bIAE | e\eRBCGGj> | ec | \eRBCGGj 1 %ea: |
| bIAF | e\eRJGIj> | ec | \eRJGIj> |
| bIAH | e\eTDBJIj> | ec | \eTDBJIj |
| bJAB | e\eRBCGGj> | ec | \eRBCGGj 1 %ea: |
| bTCAB | eCdTBGCD> | ecITYZa | CdTBGCD>]G%eCS |
| cBAB | cdABkBI B[> | cl^> i ZUVWZ] ^ | BhIBI AI` Y^I[1 %eRaaZ_X: |
| cBAH | cU>RkFGC[> | clTRcS`_IWZ] ^ | B%GIFG^i` Y^I[|
| cBBC | cU>RkDAB[> | clTRcS`_IWZ] ^ | B%GIDAAI` Y^I[|
| cBBD | cdABkDDD[> | cl^> i ZUVWZ] ^ | BhIDD^i` Y^I[1 %eRaaZ_X: |
| cCAB | cU>RkBAC[> | clTRcS`_IWZ] ^ | B%GIB^i` Y^I[|
| cCAF | cU>RkEHD[> | clTRcS`_IWZ] ^ | B%GIEH^i` Y^I[|
| cCAG | cU>RkDDC[> | clTRcS`_IWZ] ^ | B%GID^i` Y^I[|
| cCAH | cU>RkBAB[> | clTRcS`_IWZ] ^ | B%GIBAAI` Y^I[|
| cCAI | cU>RkBAC[> | clTRcS`_IWZ] ^ | B%GIB^i` Y^I[|
| cCAJ | cU>RkBAC[> | clTRcS`_IWZ] ^ | B%GIB^i` Y^I[|
| cCBA | cU>RkBAB[> | clTRcS`_IWZ] ^ | B%GIBAAI` Y^I[|
| cDAC | cU>RkCCC[> | clTRcS`_IWZ] ^ | B%GIC^i` Y^I[|
| cDAD | cdACKBAC[d | cl^> i ZUVWZ] ^ | ChIB^i` Y^I[Id^R]] |
| cDAE | cdACKCHB[d | cl^> i ZUVWZ] ^ | ChICHAI` Y^I[Id^R]] |
| cDAF | cU>RkBCE[> | clTRcS`_IWZ] ^ | B%GIBCA^i` Y^I[|
| cDAI | cdACKBCJ[d | cl^> i ZUVWZ] ^ | ChIBCI` Y^I[Id^R]] |

| J`T | aRce>T`UV | aRce>_R^V | aRce>UVdT |
|-------|-------------|-----------------|---------------------------|
| UEAC | UcXaDA[>>> | U`UV | cXaDA[|
| UEAD | UcXaBF[>>> | U`UV | cXaBF[|
| UEAE | UcXaBF[>>> | U`UV | cXaBF[|
| UEAF | UcXaBF[>>> | U`UV | cXaBF[|
| UFAB | UfKdCDS>>> | U`UViKV_Vc | fK>D`DS |
| UFAC | UB_EBEI>>> | U`UV | B_EBEI1`%RaaL_X: |
| UFAD | U^ekJcBT>> | U`UViKV_Vc | ^ekJfB>T1`%RaaL_X: |
| UFAE | UB_EJDGXa>> | U`UV | B_EJDGXa1`%RaaL_X: |
| UFAF | UB_EBEI>>> | U`UV | B_EBEI1`%RaaL_X: |
| UFAG | UB_EBEI>>> | U`UV | B_EBEI1`%RaaL_X: |
| UFAH | UB_EBEI>>> | U`UV | B_EBEI1`%RaaL_X: |
| UFAI | UB_EBEI>>> | U`UV | B_EBEI1`%RaaL_X: |
| UFAJ | U^ekFcGS>> | U`UViKV_Vc | ^ekJfG>S1`%RaaL_X: |
| UFBA | U^ekFcGS>> | U`UViKV_Vc | ^ekJfG>S1`%RaaL_X: |
| UFBB | U^ekJcBT>> | U`UViKV_Vc | ^ekJfB>T1`%RaaL_X: |
| UFBC | U^ekJcBT>> | U`UViKV_Vc | ^ekJfB>T1`%RaaL_X: |
| UFBD | U^ekJcBT>> | U`UViKV_Vc | ^ekJfB>T1`%RaaL_X: |
| UFBE | UB_EBEI>>> | U`UV | B_EBEI1`%RaaL_X: |
| UHAB | UB_EBEI>>> | U`UV | B_EBEI1`%RaaL_X: |
| UHAC | U^ekGcCS>> | U`UViKV_Vc | ^ekJfG>S1`%RaaL_X: |
| UHAE | UB_EBEI>>> | U`UV | B_EBEI1`%RaaL_X: |
| UIAB | aeUCdhHHAe | YVReIdL`_lRddqj | UUFdSRGA>>>l<IHBHEDABABB |
| ⊕UIAB | UUFdSRGA>> | U`UV | UfDsrGA |
| UIABR | EI FHACHHAe | YVReIdL`_l | R]Ivi |
| UIABS | HBHEDABABB | dTcVhleRaaeLeV | eeClc_UIdi BAI^Wk_ |
| UIAD | UcXaBF[>>> | U`UV | cXaBF[|
| UIAE | UcXaBF[>>> | U`UV | cXaBF[|
| UIAF | UcXaBF[>>> | U`UV | cXaBF[|
| UIAG | UcXaBF[>>> | U`UV | cXaBF[|
| UIAH | UfKkHfS^>> | U`UViKV_Vc | fK>HfS^IHfFg |
| UIAI | UB_EAAD>>> | U`UV | B_EAAD1`%RaaL_X: |
| UIAJ | UB_EAAD>>> | U`UV | B_EAAD1`%RaaL_X: |
| UIBA | UB_EBEI>>> | U`UV | B_EBEI1`%RaaL_X: |
| UIBB | UB_EBEI>>> | U`UV | B_EBEI1`%RaaL_X: |
| UIBC | UB_EBEI>>> | U`UV | B_EBEI1`%RaaL_X: |
| UIBE | UcXaDA[>>> | U`UV | cXaDA[|
| UIBF | UcXaDA[>>> | U`UV | cXaDA[|
| ⊕UIBG | UVXaFAU>>> | U`UV | VXaFAU1`%RaaL_X: |
| UIBH | UB_EBEI>>> | U`UV | B_EBEI1`%RaaL_X: |
| ⊕UIBJ | UVXaFAU>>> | U`UV | VXaFAU1`%RaaL_X: |
| UICA | UfKbDS^>>> | U`UViKV_Vc | fK>BDS^ |
| UJAB | UBdBI11>>> | U`UV | BdBI111`%RaaL_X: |
| UJAC | UB_EBEI>>> | U`UV | B_EBEI1`%RaaL_X: |
| UJAD | UB_EBEI>>> | U`UV | B_EBEI1`%RaaL_X: |
| UJAE | UB_EBEI>>> | U`UV | B_EBEI1`%RaaL_X: |
| UJAF | UB_EBEI>>> | U`UV | B_EBEI1`%RaaL_X: |
| UWAB | UdcFE^ghD> |]VU | dacFEI^ghicVU*%CvV_ |
| UWABR | EI FDFDDGAA | Y`JUVci]VU | a`aIS\ |
| WIAB | FW[XSGDCB] | Wfdv | [Idi^WfBIG`DRIBCFgle] |
| WIABR | EI FHEBFAAB | T]JaWfdv | aWTFAAA>AHAC |
| WIABS | EI FHEBFAAB | T]JaWfdv | aWTFAAA>AHAC |
| XJAB | EdXAUAAABAD | daRc\IXRa | d>CDJJAAG>Bf`g |
| XJAC | EdXAUAAABAD | daRc\IXRa | d>CDJJAAG>Bf`g |
| XJAD | EdXAUAAABAD | daRc\IXRa | d>CDJJAAG>Bf`g |
| ZCAB | BeRI HEH>> | IT | eRI HEH_ |
| ZDAB | aeSCdhHJAE | YVReIdL`_lRddqj | BeRI ECH>>>l<IHBHEDAAI BB |
| ZDAB | BeRI ECH>> | IT | eRI ECH\ |

| J`T | aRce>T`UV | aRce>_R^V | aRce>UVdT |
|-------|--------------|------------------|----------------------------|
| ZDABR | EI FHACHJAE | YVReIdL`_l | R]Ivi 1`9R_AUzkV: |
| ZDABS | HBHEDAAI BB | dTcVhleRaaeLeV | eeClc_UIdi 11^Wk_ |
| ZFAB | BeRBCGI _>> | IT1^RL | eRBCGI _ |
| ZGAB | BeRBCDAK>> | ITIRfU1` | eRBCDAK |
| ZGAD | BfaTBEAGYR | IT | faTIBEAGYR |
| ZGAE | aeRCdhI AAC | YVReIdL`_lRddqj | BeURCGBF>>>l<IHBHEDAAI BB |
| ZGAE | BeURCGBF>> | ITIR^a | eURCGBF |
| ZGAER | EI FHACI AAC | YVReIdL`_l | R]Ivi |
| ZGAES | HBHEDAAI BB | dTcVhleRaaeLeV | eeClc_UIdi 11^Wk_ |
| ZHAC | BCE]TACS>> | IT1^V^`cj | CE]TACS |
| ZHAD | B\BRHAECa> | ITIdhleTY | \IRHAECa |
| ZIAB | ae]CdhGFAA | YVReIdL`_lRddqj | BdecGHAI >>l<IHBHEDABCCBB |
| ZIAB | BdecdGHAI> | ITla`hVc | dec>dGHAI |
| ZIABR | EI FHACGFAA | YVReIdL`_l | R]Ivi |
| ZIABS | HBHEDABCCBB | dTcVhleRaaeLeV | eeClc_UIdi BC1^Wk_ |
| ZIAC | B]egI BHT>> | ITlaY`e`IT`fa]Vc |]eg>l BHT |
| ZIAD | BdVBDA>>> | IT | dVBDA_ |
| ZIAF | B\BRHI AFaB | ITlcVxf]Re`c | \IRHI AFaB |
| ZIAG | aeWCdhHAI AB | YVReIdL`_lRddqj | B\BRHI AJ>>l<IHBHEDAAI BB |
| ZIAG | B\BRHI AJ>> | ITlcVxf]Re`c | \IRHI AJ |
| ZIAGR | EI FHACHI AB | YVReIdL`_l | R]Ivi IS\ |
| ZIAGS | HBHEDAAI BB | dTcVhleRaaeLeV | eeClc_UIdi 11^Wk_ |
| ZJAB | aeRCdhFEAA | YVReIdL`_lRddqj | BeURGBADb>>l<IHBHEDAAI BB |
| ZJAB | BeURGBADb> | ITlgUV` | eURGBADb |
| ZJABR | EI FHACFEAA | YVReIdL`_l | RBAFAa>YCEleCA |
| ZJABS | HBHEDAAI BB | dTcVhleRaaeLeV | eeClc_UIdi 11^Wk_ |
| ZWAB | BeW^hFDIA> | ITlacVR^a | eW^hFDIA |
| [aWAB | EI FJBACBDA | [RT\IVRcaY`_V | j dT>BFDH |
| [aWAC | EI FJBAl EFA | [RT\laL`IS`RcU | j dTADa>EBCa>BER |
| [gAB | EI FJBAGEEA | [RT\ld>gYd | aY>d>]JFAD |
| [gAC | EI FJBHAFA | [RT\laL`IS`RcU | aY>[S>JGAB] %aYAGa>EBCa>T: |
|]BAB | FTakFGA\AC | T`Z]laVR\X | FGFY\N\ 9RI ZR]IDfF^>> |
|]BAC | FI SAAAAdIF | T`Z]laZW | ecW>FAAC`%deLT\: |
|]BAD | FI SAAAAdIF | T`Z]laZW | ecW>FAAC`%deLT\: |
|]BAE | FTakGI A\AC | T`Z]laVR\X | GI fY\N\ 9RI ZR]IDfF^>> |
|]BAF | FI _AAAAdDJ | T`Z]lgT` | ecW>gAAF |
|]CAB | FTakBAA\AC | T`Z]laVR\X | BAFY\N\ 9RI ZR]IDfF^>> |
|]CAC | FTakGI J\AC | T`Z]laVR\X | Gf fY\N\ 9RI ZR]IDfF^>> |
|]EAB | IFi ABAGFXj | hlcVIT`aaVc | RhXCCIB*%GfLeL`IT`ReL_X |
|]EAC | FI hAAAAABI | T`Z]IhZUeY | e]_>CAJC |
|]EAE | FI YBGAAACC | T`Z]IY>]_VRclej | ec]_>CAJD |
|]EAF | FI THAAAI F | T`Z]ITY`_VV | e]_>DAGCR |
|]FAB | FTakFGJ\AC | T`Z]laVR\X | F'GFY\N\ 9RI ZR]IDfF^>> |
|]FAD | FTakDDA\AC | T`Z]laVR\X | DDFY\N\ 9RI ZR]IDfF^>> |
|]GAB | FI dAAAAdeB | T`Z]IdZW | ecW>FAAET`%deLT\: |
|]GAC | FTakeHA\AC | T`Z]laVR\X | EHFY\N\ 9RI ZR]IDfF^>> |
|]GAD | IFi ABAGFXj | hlcVIT`aaVc | RhXCCIB*%GfLeL`IT`ReL_X |
|]GAE | FTakeHA\AC | T`Z]laVR\X | EHFY\N\ 9RI ZR]IDfF^>> |
|]GAF | IFi ABAGFXj | hlcVIT`aaVc | RhXCCIB*%GfLeL`IT`ReL_X |
|]GAG | FTakBAA\AC | T`Z]laVR\X | BAFY\N\ 9RI ZR]IDfF^>> |
|]HAB | FTakDDA\AC | T`Z]laVR\X | DDFY\N\ 9RI ZR]IDfF^>> |
|]HAC | FTakFGJ\AC | T`Z]laVR\X | F'GFY\N\ 9RI ZR]IDfF^>> |
|]IAB | Fae]WDACE> | W]eVcI]_V | e]W>DACE |
|]IAC | F^TAAABAA | T`Z]ISVRU | YT>DFFA |
|]IAD | FI TAAAAAJG | T`Z]ITY`_VV | GBXACDD`%EHA\: |
|]IAH | FI TAAAAAJG | T`Z]ITY`_VV | GBXACDD`%EHA\: |
|]IAI | FI TAAAAAJG | T`Z]ITY`_VV | GBXACDD`%EHA\: |

| J`T | aRce>T`UV | aRce>_R^V | aRce>UVdT |
|--------|-------------|---------------|-----------------------------|
| TGEG | TVi WBgBACg | TIV]VTec` | DFgicddIBAA^W 9BDi CF: lea |
| TGEH | T^i SBYCCE[| Ti^j]Rc | FAGlVFIA^CC^W[1 9ea: |
| TGEI | T^i ^CRCCD[| Ti^j]Rc | BAAGIA^ACC^W[1lea |
| THBE | TVi WBYBAAg | TIV]VTec` | FAGlcddIBA^W 9Fi BB: lea |
| THBI | TVi WBTBABg | TIV]VTec` | BGgicddIBAA^W 9GDi BB: lea |
| THBJ | TVi WBYBAAg | TIV]VTec` | FAGlcddIBA^W 9Fi BB: lea |
| ⊕ TIAB | T]B[SDBAE^ | Ti]_VIRTc` dd | RTCFAGIA^B^W^iVTb>fghiC] |
| ⊕ TIAC | T]B[SDBAE^ | Ti]_VIRTc` dd | RTCFAGIA^B^W^iVTb>fghiC] |
| ⊕ TIAD | TYBRVCCC^ | TITVcRIRT | C?F\gICCAaW^i^YIUVBAAH |
| ⊕ TIAE | TYBRVCCC^ | TITVcRIRT | C?F\gICCAaW^i^YIUVBAAH |
| ⊕ TIAF | TYBRVVEHC^ | TITVcRIRT | C?F\gIEHAAaW^i^YIUVBDAH |
| ⊕ TIAg | TYBRVVEHC^ | TITVcRIRT | C?F\gIEHAAaW^i^YIUVBDAH |
| ⊕ TIAH | TYBRVVEHC^ | TITVcRIRT | C?F\gIEHAAaW^i^YIUVBDAH |
| ⊕ TIAI | TYBRVVEHC^ | TITVcRIRT | C?F\gIEHAAaW^i^YIUVBDAH |
| ⊕ TIAJ | TYBRVVEHC^ | TITVcRIRT | C?F\gIEHAAaW^i^YIUVBDAH |
| TIBA | TVj aCUBCCS | TIV]VTec` | CAAgIWfYIBCAA^W 9DFI EA: |
| TIBB | TTj SCYBAD\ | TITVcR | FAAgISIA^B^W\ |
| TIBC | TTj cDUBAC\ | TITVcR | C\gicIBAAaW\IBCFT |
| TIBD | TVi WBVBABg | TIV]VTec` | CFgicddIBAA^W 9GDi BB: lea |
| TIBE | TVi WCRBAAg | TIV]VTec` | BAAgicddIBA^W 9GDi BB: lea |
| TIBF | TTi SCYBAC\ | TITVcR | FAAgISIBAAaW\i 9eRaaL_X: |
| TIBG | TVi WBVCCBg | TIV]VTec` | CFgicddICCA^W 9i BB?F: lea |
| TIBH | TYBRVVEHC^ | TITVcRIRT | C?F\gIEHAAaW^i^YIUVBDAH |
| TIBI | TTj cDUBAC\ | TITVcR | C\gicIBAAaW\IBCFT |
| TIBJ | TVi WBVBACg | TIV]VTec` | CFgicddIBAA^W 9BDi CA: lea |
| TICA | TSkWBABAEk | TITVcRIRi ZR] | FAGIWIa^B^W\k |
| TICB | TSkWBABAEk | TITVcRIRi ZR] | FAGIWIa^B^W\k |
| TICC | TVi WBgBABg | TIV]VTec` | DFgicddIBAA^W 9i BB?F: lea |
| TICD | TTi SDUBAB\ | TITVcR | C\gISIBAAaW\i 9eRaaL_X: |
| TICE | TVj WBgCCCT | TIV]VTec` | DFgicf dICCAA^W 9BGi DB?F: |
| TICG | TSi WBABAEk | TITVcRIdV^Z | FAGIWIa^B^W\k 9eRaaL_X: |
| TICH | TTj cDUBAC\ | TITVcR | C\gicIBAAaW\IBCFT |
| TICI | TVj aCUEHBT | TIV]VTec` | CAAgI]fYIEHA^W 9CF: DF: |
| TICJ | TTj SCYBAD\ | TITVcR | FAAgISIA^B^W\ |
| TIDA | TTi SCYBAB\ | TITVcR | FAAgISIBAAaW\i 9eRaaL_X: |
| TIDB | TVi WBVBACg | TIV]VTec` | CFgicddIBAA^W 9BDi CA: lea |
| TIDC | TTkWBVBADk | TITVcR | CFgIWIa^B^W\k 9Ri ZR]: |
| TIDD | TVi WBYYCAG | TIV]VTec` | FAGlcddICC^W 9Fi BB: lea |
| TIDE | TTkWBVBADk | TITVcR | CFgIWIa^B^W\k 9Ri ZR]: |
| TIDF | TVi WBYYCAG | TIV]VTec` | FAGlcddICC^W 9Fi BB: lea |
| TIDG | TTj SCYBAD\ | TITVcR | FAAgISIA^B^W\ |
| TIEC | TVi WBTEHBg | TIV]VTec` | BGgicddIEHA^W 9BAi BC?F: ea |
| TIED | TSkWBABAEk | TITVcRIRi ZR] | FAGIWIa^B^W\k |
| TIEF | TVi WBVBABg | TIV]VTec` | FAGlcddIBAA^W 9i BB?F: lea |
| TIFB | TVi WBVEHJg | TIV]VTec` | FAGlcddIEH^W 9Fi BB: lea |
| TIFC | TSi WBABAEk | TITVcRIdV^Z | FAGIWIa^B^W\k 9eRaaL_X: |
| TJAC | Tkd]BYCHA[| TITVcR | FAGId]ICHaW[1 9Ri ZR]: |
| TJAD | TkTYBYCAA[| TITVcR | FAGlTYICAaW[1 9Ri ZR]: |
| TJAE | TVi WCVCCJg | TIV]VTec` | CFAGlcddIC^W 9i BB?F: ea |
| TJAF | T^i SBYCCE[| Ti^j]Rc | FAGlVFIA^CC^W[1 9ea: |
| TJAH | TVj WCVHAAG | TIV]VTec` | CFAGlcddIEH^W 9BGi CF: |
| TJAI | TVj WCVBAAG | TIV]VTec` | CFAGlcddIBA^W 9BAi CA: |
| TJBA | TTj SDUEHC\ | TITVcR | C\gISIEHAAaW\ |
| TJBB | TVi WBTBABg | TIV]VTec` | BGgicddIBAA^W 9GDi BB: lea |
| TTAB | YTb\EHA[TR | TITYIaITVcR | FAGlTYIEHaW[1ICABC |
| TTAC | YTb\BAB[TR | TITYIaITVcR | FAGlTYIBAAaW[1ICABC |
| TTAF | YTW\BADkTR | TITYIaITVcR | FAGlj FgIA^B^W\kICABC |
| TTAG | YTb\BAB[TR | TITYIaITVcR | FAGlTYIBAAaW[1ICABC |

| J`T | aRce>T`UV | aRce>_R^V | aRce>UVdT |
|-------|--------------|-------------|---------------------------|
| TTAH | YTSYBAE\TR | TITYIaITVcR | CFgIi HciA^B^W\kICABC |
| TTAI | YTb\EHA[TR | TITYIaITVcR | FAGlTYIEHaW[1ICABC |
| TTAJ | YTb\EHA[TR | TITYIaITVcR | FAGlTYIEHaW[1ICABC |
| TTBA | YTb\EHA[TR | TITYIaITVcR | FAGlTYIEHaW[1ICABC |
| TTBAD | YTW\BADkTR | TITYIaITVcR | FAGlj FgIA^B^W\kICABC |
| TTBAE | YTW\BADkTR | TITYIaITVcR | FAGlj FgIA^B^W\kICABC |
| TTBAH | YTW\BADkTR | TITYIaITVcR | FAGlj FgIA^B^W\kICABC |
| TTBAI | YTW\BADkTR | TITYIaITVcR | FAGlj FgIA^B^W\kICABC |
| TTBAJ | YTW\BADkTR | TITYIaITVcR | FAGlj FgIA^B^W\kICABC |
| TTBB | YTb\EHA[TR | TITYIaITVcR | FAGlTYIEHaW[1ICABC |
| TTBBA | YTW\BADkTR | TITYIaITVcR | FAGlj FgIA^B^W\kICABC |
| TTBBB | YTW\BADkTR | TITYIaITVcR | FAGlj FgIA^B^W\kICABC |
| TTBBC | YTW\BADkTR | TITYIaITVcR | FAGlj FgIA^B^W\kICABC |
| TTBC | YTb\BCA[TR | TITYIaITVcR | FAGlTYIBCaW[1ICABC |
| TTBD | YTb\BCA[TR | TITYIaITVcR | FAGlTYIBCaW[1ICABC |
| TTBF | YTb\DAa[TR | TITYIaITVcR | FAGlTYIDaW[1ICABC |
| TTBG | YTb\DAa[TR | TITYIaITVcR | FAGlTYIDaW[1ICABC |
| TTCA | YTW\BADkTR | TITYIaITVcR | FAGlj FgIA^B^W\kICABC |
| TTCAB | YTb\BAB[TR | TITYIaITVcR | FAGlTYIBAAaW[1ICABC |
| TTCAC | YTb\BAB[TR | TITYIaITVcR | FAGlTYIBAAaW[1ICABC |
| TTCB | YTW\BADkTR | TITYIaITVcR | FAGlj FgIA^B^W\kICABC |
| TTCDE | YTW\BADkTR | TITYIaITVcR | FAGlj FgIA^B^W\kICABC |
| TTEAB | YTb\BAB[TR | TITYIaITVcR | FAGlTYIBAAaW[1ICABC |
| TTFAB | YTW\BADkTR | TITYIaITVcR | FAGlj FgIA^B^W\kICABC |
| TTFAC | YTW\BADkTR | TITYIaITVcR | FAGlj FgIA^B^W\kICABC |
| TTFAI | YTb\BAaUTR | TITYIaITVcR | FAGlTYIBaW\UICABC |
| TTFAJ | YTW\BADkTR | TITYIaITVcR | FAGlj FgIA^B^W\kICABC |
| TTFBF | YTW\BADkTR | TITYIaITVcR | FAGlj FgIA^B^W\kICABC |
| TTFBJ | YTW\BADkTR | TITYIaITVcR | FAGlj FgIA^B^W\kICABC |
| TTFCD | YTb\CAA[TR | TITYIaITVcR | FAGlTYICaW[1ICABC |
| TTFEA | YTW\BADkTR | TITYIaITVcR | FAGlj FgIA^B^W\kICABC |
| TTGAB | YTS\BAC\TR | TITYIaITVcR | FAGIi HciBAAaW\kICABC |
| TTGAC | YTb\BAB[TR | TITYIaITVcR | FAGlTYIBAAaW[1ICABC |
| TTGAD | YTb\EBH[TR | TITYIaITVcR | FAGlTYIEHaW[1ICABC |
| TTGAE | YTb\EBH[TR | TITYIaITVcR | FAGlTYIEHaW[1ICABC |
| TTGAF | YTW\BADkTR | TITYIaITVcR | FAGlj FgIA^B^W\kICABC |
| TTGAG | YTb\CHA[TR | TITYIaITVcR | FAGlTYICHaW[1ICABC |
| TTGAH | YTW\BADkTR | TITYIaITVcR | FAGlj FgIA^B^W\kICABC |
| TTHBH | YTW\BADkTR | TITYIaITVcR | FAGlj FgIA^B^W\kICABC |
| TTHBI | YTb\BAB[TR | TITYIaITVcR | FAGlTYIBAAaW[1ICABC |
| TTHBJ | YTb\BAB[TR | TITYIaITVcR | FAGlTYIBAAaW[1ICABC |
| TTHCA | YTW\BADkTR | TITYIaITVcR | FAGlj FgIA^B^W\kICABC |
| TWAB | TVi WBVEHAg | TIV]VTec` | FAGlcddIEH^W 9GDi BB: lea |
| TWAC | TVi WBYBAAg | TIV]VTec` | FAGlcddIBA^W 9Fi BB: lea |
| TWAD | TVi WBYYCCJg | TIV]VTec` | FAGlcddIC^W 9Fi BB: lea |
| TWAE | TVi WBYYCCJg | TIV]VTec` | FAGlcddIC^W 9Fi BB: lea |
| TWAF | TVi WBYBAAg | TIV]VTec` | FAGlcddIBA^W 9Fi BB: lea |
| TWCAB | Fai adEF^S> | W]eVcITVcR | ead:E?F^SlecRaI 9eRaaL_X: |
| TWGAB | Fai WdYEcF^ | W]eVcITVcR | dWdY?F^TS>eWCBi 9ea: |
| UBAB | BfaTFHE[>> | IT | faTFHE[|
| UBAC | U^ekFcBS>> | U^ UViKV_Vc | ^ekIF?B>S 9eRaaL_X: |
| UDAB | UB_EJDGXa> | U^ UV | B_EJDGXaI 9eRaaL_X: |
| UDAC | UB_EJDGXa> | U^ UV | B_EJDGXaI 9eRaaL_X: |
| UDAD | UB_EAAD>>> | U^ UV | B_EAADi 9eRaaL_X: |
| UDAE | UB_EAAD>>> | U^ UV | B_EAADi 9eRaaL_X: |
| UDAF | UB_EBEI>>> | U^ UV | B_EBEIi 9eRaaL_X: |
| UEAB | USj CCI>>>> | U^ UV | Sj CCIi 9eRaaL_X: |

~ (⊕) Q⁻ Q⊕ TMβ⁺ Š⁻ TM[TM TMpTMTMTM ⊕Ú« d©ý ©u±%TMa⁻ ®⁻ 1TMç⁻ \TM0⁺ Š⁻ TM&TMÚTMTM&TM TM]'' x±fTMETMxTM[TM

| J`T | aRce>T`UV | aRce>R^V | aRce>UVdT |
|-------|--------------|--------------------|------------------------------|
| AAABA | EIGHBGCAA | SReeVcj | RRR |
| AAACA | EIFARABHFA | ecR_dIR_el^ReTYL_X | j dT>e>ACCD |
| TBAB | TVi WBYBAAg | TIV]VTec` | FAgicddiBA^Wl 9Fi BB: lea |
| TBAC | TVi WBTBABg | TIV]VTec` | BGlcddiBAA^Wl 9GDi BB: lea |
| TBAF | TVi WBVCCBg | TIV]VTec` | CFglcddiCCA^Wl 9Fi BB: lea |
| TBAG | TVi WBYEHJg | TIV]VTec` | FAgicddiEH^Wl 9Fi BB: lea |
| TBAH | TVi WBYEHI g | TIV]VTec` | FAgicddiEA^Wl 9Fi BB: lea |
| TBAI | TVi WBYEHAg | TIV]VTec` | FAgicddiEH^Wl 9GDi BB: lea |
| TBAJ | T^i ^CRBAC[| Ti^j]Rc | BAAglA?AB^Wl[1 9ea: |
| TBBA | TVi WBYEHI g | TIV]VTec` | FAgicddiEA^Wl 9Fi BB: lea |
| TBBB | TTi WBVBADk | TITVcR | FAgIWA?AB^Wl k1 9eRaaL_X: |
| TCAC | TTkWBVBADk | TITVcR | CFgIWA?AB^Wl k1 9Ri ZR]: |
| TCCJ | TVi WBYBAAg | TIV]VTec` | FAgicddiBA^Wl 9Fi BB: lea |
| TCDC | TVi WBYBAAg | TIV]VTec` | FAgicddiBA^Wl 9Fi BB: lea |
| TCDH | TVi WBYBAAg | TIV]VTec` | FAgicddiBA^Wl 9Fi BB: lea |
| TDAB | T^i ^CRDDC[| Ti^j]Rc | BAAglDAAaWl[1 9ea: |
| TDAC | T^i SCRCC[| Ti^j]Rc | BAAglVFIACC^Wl[1 9ea: |
| TDAD | Tkd]BYGIA[| TITVcR | FAgld]IGI aWl[1 9Ri ZR]: |
| TDAE | T^i ^CRBAC[| Ti^j]Rc | BAAglBAAAaWl[1 9ea: |
| TDAF | TVi WBVCCBg | TIV]VTec` | FAgicddiCCA^Wl 9BAi BG: lea |
| TDAG | T^i ^CRBAE[| Ti^j]Rc | BAAglA?B^Wl[1 9ea: |
| TDH | TVi UBYBAJb | TIV]VTec` | FAgIcelB^Wl 9GDi BB: lea |
| TDI | TVj WBgDDCg | TIV]VTec` | DFglcddiDDAA^Wl 9Bi DF?F: |
| TDJ | TTkWBVBADk | TITVcR | CFgIWA?AB^Wl k1 9Ri ZR]: |
| TEAB | TTi SCYBAC\ | TITVcR | FAAgISIBAAAaWl\1 9eRaaL_X: |
| TEAC | TTj SCYBAD\ | TITVcR | FAAgISIA?AB^Wl\ |
| TEAD | TTi SCYEHB\ | TITVcR | FAAgISIEHaWl\1 9eRaaL_X: |
| TEAE | T^j YDTICC[| Ti^j]Rc | B?G\giSFail CAAaWl[|
| TEAG | T^j YDTICC[| Ti^j]Rc | B?G\giSFail CAAaWl[|
| TEAH | T^j VCUFBE[| Ti^j]Rc | CAAgIafIA?FB^Wl[|
| TEAI | T^i SCUGID[| Ti^j]Rc | CAAgIVFIAGI ^Wl[1 9ea: |
| TEAJ | T^j VCXCHD[| Ti^j]Rc | EAAGIafIA?ACH^Wl[|
| TEBA | TVi VCTBAAY | TIV]VTec` | BGAgIcfclBA^Wl 9BDi CF: lea |
| TEBB | TVi RCUCCJV | TIV]VTec` | CAAgIcf]IC?C^Wl 9BAi BG: lea |
| TEBC | TVi WBYBAAg | TIV]VTec` | FAgicddiBA^Wl 9Fi BB: lea |
| TEBD | T^i ^CRBAE[| Ti^j]Rc | BAAglA?B^Wl[1 9ea: |
| TEBF | TVi WBgEHBg | TIV]VTec` | DFglcddiEHA^Wl 9BAi CA: lea |
| TEBG | TVi WBYEHAg | TIV]VTec` | FAgicddiEH^Wl 9GDi BB: lea |
| TEBH | TVi WBTBACg | TIV]VTec` | BGlcddiBAAA^Wl 9BAi CA: lea |
| TEBI | T^i ^CRBAE[| Ti^j]Rc | BAAglA?B^Wl[1 9ea: |
| TEBJ | T^i ^CRBAE[| Ti^j]Rc | BAAglA?B^Wl[1 9ea: |
| TECA | TVj UBYGI Jg | TIV]VTec` | FAgIcfSIGI^Wl 9BG: DF?F: |
| TECB | TTi SCYBAC\ | TITVcR | FAAgISIBAAAaWl\1 9eRaaL_X: |
| TFAJ | T^i ^CRBAE[| Ti^j]Rc | BAAglA?B^Wl[1 9ea: |
| TFBA | TVi WBVCCJg | TIV]VTec` | FAgicddiCC^Wl 9Fi BB: lea |
| TFBB | TVi WBYBAJg | TIV]VTec` | FAgicddiB^Wl 9Fi BB: lea |
| TFBC | TVi WBYBAJg | TIV]VTec` | FAgicddiB^Wl 9Fi BB: lea |
| TFBD | TVi WBYBAJg | TIV]VTec` | FAgicddiB^Wl 9Fi BB: lea |
| TFBE | TVi WBYEHAg | TIV]VTec` | FAgicddiEH^Wl 9GDi BB: lea |
| TFBG | T^i]BYBAF[| Ti^j]Rc | FAgI^VFI B^Wl[|
| TFBH | T^i ^CREHC[| Ti^j]Rc | BAAglEHAAAaWl[1 9ea: |
| TFBI | TVi WBVCCJg | TIV]VTec` | FAgicddiCC^Wl 9Fi BB: lea |
| TFCA | TVi WBVBABg | TIV]VTec` | CFglcddiBAA^Wl 9GDi BB: lea |
| TFCB | TVi WBYEHJg | TIV]VTec` | FAgicddiEH^Wl 9Fi BB: lea |

| J`T | aRce>T`UV | aRce>R^V | aRce>UVdT |
|------|-------------|-------------|------------------------------|
| TFCC | TVi WBYBAAg | TIV]VTec` | FAgicddiBA^Wl 9Fi BB: lea |
| TFCE | TVi WBVCCJg | TIV]VTec` | FAgicddiCC^Wl 9Fi BB: lea |
| TFCF | T^i ^CRBID[| Ti^j]Rc | BAAglA?AB^Wl[1 9ea: |
| TFCG | TVi WBYBAJg | TIV]VTec` | FAgicddiB^Wl 9Fi BB: lea |
| TFCH | TVi UBYCCJW | TIV]VTec` | FAgIc_UIC?C^Wl 9Fi BB: lea |
| TFCI | TVi WBYBAAg | TIV]VTec` | FAgicddiBA^Wl 9Fi BB: lea |
| TFCJ | TVi WBYBAJg | TIV]VTec` | FAgicddiB^Wl 9Fi BB: lea |
| TFDA | TVi WBYBAAg | TIV]VTec` | FAgicddiBA^Wl 9Fi BB: lea |
| TFDB | TVi UBYBAJW | TIV]VTec` | FAgIc_UIB^Wl 9Fi BB: lea |
| TFDC | TVi WBYBAJg | TIV]VTec` | FAgicddiB^Wl 9Fi BB: lea |
| TFDD | T^i ^CRBAE[| Ti^j]Rc | BAAglA?B^Wl[1 9ea: |
| TFDE | TVi WBYEHAg | TIV]VTec` | FAgicddiEH^Wl 9GDi BB: lea |
| TFEA | TVi WBYEHAg | TIV]VTec` | FAgicddiEH^Wl 9GDi BB: lea |
| TFEC | TVi WBYBAAg | TIV]VTec` | FAgicddiBA^Wl 9Fi BB: lea |
| TFED | YTW\BADkTR | TITyIaITVcR | FAgIj FgIA?AB^Wl k1CABC |
| TFEE | TVi UBYCCJW | TIV]VTec` | FAgIc_UIC?C^Wl 9Fi BB: lea |
| TFEF | TVi WBVCCAg | TIV]VTec` | FAgicddiCC^Wl 9Fi BB: lea |
| TGAB | T^i ^CRBAE[| Ti^j]Rc | BAAglA?B^Wl[1 9ea: |
| TGAC | TTkWBVBADk | TITVcR | CFgIWA?AB^Wl k1 9Ri ZR]: |
| TGAD | TVi WBYBAAg | TIV]VTec` | FAgicddiBA^Wl 9Fi BB: lea |
| TGAE | TVi WBVCCJg | TIV]VTec` | FAgicddiCC^Wl 9Fi BB: lea |
| TGAF | TTkWBVBADk | TITVcR | CFgIWA?AB^Wl k1 9Ri ZR]: |
| TGAG | TTkWBVBADk | TITVcR | CFgIWA?AB^Wl k1 9Ri ZR]: |
| TGAH | T^i ^CRDD[| Ti^j]Rc | BAAglA?ADD^Wl[1 9ea: |
| TGAI | TVi WBYEHAg | TIV]VTec` | FAgicddiEH^Wl 9GDi BB: lea |
| TGBA | TVi WBYBAAg | TIV]VTec` | FAgicddiBA^Wl 9Fi BB: lea |
| TGBB | TTkWBVBADk | TITVcR | CFgIWA?AB^Wl k1 9Ri ZR]: |
| TGBC | TVi WBYEHAg | TIV]VTec` | FAgicddiEH^Wl 9GDi BB: lea |
| TGBD | TVi WBYBAAg | TIV]VTec` | FAgicddiBA^Wl 9Fi BB: lea |
| TGBE | T^i ^CRDD[| Ti^j]Rc | BAAglA?ADD^Wl[1 9ea: |
| TGBF | TVi WBYBAAg | TIV]VTec` | FAgicddiBA^Wl 9Fi BB: lea |
| TGBG | TVi WBVCCJg | TIV]VTec` | FAgicddiCC^Wl 9Fi BB: lea |
| TGBI | TVi WBYBAAg | TIV]VTec` | FAgicddiBA^Wl 9Fi BB: lea |
| TGBJ | TVi WBVCCJg | TIV]VTec` | FAgicddiCC^Wl 9Fi BB: lea |
| TGCD | TVi WBVCCJg | TIV]VTec` | FAgicddiCC^Wl 9Fi BB: lea |
| TGCE | TVi WBVCCJg | TIV]VTec` | FAgicddiCC^Wl 9Fi BB: lea |
| TGCF | TVi WBTEHBg | TIV]VTec` | BGlcddiEHA^Wl 9BAi BC?F: ea |
| TGCH | TVi WBVCCJg | TIV]VTec` | FAgicddiCC^Wl 9Fi BB: lea |
| TGCI | TVi WBVCCJg | TIV]VTec` | FAgicddiCC^Wl 9Fi BB: lea |
| TGDA | TVi WBYBAAg | TIV]VTec` | FAgicddiBA^Wl 9Fi BB: lea |
| TGDB | TVi WBYEHJg | TIV]VTec` | FAgicddiEH^Wl 9Fi BB: lea |
| TGDC | TVi WBYEHJg | TIV]VTec` | FAgicddiEH^Wl 9Fi BB: lea |
| TGDD | TVi WBYEHJg | TIV]VTec` | FAgicddiEH^Wl 9Fi BB: lea |
| TGDE | TVi WBYEHJg | TIV]VTec` | FAgicddiEH^Wl 9Fi BB: lea |
| TGDF | TVi WBYEHJg | TIV]VTec` | FAgicddiEH^Wl 9Fi BB: lea |
| TGDG | TVi WBVEHAg | TIV]VTec` | CFglcddiEH^Wl 9Fi BB: lea |
| TGDI | T^i ^CRCCD[| Ti^j]Rc | BAAglA?ACC^Wl[1lea |
| TGDJ | T^i SBYCCE[| Ti^j]Rc | FAgIVFIACC^Wl[1 9ea: |
| TGEA | TVi WBYBAAg | TIV]VTec` | FAgicddiBA^Wl 9Fi BB: lea |
| TGEB | TVi WBgBABg | TIV]VTec` | DFglcddiBAA^Wl 9Bi BB?F: lea |
| TGEC | T^i ^CRCCD[| Ti^j]Rc | BAAglA?ACC^Wl[1lea |
| TGED | TVi WBgBACg | TIV]VTec` | DFglcddiBAAA^Wl 9BDi CF: lea |
| TGEE | TVj WBgCCCg | TIV]VTec` | DFglcddiCCAA^Wl 9BGi DB?F: |
| TGEF | T^i ^CRCCD[| Ti^j]Rc | BAAglA?ACC^Wl[1lea |

Š ^ Š § Š sŠ _Š pŠ TŠ > Š ` Š fŠ -

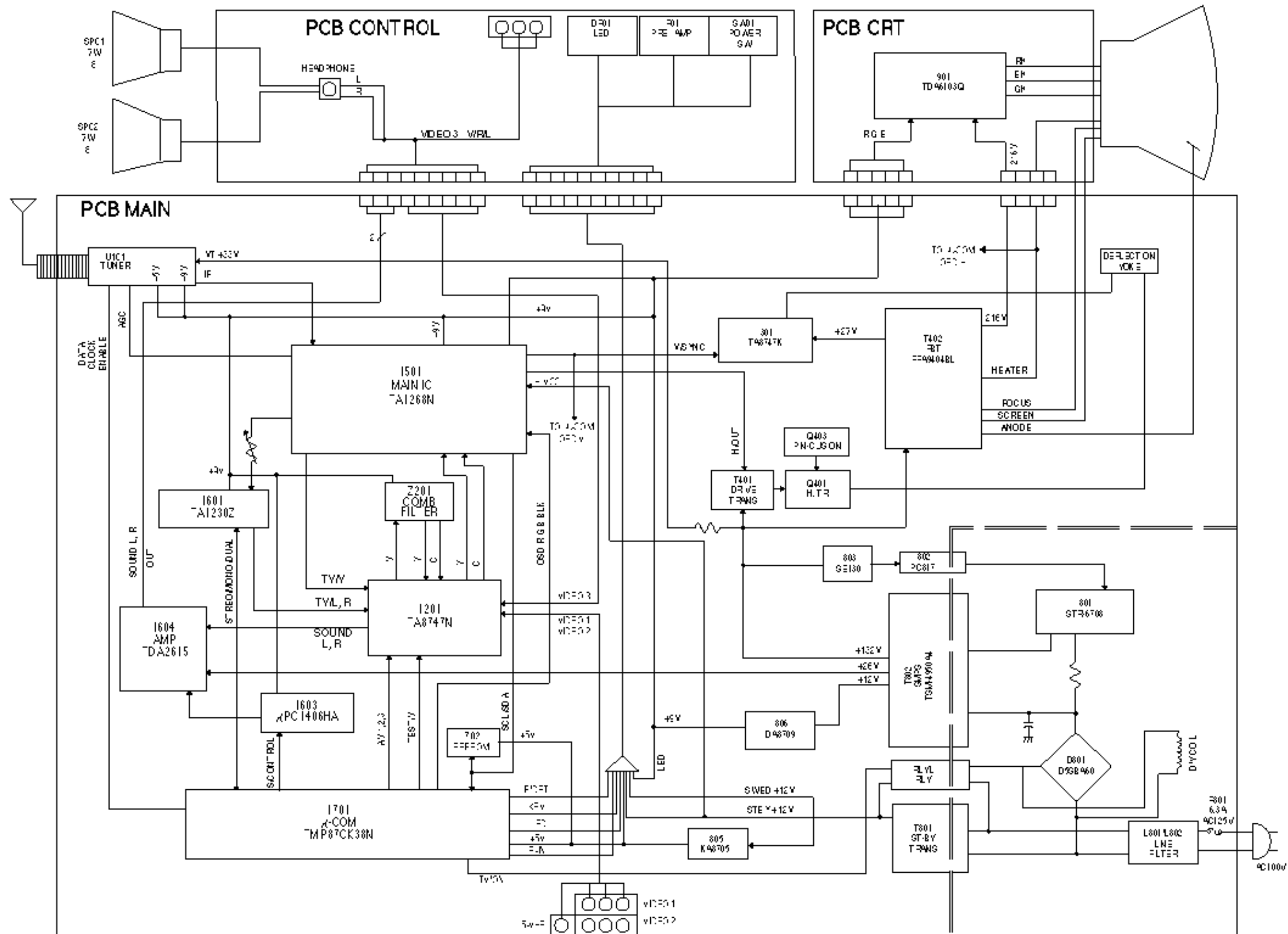

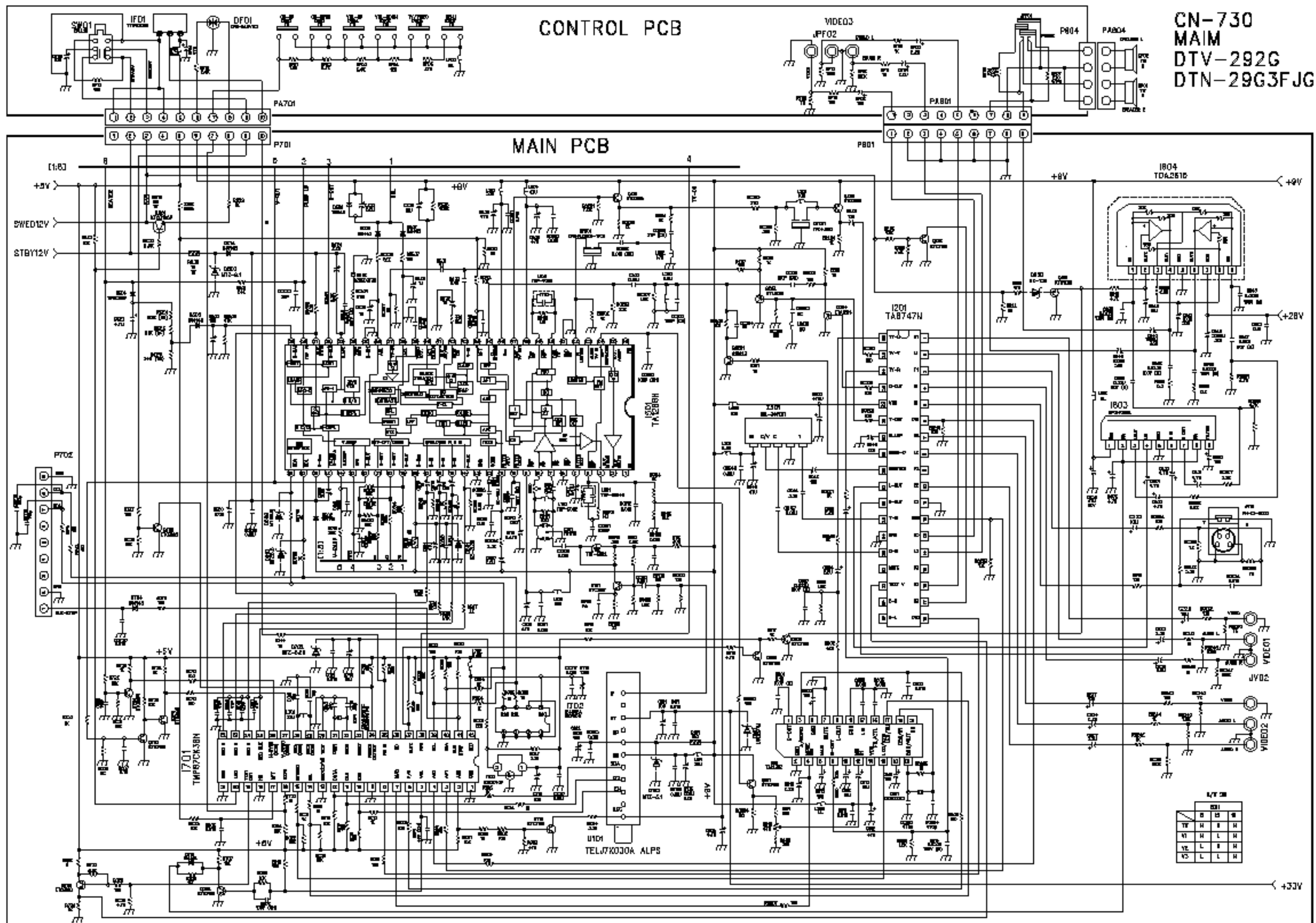

E ~ Q² Y ~ Q^a "

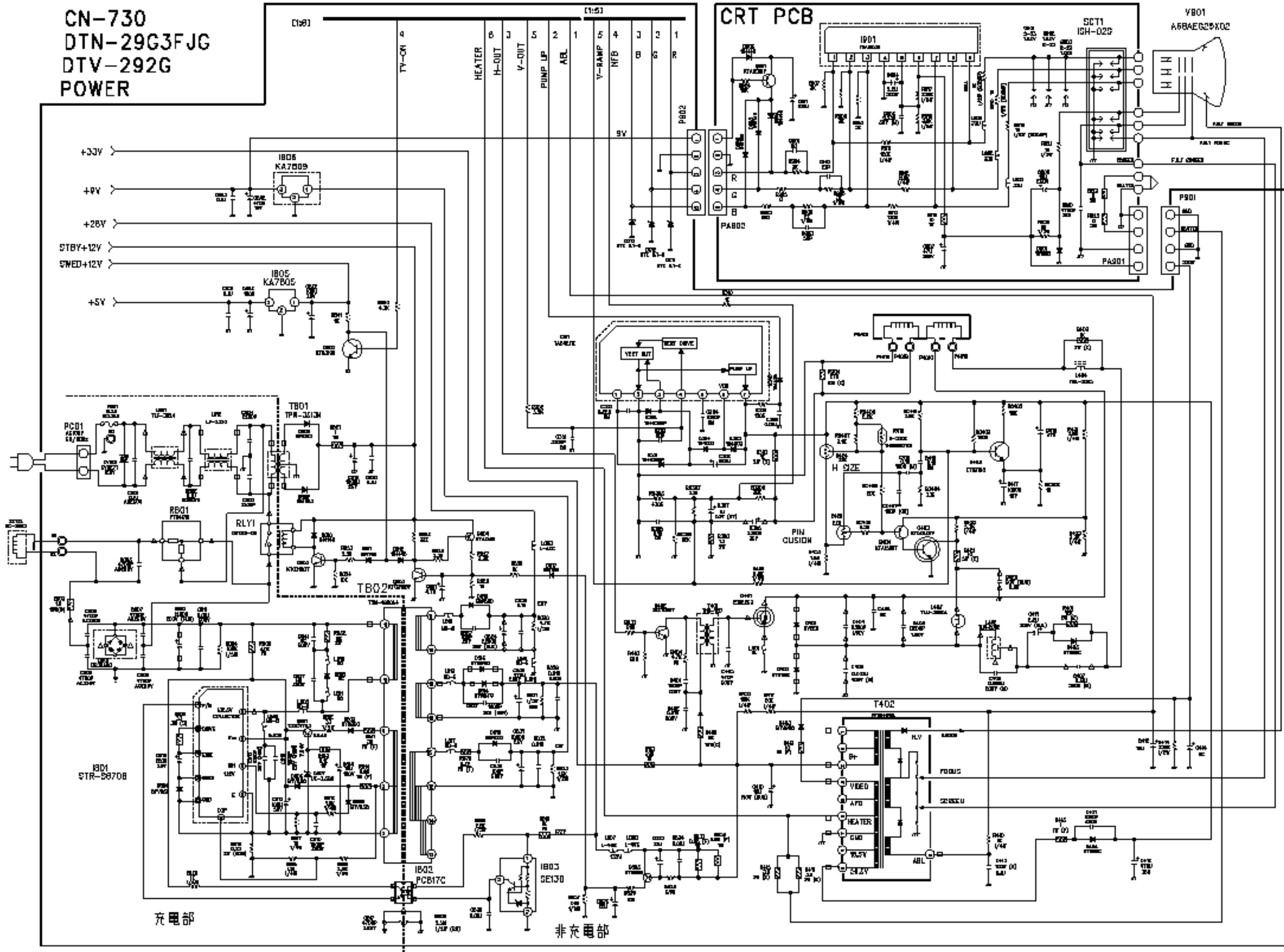

¥Q~ Q§m~ Q-h~ Qα[~ Qα " "

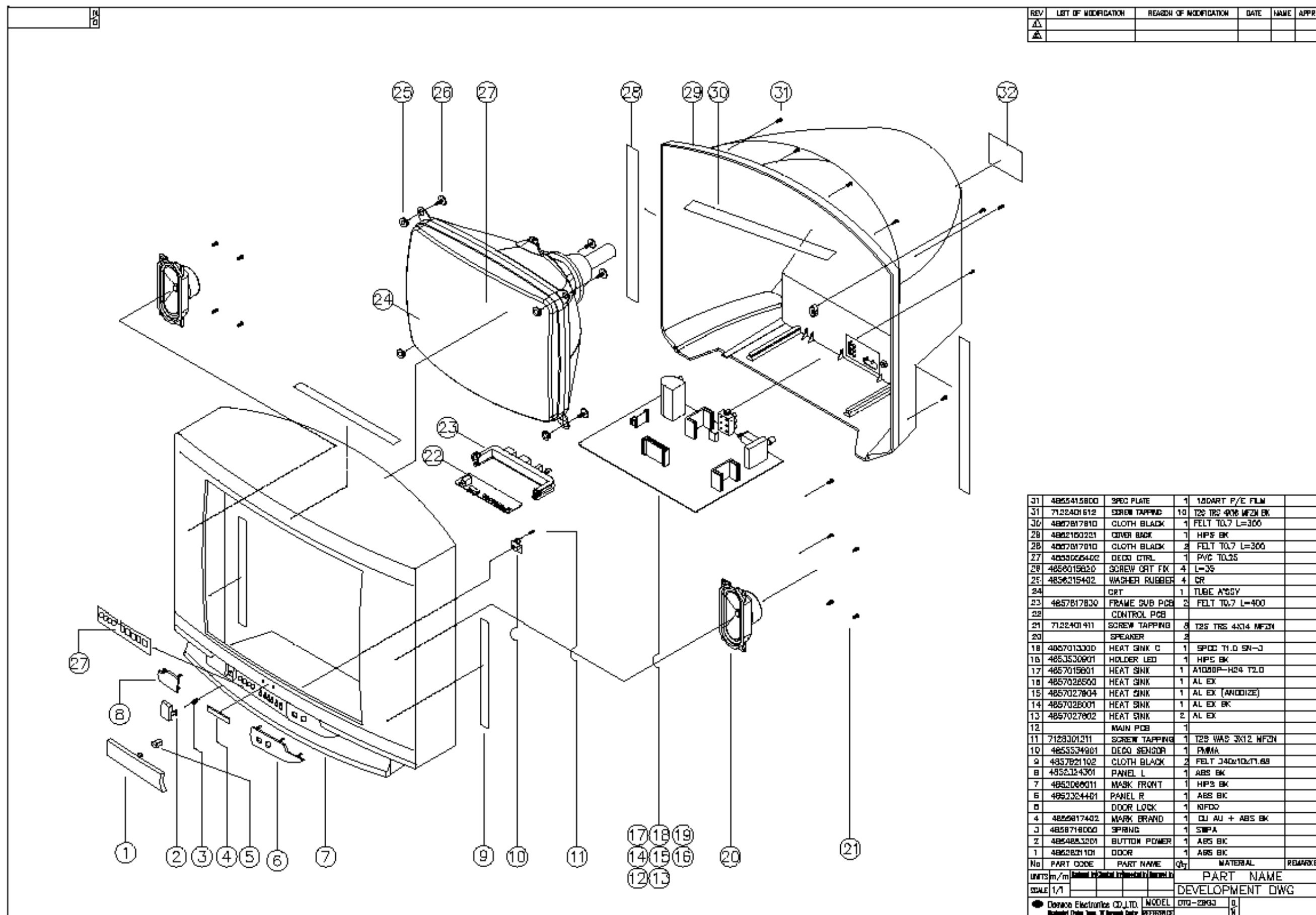

Š %Š ǻ Š – Š xǻ ®Ü¯ ®¯ l®' –

^a "

B?1^RZ_1aTS ǻ ®Ü^a "

C?1Tce1aTS 𐤀 𐤃𐤅𐤁 ”

D?1T`_ec`]1aTS 𐤀 𐤃𐤅𐤁 ”